

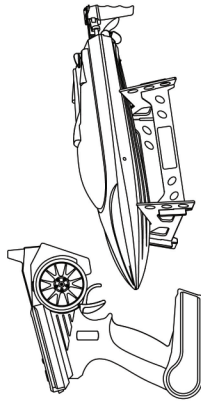

# UDI001



## 2.4G Wireless RC boat model manual

1. This model includes a 370 magnetic motor drive system Lithium-ion battery, for speeds of up to 20KM/H
2. The boat and transmitter take advantage of advanced 2.4GHz automatic code pairing technology to control the boat over long distances.
3. RC boat specifications:  
Length: 342mm  
Width: 89mm  
Height: 89mm
4. Special anti-tilt function prevents tilting and keeps the boat sailing.
5. Water-cooled motor extends the life of the boat.
6. Built-in left and right navigation rudders enhancing sailing stability.
7. Low-voltage alarm function: when the battery runs low, the transmitter will sound "Di, di, di." This warns that you have about 1 minute left, so you can sail it back for retrieval.
8. Transmitter detects when 2.4G signal becomes weak and flashes an out-of-range light.

### Operation instructions

<p>Forward</p>	
<p>Backward</p>	
<p>Left rudder</p>	
<p>Right rudder</p>	

1. To go forward: pull backward (squeeze) the throttle trigger on the transmitter.
2. To go backward (reverse): push forward on the throttle trigger.
3. To go left, turn the rudder wheel counter-clockwise (towards yourself). Use the throttle trigger to go forward and left.
4. To go right, turn the rudder wheel clockwise (away from yourself). Use the throttle trigger to go forward and right.

### RC boat exploded view

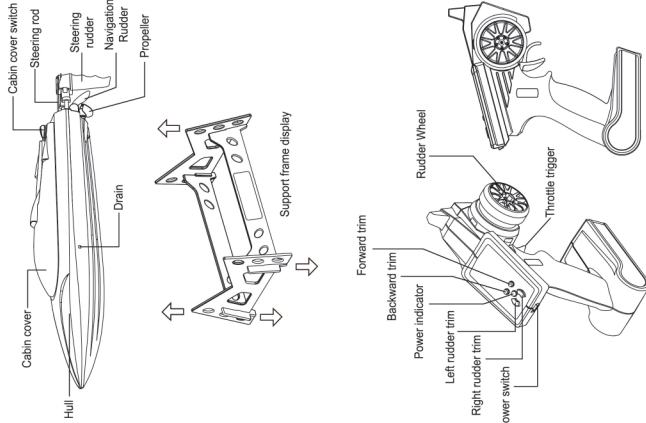

### Battery installation of transmitter

Battery installation: Open the battery compartment of the transmitter by sliding the cover open. Install 4 1.5 "AA" batteries into the battery compartment. Make sure the "+" and "-" ends of the batteries match the illustrations inside the battery compartment. Replace the cover and close the battery compartment.

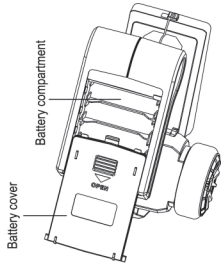

### Battery charge

"Plug the USB to the computer USB port, then connect the battery to USB. The battery will take about 110 minutes to get saturated." When in charging, USB LED indicator gets a solid light, after full charged, then light off. When finished the charge, please plug out the USB cable.

### Battery installation for RC boat

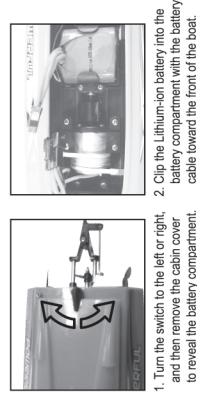

3. Connect the battery cable to the power plug. **NOTICE:** Lay the battery cable against the side of the hull to avoid damaging the cable.
  3. Turn the switch to the forward position so that it holds down the cabin cover.
- Notice: The battery cable should be layed by side of boat to avoid being stucked or broken up.

### Security Warning

For safety and security purposes, the boat will not operate until it is put into the water. This helps prevent the propeller from harming people or hitting solid objects.

1. This product is suitable for people aged 14 years or more. This product must always be used under adult supervision and guidance.
2. Please do not mix new and old batteries, or mix different types of batteries (e.g. alkaline batteries with rechargeable batteries).
3. Please do not use the transmitter for long periods of time, because the battery may get hot. Please wait until the battery cools down.
4. To avoid injury, please make sure there are no plants or peels are swimming where the boat is operating. Make sure there are no plants or debris in the water to avoid tying up or damaging the propeller.
5. The effective remote distance is up to 120 meters. Please do not exceed this range, or the boat will be out of range and you will lose control.
6. When the battery runs low, the transmitter will sound a "Di, di, di" alarm, and the speed of the boat will slow down. This indicates that the battery only has about 10 minutes left. Please wait until the battery cools down.
7. When the boat is not in use, please power off the transmitter and the boat. You must find a safe way to retrieve it. Please do not attempt to retrieve the boat from the water unless you know it is absolutely safe.
8. When the boat is operating, please focus on safety first. If the boat loses control, you must find a safe way to retrieve it. Please do not attempt to retrieve the boat from the water unless you know it is absolutely safe.
9. When the sails too far away, an out-of-range light on the transmitter will flash to indicate that the signal is getting weak. If the light is too far from the transmitter, the boat will become unstable and you will not be able to control it. Please make sure you control the boat so that it stays within the proper range.

<p>UDI001-05 Pipe unit</p>	<p>UDI001-07 Hull set</p>	<p>UDI001-06 Cabin cover set</p>	<p>UDI001-08 Li-Po battery</p>	<p>UDI001-08 Li-Po battery</p>	<p>UDI001-11 Servo linkage rod</p>	<p>UDI001-14 Silicone waterproof</p>	<p>UDI001-17 Navigation rudder</p>	
<p>UDI001-12 Support holder</p>	<p>UDI001-13 Tail Rudder positioning spacer</p>	<p>UDI001-16 Motor</p>	<p>UDI001-09 USB</p>	<p>UDI001-10 circuit board</p>	<p>UDI001-15 Heatsink assembly</p>	<p>UDI001-03 Rudder Servo unit</p>	<p>UDI001-02 Propeller unit</p>	<p>UDI001-04 Screw holder</p>

9. Let the boat idle (release the throttle trigger). If the boat still moves backward, press the forwards trim button until the boat stops moving.

### Maintenance and repair

1. If the RC boat stops running and will not power on, you must remove the battery.
2. Avoid exposing the surface of the boat to long exposures of sunlight, to prevent damaging the boat's surface. Please clean and dry the surface of the boat each time after use.
3. If the RC boat is not used for a long period of time, please remove the battery to avoid possible damage to the boat from battery leakage.

### Spare parts

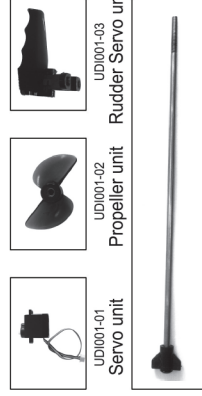

## Caution:

The user is cautioned that changes or modifications not expressly approved by the party responsible for compliance could void the user's authority to operate the equipment.

NOTE: This equipment has been tested and found to comply with the limits for a Class B digital device, pursuant to Part 15 of the FCC Rules. These limits are designed to provide reasonable protection against harmful interference in a residential installation. This equipment generates, uses and can radiate radio frequency energy and, if not installed and used in accordance with the instructions, may cause harmful interference to radio communications. However, there is no guarantee that interference will not occur in a particular installation.

If this equipment does cause harmful interference to radio or television reception, which can be determined by turning the equipment off and on, the user is encouraged to try to correct the interference by one or more of the following measures:

- Reorient or relocate the receiving antenna.
- Increase the separation between the equipment and receiver.
- Connect the equipment into an outlet on a circuit different from that to which the receiver is connected.
- Consult the dealer or an experienced radio/TV technician for help.