

Grandstream Networks, Inc.

126 Brookline Ave, 3rd Floor
 Boston, MA 02215. USA
 Tel : +1 (617) 566 - 9300

www.grandstream.com



BE	BG	CZ	DK	DE	EE	IE	EL	LI
ES	FR	HR	IT	CY	LV	LT	LU	CH
HU	MT	NL	AT	PL	PT	RO	SI	TR
SK	FI	SE	NO	IS	UK	UK(NI)		

In the UK and EU member states, operation of 5150-5350 MHz is restricted to indoor use only.



For Certification, Warranty and RMA information,
 please visit www.grandstream.com



GWN7664E

High-Performance AX6000 Wi-Fi 6 Access Point

Quick Installation Guide

Content

English.....1

OVERVIEW

The GWN7664E is a powerful, enterprise-grade 802.11ax Wi-Fi 6 access point, ideal for small-to-medium sized businesses, multiple floor buildings, residential settings and commercial locations. It offers dual-band 4x4:4 MU-MIMO with DL/UL OFDMA technology and a sophisticated internal antenna design for stronger anti-interference, more stable connection, delivering up to 6 Gbps wireless throughput and expanded Wi-Fi coverage range. The GWN7664E is supported by GWN.Cloud and GWN Manager, Grandstream's cloud and on-premise Wi-Fi management platform that and makes managing your network or several networks across multiple locations easier than ever before. It also uses a controller-less network management architecture in which the controller is embedded within the product's web user interface for easy administration of locally deployed Wi-Fi APs. The GWN7664E is the ideal Wi-Fi AP for voice-over-Wi-Fi deployments and offers a seamless connection with Grandstream's Wi-Fi capable IP phones. With support for advanced QoS, low- latency real-time applications, mesh networks, captive portals, 1000+ concurrent clients and dual 2.5 Gigabit network ports with PoE/PoE+, the GWN7664E is an ideal Wi-Fi access point for business-grade wireless network deployments with medium-to-high user density.

PRECAUTIONS

- Do not attempt to open, disassemble, or modify the device.
- Do not expose this device to temperatures outside range of 0 °C to 50 °C for operation and -10 °C to 60 °C for storage.
- Do not expose the GWN7664E to environments outside of the following humidity range: 10-95% RH (non-condensing).
- Do not power cycle your GWN7664E during system boot up or firmware upgrade. You may corrupt firmware images and cause the unit to malfunction.

PACKAGE CONTENTS

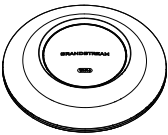

1x GWN7664E Access Point

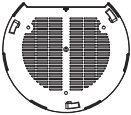

1x Mounting Bracket



1x Ceiling Mounting Bracket



3x Screw (PM 3 x 50)



3x Screw (PA 3.5 x 20)

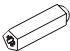

3x Plastic Expansion Bolt

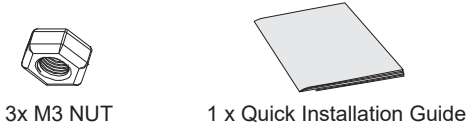

GWN7664E PORTS

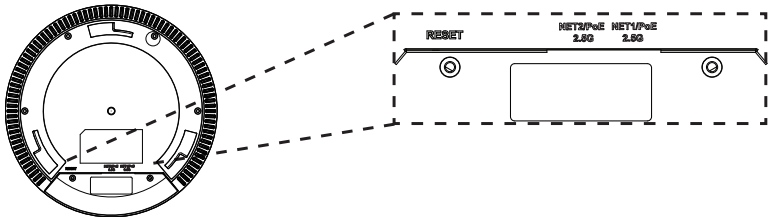

Port	Description
NET/POE 2.5G	2x 2.5 Gbps Ethernet RJ45 port with PoE/PoE+ support.
RESET	Factory reset button. Press and hold for 7 seconds to reset the unit to factory settings.

POWERING AND CONNECTING THE GWN7664E

GWN7664E can be powered on using PoE/PoE+ switch using following steps:

Step 1: Plug an RJ45 Ethernet cable to the port on the GWN7664E.

Step 2: Plug the other end into the uplink port of the power over Ethernet (PoE/PoE+) switch.

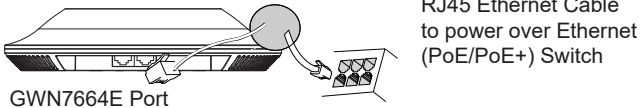

HARDWARE INSTALLATION

GWN7664E can be mounted on the wall or ceiling, Please refer to the following steps for the appropriate installation.

Wall Mount

1. Position the mounting bracket at the desired location on the wall with the arrow pointing up.
2. Use a pencil to mark the four mounting holes (screw holes DIA 5.5mm, reticle hole DIA 25mm).
3. If your Ethernet cable feeds through the wall, then cut or drill a circle approximately 18mm in diameter.
4. Insert screw anchors into the 5.5mm holes. Attach the mounting bracket to the wall by inserting the screws into the anchors.

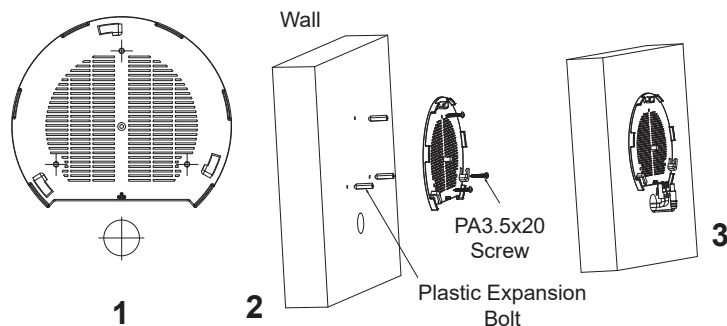

5. Connect the ethernet cable (RJ45) to the correct ports of your GWN7664E.
6. Align the arrow on the GWN7664E AP with the arrow on the locking tab of the mounting bracket and ensure that your GWN is firmly seated on the mounting bracket.
7. Turn the GWN clockwise until it locks into place and fits the locking tab.

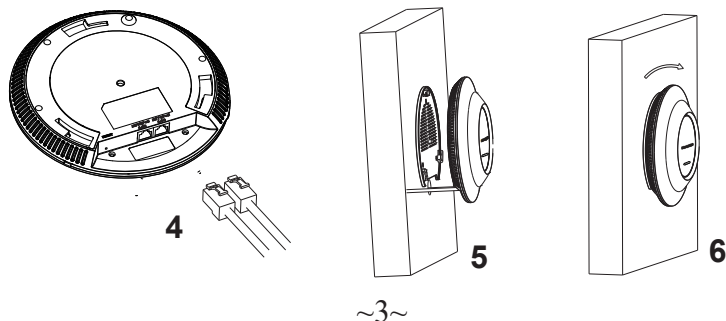

Ceiling Mount

Note: Ceiling mounting is recommended for optimal coverage performance.

1. Remove the ceiling tile.
2. Place the ceiling backing plate in the center of the ceiling tile and mark the mounting screw holes (screw holes DIA 5.5mm, reticle hole DIA 25mm).
3. Insert the screws through the mounting bracket.

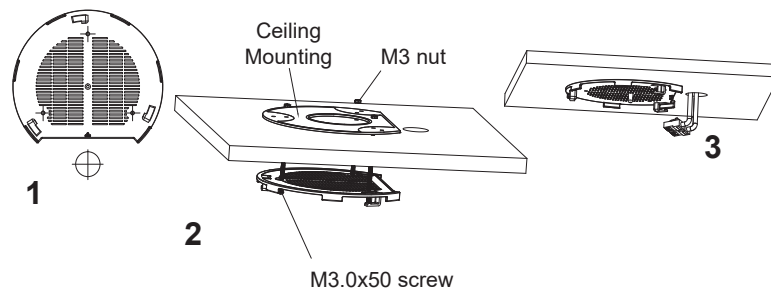

4. Connect the Ethernet cable (RJ45) to the correct ports of your GWN7664E.
5. Align the arrow on the GWN7664E with the arrow on the locking tab of the mounting bracket and ensure that your GWN is firmly seated on the mounting bracket and connect the network and power cables.
6. Turn the GWN clockwise until it locks into place and fits the locking tab.

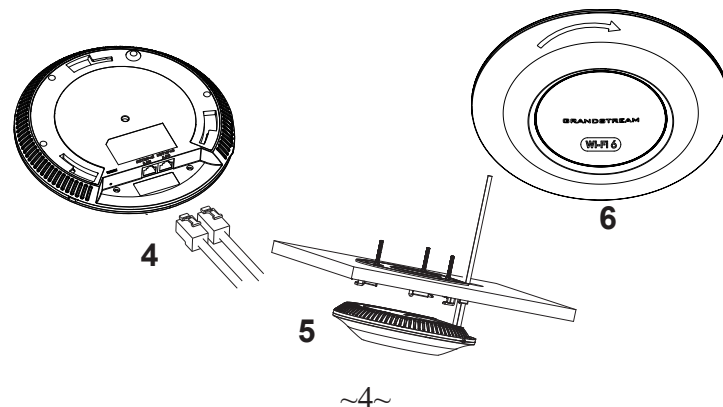

CONNECT TO GWN7664E DEFAULT Wi-Fi NETWORK

GWN7664E can be used as standalone access point out of box, or after factory reset with Wi-Fi enabled by default.

After powering the GWN7664E and connecting it to the network, GWN7664E will broadcast a default SSID based on its MAC address GWN[MAC's last 6 digits] and a random password.

Note: GWN7664E's default SSID and password information are printed on the MAC tag of the unit.

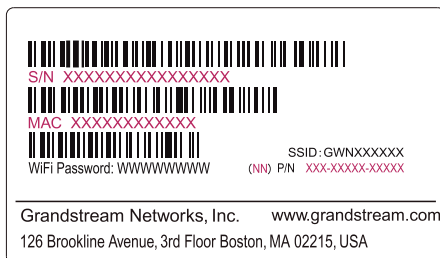

ACCESSING THE CONFIGURATION INTERFACE

A computer connected to the GWN7664E's SSID, or to the same network as the GWN7664E can discover and access its configuration interface using one of the below methods:

Method 1: Discover GWN7664E using its MAC Address

1. Locate the MAC address on the MAC tag of the unit, which is on the underside of the device, or on the package.
2. From a computer connected to same network as the GWN7664E, type in following address using GWN7664E's MAC address on your browser: **`https://gwn_<mac>.local`**

Example: If a GWN7664E has the MAC address C0:74:AD:8B:4E:28, this unit can be accessed by typing **`https://gwn_c074ad8b4e28.local`** on the browser.

Method 2: Discover GWN7664E using GWN Discovery Tool

1. Download and install **GWN Discovery Tool** from the following link: <http://www.grandstream.com/tools/GWNDiscoveryTool.zip>
2. Open the GWN DiscoveryTool, and click on **Scan**.

3. The tool will discover all GWN76XX Access Points connected on the network showing their MAC and IP addresses.
4. Click on **Manage Device** to be redirected directly to the GWN7664E's configuration interface, or type in manually the displayed IP address on your browser.
5. Enter username and password to login. (The default administrator username is "admin" and the default random password can be found at the sticker on the GWN7664E).



Notes:

- Make sure that the GWN7664E is not already paired with another GWN76xx Access Point as slave, GWN Router, GWN Cloud, or GWN Manager, otherwise the configuration interface cannot be accessed
- If the GWN7664E is already paired, make sure to unpair it first, or do a factory reset.
- It is customer's responsibility to ensure compliance with local regulations for frequency bands, transmit power and others.
- To manage GWN7664E over cloud, please refer to <https://www.gwn.cloud>.

The GNU GPL license terms are incorporated into the device firmware and can be accessed via the Web user interface of the device at `my_device_ip/gpl_license`. It can also be accessed here: <http://www.grandstream.com/legal/open-source-software>
To obtain a CD with GPL source code information please submit a written request to info@grandstream.com

Refer to online documents and FAQ for more detailed information:
<http://www.grandstream.com/our-products>