

NOTES: (UNLESS OTHERWISE SPECIFIED)

- DRAWING INDICATES FIRST ARTICLE INSPECTION [X.X], CRITICAL-TO-FUNCTION [CTF], AND STATISTICAL PROCESS CONTROL [SPC] DIMENSIONS. ASSOCIATED CAD FILE DEFINES ALL NON-DIMENSIONED FEATURES (DEFAULT TOLERANCES APPLY TO NON-DIMENSIONED FEATURES).
- DEFAULT TOLERANCES:  
0 - 25 mm:  $\pm 0.10$  mm  
25.01 - 50 mm:  $\pm 0.12$  mm  
50.01 - 100 mm:  $\pm 0.15$  mm  
100.01 - 150 mm:  $\pm 0.20$  mm  
150.01 - 250 mm:  $\pm 0.25$  mm  
> 250 mm:  $\pm 0.30$  mm  
ANGLES:  $\pm 0.5^\circ$
- MATERIAL: ADC12
- SURFACE ROUGHNESS SHALL BE MAXIMUM 1.6
- BREAK SHARP EDGES TO 0.20 MAX. REMOVE ALL BURRS.
- DIMENSIONS APPLY BEFORE FINISH, EXCEPT WHERE NOTED.
- FINISH: AS DETAILED ON FINISH SHEET.
- PART VOLUME APPROXIMATELY: 26107.576 mm<sup>3</sup>
- STRAIGHT EDGES TO HAVE STRAIGHTNESS TOLERANCE OF 0.05 mm PER 25 mm, NOT TO EXCEED 0.25 mm OVER ENTIRE LENGTH.
- FLAT SURFACES TO HAVE FLATNESS TOLERANCE OF 0.10 mm PER 25 mm, NOT TO EXCEED 0.25 mm OVER ENTIRE SURFACE.
- PARTING LINE MISMATCH NOT TO EXCEED 0.10 mm.
- GATE TRIM TO BE FLUSH, OR RECESSED BELOW SURFACE 0.10 mm MAX.
- FLASH NOT TO EXCEED 0.10 mm.
- VISIBLE SURFACES TO BE FREE OF SINKS, GATE MARKS, EJECTOR MARKS, POROSITY, AND OTHER COSMETIC DEFECTS.
- CASTING TOOL TO BE PROPERTY OF RED DIGITAL CINEMA AND SHALL BE PROMINENTLY STAMPED OR ENGRAVED ON THE OPERATOR SIDE WITH RED DIGITAL CINEMA, PART NUMBER, ASSET NUMBER, TOOL WEIGHT, AND DATE.
- CASTING TOOL DESIGN, EJECTOR PIN, PARTING LINE AND GATE LOCATION TO BE APPROVED BY RED DIGITAL CINEMA IN WRITING PRIOR TO TOOL FABRICATION.
- IN INDICATED AREA, ENGRAVE THE PART NUMBER AND REVISION, USING 3.5 mm TEXT HEIGHT.
- DIMENSIONS APPLY AFTER FINISH.

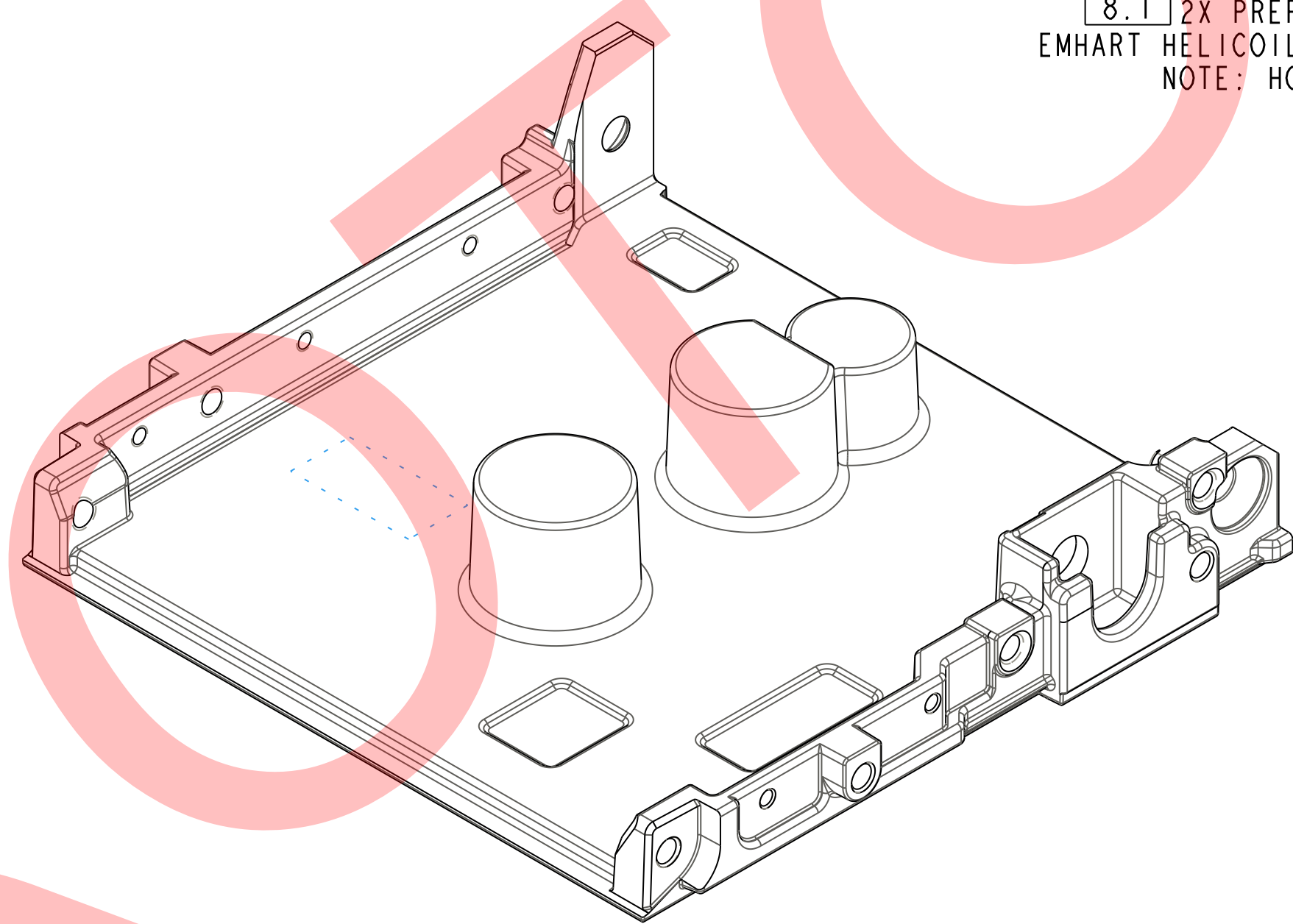
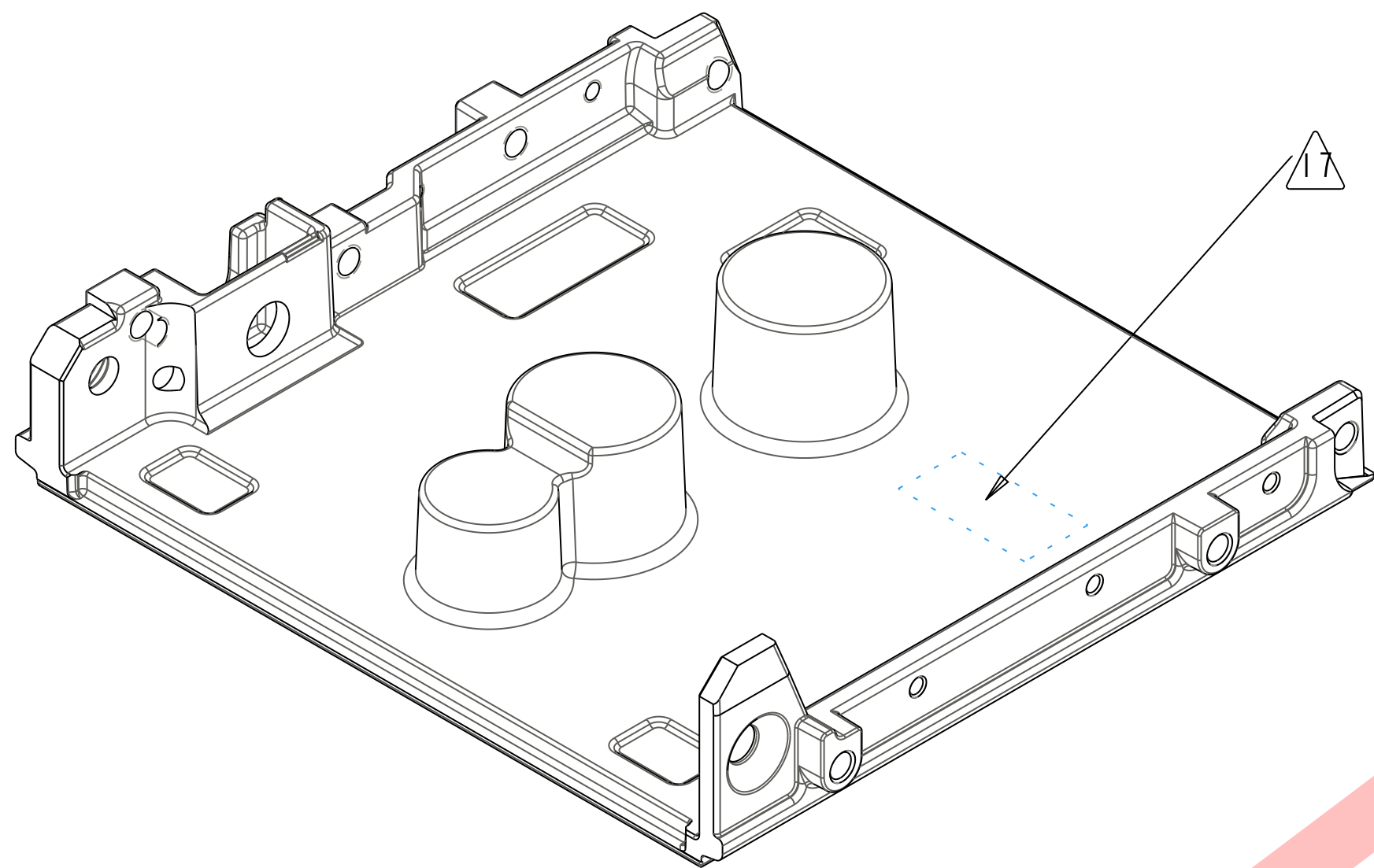

8.2 PREPARE HOLE PER MANUFACTURER'S INSTRUCTIONS  
KFS HELICAL INSERT 2TNC-4C-0250 OR EQUIVALENT  
NOTE: HOLE IS SHALLOWER THAN MANUFACTURER'S SPEC.

8.1 2X PREPARE HOLES PER MANUFACTURER'S INSTRUCTIONS  
EMHART HELICOIL HELICAL INSERT 1185-6CN375 OR EQUIVALENT  
NOTE: HOLE IS SHALLOWER THAN MANUFACTURER'S SPEC.

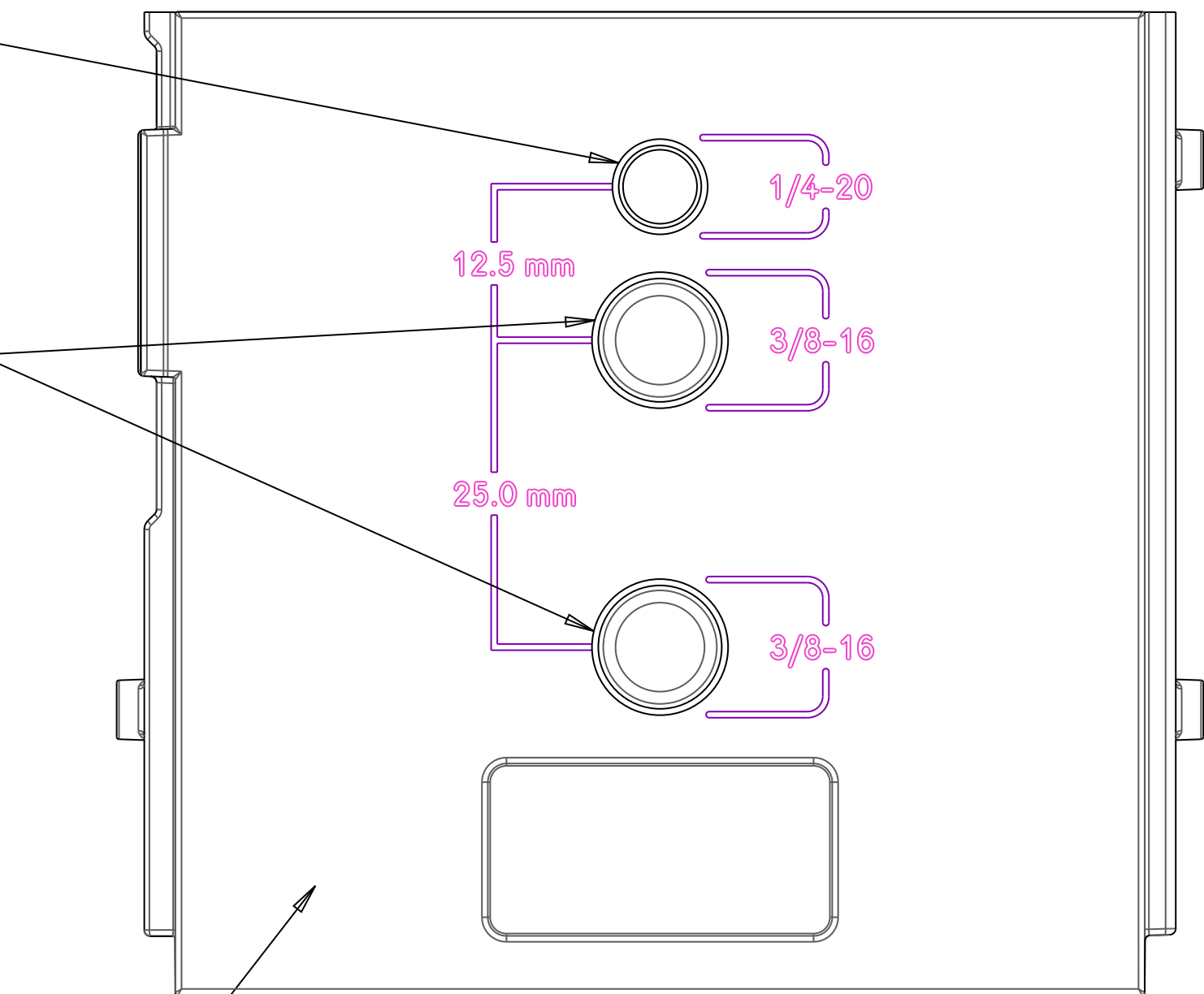

THIRD-ANGLE PROJECTION  
PROPRIETARY AND CONFIDENTIAL  
THE INFORMATION CONTAINED IN THIS DRAWING IS THE SOLE PROPERTY OF RED DIGITAL CINEMA. ANY REPRODUCTION IN PART OR AS A WHOLE WITHOUT THE WRITTEN PERMISSION OF RED DIGITAL CINEMA IS PROHIBITED.

UNLESS OTHERWISE SPECIFIED:  
DIMENSIONS ARE IN MILLIMETERS  
DEFAULT TOLERANCES: SEE NOTES  
INTERPRET GEOMETRIC TOLERANCING PER: ASME Y14.5M-1994  
MATERIAL: SEE NOTES  
FINISH: SEE NOTES  
DO NOT SCALE DRAWING

UNLESS OTHERWISE SPECIFIED:	NAME	DATE
DRAWN	A.P.D.	1/28/2011
CHECKED	REFER TO ECO	REFER TO ECO
ENG APPR	REFER TO ECO	REFER TO ECO
MFG APPR	REFER TO ECO	REFER TO ECO
Q.A	REFER TO ECO	REFER TO ECO

RED DIGITAL CINEMA	20291 VALENCIA CIRCLE LAKE FOREST, CA 92630
TITLE: ENCLOSURE, BOTTOM EPIC S35	
SIZE DWG NO:	REV
D 125-1790	11
SCALE: 2.000	SHEET 1 OF 4