

ID-K100 User’s Guide

Thank you for purchasing the IONTICS ID-K100.

This document provides you with a guide for using your new ID-K100. If you need more information of this product, Please visit www.iontics.com

Product Specification

Bluetooth Standard	V 2.0 (Bluetooth HID)
Frequency	2.4~2.48 GHz
Size	110×59×10.3 mm
Battery	Built-in rechargeable Li-ion Polymer
Charging time	<3 hrs
AC Input	110~240 V
Working Range	10 m
Power Saving	○
Weight	50 g
Operating Time	≥ 30 hrs
Standby Time	≥ 6 months
DC output	3.6 V

1

Components

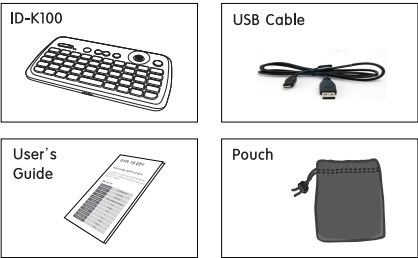

Locating the Controls

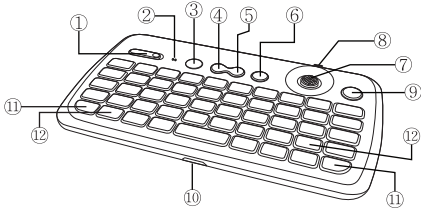

2

- ① **Power Switch**
- ② **LED Signal Lamp**
 - ▷ Blue lamp flashing (1sec): Bluetooth stand by
 - ▷ Blue lamp on (5sec): Power switch on
 - ▷ Green lamp on : Recharging
- ③ **Connect Button** : Run bluetooth working
- ④ **Volume (-) Button**
- ⑤ **Volume (+) Button**
- ⑥ **Mute Button**
- ⑦ **Joystick Mouse** : Controlling mouse cursor
- ⑧ **Enter Button** : Clicking left button on mouse (Selection button)
- ⑨ **Menu Button** : Clicking right button on mouse (Full down menu)
- ⑩ **Micro USB Port** : Charging battery through computer USB port
- ⑪ **Shift Button** : Character on right/upper-side, Capital letter and so on
- ⑫ **Func Button** : Character or function on left/upper-side and so on

* **Shift+Shift** : Keypad Back-lighting On/Off

* **2- Internet Hot Keys**

Fn+B : www.iontics.com

Fn+N : .com

3

Installation

Connecting the ID-K100

- Bluetooth is installed on your computer, Go to the Control Panel to run bluetooth configuration.
- For Bluetooth standby, Turn on Power button(①) and Press the connect button(③) on the ID-K100.
- At "Add the selected Bluetooth device "→ "The Bluetooth Setup Wizard" , Searching 'Bluetooth Mini Keyboard'.
- Select 'Bluetooth Mini Keyboard' , and click "Next>".
- At "Bluetooth Security Setup", Insert a secret key(a 6-digit sequence of numbers) for Bluetooth, and then Press Enter at ID-K100.
- Connecting ID-K100 to Bluetooth of your computer has been completed.

Notice of Connecting ID-K100

Notice) While the ID-K100 is on within 5 seconds(blue lamp on), do not use joystick mouse. If you do this, it may cause a malfunction. (If the joystick mouse malfunctions, you have to turn the power off and then on again.)

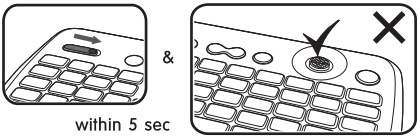

within 5 sec

4

Using the ID-K100

ID-K100 Joystick Mouse

The **Joystick Mouse** is available for free movement in all directions, and depending on the user's convenience, the mouse cursor can be easily adjusted.

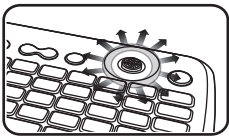

ID-K100 Ergonomic Design

You can use easily ID-K100 as a device which is composed of a keyboard and the 2-button mouse.

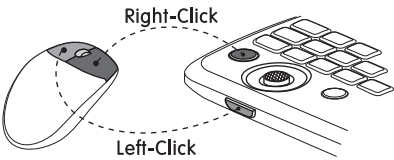

5

* Dragging the mouse pointer or moving some icons on your window is easy because you can handle the joystick mouse(⑦) and the enter button(⑧) at the same time.

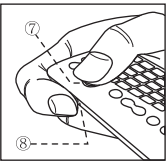

Charging ID-K100

- Plug the USB cable into the USB port on the ID-K100 and the computer USB port.
- The green LED lights on and start charging battery.
- Within 3 hours fully charged, the green LED will turn off.
- The straight operating time is more than 30 hours, and the standby time is more than 6 months.

6

Certification / Exemption Clause

Certification

CE/FCC/KCC

Class B Equipment (Information Communication equipment for residential): This unit residential (B grade) and EMC registration as a device primarily intended to use at home, and are available in all areas.

Exemption Clause

Including importers, mid dealers, manufacturers is not responsible for any other damage such as accidental damage or injury due to improper use, immaturity of manipulation. Use the information herein has been made on the basis of the current product specifications. All specifications subject to change without prior notice to the individual user.

- In case of hardware is modified or tampered with;
- In case of being damaged by Acts of God, power surge, misuse, abuse, negligence, accident, wear and tear, mishandling, misapplication, or other causes unrelated to defects in the Hardware Device or the SOFTWARE;
- In case of being damaged by programs, data, viruses, or files, or during shipments or transmissions;
- In case of being not used in accordance with the accompanying documentation and instructions; or
- In case of being repaired, modified or altered by other than an IONTICS repair center and the unauthorized center causes or contributes to any defect or damage.

7

Limited Warranty Statement

Warranty Card

Product		Model	
Purchase Date			
Customer	Name		Tel.
	Address		

- Warranty is to cover the operating defaults after the purchase during the warranty period.(12months after the purchase).
- This product is manufactured under strict quality control and inspection processes.
- When this product goes out of order under the normal use of customer, we will repair it in free of charge during the warranty period.
- Even during the warranty period, we will provide repair services for problems not covered under this warranty with reasonable charges.
- The damage (defaults) prescribable below are not to be covered by warranty
 - (1) User faults by lack of care.
 - (2) Faults by the users own intention of dismatle or repair.
 - (3) Damage caused by natural disaster. (Fire, Flood, Earthquake, Lighting, etc.)
- Please show us the warranty card when you ask for repair service.
- Please Keep the warranty card securely as it is not reissued.

8

FCC NOTE :

The Manufacturer Is Not Responsible For Any Radio Or Tv Interference Caused By Unauthorized Modifications To This Equipment. Such Modifications Could Void The User'S Authority To Operate The Equipment

This device complies with part 15 of the FCC Rules. Operation is subject to the following two conditions: (1) This device may not cause harmful interference, and (2) this device must accept any interference received, including interference that may cause undesired operation