

T3911-A User Manual

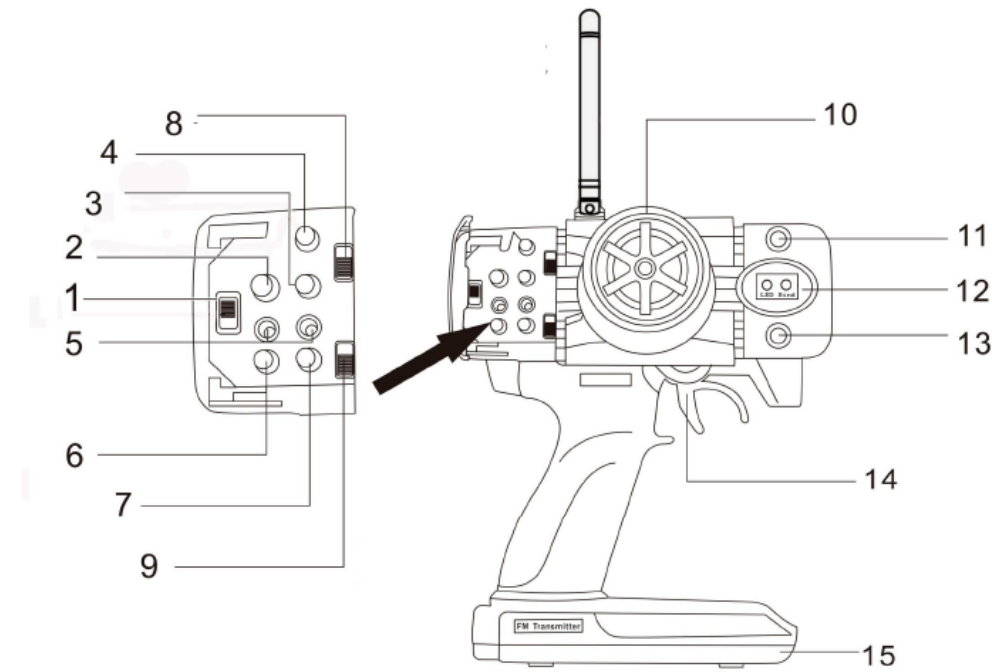

This device is a 2.4GHz transmitter used for model control.

Operation:

Match code—Turn on the power, press the coding button and the LED light flash. Then press the receiver's coding button, the LED will keep lighting after complete match code.

Avoid lose control setup—Normal condition, first setup the state of lose control every channel, then press the transmitter match code twice, the LED light flash three times, complete setup.

- | | | |
|----------------------------|--|--|
| 1. Power switch | 7. Back angle adjust | 12. Match code |
| 2. Left turn angle adjust | 8. Right-and-left switch | 13. Fore-and-aft middle inching switch |
| 3. Right turn angle adjust | 9. Fore-and-aft switch | 14. Fore-and-aft spanner |
| 4. Turn angle adjust | 10. Right-and-left wheel | 15. Battery box |
| 5. Power indicator light | 11. Right-and-left middle inching switch | |
| 6. Forward angle adjust | | |

Shenzhen Qingsongfa Company Ltd.

Rm504, 22Block, Yueliangwan Garden, Nanshan District, Shenzhen

This device complies with Part 15 of the FCC Rules. Operation is subject to the following two conditions: (1) this device may not cause harmful interference, and (2) this device must accept any interference received, including interference that may cause undesired operation.

Note: This equipment has been tested and found to comply with the limits for a Class B digital device, pursuant to part 15 of the FCC Rules. These limits are designed to provide reasonable protection against harmful interference in a residential installation. This equipment generates, uses and can radiate radio frequency energy and, if not installed and used in accordance with the instructions, may cause harmful interference to radio communications. However, there is no guarantee that interference will not occur in a particular installation. If this equipment does cause harmful interference to radio or television reception, which can be determined by turning the equipment off and on, the user is encouraged to try to correct the interference by one or more of the following measures:

- Reorient or relocate the receiving antenna.
- Increase the separation between the equipment and receiver.
- Connect the equipment into an outlet on a circuit different from that to which the receiver is connected.
- Consult the dealer or an experienced radio/TV technician for help.

NOTE: THE MANUFACTURER IS NOT RESPONSIBLE FOR ANY RADIO OR TV INTERFERENCE CAUSED BY UNAUTHORIZED MODIFICATIONS TO THIS EQUIPMENT. SUCH MODIFICATIONS COULD VOID THE USER AUTHORITY TO OPERATE THE EQUIPMENT