

WM320 User Guide for Windows

2012/3

Contents

Introduction.....	1
Before using the terminal.....	1
Supported OS (Personal Computers).....	1
Safety Notes	2
Use of the device around electrical devices for medical care.....	6
Request concerning handling.....	7
Common	7
WM320 terminal	7
USIM card.....	7
Caution	8
1. Part names and function	9
1.1 LED indicators	9
2. Preparing USIM card.....	10
2.1 Attaching	10
2.2 Removing	10
3. Setup for Windows	11
3.1 Installing WM320 Data Connection Manager	11
3.2 Confirm WM320 Data Connection Manager.....	13
3.3 Uninstalling WM320 Data Connection Manager	14
4. Utility Software for Windows.....	16
4.1 WM320 Data Connection Manager configuration	16
4.1.1 Status display area	17
4.2 Launch WM320 Data Connection Manager.....	18
4.3 Close WM320 Data Connection Manager	18
4.4 Connection Setting.....	19
4.4.1 Profile Setting.....	19
4.4.2 Advanced.....	20
4.4.3 Connection method	20
4.5 Connect /Disconnect.....	21
4.6 PIN Management.....	22
4.6.1 Enabled PIN	22
4.6.2 Disabled PIN	22
4.6.3 Modify PIN	23
4.7 Network Settings	24
4.7.1 Network Mode	24
4.7.2 3G/GPRS Settings	24
5. Appendix.....	25
5.1 Product Specifications.....	25
5.2 Export Administration Regulations.....	26
5.3 Intellectual property rights.....	26

Introduction

Thank you for purchasing the WM320.

Please always read this user guide before using the product.

Before using the terminal

- It is not available, at the place that out of reach of radio waves such as in tunnels, underground, building and weak point, out of service. And you may not be available even in the high floor vantage point, such as high-rise apartment buildings.
- Public places, a quiet place and where there is a lot of people, please use so as not to disturb the people around.
- If use overseas, please check with your customer center.
- Damage of this document and caused by the use of products that have been described in this document, costs of recovery is your responsibilities.



Supported OS (Personal Computers)

Operation System	Windows 7®	Japanese version (Service Pack 1 or later)
	Windows Vista®	Japanese version (Service Pack 2 or later)
	Windows XP®	Japanese version (Service Pack 3 or later)
	Mac OS X 10.5~10.7	Japanese version (Intel)
Memory	Windows 7®	1GB or more recommended
	Windows Vista®	1GB or more recommended
	Windows XP®	512MB or more recommended
	Mac OS X 10.5~10.7	512MB or more recommended
Hard Disk	50MB or more	
Interface	USB2.0	





- Other than the above, it may not work. In addition, even if applicable to the above, by your environment, you may not operate properly.
- Operation of the via (including the USB port on the monitor or keyboard, etc.) USB conversion adapter or hub is not guaranteed.
- Operation with the OS upgrade is not guaranteed.

Safety Notes





Before using this product, please read the "Safety Notes" and use this product in the correct manner. The dangers or damage that can occur if the following precautions are not strictly adhered to or this product is not used in the correct manner are described below.

 Danger	This sign denotes that death or serious injury may directly result from improper use.
 Warning	This sign denotes that death or serious injury may result from improper use.
 Caution	This sign denotes that bodily injury or damage to property may result from improper use.

The following pictorial displays are used to represent what you should do or should not do.

 Don't	This symbol denotes a prohibited action.
 No disassembly	This symbol denotes that disassembling the phone or its components is not allowed.
 No liquids	This symbol denotes that using the device or its components in a bathroom or highly humid area is not allowed.
 No wet hands	This symbol denotes that using the device or its components with wet hands is not allowed.
 Do	This symbol denotes an obligatory action (that must be performed).

Danger

	<p>Please do not use or leave the device in a place where it will be exposed to high temperatures, such as near a fire or heater, in strong, direct sunlight, or inside a car on a hot day.</p> <p>This may cause the device change shape or malfunction or overheat, catch fire. It may also cause the device to become hot, resulting in a burn injury.</p>
	<p>Please do not use near the vicinity of high-precision electronic devices.</p> <p>If you are using electrical devices for medical care other than an implanted pacemaker or implanted defibrillator at home or other location outside a medical facility, please inquire with the manufacturer of each device concerning any adverse effects of radio waves on device.</p>
	<p>Please do not disassemble or modify the device.</p> <p>This may cause a fire, injury, electric shock or other accident, or malfunction of the device.</p> <p>By alter the device, it is a violation of the Radio Law.</p>
	<p>Please do not use the device with wet hands.</p> <p>This may cause electric shock, or malfunction of the device.</p>
	<p>Please do not use the device in a bathroom and not put in the water.</p> <p>This may cause overheat, a fire, electric shock or malfunction of the device.</p> <p>Do not use near a risk of spilling liquid.</p> <p>Spilled liquid may cause a fire, overheat, electric shock, or malfunction of the device.</p>







Warning

	<p>Please do not subject the device to strong shocks or throw it.</p> <p>It may cause malfunction of device, a fire, injury of yourself or others.</p>
	<p>Please do not contact the conductive foreign object into the USB connector or not insert foreign object into crack.</p> <p>This may cause overheating, a fire, electric shock or malfunction.</p>
	<p>Please do not use the device at gasoline stations or other locations where it may cause a fire or explosion.</p> <p>This may cause explosion, or catch fire.</p>
	<p>Please do not put in a microwave oven or other cooking device that use heat, or a high-pressure container.</p> <p>This may cause overheating, a fire, electric shock or malfunction.</p>
	<p>Please use the equipment always dedicated.</p> <p>If use the equipment not dedicated, it may cause overheating, a fire, explosion or malfunction.</p>
	<p>Please do not use this device while driving.</p> <p>This may cause traffic accident.</p>
	<p>Please do not use this device in aircraft, at hospitals, or other areas where its use is prohibited.</p> <p>It may adversely affect electronic instruments or electric devices for medical care.</p>
	<p>Please remove the device from the PC, when not used for a long time.</p> <p>This may cause electric shock, a fire or malfunction.</p>
	<p>Abnormal condition such as smoke, strange odor, please remove this device from PC immediately.</p> <p>Continuing to use, it may cause overheating, a fire. When notice any abnormality, please discontinue use immediately.</p>
	<p>If water enters, please discontinue use immediately.</p> <p>Continuing to use, it may cause electric shock or malfunction.</p>



Caution





	<p>Do not place the device on sloped or unstable surface.</p> <p>The device may fall off, causing an injury, or malfunction of the device.</p>
	<p>Do not use more excessive force than necessary.</p> <p>This may cause injury or malfunction.</p>
	<p>Itching, rash, eczema, or other condition may occur depending on the customer's health or physical disposition.</p> <p>If an abnormality occurs, immediately stop using, please receive medical attention.</p>
	<p>If the impact on electronic devices of the vehicle, please do not use.</p> <p>It may cause an adverse effect on vehicle electronic products and interfere with the safe driving</p>
	<p>Keep the device out of the reach of small children.</p> <p>Small children may accidentally swallow the device, or may injure themselves.</p>

Use of the device around electrical devices for medical care

Details noted here are based on the "Guidelines on the use of mobile phones and other device to prevent adverse effect or radio waves on electrical devices for medical care (Electromagnetic Compatibility Conference JAPAN).



Warning

 Do	<p>Please adhere to the following rules inside medical facilities.</p> <ul style="list-style-type: none">• Do not bring this device into operating rooms, intensive care units(ICU), or coronary care units(CCU).• Turn OFF PC in hospital wards.• Turn OFF PC even in the lobby if it is located near electrical medical equipment.• If the medical facility has designated areas where the use of the device or carrying them inside is prohibited, please follow the instructions of the facility.
 Do	<p>If you are wearing an implanted pacemaker or implanted defibrillator, please carry or use the device at least 22 cm away.</p> <ul style="list-style-type: none">• Radio waves may have an adverse effect on the operation of electrical equipment for medical care.
 Do	<p>Turn OFF PC in rush-hour train and other crowded places, in case there is anyone near you who has an implanted pacemaker or implanted defibrillator.</p> <ul style="list-style-type: none">• Radio waves may have an adverse effect on the operation of electrical equipment for medical care.
 Do	<p>If you are using electrical devices for medical care other than an implanted pacemaker or implanted defibrillator at home or other location outside a medical facility, please inquire with the manufacturer of each device concerning any adverse effects of radio waves on device.</p> <ul style="list-style-type: none">• Radio waves may have an adverse effect on the operation of electrical equipment for medical care.

Request concerning handling

Common

- Please use a soft, dry cloth when cleaning the units.
If you use alcohol, thinner, benzine or other cleaning agent, the printing may disappear and the colors may fade.
- Use a dry cotton swab to occasionally clean the electrode terminals.
If the terminals become dirty, contact becomes poor and power may be cut. If the terminals become, please wipe them clean with a dry cloth or cotton pad.
- Do not place the units near the air outlet section of an air-conditioner.
Rapid temperature changes cause dewing which results in internal corrosion and malfunction.
- Do not use more excessive force than necessary.
If the units is included in a container packed with many things or placed in a pocket subject to pressure when you sit down, internal circuit board may be damaged or malfunction,。

WM320 terminal

- Please avoid extremely high or low temperatures, humid, direct sunlight and dusty place.
- Since adverse effects may occur if the WM320 terminal is used near an ordinary phone, television, or radio, please use it at a distance from these location.
- Do not drop WM320 terminal or subject it to shocks.
This may cause it to malfunction.
- Please insert horizontally and not pull it when you connect the USB connector to PC.
This may cause it to malfunction.
- When moving, please remove WM320 terminal from the PC.
This may cause it to malfunction.
- Though the WM320 terminal gets warm while it is being used, this is normal. You can use it as is.

USIM card

- When removing USIM card, do not use more force than necessary.
- Be sure that the IC section is always clean when using it.
- Use a soft, dry cloth when cleaning the USIM card.
- Do not damage the IC chip, handle it carelessly or cause it to short circuit.
This may cause a loss of data or a malfunction.
- Do not drop USIM card or subject it to shocks.
This may cause it to malfunction.
- Do not bend the USIM card, and do not place any heavy items on top of the USIM card.
This may cause it to malfunction.
- Do not insert USIM card with label to WM320 terminal.
This may cause it to malfunction.

Caution

Please do not use WM320 altered absolutely. If used it, it is a violation of the Radio Act.

This product complies with Japanese technical regulations regarding exposure to radio waves. Its proof has been displayed in the label of its name plate. If you remove its screw for modification, such proof will be disabled. If its proof will be disabled, it is a violation of the Radio Act.

1. Part names and function

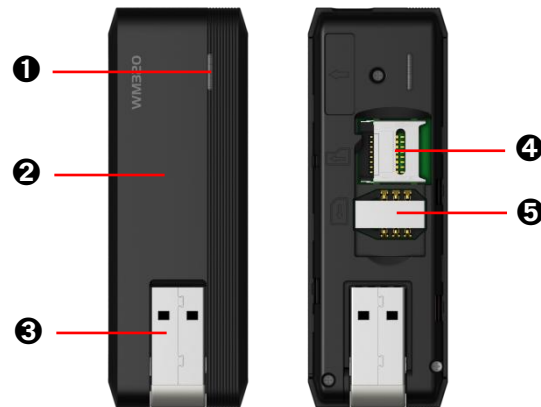

❶ LED status lamp

Display the current state

❸ Cover

To protect the USIM card

❹ USB connector

Connection terminal for PC

❷ Memory card slot

For inserting a memory card

※Not available part

❸ USIM card slot

For inserting a USIM card.

1.1 LED indicators

Terminal status		LED color	Indicator
Power OFF		lights off	lights off
Out of service		Red	Flashes
PIN1	PIN1 lock	Red	Flashes
	PIN1 inputting	Red	Flashes
USIM card is not inserted		Red	Flashes
Standby	HSDPA/HSUPA	Blue	Flashes slowly
	W-CDMA	Purple	Flashes slowly
	GPRS	Yellow	Flashes slowly
Connected	HSDPA/HSUPA	Blue	Flashes always
	W-CDMA	Purple	Flashes always
	GPRS	Yellow	Flashes always

2. Preparing USIM card

USIM card is an IC card customer information such as telephone numbers are recorded. In order to use this product, please attach to this product USIM card. Not to insert USIM card, you will not be able to take advantage of data communication, etc.

2.1 Attaching

1. Remove the cover.
2. Facing down the terminal portion of gold in the USIM card slot, insert the direction of the arrow.
3. Attach the cover.



2.2 Removing

1. Remove the cover.
2. Remove the USIM card from USIM card slot.
3. Attach the cover.

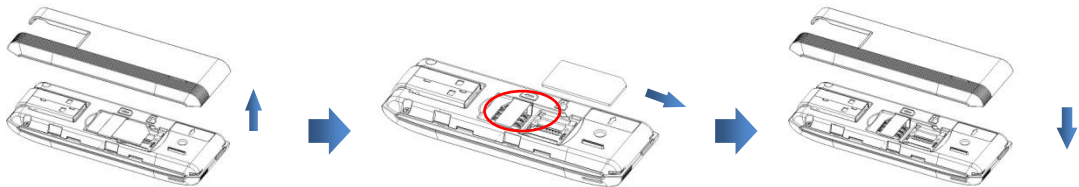

3. Setup for Windows

For the first time, connect to a PC product, the installer will automatically launch and installation of a (WM320 Data Connection Manager) utility software for data communications.

3.1 Installing WM320 Data Connection Manager

1. Turn on your PC, start the OS.
2. Connect the USB port on your PC this product.

WM320 Data Connection Manager setup screen for installation by the zero function, to connect the product will be displayed automatically.



3. If "User Account Control" window appears, click [Yes].

*Windows XP: The "User Account Control" window will not appear.

4. To start the installation of the WM320 Data Connection Manager. Click [Next].



5. Confirm the "license agreement", click [Agree].

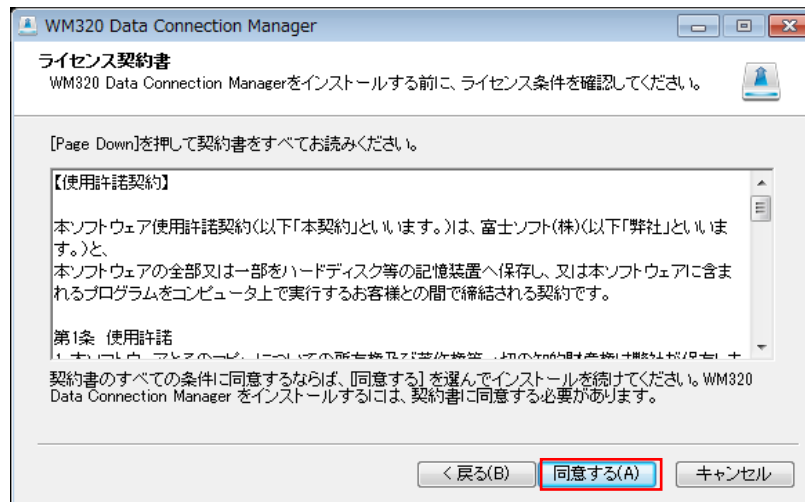

6. Select the installation location, click [Install].

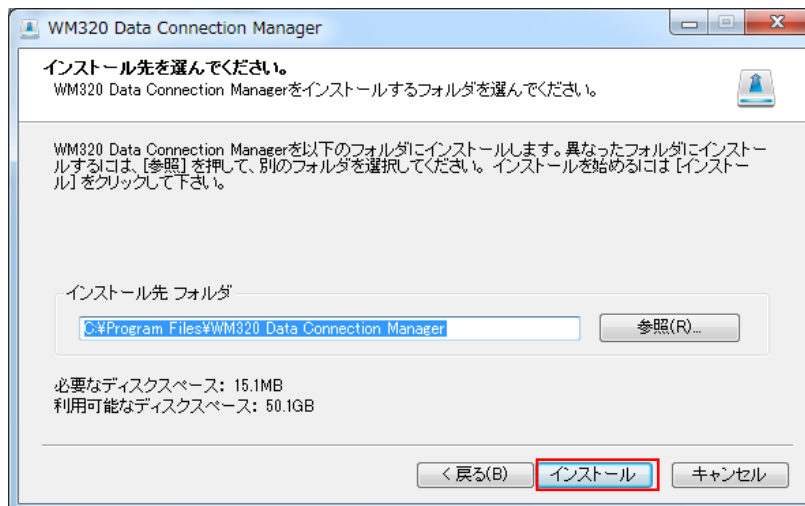

7. The installation is complete and the following screen is displayed. Click [Finish].

WM320 Data Connection Manager launch automatically.



3.2 Confirm WM320 Data Connection Manager

Make sure that is installed on the PC WM320 Data Connection Manager.

1. Select [Start] - [Control panel] - [System and Security]

*Windows Vista

Select [Start] - [Control panel] - [System and Maintenance]

*Windows XP

Select [Start] - [Control panel] - [Performance and Maintenance] - [System]

2. Click [Device Manager].

*Windows Vista

Click [Device Manager] - [Continue].

*Windows XP

Click [Hardware] tab - [Device Manage]

3. Confirm the file (driver) for settings that installed.

Please make sure that the device name is displayed under the "Modem", "Universal Serial Bus controllers", "Network adapter ", "Port (LPT and COM)".

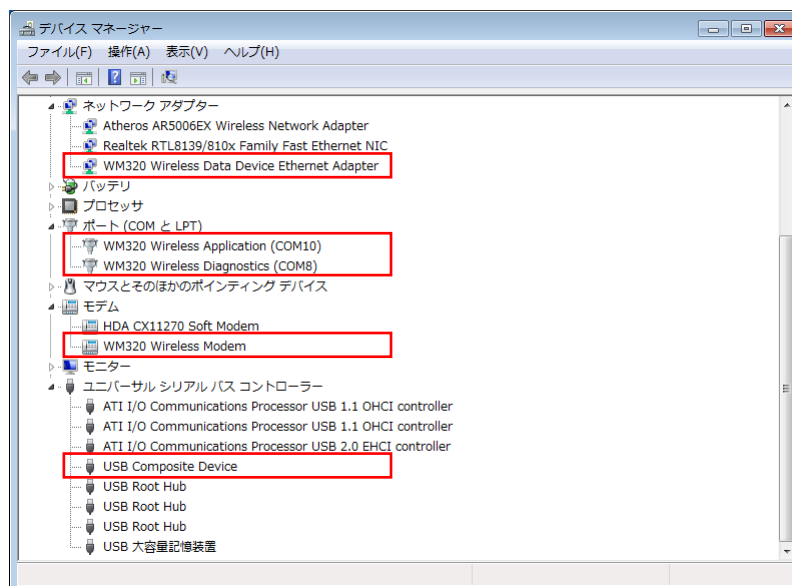

Network Adapter	WM320 Wireless Data Device Ethernet Adapter
Port(LPT and COM)	WM320 Wireless Application WM320 Wireless Diagnostics
Modem	WM320 Wireless Modem
Universal Serial Bus Controllers	USB Composite Device
*Windows XP	*Windows XP
USB(Universal Serial Bus) Controllers	USB composite device

*COM Port number may vary, depending on your computer.

3.3 Uninstalling WM320 Data Connection Manager

1. Select [Start] - [Control panel] - [Program] - [Uninstalling programs].

*Windows XP

Select [Start] - [Control panel] - [Add or Remove Programs].

2. Select [WM320 Data Connection Manager] - [Uninstall and delete].

*Windows XP

Select [WM320 Data Connection Manager] - [Modification and delete].

3. Click [Next].

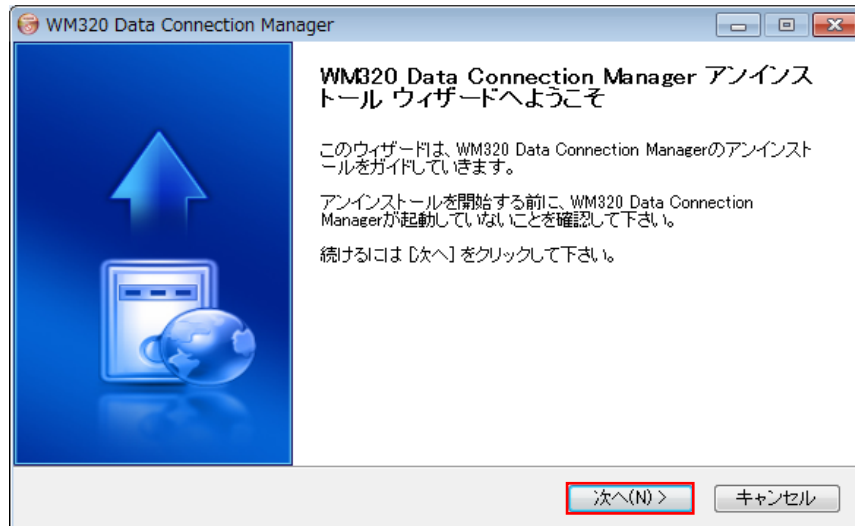

4. Click [Uninstall].

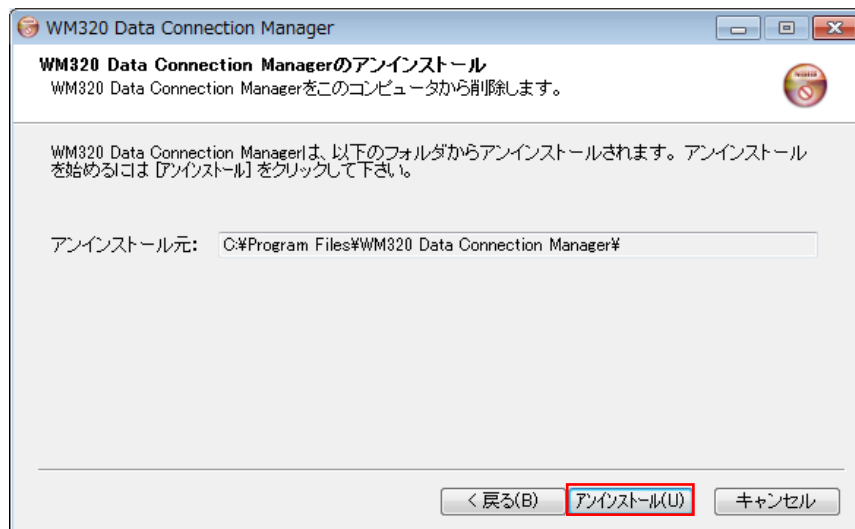

5. Click [Finish].

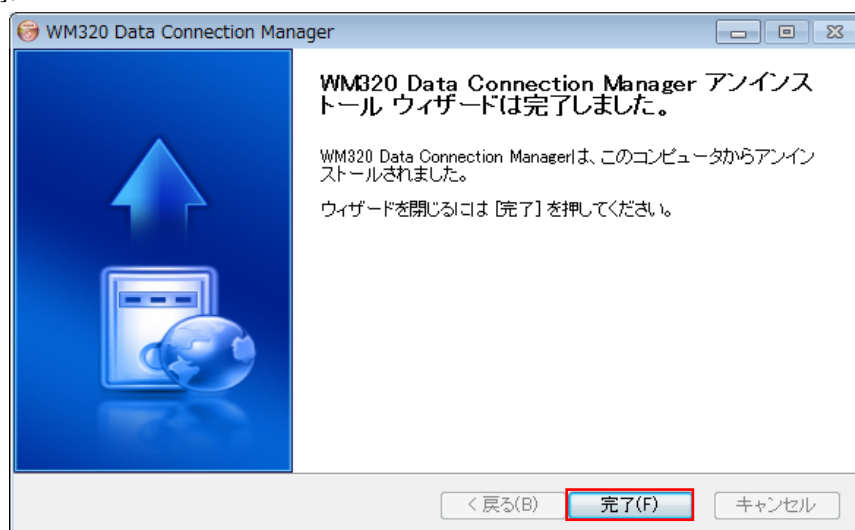

4. Utility Software for Windows

This product WM320 Data Connection Manager utility for data communication software will be installed. Data communication will be available on Windows using this software.

4.1 WM320 Data Connection Manager configuration

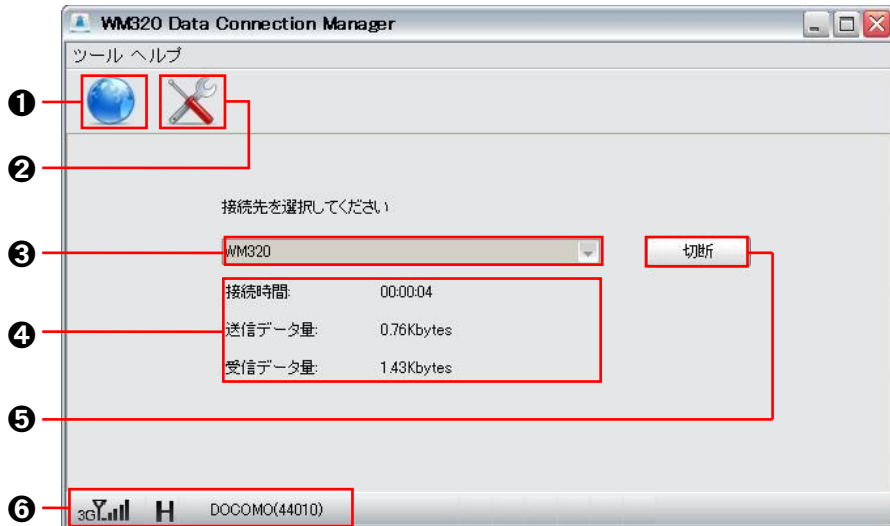

❶ Connection

To open the main.

❷ Setting

To open the Connection Settings, manage PIN, Network configuration.

❸ Profile name

Displays the name of the profile to connect.

❹ Information of Connection

While connecting, displays the following information.

- Connection time
- Amount of data sent
- Amount of data received



❺ Button to Connect / Disconnect

When connecting and disconnecting to the network, click this button.

❻ Status display area

Displays the status of the device.

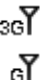
4.1.1 Status display area

Information	Status
Signal strength	 Out of range Weak ← → Strong  W-CDMA ^{※2} / HSDPA/HSUPA ^{※3}  GPRS ^{※4}
Connection interface to Internet	H HSDPA/HSUPA ^{※5} E GPRS
Operator	Display name of operator. (Displayed only while connecting.)
Operator-specific number	Display the network information (PLMN). PLMN is the operator-specific number. PLMN indicates MCC(Mobile Country Code) and MNC(Mobile Network Code) Display "DOCOMO (44010)" in DOCOMO area.

*1 W-CDMA(3G): Wideband CDMA

*2 HSDPA: High Speed Downlink Packet Access, HSUPA: High Speed Uplink Packet Access

*3 GPRS: General Packet Radio Service

*4 While connecting W-CDMA area, not displayed.

4.2 Launch WM320 Data Connection Manager

1. When connecting to PC, launch automatically.

4.3 Close WM320 Data Connection Manager

1. Click "×" at the top of the main screen.

4.4 Connection Settings

1. Click .
2. Select [Settings] - [Connection settings].

4.4.1 Profile Settings

Sets the profile to take advantage of data communication. If the settings of the profile is not, data communication is not available.

1. Select [Connection settings] - [Profile settings].
2. Click [New].
3. Enter the profile information.



① Profile name

Enter profile name.

The maximum number of characters

64 characters / 32 double-byte character

② User name

Enter user name.

The maximum number of characters

64 characters

③ Password

Enter password.

The maximum number of characters

64 characters

④ APN

Enter APN(Access Point Name)

The maximum number of characters

100 characters

⑤ Authentication method

Choose from two types of "PAP" "CHAP".

⑥ Connection method

Choose from four types of "IPv4" "IPv6" "IPv4V6" "PPP".

⑦ When connecting, verify the user name and password .

Check in this field, when each time connecting, confirmation screen appear.

4. Click [OK].
5. Select the profile that created and click [Connection destination settings].

4.4.2 Advanced

When use RAS(Modem), it is available to set manually IP address, DNS server addresses, WINS server addresses. Please follow the steps below. The default setting is "automatically".

1. Click [Advanced].
2. Input IP address, DNS server addresses, WINS server addresses



4.4.3 Connection method

It is available to use RAS(using dial-up modem) or NDIS(via network adapter).

Please select a connection method. The default setting is "NDIS".

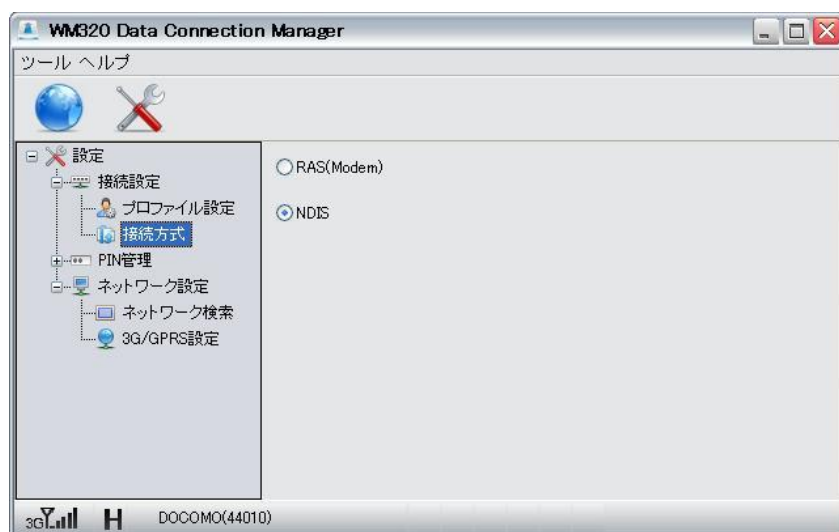

4.5 Connect/Disconnect

1. Insert the USB port of PC the device.
2. WM320 Data Connection Manager launch automatically.
3. Create the profile for connecting to the network.
4. Click [Connect].

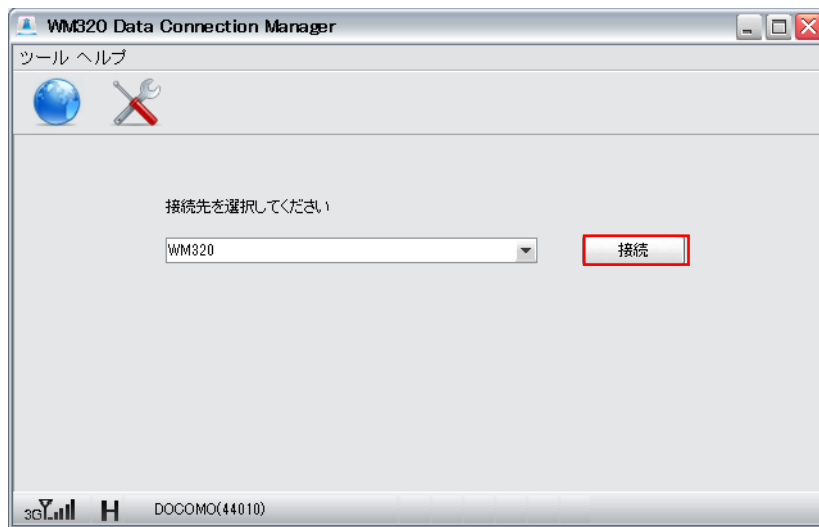

5. While connecting, "Connect" is replaced by "Disconnect" and display "Connection Time", "Amount of data sent and received".



6. Click [Disconnect].
7. Terminated connecting, "Disconnect" is replaced by "Connect".

4.6 PIN Management

It is available to set "Enabled PIN", "Disabled PIN", "Modify PIN".

PIN is a code of 4 to 8 digits in order to prevent unauthorized use by third parties.

If set to "Enable PIN1", need to enter a PIN code when connecting to PC.

For the default settings, please contact customer center.

4.6.1 Enabled PIN

1. Select [Enable PIN/Disable PIN].
2. Select [Enable PIN].



3. Input the correct PIN, PIN1 authentication is enabled.

4.6.2 Disabled PIN

1. Select [Enable PIN/Disable PIN].
2. Select [Disable PIN].



3. Input the correct PIN, PIN1 authentication is disabled.

4.6.3 Modify PIN

1. Select [Modify PIN].

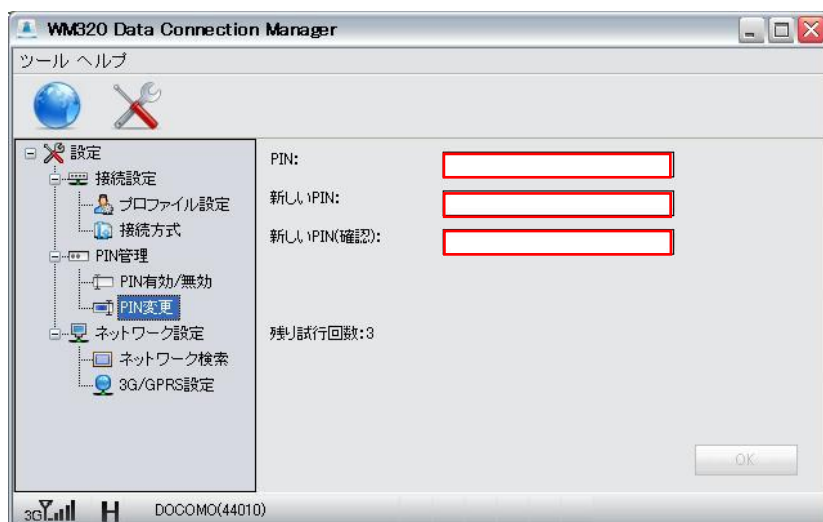

2. Input the original PIN.
3. Input new PIN.
4. Re-input for confirmation.
5. Click [OK].

4.7 Network Settings

The default setting is "Auto". Search automatically, and then connect the network.

If you select "manual", please follow the steps below.

4.7.1 Network Mode

1. Select [Network Mode].

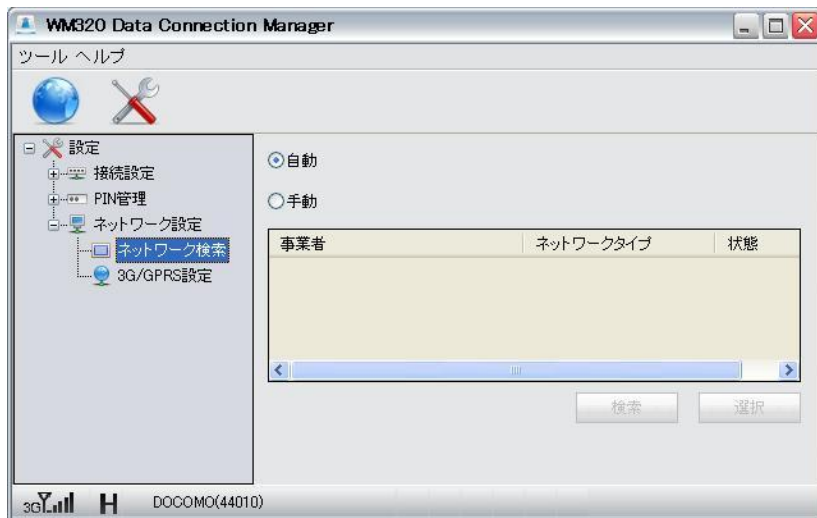

2. Select [Manual].
3. Click [Search].
After searching, the network found is displayed.
4. Select the network.
5. Click [Select].

4.7.2 3G/GPRS Settings

When search for a network, is able to specify the network preferentially.

1. Select [3G/GPRS Settings].

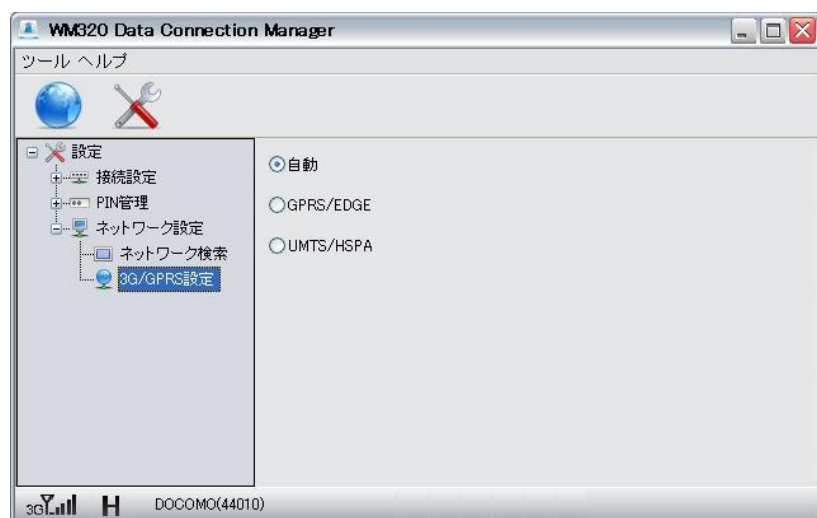

2. Select [Auto] or [GPRS/EDGE] or [UMTS/HSPA].

5. Appendix

5.1 Product Specifications

Product Name	WM320
External Dimensions	88.5mm(D) × 30.5mm(W) × 12.9mm(H)
Weight	Approximately 30g
Interface	USB 2.0
Power Consumption	<p>At maximum communication</p> <p>3G: Approximately 550mA or less</p> <p>GPRS: Approximately 360mA or less</p> <p>At general communication</p> <p>3G: Approximately 450mA or less</p> <p>GPRS: Approximately 300mA or less</p> <p>When in idling</p> <p>3G: Approximately 110mA or less</p> <p>GPRS: Approximately 110mA or less</p>
Operating Environment	<p>Temperature: -10~55°C</p> <p>Humidity: 0~85%</p>
Frequency Range	<p>W-CDMA 800MHz / 2100MHz</p> <p>GSM 850MHz / 900MHz / 1800MHz / 1900MHz</p>
Compliance Standards	<p>W-CDMA / HSDPA(DL 14.4Mbps) / HSUPA(UL 5.76Mbps)</p> <p>GSM / GPRS / EDGE</p> <p>The maximum speed is different, by connection method or area. In addition, because of a best-effort, due to line congestion and communication environment, speed is reduced or may be unable to communicate.</p>

5.2 Export Administration Regulations

This product and its accessories may be under coverage of the Export Administration Regulations of Japan ("Foreign Exchange and Foreign Trade Control Laws" and the related laws and regulations). And, they are also under coverage of Export Administration Regulations of the U.S. When exporting and reexporting this product and its accessories, take necessary procedures on your responsibility and expense. For details, contact Ministry of Economy, Trade and Industry of Japan or US Department.

5.3 Intellectual property rights

- *Windows, Windows 7, Windows Vista, Windows XP, Internet Explorer are trademarks or registered trademarks of the Microsoft Corporation in the U.S. and other country.
- *Macintosh, Mac, Mac OS are trademarks or registered trademarks of the Microsoft Corporation in the U.S. and other country.
- *The other company names and brand names described in this manual are the trademarks or registered trademarks of the respective companies.

5.4 FCC Regulations

This device complies with part 15 of the FCC Rules. Operation is subject to the following two conditions: (1) This device may not cause harmful interference, and (2) this device must accept any interference received, including interference that may cause undesired operation.

This device has been tested and found to comply with the limits for a Class B digital device, pursuant to Part 15 of the FCC Rules. These limits are designed to provide reasonable protection against harmful interference in a residential installation. This equipment generates, uses and can radiated radio frequency energy and, if not installed and used in accordance with the instructions, may cause harmful interference to radio communications. However, there is no guarantee that interference will not occur in a particular installation. If this equipment does cause harmful interference to radio or television reception, which can be determined by turning the equipment off and on, the user is encouraged to try to correct the interference by one or more of the following measures:

- Reorient or relocate the receiving antenna.
- Increase the separation between the equipment and receiver.
- Connect the equipment into an outlet on a circuit different from that to which the receiver is connected.
- Consult the dealer or an experienced radio/TV technician for help.

Changes or modifications not expressly approved by the party responsible for compliance could void the user's authority to operate the equipment.

The antenna(s) used for this transmitter must not be co-located or operating in conjunction with any other antenna or transmitter.

5.5 RF Exposure Information(SAR)

This device meets the government's requirements for exposure to radio waves.

This device is designed and manufactured not to exceed the emission limits for exposure to radio frequency (RF) energy set by the Federal Communications Commission of the U.S. Government.

The exposure standard for wireless devices employs a unit of measurement known as the Specific Absorption Rate, or SAR. The SAR limit set by the FCC is 1.6W/kg. *Tests for SAR are conducted using standard operating positions accepted by the FCC with the device transmitting at its highest certified power level in all tested frequency bands. Although the SAR is determined at the highest certified power level, the actual SAR level of the device while operating can be well below the maximum value. This is because the device is designed to operate at multiple power levels so as to use only the power required to reach the network. In general, the closer you are to a wireless base station, the lower the power output.

The highest SAR value for the model device as reported to the FCC when worn on the body, as described in this user guide, is 1.03 W/kg (Body-worn measurements differ among device models, depending upon available accessories and FCC requirements.)

While there may be differences between the SAR levels of various devices and at various positions, they all meet the government requirement.

The FCC has granted an Equipment Authorization for this model device with all reported SAR levels evaluated as in compliance with the FCC RF exposure guidelines. SAR information on this model device is on file with the FCC and can be found under the Display Grant section of www.fcc.gov/oet/ea/fccid after searching on FCC ID: WLPWM320.

For body worn operation, this device has been tested and meets the FCC RF exposure guidelines for use with an accessory that contains no metal and the positions the handset a minimum of 0.5 cm from the body. Use of other accessories may not ensure compliance with FCC RF exposure guidelines.

5.6 Declaration of Conformity

Model: WM320

Intended use: LTE USB Modem

Complies with the essential requirements of Article 3 of the R&TTE 1999/5/EC Directive, if used for its intended use and that the following standards have been applied:

1. **Health (Article 3.1(a) of the R&TTE Directive)**
 - EN 62311 :2008/EN 62209-2:2010
2. **Safety (Article 3.1(a) of the R&TTE Directive)**
 - Applied Standard(s):
 - EN 60950-1:2006+A11:2009
3. **Electromagnetic compatibility (Article 3.1 (b) of the R&TTE Directive)**
 - Applied Standard(s):
 - EN 301 489-1 V1.9.2/-7 V1.3.1/-24 V1.5.1
4. **Radio frequency spectrum usage (Article 3.2 of the R&TTE Directive)**
 - Applied Standard(s):
 - EN 301 511 V9.0.2
 - EN 301 908-1 V4.2.1/ -2 V5.2.1

All the reports of the applied standards have the Positive Opinion of Notified Body:

PHONEIX TESTLAB, Königswinkel 10 D-32825 Blomberg, Germany

Identification mark: 0700 (Notified Body) CE

CE 0700

5.7 WEEE/RoHS Compliance Statement

This symbol on the product or its packaging indicates that this product must not be disposed of with other waste. Instead, it is your responsibility to dispose of your waste equipment by handing it over to a designated collection point for the recycling of waste electrical and electronic equipment. The separate collection and recycling of your waste equipment at the time of disposal will help conserve natural resources and ensure that it is recycled in a manner that protects human health and the environment. For more information about where you can drop off your consumer waste equipment for recycling, please contact your local city recycling office or the dealer from whom you originally purchased the product.



