



Operating instructions

WARNINGS OVERLEAF



1 Charging Solar Power plant (deluxe version only) - 8 hrs in direct sunlight to fully charge before use. 16 hrs for best performance and it is recommended to recharge any time the unit is unused.
8 - 16 HRS

2 Remote control preparation.
1. Screw antenna in place.
2. Charge for 30 seconds each time you refuel the car with hydrogen.
3 minutes or more play time

3 Car turbo preparation.
1. Switch Car to 'ON'
2. Connect power supply to car and charge for 30 sec.
3. Unplug power supply then switch car to 'OFF'.
ON OFF WARM UP
ON
30 seconds
ON OFF WARM UP
OFF

4 Standard refueling 1. Carefully fill with purified/distilled water to a level covering 'outlet hole'. Clean tap water can be used, but is not recommended as it may reduce the lifetime of the Refueling Station. Avoid over filling.

5 Standard refueling 2. Plug in a fully charged Solar Power Plant or the power plug

6 Standard refueling 3. Switch 'on' unit. Press 'restart' button. LED will flash for 4-7 minutes until 1 full tank of hydrogen is produced. When the plunger stops rising the tank is full. Tip: for best performance wait with playing for 1 minute after tank is full.
Press

7 Standard refueling 4. Refuel station preparation - Important: check the water window. If there's water inside, go to step 15 to drain water first. If there is no water inside, proceed directly to next step.
Go to step 8
Go to step 15

8 Standard refueling 5.
1. Press purge valve for 1 seconds and release.
2. Push hydrogen input valve all the way in and rotate clockwise until it locks.
2
1

9 Standard refueling 6.
1. Locate marking on gas window and press plunger to this level.
2. The refueling station now automatically refills as the plunger rises.

10 Standard refueling 7.
On the car, press purge valve until balloon is empty.
Press
Release

11 Standard refueling 8. Fuel up car.
1. Switch car 'OFF'.
2. Press plunger all the way down to fill the car's fuel tank.
3. Unplug when fully fueled.

12 Standard refueling 9. If the car is unused for more than 1 hour or you want to ensure optimal car performance, follow these WARM UP steps. If not, go to next step directly.
1. Switch car to 'WARM UP'.
2. LED flashes until all the hydrogen fuel is used.
3. Switch car 'OFF'.
4. Return to the step 6.
FILL TANK
WARM UP
LED FLASH
EMPTY
OFF
ON OFF WARM UP
ON OFF WARM UP

13
1. Switch car 'ON' and wait 3 seconds before playing.
2. Ensure car antenna is straight and vertical.
3. Control car with remote control.
ON OFF WARM UP

14
1. Press turbo together with forward or backward for extra speed.
Left / Right
Forward
Reverse
Turbo

15 Removing Water from water window.
1. Ensure tank is full.
2. Open rubber cap.
3. Press down plunger all the way to drain the water out.
4. Close rubber cap firmly.
5. Wipe away water.
Water inside
Close
Open

Remote control has up to 10m range outdoors. The area should be Smooth, Flat, Clean, Dry, Safe. It is recommended to limit play sessions to a maximum of 2hrs. Tip: If control range is reduced, recharge the remote control. (step 2)

Storage.
1. Unplug power after play and remove all water from unit.

Clean all components with a soft dry cloth. (not included)

Store safely in cool dry place. Do not stack.

Operation Notes:
Hydrogen Refueling station - Safety timer: During refueling, a green LED flashes. The refueling station is designed to deliver 8 full cycles before automatically triggering a safety timer. Hydrogen production is suspended after 8 cycles. For 2 minutes the LED flashes at half speed while the refueling station enters sleep mode. After 2 minutes the user can press the restart button to restart unit. Refueling sessions exceeding 10 minutes in length also trigger the 2 minute safety timer to prevent unsafe use. If the LED is not flashing, ensure the refueling station is supplied with power, switched on and then press the restart button.
Solar Panel (Deluxe Version Only) - Place solar panel in direct exposure to sunlight where it is safe to leave for several hours undisturbed. After recharging the solar panel may be hot to touch. Use gloves to pick it up and allow to cool for 30 minutes before using.



STRONGLY RECOMMEND DISTILLED WATER ONLY FOR THE REFUELING STATION!



Trouble Shooting, Care Instructions and Safety Warnings

H2go car

Purging Car

By pressing the built in purge valve, the user can release any atmospheric gases inside the car's fuel system when the fuel tank is empty. You can also use a small quantity of hydrogen to do another purge and this ensures the car's fuel system is filled only with pure hydrogen fuel for optimal performance. It is recommended to perform both purges when ever purging is necessary.

Car is moving slower than before or for a shorter time or stopped without using all fuel

Purge car fuel tank and perform a car warm-up before use. Ensure play surface is flat and clean. Ensure the car's fuel tank is full. Turn car's switch to 'off' and then 'on' again.

Having trouble steering

Clean away any debris restricting front steering with tweezers.

The turbo speed is slow

Charge car again for 30 seconds.

I left the car's on/off switch at the ON position or the WARM-UP position for extended period of time

This does no harm the car. Move switch to 'OFF' position. Warm-up car before next play.

The balloon won't fill

Clear any blockages from refuel station output valve, car input valve. Make sure output valve is correctly and fully inserted. Ensure refueling station rubber plug is securely in place.

The car's input valve is blocked

Clear blockages with tweezers. Do not insert any sharp implements into the valve as this will cause irreversible damage to the unit.

Car quickly becomes out of control range

Ensure car antenna is straight and vertical. Ensure the antenna is properly installed. There may be interference between the car and the remote control like glass or walls. Ensure remote control is fully charged.

Water has not been removed from refueling station properly and has gone into the car during refueling

Purge the car and warm up car. Properly empty water from the refueling station. Or switch off car and store it for a day before using again.

Refueling station

Refueling station not working

The refueling station has a 2 minute sleep mode after 8 production cycles preventing users from abusing the unit. Switch off the unit and unplug it from power supply. Rest it for 2 minutes and follow instructions to prepare refueling station for use. The plunger may be sticking so manually pull up the plunger a little bit and press down again. Check unit is on, all connections and power supply are properly connected or fully charged.

Refueling station not working

If LED is not flashing but unit is properly connected, a) the sleep mode has stopped and user can press restart button immediately, or b) the timer has reached 10 minutes during hydrogen production, and user again does not have to wait for 2 minutes (sleep mode), but can restart by pressing 'restart' button directly

Why are there bubbles coming out?

This means the refueling station is functioning properly. The Electrolyser splits water into its component parts of oxygen and hydrogen. Oxygen bubbles should come out of the top hole in the water tank while the hydrogen is harnessed in to the syringe ready to fuel the car.

Bubbles are coming out the bottom hole and not the top

Use a cotton bud to block the bottom hole until the bubbles comes out from the top again. Turn refueling station power switch OFF, wait for 3 minutes and turn On.

No bubbles are coming out

Switch off the unit and unplug it from power supply. Rest it for 3 minutes and follow instructions to prepare refueling station for use. If you are using the solar power plant, ensure the unit is fully charged before use. Ensure that adequate water is in the refueling station.

The plunger does not move but bubbles are coming out

The plunger may need loosening. Manually pull up the plunger a little bit and press down again. Do not pull the plunger for prolonged periods as this may damage the unit. Ensure refueling station rubber plug is securely in place.

Hydrogen production is very slow

Ensure the refueling station is filled with water and properly connected to power supply. Manually pull up the plunger a little bit and press down again. There may be not enough water in the electrolyser, check if the water tank is completely filled with water. Switch off unit and wait for 10 minutes to let the electrolyser get humidified. Switch 'on' unit before use.

The light stopped flashing

Ensure the refueling station is switched 'on'. Ensure the unit is plugged in properly. Wait 3 minutes and press restart button.

The unit won't restart or stopped half way through

Open the refueling station rubber plug and press the plunger all the way down. Close the rubber plug. Ensure the refueling station is switched 'on'. Ensure the unit is plugged in properly. Wait 3 minutes and press restart button.

I spilt water all over the refueling station

Warning: Water and electricity can cause electric shock. Immediately switch off and disconnect from power supply. Dry the wet components with a soft dry cloth immediately. Pay special attention to any water residing in recesses or gaps. Pour out water inside the unit through slots at the bottom of refueling station. Rest unit for 1 hour before use.

There's water inside

Warning: Water and electricity can cause electric shock. Immediately switch off and disconnect from power supply. Dry the wet components with a soft dry cloth immediately. Pay special attention to any water residing in recesses or gaps. Pour out water inside the unit through slots at the bottom of refueling station. Rest unit for 1 hour. You may place the unit in the sun until the water evaporate from inside the unit. Use gloves to move the unit out of the sun and to a cool dry place. Leave it for 30 minutes before use.

I put something other than water into the refueling station

Warning: Any substance other than water inside the refueling station will result in permanent failure of the unit. Only water can be used in this unit. Placing any other substance inside is strictly prohibited.

How do I empty the system?

Hold the refueling station with both hands beside a sink or basin. Pour the water out of the water tank slowly from the front side of the unit. Hold it upside down until all of the water has run out of the water tank. Wipe away dry before storage. Any water remaining inside the tubes are safe and does not need to be removed.

It's a really cold / hot day and the unit is really slow

H2go is designed to operate between 10 degrees Celsius and 50 degrees. Use H2go only when within this operating specification.

I left the unit in the sun, is it still safe to use?

The unit will not experience any harm but will be hot to touch. Be very careful and use gloves to move the unit out of the sun and to a cool dry place. Leave it for 30 minutes before use.

Remote control unit

The light is getting dim and the car doesn't respond well

Ensure the remote control is fully charged. Ensure antenna is fully extended.

AC/DC adaptor

Always keep this unit dry and clean. Wipe with a soft dry cloth and store in a cool dry place. Do not use any other power source other than the transformer or Solar Power Plant provided with this product.

Solar Panel (Deluxe version only or sold separately)

The solar panel cannot fill the refueling station in 10 minutes.

Recharge the solar panel in direct sunlight before use.

Solar Power Plant accessory

It seems to supply no power

The stored electricity may be fully discharge from use. Place under direct sun light for 8-16hrs to fully charge unit.

The Solar plant was left to charge for longer than suggested

Always follow usage instructions for H2go. Do not exceed the recommended charging time for the solar plant. Be very careful and use gloves to move the unit out of the sun and to a cool dry place. Leave it for 30 minutes before wiping clean. If charging time is exceeded, remove the solar plant from direct sunlight. The unit is fully charged and ready for use.

TAKING CARE OF YOUR CAR

Safe storage.

Switch all units to off position before storage.

Unplug all units before storage.

Empty the unit of all hydrogen and water before storage.

Lay unit flat in a dedicated space.

The unit should be stored safely away in a cool dry place.

Do not stack the unit, car or remote control.

It is ok to store Solar Plant with charge but be sure to recharge plant immediately before use.

How to care for your car and H2go components

Cleaning

Your H2go car is an advanced piece of toy engineering and so you will need to take good care of it to ensure you get many smooth runs out of it. Always ensure the units are switched 'OFF' and unplugged from the mains power supply before commencing any cleaning. Wipe the car and all other units clean with a soft damp cloth. Take care to dry the units thoroughly by wiping away all excess water.

When cleaning the refueling station, make sure to clean both top and bottom of the unit. Wipe away any excess water before storage. It is a good idea to leave the unit to air dry after cleaning for 30 minutes before storage. The car's fuel cell needs uninhibited ventilation. If you find any stones or debris blocking the fuel cell ventilation, remove them carefully taking care not to poke anything into the fuel cell. Remove any debris trapped in the wheel arches with care using tweezers. Keep all power plugs, outlet valves and input valves clean and free from obstruction for optimal performance.

GENERAL WARNINGS

General Warnings:

"The instruction sheet must be retained since it contains important information."

This product is intended only for use by person 8 years old and up, and only under the supervision of an adult who has read and understood the instructions provided in the kits user manual. Do not use the Refueling Station for any other purposes than refueling the H2Go car as instructed in this user manual. Do not turn on Refueling Station without adding water as instructed in this user manual. Failure to do so repeatedly may result in damage to the refueling station. Do not submerge the Refueling Station in water; only fill the Refueling Station with water as instructed in this user manual. Keep the Refueling Station and H2go car away from flames or fires. Read the user manual carefully before use and always have it ready for reference.

The hydrogen generation process is controlled by the electrical system , the small amount of hydrogen produced every time will not have any ignition risks. The Refueling station can't be used for any other purposes.

In addition the following safety rules were present:

Warning: please read carefully before starting.

Do not attempt to use any part, item or components provided in this product for any other purpose than what is instructed in this manual. Do not attempt to disassemble any part, item or component in this kit.

I) Small parts warnings - Choking Hazard.

Not for children under 3 years.

II) Cleaning instruction

See 'How to care for your car and H2go components.

III) Transformer warnings:

Transformer information

The toy is not intended for children under 3 years old;

The toy must only be used with the transformer supplied;

The transformer is not a toy;

Toys liable to be cleaned with liquids are to be disconnected from the transformer before.

IV) WEEE Directive.

Processing of electric and electronic equipment at the end of their service life (applicable in member countries of the European Union and other European countries operating a selective waste collection system). This symbol, affixed to the product or its packaging, indicates that the product must not be processed with household waste. It must be brought to an electric and electronic waste collection point for recycling and disposal. By ensuring the appropriate disposal of this product you also help in preventing potentially negative consequences for the environment and human health. The recycling of materials helps preserve our natural resources. For further information regarding the recycling of this product, please contact your municipality, local waste disposal centre. During the replacement of your used batteries, we request that you follow the current regulations as to their elimination. We thank you for depositing them in a location foreseen for that purpose to ensure their elimination in a sure manner and with respect for the environment.

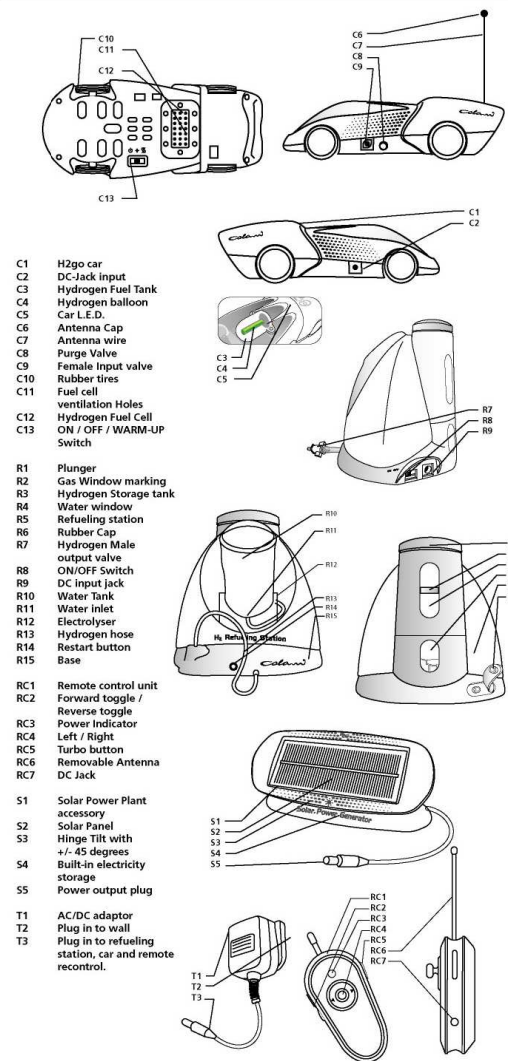

Warning: Changes or modifications to this unit not expressly approved by the party responsible for compliance could void the user's authority to operate the equipment.

NOTE: This equipment has been tested and found to comply with the limits for a Class B digital device, pursuant to Part 15 of the FCC Rules. These limits are designed to provide reasonable protection against harmful interference in a residential installation. This equipment generates, uses and can radiate radio frequency energy and, if not installed and used in accordance with the instructions, may cause harmful interference to radio communications.

However, there is no guarantee that interference will not occur in a particular installation. If this equipment does cause harmful interference to radio or television reception, which can be determined by turning the equipment off and on, the user is encouraged to try to correct the interference by one or more of the following measures:

- ☐ Reorient or relocate the receiving antenna.
- ☐ Increase the separation between the equipment and receiver.
- ☐ Connect the equipment into an outlet on a circuit different from that to which the receiver is connected.
- ☐ Consult the dealer or an experienced radio/TV technician for help.

Supplementary instruction sheet with min. letter height : 1.5mm