

Technology at Work.®

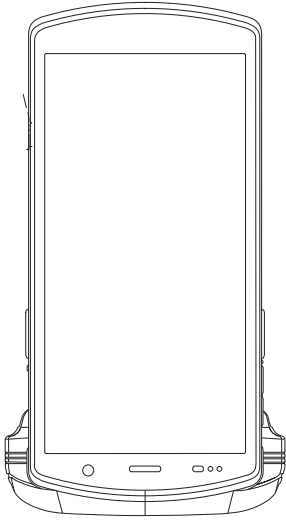

Quick Start Guide
XR2 Series™
part of
JANAM

Battery Warning

CAUTION

**IF MISUSED OR MISTREATED THE BATTERY MAY PRESENT A RISK OF FIRE OR CHEMICAL BURN.
RISK OF EXPLOSION IF BATTERY IS REPLACED BY AN INCORRECT TYPE.
DISPOSE OF USED BATTERIES ACCORDING TO THE INSTRUCTIONS.**

BATTERY SAFETY GUIDELINES.

Use only Janam XR2 Series batteries and recharge batteries using only Janam approved charging accessories. Observe the following guidelines for safe use of Li-Ion batteries:

1. Do not expose the battery to excessive heat or cold. Do not short-circuit. Do not incinerate.
2. To avoid risk of fire, burn or damage to your battery, do not allow a metal object to touch battery contacts.
3. Do not disassemble the battery. There are no user serviceable parts inside.
4. If battery leakage is observed, avoid any contact with affected area and properly dispose of the battery.
5. If you come in contact with battery leakage, rinse exposed area with soap and water. If it contacts the eye, flush the eye with water for 15 minutes and seek medical attention.
6. Dispose of used battery promptly. Keep away from children. Do not disassemble or dispose of in fire.
7. When discarding a battery, contact your local waste disposal provider to understand local restrictions for disposal or recycling of batteries.

BATTERY CHARGER SAFETY GUIDELINES.

1. Do not use the equipment in or near areas in which sparks are likely or possible.
2. Do not let equipment's metal contacts and electrical sockets come in contact with metal objects.
3. For indoor use only. Do not expose the equipment to rain or any liquids.
4. Do not use or store the equipment in direct sunlight or in areas that are prone to get hot such as in a parked vehicle, near a heat duct or close to other heat sources.
5. Keep equipment's metal contacts and electrical sockets free from debris that could obstruct charging or could cause a short circuit.

XR2 Series Quick Start Guide

Copyright 2024 Janam Technologies (part of HID). All rights reserved.

XR2 Series, Janam and the Janam logo are trademarks of Janam Technologies (part of HID). Other product and brand names may be trademarks or registered trademarks of their respective owners.

Janam Technologies assumes no responsibility for any damage or loss resulting from the use of this guide. Janam Technologies assumes no responsibility for any loss or claims by third parties which may arise through the use of this product. Janam Technologies assumes no responsibility for any damage or loss caused by deletion of data as a result of malfunction, dead battery or repairs. To protect against data loss, be sure to make backup copies (on other media) of all important data.

Follow all usage, charging and maintenance guidelines in the Product User Guide. If you have questions, contact Janam. For a copy of the Product User Guide, visit www.janam.com.

Important: Please read the End User License Agreement for this product before using the device or the accompanying software program(s). Using the device or any part of the software indicates that you accept the terms of the End User License Agreement.

Content and Additional Resources

To help you get started with your XR2 Series mobile computer, this guide features:

- Hardware Overview
- Getting Started
 - A. Install the Battery
 - B. Charge the Battery
 - C. Remove the Battery + Access TF and SIM Card Slots
- Battery warnings and safety guidelines.

Contents of this guide are subject to change. For the most current version of this guide and additional product details, visit www.janam.com.

For software updates and information, visit www.janam.com/product-zone.

Hardware Overview

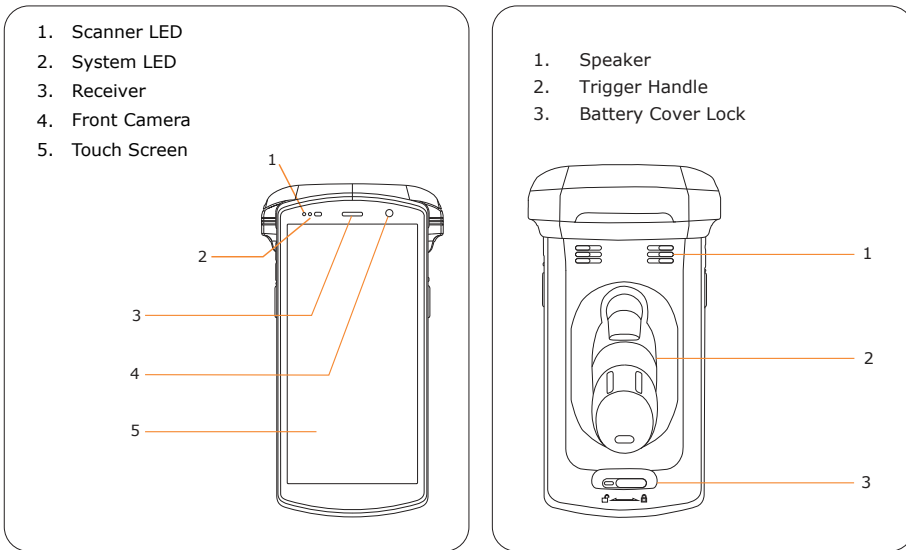

Page 3

Getting Started

A. INSTALLING THE BATTERY

1. To access the battery compartment, move both tabs on the battery cover to the "unlock" position and pull the cover away from the device.
2. Position the battery so that the text "Insert this direction." is on the left side and snap into place.
3. Replace the battery cover by positioning the bottom prongs and snapping cover into place.
4. Move both tabs on the battery cover to the "lock" position.

B. CHARGING THE BATTERY

Important Note: The main battery charges the backup battery in the XR2 Series device. When discharged, the backup battery requires approx. 1.5 hours to recharge.

To charge the battery using the included **AC/DC Power Adapter Kit**:

1. Connect the AC/DC adapter to XR2 Series.
2. Plug in the AC/DC adapter. Use only easily accessible wall sockets that are easily reached with the length of supplied power cable.

To charge the battery using a **Cradle Kit**:

1. Connect the power supply to the cradle, then connect the line cord to the power supply.
2. Plug in the power supply. Use only easily accessible wall sockets that are easily reached with the length of supplied power cable.
3. Place the device in cradle. The LED on the device will illuminate to confirm connection.
4. The battery is fully charged in approximately 2.5 hours.
5. To charge a battery in the spare battery well, insert the battery into the well top down (connectors on the battery should face downward and to the back of the cradle) and gently press down. The LED light on the cradle will illuminate to confirm connection.

Page 5

Hardware Overview

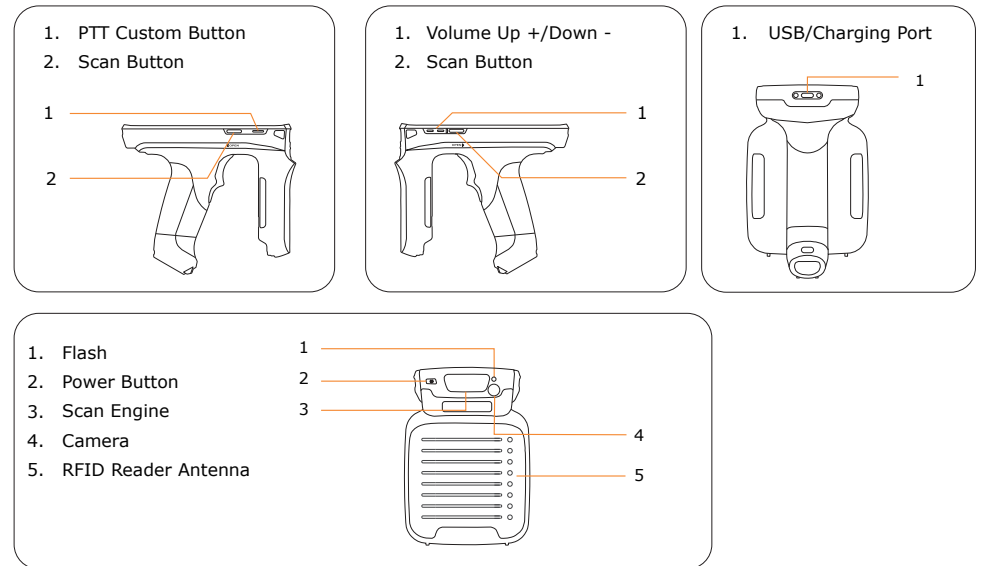

Page 4

Janam Technologies
Add: 999 South Oyster Bay Rd Suite 409 Bethpage,
NY 11714

Getting Started (continued)

To charge the **Backup Battery**:

1. Navigate to the Home Screen -> App drawer -> Settings -> Battery.
2. Select "Backup Battery Charge" option.

C. ACCESSING SIM CARD SLOTS and TF CARD SLOT

1. Remove the back cover.
2. Remove battery from XR2.
3. Lift the silver tab on the top left corner to remove the SIM/TF card holder.
4. Place the SIM card(s) and TF card into the respective slots and replace the card holder.
5. Replace the battery and battery cover.

Page 6

XR2 Series Series Quick Start Guide

CE DOC

Hereby, Janam Technologies LLC declares that the radio equipment type XR2 is in compliance with Directive 2014/53/EU. The full text of the EU declaration of conformity is available at the following internet address: www.janam.com.

RF exposure information:

The SAR limit of EU is 2.0W/kg(Head&body), 4.0W/kg(Limbs) averaged over one gram of tissue. Device has also been tested against this SAR limit.

FCC regulatory conformance

FCC ID:UTWXR2WA

This device complies with Part 15 of the FCC Rules. Operation is subject to the following two conditions:

- (1) This device may not cause harmful interference.
- (2) This device must accept any interference received, including interference that may cause undesired operation.

NOTE: This equipment has been tested and found to comply with the limits for a Class B digital device, pursuant to part 15 of the FCC Rules. These limits are designed to provide reasonable protection against harmful interference in a residential installation.

This equipment generates uses and can radiate radio frequency energy and, if not installed and used in accordance with the instructions, may cause harmful interference to radio communications. However, there is no guarantee that interference will not occur in a particular installation. If this equipment does cause harmful interference to radio or television reception, which can be determined by turning the equipment off and on, the user is encouraged to try to correct the interference by one or more of the following measures:

- Reorient or relocate the receiving antenna.
- Increase the separation between the equipment and receiver.
- Connect the equipment into an outlet on a circuit different from that to which the receiver is connected.
- Consult the dealer or an experienced radio/TV technician for help

NOTE: Unauthorized modifications could void the user' s authority to operate the equipment.

RF Exposure

The SAR limit of IC is 1.6W/kg(Head&Body-worn&Hotspot), 4.0W/kg(Extremity) averaged over one gram of tissue. Device has also been tested against this SAR limit.

IC warning

IC:6914A-XR2WA

This device complies with Industry Canada license-exempt RSS standard(s).

Operation is subject to the following two conditions:

(1) this device may not cause harmful interference, and (2) this device must accept any interference received, including interference that may cause undesired operation .

Le présent appareil est conforme aux CNR d'Industrie Canada applicables aux appareils radio exempts de licence. L'exploitation est autorisée aux deux conditions suivantes : (1) l'appareil ne doit pas produire de brouillage, et (2) l'utilisateur de l'appareil doit accepter tout brouillage radioélectrique subi, même si le brouillage est susceptible d'en compromettre le fonctionnement.

This Class B digital apparatus complies with Canadian ICES-003.

Cet appareil numérique de la classe B est conforme à la norme NMB-003 du Canada.

RF Exposure

The SAR limit of IC is 1.6W/kg(Head&Body-worn&Hotspot), 4.0W/kg(Extremity) averaged over one gram of tissue. Device has also been tested against this SAR limit.

The 5150 to 5350 MHz frequency range is restricted to indoor use only in: AT, BE, BG, CH, CY,CZ, DE, DK, EE, EL, ES, FI, FR, HR, HU, IE, IS, IT, LI, LT, LU, LV, MT, NL, NO, PL, PT, RO, SE, SI, SK, TR, UK.