



User Guide

For Loc8tor models

Loc8tor

- 1 Loc8tor Handheld
- 2 Mini Homing Tags
- 1 Key ring loop / adhesive pack
- Batteries included

Loc8tor Plus

- 1 Loc8tor Plus Handheld
- 3 Mini Homing Tags
- 1 Panic Homing Tag
- 2 Key ring loop / adhesive packs
- Batteries included

Award



INTRODUCTION

Welcome to Loc8tor, the great new product that helps you find your mislaid items and can even stop you losing them in the first place*.

We've designed the Loc8tor to be versatile and easy to use, whether at home, out and about or on business. Please take a few minutes to read through this User Guide to help you get the most out of your purchase.

Loc8tor has been manufactured to quality standards to run trouble free and comes supplied with a 12 month warranty. Please visit our website at www.loc8tor.com/support for additional product information, contact details and frequently asked questions.

We'd love to hear from you, what you like about Loc8tor and any suggestions you have to improve it. Visit www.loc8tor.com/feedback to have your say.

We hope you enjoy your new purchase and can now rest at ease, avoiding those frustrating moments of mislaying your important items.

With best wishes.



Anthony Richards
Managing Director

***Loc8tor Plus** - Comes supplied with Locate and Alert modes. Helps you find misplaced items and allows invisible safety zones to be set around you to stop items going astray.

Loc8tor - Comes supplied with Locate mode. Helps you find misplaced items.
www.loc8tor.com/support

CONTENTS

	<i>Page</i>
Quick Key Guide	3
Setting Up Your Loc8tor	4
Locate Mode - Find a mislaid item	5
Alert Mode* - Helps prevent items getting lost	6
Alert Activated	7
Mini Homing & Panic Homing Tags	8
Icons and Abbreviations	8
Menu Functions	9
Batteries	10
General Care	10
Changes	11
Warranty	11
Please Note	
	Back cover

QUICK KEY GUIDE

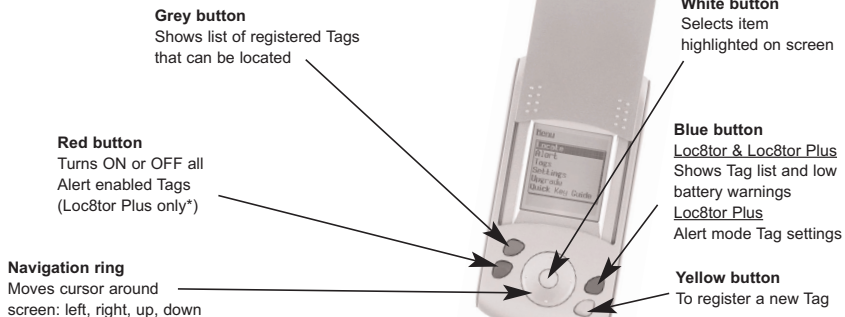

SETTING UP YOUR LOC8TOR

1. Insert batteries (2 x AAA)

With the Loc8tor buttons facing you push forwards and remove right hand side panel. Insert batteries (See diagram in battery compartment for correct insertion) and replace side panel.

Loc8tor has no ON or OFF button. To use press any button. It will automatically turn ON.



1.

2. Register Tags

- Pull out white strip in Tag to activate batteries
- Tag beeps and red light flashes once
- Place Tag next to Handheld making sure all other Tags have been moved more than an arms length away
- Press Yellow register button on the Handheld
- Follow on-screen instructions
- Repeat process for each new Tag

3. Naming your Tags

- Tags can be personalised with a name of your choice up to 10 characters long
- Use navigation ring to highlight letters
- Press White button to select
- Press OK to finish



3.

4. Attach Tags

Depending on use Tags can be attached with adhesive strips, key ring loop or left loose.

Adhesive strips

Best used when attaching to a hard, flat surface. Peel off backing to attach. Sticky tabs are not permanent but increase their bond with time. Ideally leave for a minimum of 10 minutes. Strongest bond after 24 hours. To remove insert flat tool under Tag and gently twist / prise off.

Key ring loop

Best used to attach Tag to items such as key ring, bags and belt loop. Push loop through the Tag hole and then pull ring through the loop.



4.

LOCATE MODE - FIND A MISLAID ITEM

LOST

- Slide up lid and press Grey button (top left) to see list of Tags that can be located
 - Scroll down and select item to be found with White button
 - Scan area slowly turning full 360° circle
 - Once circle completed go back to direction of strongest audio and visual signal
 - Walk in this direction - As you get nearer audio pitch and frequency of beeps increase, lines on screen extend and signal strength numbers increase (1)
 - If in doubt, repeat 360° circle
 - When signal strength lines get close to the top of the screen Tag is close by
 - Try pressing select button on Handheld to Mute and listen for the Tag beep
- When you are almost on top of Tag, screen changes to Zooming in mode to guide you right in (2)
- Select and press STOP when the item is found

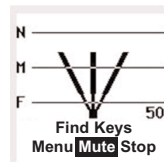

(1)

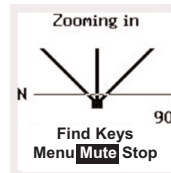

(2)

FOUND

TIPS

- Place the Tag on a surface and practice locating a few times to get a feel for how it works
- If you are ever unsure which direction to go in slowly repeat full 360° circle and then go in direction with the strongest signal strength
- Strongest signal is displayed when Handheld is pointing directly at Tag. Also try moving Handheld up and down as Tag could be upstairs or downstairs
- If you are close to a wall whilst getting a strong signal check the room next door
- If no signal is displayed try moving position to a different area



ALERT MODE - HELPS PREVENT ITEMS GETTING LOST (Loc8tor Plus Model)

The Blue button (Tag Settings screen) controls your Alert settings. It enables you to decide what mode each Tag is in, Locate or Alert, and to set the distance for your required safety zone (Near, Medium or Far) for each Tag. Once you're happy with your settings simply press the Red button to activate Alert. All Tags with a (✓) will now automatically be in Alert mode.

Setting up Alert (Blue Button - Tag Settings Screen)

- Attach Tag in or on item to be protected
- Press Blue button for Tag Settings screen. A list of all your Tags will be displayed

Selecting the Safety Range (1)

- Scroll to the right hand column (under R) in line with selected Tag
- Use White button to select distance between Tag and your Handheld
N = Near, M = Medium, F = Far

**Set Tag Mode**

- Scroll to column with dash (-) next to the Tag name
- Press White button to make Tag alertable (✓)

Repeat this process for each Tag

Using Alert Mode

- Press Red button to turn Alert mode ON or OFF for all Tags with (✓) in Tag settings screen
- Tag beeps to confirm Alert mode is ON.

Your Tags are now in Alert. Should any Tag set in Alert mode go out of the preset safety zone the Loc8tor Plus will vibrate, set off an alarm and advise which Tag has gone astray

An **A** will appear in the bottom right hand corner when the Alert mode is on

! Important Alert mode usability statement ! - A constant link between Handheld and Tag ensures you are notified immediately when Tags go out of range. However if used continuously will significantly reduce battery life. When not needed turn Alert mode off using Red button.