

User Manual

TD-9016A

JS1830

JS1832

CS10

Important safety information

Your Wi-Fi & Bluetooth speaker should be treated with care. The information below has been provided in the interest of safety and will help you to enjoy this product and the benefits it brings for many years.

1. Read these instructions – All the safety and operating instructions should be read before this product is operated.
2. Keep these instructions – The safety and operating instructions should be retained for future reference.
3. Heed all warnings – All warnings on the appliance and in the operating instructions should be adhered to.
4. Follow all instructions – All operating and use instructions should be followed.
5. WARNING : To reduce the risk of fire or electric shock, do not expose this apparatus to rain or moisture.
6. Clean only with a dry cloth.
7. Do not block any ventilation openings. Install in accordance with the manufacturer's instructions.
8. Do not install near any heat sources such as radiators, heat registers, stoves, or other apparatus (including amplifiers) that produce heat.
9. Do not defeat the safety purpose of the polarized or grounding-type plug. A polarized plug has two blades with one wider than the other. A grounding type plug has two blades and a third grounding prong. The wide blade or the third prong are provided for your safety. If the provided plug does not fit into your outlet, consult an electrician for replacement of the obsolete outlet.
10. Protect the power cord from being walked on or pinched particularly at plugs, convenience receptacles, and the point where they exit from the apparatus.
11. Only use attachments/accessories specified by the manufacturer.
12. Use only with the cart, stand, tripod, bracket, or table specified by the manufacturer, or sold with the apparatus. When a cart is used, use caution when moving the cart/apparatus combination to avoid injury from tip-over.



13. Unplug this apparatus during lightning storms or when unused for long periods of time.
14. Refer all servicing to qualified service personnel. Servicing is required when the apparatus has been damaged in any way, such as power-supply cord or plug is

damaged, liquid has been spilled or objects have fallen into the apparatus, the apparatus has been exposed to rain or moisture, does not operate normally, or has been dropped.

15. Operate this product only from the type of power source indicated on the back panel. For products using an external power supply, use an exact replacement if lost or damaged. For products operating from battery power, refer to the user manual.

16. Unplug this product from the wall outlet and refer servicing to qualified service personnel under the following conditions:

- a. When the power supply cord or plug is damaged.
- b. If liquid has been spilled or objects have fallen into the product.
- c. If the product has been exposed to water or rain.
- d. If the product does not operate normally by following the operating instructions.
- e. If the product has been dropped or damaged in any way.
- f. When the product exhibits a distinctive change in performance.

17. Keep this product a safe distance away from naked flame, such as a lit candle.

18. Apparatus shall not be exposed to dripping or splashing and no objects filled with liquids, such as vases, shall be placed on the apparatus.

19. When replacement parts are required, be sure your service technician has used replacement parts specified by the manufacturer or have the same characteristics as the original part. Unauthorized substitutions may result in fire, electric shock, or other hazards.

20. Upon completion of any service, ask the service technician to perform safety checks to confirm the product is in proper operating condition.

21. The recommended operating temperature range is 5°C to 40°C (41°F – 104°F).

22. WARNING : The mains are not disconnected in the off position, but the circuits are de-powered.

23. The power cord plug serves as the disconnect device and should remain readily accessible.

24. The maximum height above sea level is 2000m.

25. The maximum operating ambient is 45°C. (may to select 35°C or 40°C.)

FCC Statement

This device complies with FCC radiation exposure limits set forth for an uncontrolled environment. This

device complies with Part 15 of the FCC Rules. Operation is subject to the following two conditions:

this device may not cause harmful interference, and (2) this device must accept any

interference received, including interference that may cause undesired operation. This equipment has been tested and found to comply with the limits for a Class B digital device, pursuant to Part 15 of the FCC rules. These limits are designed to provide reasonable protection against harmful interference in a residential installation. This equipment generates, uses and can radiate radio frequency energy and, if not installed and used in accordance with the instructions, may cause harmful interference to radio communications. However there is no guarantee that interference will not occur in a particular installation. If this equipment does cause harmful interference to radio or television reception, which can be determined by turning the equipment of and on, the user is encouraged to try to correct the interference by one or more of the following measures:

- Reorient or relocate the receiving antenna
- Increase the separation between the equipment and receiver
- Connect the equipment into an outlet on a circuit different from that to which the receiver is connected
- Consult the dealer or an experienced radio/TV technician for help.

Only operate the device in accordance with the instructions supplied. This device complies with FCC

radiation exposure limits set forth for an uncontrolled environment. In order to avoid the possibility of **P**roduct.

FCC Radiation Exposure Statement

This device complies with FCC radiation exposure limits set forth for an uncontrolled environment and it also complies with Part 15 of the FCC RF Rules. This equipment must be installed and operated in accordance with provided instructions and the antenna(s) used for this transmitter must be installed to provide a separation distance of at least 20 cm from all persons and must not be co-located or operating in conjunction with any other antenna or transmitter. End-users and installers must be provided with antenna installation instructions and consider removing the no-collocation statement.

This device complies with Part 15 of the FCC Rules. Operation is subject to the following two conditions:

- (1) this device may not cause harmful interference, and
- (2) this device must accept any interference received, including interference that may cause undesired operation.

Caution!

Any changes or modifications not expressly approved by the party responsible for compliance could void the user's authority to operate the equipment.

IC Statement

This device contains licence-exempt transmitter(s)/receiver(s) that comply with Innovation, Science and Economic Development Canada's licence-exempt RSS(s). Operation is subject to the following two conditions:

- (1) This device may not cause interference.
- (2) This device must accept any interference, including interference that may cause undesired operation of the device.

L'émetteur/récepteur exempt de licence contenu dans le présent appareil est conforme aux CNR d'Innovation, Sciences et Développement économique Canada applicables aux appareils radio exempts de licence. L'exploitation est autorisée aux deux conditions suivantes :

- 1) L'appareil ne doit pas produire de brouillage;
- 2) L'appareil doit accepter tout brouillage radioélectrique subi, même si le brouillage est susceptible d'en compromettre le fonctionnement.

.

The device meets the exemption from the routine evaluation limits in section 2.5 of RSS 102 and compliance with RSS-102 RF exposure, users can obtain Canadian information on RF exposure and compliance.

Le dispositif rencontre l'exemption des limites courantes d'évaluation dans la section 2.5 de RSS 102 et la conformité à l'exposition de RSS-102 rf, utilisateurs peut obtenir l'information canadienne sur l'exposition et la conformité de rf.

This transmitter must not be co-located or operating in conjunction with any other antenna or transmitter. This equipment should be installed and operated with a minimum distance of 20 centimeters between the radiator and your body.

Cet émetteur ne doit pas être Co-placé ou ne fonctionnant en même temps qu'aucune autre antenne ou émetteur. Cet équipement devrait être installé et actionné avec une distance minimum de 20 centimètres entre le radiateur et votre corps.

5G band 1:

the device for operation in the band 5150-5250 MHz is only for indoor use to reduce the potential for harmful interference to co-channel mobile satellite systems

les dispositifs fonctionnant dans la bande 5150-5250 MHz sont réservés uniquement pour une utilisation à l'intérieur afin de réduire les risques de brouillage préjudiciable aux systèmes de satellites mobiles utilisant les mêmes canaux;

5G All band:

1. the device for operation in the band 5150–5250 MHz is only for indoor use to reduce the potential for harmful interference to co-channel mobile satellite systems;
2. for devices with detachable antenna(s), the maximum antenna gain permitted for devices in the bands 5250-5350 MHz and 5470-5725 MHz shall be such that the equipment still complies with the e.i.r.p. limit;
3. for devices with detachable antenna(s), the maximum antenna gain permitted for devices in the band 5725-5850 MHz shall be such that the equipment still complies with the e.i.r.p. limits specified for point-to-point and non-point-to-point operation as appropriate.
4. les dispositifs fonctionnant dans la bande 5150-5250 MHz sont réservés uniquement pour une utilisation à l'intérieur afin de réduire les risques de brouillage préjudiciable aux systèmes de satellites mobiles utilisant les mêmes canaux;
5. le gain maximal d'antenne permis pour les dispositifs utilisant les bandes 5250-5350 MHz et 5470-5725 MHz doit se conformer à la limite de p.i.r.e.;

le gain maximal d'antenne permis (pour les dispositifs utilisant la bande 5725-5850 MHz) doit se conformer à la limite de p.i.r.e. spécifiée pour l'exploitation point à point et non point à point, selon le cas.

Important RF IC Instructions

CE Declaration of Conformity

Low Voltage Directive 2006/95/EC

Electromagnetic Compatibility Directive 2004/108/EC

Restriction of Hazardous Substances (RoHS2) Directive 2011/65/EU

Waste of Electrical and Electronic Equipment Directive 2012/19/EU

Energy related Product Directive 2009/125/EC

Naim Audio products comply with the following standards:

EN60065 - Audio, video and similar electronic apparatus - Safety requirements

EN55013 - Sound and television broadcast receivers and associated equipment - Radio disturbance characteristics

EN55020 - Sound and television broadcast receivers and associated equipment - Immunity characteristics

EN61000-3-2 - Mains harmonics current emissions

EN61000-3-3 - Mains flicker emissions



WARNING:

To prevent possible hearing damage, do not listen to this radio at high volume levels for long periods of time.

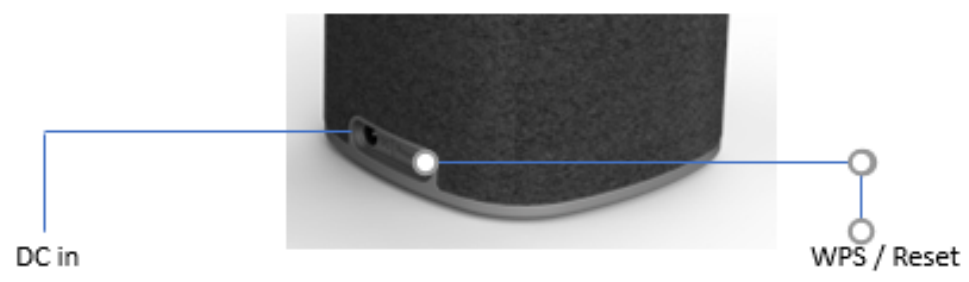

LED Definition

Group	States	Description	Color
Idle	Idle	The device state when there is not an Alexa interaction in process.	No visual indicators
Core	Listening	Communicates the states of a customer's conversation with Alexa, the core of her personality.	Cyan & Blue
	Thinking		
	Speaking		
Microphone Off	Microphone Off	Indicates that the customer has pressed the Microphone-off button.	Red
Alerts	Timers	Communicates that an Alert has expired.	Cyan & Blue
	Alarms		
	Reminders		
Notifications	Notification Arrives	Communicates when notification arrives and when notifications are waiting to be retrieved by the customer.	Yellow
	Notification Queued		
Do Not Disturb	Do Not Disturb Enabled	Communicates that Alexa will not disturb the customer with incoming calls, messages, and notifications.	Purple
	Do Not Disturb Disabled		
Pairing & Discovery	Bluetooth	Communicates that the product is interacting with or connecting directly to	Blue

Errors	System and Device Errors	Communicates that an error has occurred on the device, or that Alexa is unavailable when the customer attempts to start an Alexa interaction.	Red
	Alexa Service Unavailable		
	No Wi-Fi		
Device Setup	OoBE	Communicates that the product is in initial setup mode (OoBE) or is booting up.	Cyan & Blue
	Boot-Up		
Device Change	Volume Changes	Communicates device's responses to a customer interaction. In these cases, Alexa isn't interacting with the customer, the device is	White
	Power Off		N/A
Configuration Change	Factory Reset	Communicates customer-initiated changes to the system while the change is being processed by the product, not Alexa.	Orange
	Wake word Change		Orange
	Wi-fi Configuration		Orange

WiFi set up

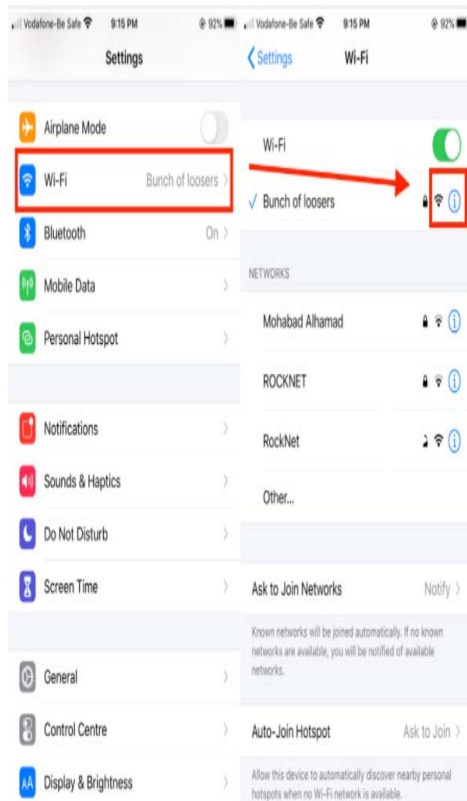

1. Go to your mobile WiFi's setting and select **device S2S**

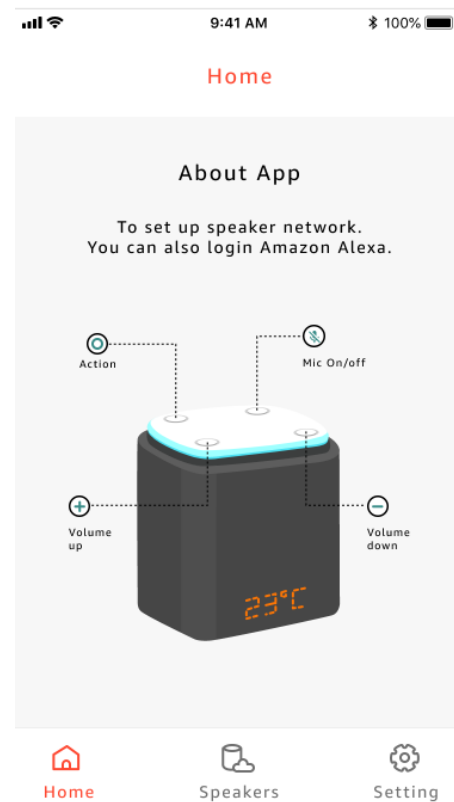

2. download and launch **S2 JS-AVS** mobile app

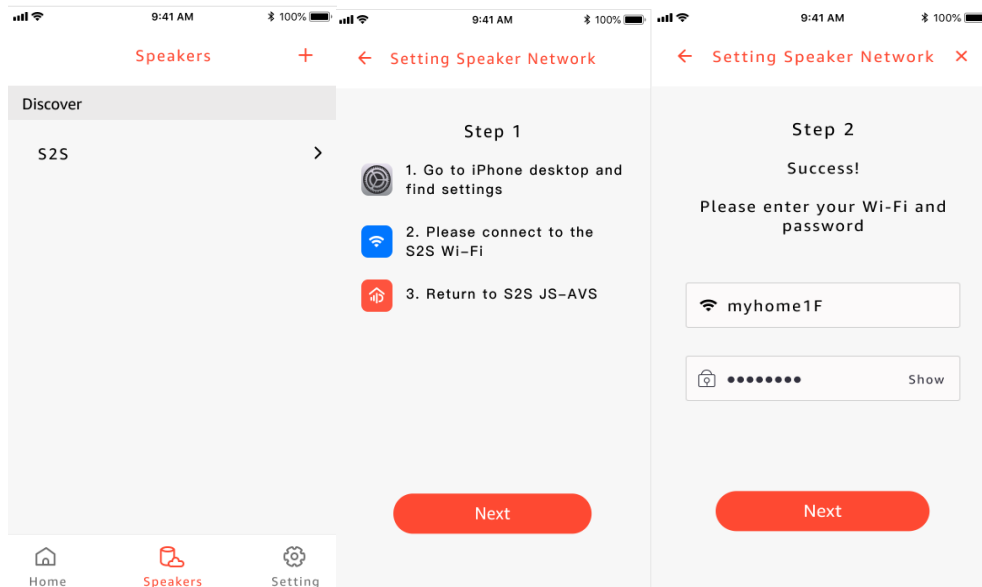

3. under "Speaker" tab, add device by clicking "+" on upper right corner

4. press "Next"

5. key in your WiFi network and enter password, then "Next"

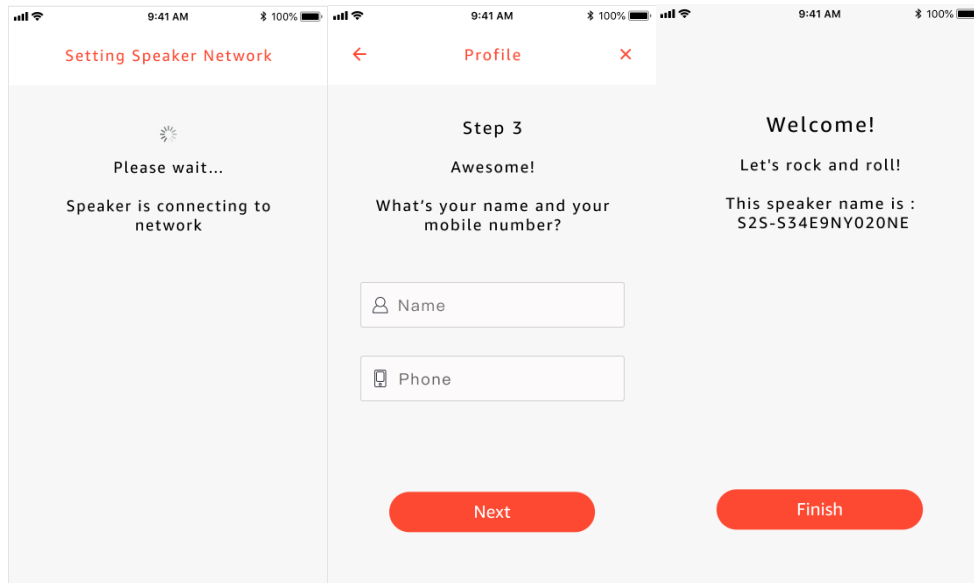

6. connecting...

7. you can skip this step if you don't want to set up profile

8. Done! Finish!

AVS set up

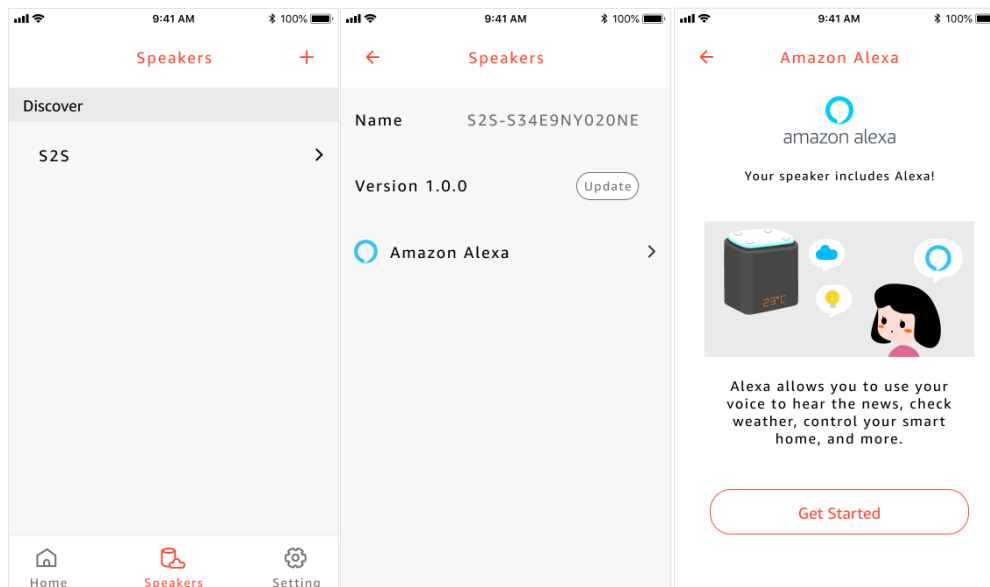

3. Select the device

2. Click "Amazon Alexa"

1. Click "Get Started"

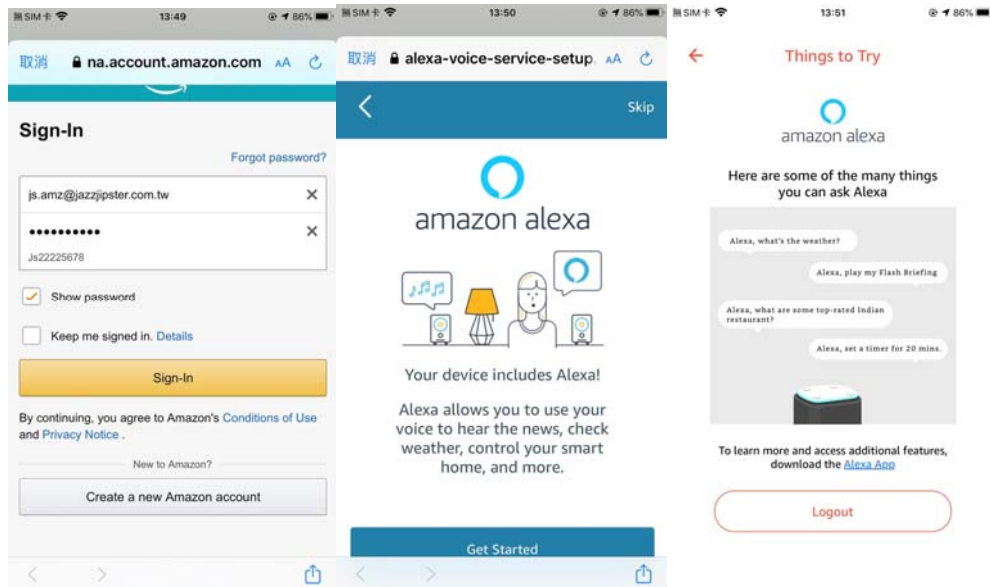

6. Sign in with your AVS account

4. Click "Get Started"

6. Done! Finished!

APP features

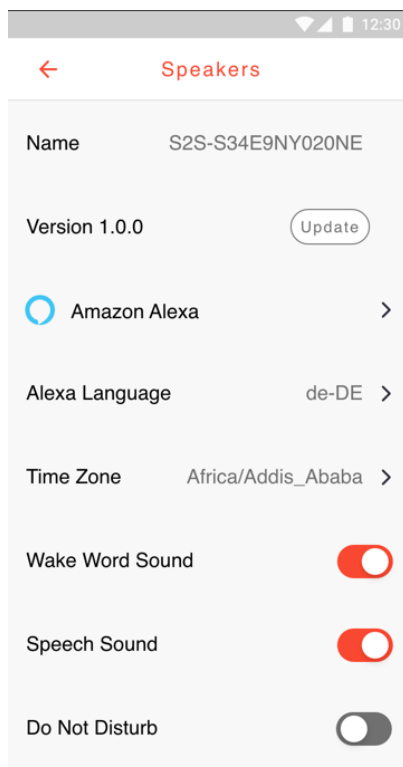

1. Language selection
2. Time Zone
3. Wake Word Sound on/off
4. Speech Sound on/off
5. Do Not Disturb on/off

APP Setting

The screenshot displays the 'APP Setting' interface. At the top, there is a status bar with signal, battery, and time (12:30) indicators. Below this is a navigation bar with a back arrow, the title 'Profile', and the word 'Setting'. The main content area is divided into two sections. On the left, there are two input fields: the first contains a person icon and the text 'Tina', and the second contains a mobile phone icon and the text '0912-345-678'. Below these fields is a red-outlined button labeled 'Save'. On the right, there are two rows of information: 'Profile' with a right-pointing chevron, and 'App Version' with the text 'v 1.0.0'. At the bottom, there is a navigation bar with three icons: a house for 'Home', a speaker for 'Speakers', and a gear for 'Setting' (which is highlighted in red).

← Profile Setting

Profile >

App Version v 1.0.0

Save

Home Speakers Setting

1. Check out APP version
2. Set up your profile (name, mobile number)

Product Specification

Product type	Smart speaker
Power consumption	10W (RMS)
Channel	1
Driver	one driver (2.25") + 1 PR
360 Degree	Nope
Frequency Range	100~20KHz +/- 10dB (TBC by actual test data)
Microphone	Far-field*4
WiFi	802.11 a/b/g/n/ac (2.4G/5GHz)
Cloud Service	Amazon
Voice assistant	Amazon Alexa
Bluetooth	BT 5.0 (A2DP, AVRCP)
Display	Dot matrix
DC port	Yes
Reset	Yes
Buttons	Microphone Mute, Volume +/-, Action button
Power adapter	12V/2A external adapter

Things to Ask Alexa

Volume Controls

"Alexa, volume up."

"Alexa, turn up the volume."

"Alexa, louder."

"Alexa, volume down."

"Alexa, turn down the volume."

"Alexa, volume 6."

Bluetooth

"Alexa, pair."

"Alexa, Bluetooth."

"Alexa, connect to my phone."

"Alexa, disconnect from my phone."

Help and Guidance

We're here to help you get the most from your S2S, Wi-Fi/Bluetooth smart speaker with Amazon Alexa.

If you still require further assistance, visit our official website on www.jazzhipster.com.tw

Jazz Hipster Corporation
2F, No.512, Yuan-San Rd., Chung-Ho Dist.
New Taipei City 235, Taiwan R.O.C.
+886-2-22225678