

# INSTRUCTION MANUAL

• A parent or supervising adult should read the following instructions.

## A TRANSMITTER

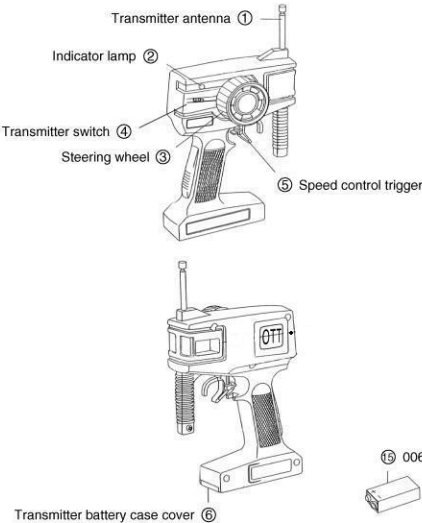

## B R/C VEHICLE

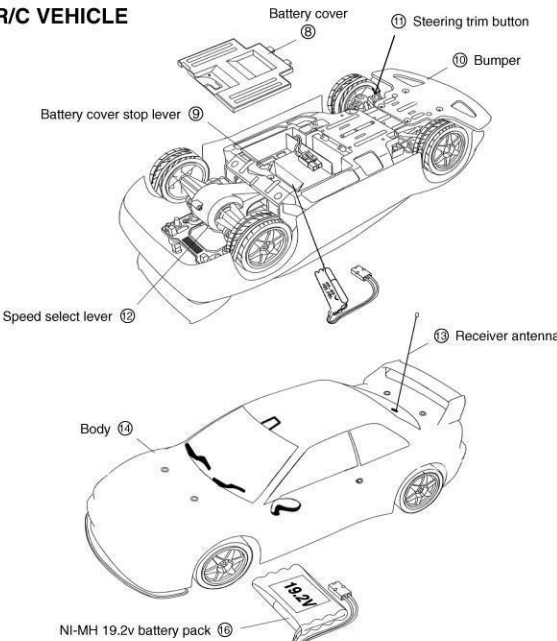

### HERO POWER SPEED R/C CAR COMPONENTS

- ① Transmitter antenna  
② Indicator lamp  
③ Steering wheel  
④ Transmitter switch  
⑤ Speed control trigger  
⑥ Transmitter battery case cover

- ⑧ Battery cover  
⑨ Battery cover stop lever  
⑩ Bumper  
⑪ Steering trim button  
⑫ Speed select lever  
⑬ Receiver antenna  
⑭ Body

- ⑮ 006P size 9v battery  
⑯ NI-MH 19.2v battery pack

- ① Use a 006p-9V battery for the transmitter.  
Always use fresh batteries and install properly.  
② Open transmitter battery cover  
③ Insert +006P-9V battery noting correct polarity.  
If power does not work properly, reinsert battery

and make sure that connections are secure.  
④ Close transmitter battery cover  
★ If the switch is turned ON and the indicator lamp does not light, check battery.  
If battery is properly installed and indicator light fails to light, battery may be depleted.  
Install new battery when indication light blinks or dims while racing.

### 1 HOW TO INSTALL BATTERY

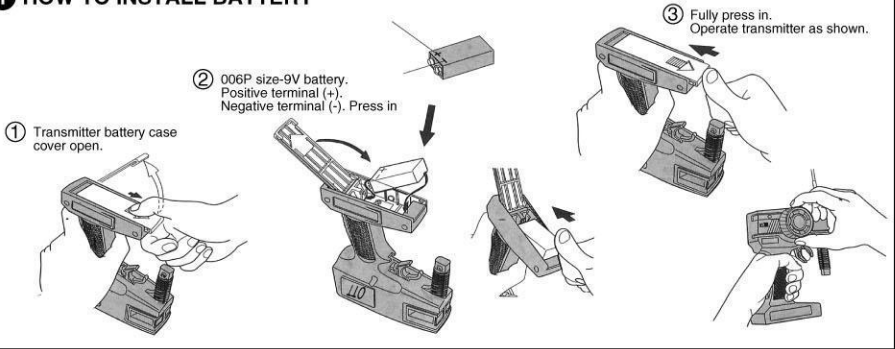

## 2 INSTALL RUNNING BATTERY

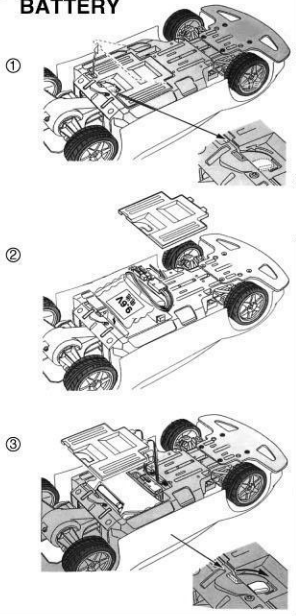

### CAUTION

Transmitting range of this R/C model is approximately 30m.  
Exceeding this distance might cause control difficulties.

1. This device complies with Part 15 of the FCC Rules.  
Operation is subject to the following two conditions:

- (1) This device may not cause harmful interference, and  
(2) This device must accept any interference received, including interference that may cause undesired operation.  
2. Changes or modifications not expressly approved by the party responsible for compliance could void the user's authority to operate the equipment.

### INSERTING BATTERY

- ① Move chassis stop lever, open battery cover  
② Insert 19.2V NI-MH battery, connect noting polarity  
③ Close battery cover, use stop lever to lock.

### HOW TO DISCONNECT



## 3 SWITCHING ON EQUIPMENT

The diagram outlines the procedure for switching on the R/C car and transmitter.  
When turning the car off, follow the reverse order (3-2-1)  
Carefully collapse antenna by holding bottom of antenna and not the tip.

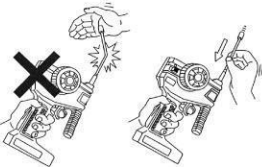

### 3 HOW TO SWITCH ON

- ① Fully extended antenna  
② Switch on transmission  
③ Switch on vehicle

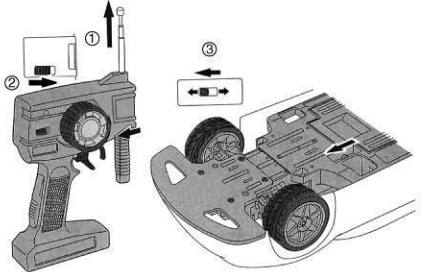

## 4 CONTROL OF THE R/C CAR

- ① Speed control Trigger  
The speed control trigger operates when pull or push with a finger.  
Pulling the trigger towards you runs the model forward.  
Pushing the trigger runs the model in reverse.  
② Steering Wheel  
Steers the model left and right. Turning the wheel right steers model to the right and turning the wheel left steers the model to the left.

WHEN R/C MODEL DOES NOT RUN STRAIGHT  
USE A SCREWDRIVER TO ADJUST THE STEERING TRIM BUTTON.

### 4 HOW TO CONTROL MODEL

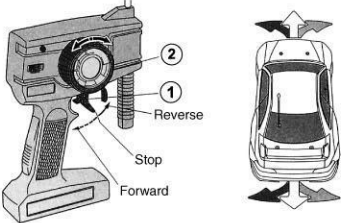

## 5 SELECTING "HIGH" OR "LOW" SPEED GEAR

- "High" Gear (Speed)  
Best for high speeds on flat surfaces. Setting the speed lever to "H" gives the model a higher running speed.  
• "Low" Gear (Power)  
Setting the lever to "L" gives less speed but more power than the "H" gear and a longer running time.

### 5 SELECTING "HIGH" OR "LOW" SPEED GEAR

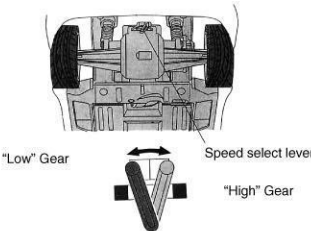

### 6

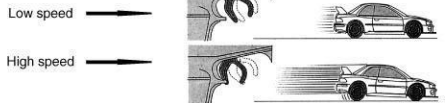

**WARNING:**  
CHOKING HAZARD-Small parts.  
Not for children under 3 years.