

Bluetooth Stereo Headset

T900S + Audio dongle / USB dongle

User Manual

Audio dongle include A450, A451 etc.

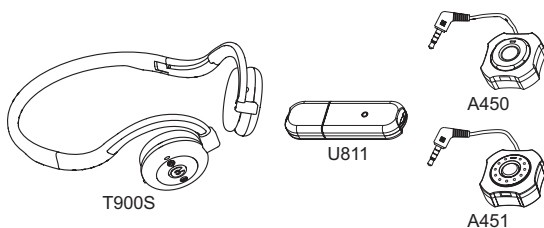

Package Contents

In this package, you will find:

1. One T900S
2. One A450 / A451 / U811
3. One Charger
4. One USB Charger
5. One ϕ 2.5 Stereo Audio Jack
6. One ϕ 6.3 Stereo Audio Jack
7. One 3.5-2RCA
8. One user manual
9. One warranty card
10. Four Ear cushions

Headset function

1. Multifunctional button MFB: switches the headset on/off, answers/ends a call, pairs the headset, pause.
2. Volume down button: decrease the speaker volume.
3. Volume up button: increase the speaker volume.
4. USB charging port: Charges the battery
5. LED indicator: displays the status of the headset.

6. Headset body
7. Headset shuck

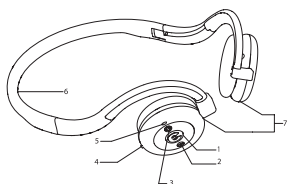

1. Signal jack
2. LED: indicate the status
3. MFB button: turn on/off, pairing
4. Body
5. USB charging port

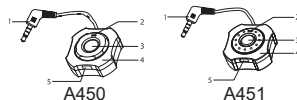

Charge the headset

The headset has a rechargeable battery. Before using the headset for the first time, you have to charge the headset battery for approximate 2 hours to get a full charge. T900S can provide up to 5 hours of working time and 110 hours of standby time, audio dongle can provide up to 5 hours of working time and over 80 hours of standby time.

1. Plug the charge into the AC outlet.
 2. Connect the headset with the adapter. (the red LED of headset light on)
 3. When the battery is fully charged, the red LED are off.
- Note: 1. During charging, the headset can not work, audio dongle can work.
2. Audio dongle and T900S can charge in the same time.
 3. Battery is low, the red LED flashes.
- Put the USB line, link with Port of PC USB. Also can charge it.

Switching the headset on/off

1. Off mode, press the MFB button for about 3 seconds until the LED indicator flashes blue.
2. Standby mode, Press the MFB button for about 3 seconds until the LED indicator off.

Connect audio dongle

1. Switch on T900S pairing mode (Press the MFB button till the red LED and blue LED flash alternatively)
2. Switch on audio dongle pairing mode (Press the MFB button till the LED flash rapidly)
3. T900S pairing with audio dongle automatically
4. Plug the audio dongle to the radio-play. (example: Ipod Mini and so on)
5. The sound will transferred to headset.

Pairing the headset with mobile phone

1. Place the headset and the mobile phone (can support A2DP)
 - no more than 1 meter apart and ensure there is nothing between.
 2. Ensure the headset is off.
 3. Press and hold the MFB until the headset LED alternately flash blue and red.
 4. Mobile phone discovery the device (T900S)
 5. Choose the T900S
 6. Enter the passkey "0000" and then "ok" to pair the headset with the phone.
 7. The voice of the phone will be transferred to the headset.
- Listening to stereo audio from PC

Connect to USB Dongle (V1.2)

1. Start-up the headset pairing mode
2. Plug in USB Dongle to PC
3. USB Dongle will automatically connecting and pairing with the headset, the blue LED flashes.
4. Through the headset will hear stereo voice from PC

Connect USB Dongle BT-USB 10M (V1.2)

1. Installation Bluesoleil software V1.6.1.
 2. Start-up the Bluesoleil
 3. Plug in USB Dongle to PC
 4. Switch on the headset into pairing mode
 5. Find the headset device, choose T900S
 6. Enter passkey "0000", and then choose connect with the AV service.
 7. Through the headset will hear the sound from PC.
- Note: This product can pairing with all Audio dongle (ensure the passkey NO is "0000").

Button function

When listening to stereo audio, press VOL+, voice will increased; press VOL-, voice will decreased; press the MFB button, the voice will pause, press MFB button again, it will resume stereo audio.

Note: On completing pairing, listening to stereo audio should be within 5 meters indoors and 10 meters outdoors.

LED indicator

Status	Led indicator
Charging in process	Red LED will on
Fully battery	Red LED will flashing stops
Low battery	Flashes red
Turning off	Red LED and blue LED will flashing stop
Turning on	Flashes blue
Pairing mode	LED of T900S and audio dongle flash red and blue alternatively
Standby mode	Flashes blue

Note: Pairing T900S will take 120 seconds and pairing audio dongle will take 60 seconds, in pairing mode, the LED of T900S flashes red and blue alternatively, the LED of audio dongle flashes blue. The pairing mode will automatically quit when exceed the pairing time, if you want repairing them, you should switch off them and then switch on them again.

Federal Communications Commission (FCC) Statement

15.21
You are cautioned that changes or modifications not expressly approved by the part responsible for compliance could void the user's authority to operate the equipment.

15.105(b)
This equipment has been tested and found to comply with the limits for a Class B digital device, pursuant to part 15 of the FCC rules. These limits are designed to provide reasonable protection against harmful interference in a residential installation. This equipment generates, uses and can radiate radio frequency energy and, if not installed and used in accordance with the instructions, may cause harmful interference to radio communications. However, there is no guarantee that interference will not occur in a particular installation. If this equipment does cause harmful interference to radio or television reception, which can be determined by turning the equipment off and on, the user is encouraged to try to correct the interference by one or more of the following measures:

- Reorient or relocate the receiving antenna.
- Increase the separation between the equipment and receiver.
- Connect the equipment into an outlet on a circuit different from that to which the receiver is connected.
- Consult the dealer or an experienced radio/TV technician for help.

Operation is subject to the following two conditions:
1) this device may not cause interference and
2) this device must accept any interference, including interference that may cause undesired operation of the device.

FCC RF Radiation Exposure Statement:
This equipment complies with FCC radiation exposure limits set forth for an uncontrolled environment. End users must follow the specific operating instructions for satisfying RF exposure compliance. This transmitter must not be co-located or operating in conjunction with any other antenna or transmitter.