

To Customer

Thank you for purchasing our hand held FM transceiver, This model is novel design, stable performance, easy to operate and with a variety of sophisticated functions, so we are using the most advanced technology.

We deeply confident that its quality and functionality would make you feel satisfied!

Table of contents

User Safety Information	1	Call Alert.....	13
Before use.....	1	Radio Check	14
Unboxing and Configuration Checks	2	Remote Monitor	14
Accessories.....	2	Scan.....	14
Supplied Accessories.....	2	Zone.....	15
Preparation	3	Record	15
Charging Instruction.....	3	Power Level	15
Charge Steps	4	Tone Set.....	15
Install/Remove Battery Pack	4	VOX	15
Install Belt Clip	5	Power Save.....	16
Installing the Optional Speaker/Microphone.....	5	TOT.....	16
Speaker/Microphone.....	5	Brightness.....	16
Speaker/Microphone.....	5	Backlight	16
Speaker/Microphone.....	5	Language	16
Main Function Description ...	6	Firmware Ver.....	16
Getting Started	7	Radio ID.....	16
Guide	7		
Key Operation Instructions ..	8	Other Function Descriptions and Settings	17
Keyboard.....	8	Emergency alarm on digital channels	17
Key Function	8	Emergency alarm on analog channels.....	17
Menu Content	10	Encryption.....	17
Digital Channel.....	10	Remote monitoring.....	17
Analog Channel	11	Man Down.....	17
Menu Function Description and Setting	13	Vibration.....	18
View	13	Troubleshooting	19
Disable	13		
Radio Enable	13		

User Safety Information

■ Before use

- Do not use damaged antennas. Damaged antennas may cause minor burns if they come into contact with the skin.
- Do not use the radio or charge the battery in an explosive environment (such as gas, dust, steam, etc.).
- Turn off the radio when refueling or parking at a gas station.
- Do not modify or adjust this unit for any reason.
- Do not expose the radio to direct sunlight for a long time, and do not place it near heating appliances.
- Do not place the radio in extremely dusty, humid and splashy places, and do not place it on an unstable surface.
- Repairs may only be carried out by professional technicians.
- If you notice a strange smell or smoke from the radio, immediately turn off the power of the radio, remove the rechargeable battery pack from the radio, and contact the supplier.

Safety:

It is important that the user has knowledge and awareness of the general dangers of using a walkie-talkie.

Unboxing and Configuration Checks

■ Accessories

Carefully take out the transceiver from the box. We recommend that confirm the below goods before get rid of the packing.

■ Supplied Accessories

Item	Qty.
Radio	1
Li-ion Battery pack 3.7V	1
Charger /Adapter	1
Belt Clip	1
User Manual	1
Hang Strap	1

Preparation

■ Charging Instruction

The note of Li-ion battery charging below:

- The battery pack had not charging when come out the factory, please charging first when you want to use. After the purchase or long-term storage (more than two months), the first to charging the battery pack can not make the battery pack up to its saturation use of capacity. In repeated charging and discharging two, three times, The effect can be achieved the normal charging and battery power.
- Before charging, should turn off the transceiver power. if use the transceiver while its battery charging, it would badly influence on the battery normally charging.
- The Battery under the normal charging many times, The time of using time is not adding anymore, it mean that life of battery is close to over, should replace new one; As calculated, The average time of battery pack is about 13 hours. The average use time is 5% receive time, 5% transmit time, and 90% standby time.

CAUTION

- Do not charging the battery pack again, when its already fully charging before. otherwise it would cause the life of battery pack to shorten, even it may be damaged.
- When it's charging fully, please remove it away charger cup.
- Do not short the battery terminal or dispose of the battery by fire.

■ Charge Steps

The charger plug into the mains of 110V **power outlet**, the charger indicator green light flashing.

The battery pack or the transceiver with battery pack insert into the charger card slot. (as picture show).

The charger red light flashing to start charging. Charging fully then the charger green light flashing, charging end.

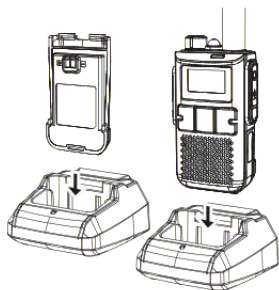

■ Install/Remove Battery Pack

When install the battery pack, should match the corresponding location of aluminum frame of transceiver backside, then push into the battery towards direction. The Buckles on the tail of battery would fasten the battery pack, until can hear “clicking” sound;

To remove the battery pack, please turn off the transceiver first. Then press the buckles of the battery, at the same time, the battery will be pushed back, take the battery away;

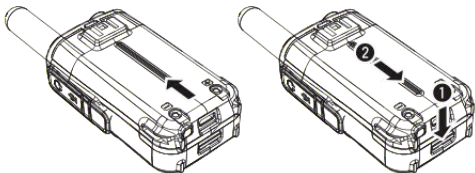

NOTE

Please do not antenna as a handle. the keys or external type loud-speaker microphone hanging on the antenna, which can damage the antenna and lowered transceiver's performance.

■ Install Belt Clip

Push the back clip along the battery back clip slot.

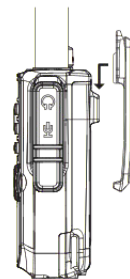

■ Installing the Optional Speaker/Microphone

Outward apart the moisture proof rubber of the headphone mouth, Insert the speaker/microphone plugs into the speaker/microphone jacks.

NOTE

The transceiver is not fully water resistant while using the speaker/microphone.

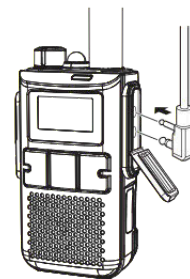

Main Function Description

- UHF: 400MHz~480MHz
- Channel spacing: 12.5KHz
- RF output power: H: 2W
- CTCSS 38, CDCSS 83/CDCSS Inverse 83
- TOT (OFF, 30, 60.....150, 180S)
- VOX (OFF/1/2/3)
- Scan: channel scan
- Record
- Color Code: 0-15
- Encryption AES256
- Backlight ON/OFF
- Power Saving Function
- Monitor
- Low battery alarm
- Beep
- Prompt (Chinese/English)
- Tail voice cancellation
- Scrambler

Getting Started

■ Guide

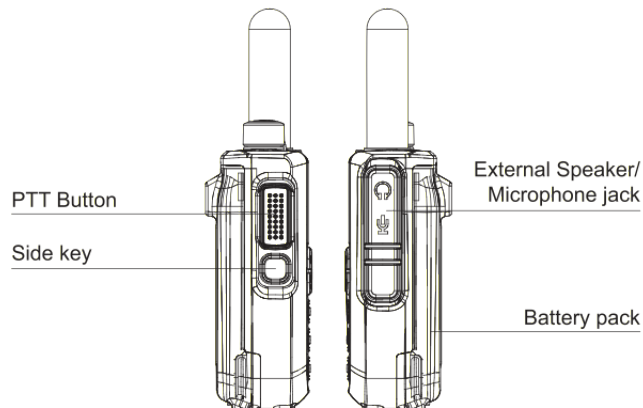
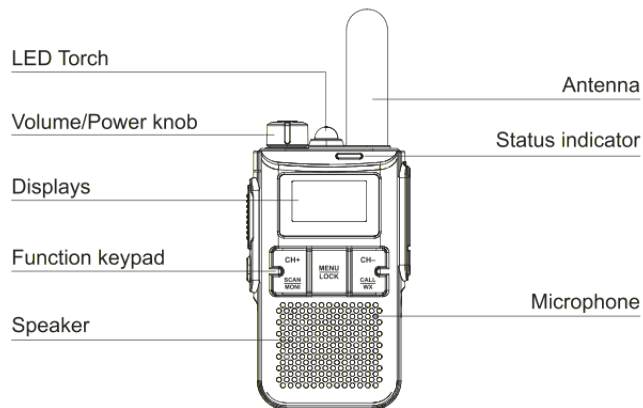

Key Operation Instructions

■ Keyboard

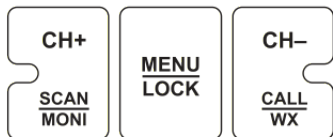

■ Key Function

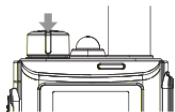

On/off knob, turn it clockwise and hear a “beep”, that is, it is turned on, turn it counterclockwise and hear a “beep”, that is, it is turned off, and the channel number will be broadcast when it is turned on.



Launch button, press this switch when launching, and release it after launching.

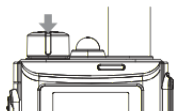

Volume knob, the same knob as the on/off knob, clockwise increases the volume, counterclockwise decreases the volume.



Short press or long press the programmable button to configure scanning on/off, VOX on/off, high/low power, monitoring, emergency alarm, one-key call and other functions through CPS.

[CH+ / CH-]

: Function or channel switching key, press the key continuously to increase the channel number, and press the key continuously to decrease the channel number. During scanning, press the up/down key to exit the scan.

[MENU/LOCK]

: Short press the function setting and selection key to select various functions, and long press to lock the keypad.

[SCAN/MONI]

: Scanning on button, short press to turn on/off the scan, long press on the analog channel to turn on the monitoring mode.

[CALL/WX]

: Short press the back button, long press to return to the standby interface.

Menu Content

■ Digital Channel

ITEM	Display and Description		Set content	
01	Contact		Contact1 / Contact2 / Contact3 / Group1 / Group2 / Group3 / Group4 / ALL CALL	
02	Message	1.Quick Text		
		2.Inbox	Inbox List / Delete ALL	
		3.Outbox	Outbox List / Delete All	
03	Scan		Off / On	
04	Zone		Zone1	
05	Record	1.On-Off	Off / On	
		2.Record File	1...49	
06	Setting	01 Power Level	High power	
		02 Tone Set	Off / On	
		03 VOX	On / Off	
			Level 1/ Level 2/ Level 3	
		04 Power Save	off	
			Level 1/ Level 2/ Level 3	
05 TOT	Off			
	30s / 60s / 90s / 120s / 150s / 180s			
06 Brightness	Level 1/ Level 2/ Level 3			

ITEM	Display and Description		Set content
06	Setting	07 Backlight	Infinite
			5s / 10s / 15s / 30s / 45s / 60s / 120s / 180s / 240s / 300s
		08 Language	Chinese / English
		09 Boot Screen	Picture
			Information
		10 Vibration	Off / On
		11 Man down	Off / On
		12 Factory set	Reset All?
13 Firmware version			
14 Radio ID			

■ Analog Channel

ITEM	Display and Description		Set content	
01	Scan		Off / On	
02	Zone		Zone1	
03	Setting	01 Power Level	High power	
		02 Tone Set	Off / On	
		03 VOX	On / Off	
			Level 1/ Level 2/ Level 3	
04 Power Save	off			
	Level 1/ Level 2/ Level 3			

ITEM	Display and Description		Set content
03	Setting	05 TOT	Off
			30s / 60s / 90s / 120s / 150s / 180s
		06 Brightness	Level 1/ Level 2/ Level 3
		07 Backlight	Infinite
			5s / 10s / 15s / 30s / 45s / 60s / 120s / 180s / 240s / 300s
		08 Language	Chinese/English
		09 Boot Screen	Picture
			Information
		10 Vibration	Off / On
		11 Man down	Off / On
12 Factory set	Reset All?		
13 Firmware version			
14 Radio ID			

Menu Function Description and Setting

■ View

Select **[Menu]**→**[Contacts]** to enter the contact interface, select the target contact, press and hold the **[PTT]** to initiate a call, the indicator light is always red, release the **[PTT]** to stop the call, and enter the call hold time, The orange light is always on, and at this time press and hold the **[PTT]** again to initiate a call to the contact again.

If you press and hold the **[PTT]** on the main interface, it will initiate a call to the default contact.

■ Disable

Select **[Menu]**→**[Contacts]**, select a contact for individual calls, and select remote kill, after successful remote kill, a prompt "remote kill successful" will pop up. If after 15 seconds, the remote kill is still not successful, a prompt "Failed to send" will pop up.

After the receiver is successfully remote-killed, it will always be on the remote-killed interface, and any operation will have no effect. After re-starting, it will still stay on the remote-killed interface, and it will return to normal after being activated.

■ Radio Enable

Select **[Menu]**→**[Contacts]**, select the personal call contact that has been blocked by remote control, and select Activate. After the activation is successful, a prompt "Activation successful" will pop up. If the activation is still not successful after 15 seconds, a prompt "Failed to send" will pop up.

■ Call Alert

Select **[Menu]**→**[Contacts]**, select a private call contact, select call notification, after the call notification is successful, a prompt "Call notification successful" will pop up. If after 15 seconds, there is still no successful call notification, a prompt will pop up saying "Failed to send".

After the receiver is successfully called, it will always sound the "Dididi"

prompt tone, press the PTT button to directly reply to the transmitter.

■ Radio Check

Select **[Menu]**→**[Contacts]**, select a personal call contact, select walkie-talkie check, after the walkie-talkie check is successful, a prompt will pop up saying “walkie-talkie check is successful”. If the walkie-talkie has not been checked successfully after 15 seconds, a prompt “Failed to send” will pop up.

If the receiver has business, the transmitter will fail to transmit. The transmitter can only send successfully when the receiver is idle.

■ Remote Monitor

Select **[Menu]**→**[Contacts]**, select a personal call contact, and select remote monitoring. After the remote monitoring is successful, a prompt “remote monitoring successful” will pop up. If the remote monitoring is not successful after 15 seconds, a prompt “Failed to send” will pop up.

After the receiver is successfully monitored remotely, press any key to exit the monitored state.

■ Scan

There are two ways to start scanning. The first one is to select **[Menu]**→**[Scan]**, select Open, the voice will announce “Scan On”, and it will automatically return to the main interface, the scan icon will appear on the top, and the scanned channels will be scrolled and displayed, and the orange light will flash. The second is to configure the programmable button, and configure the short press or long press of the programmable button as scanning on/off.

During scanning, you can enter the menu. After entering the menu, it will stay on the channel where it was when entering the menu, and the orange light will no longer flash. After exiting the menu, re-enter the scanning state.

There are three ways to turn off scanning. The first is to directly press the up or down key, and it will automatically exit the scan. The second is to enter the menu to turn off scanning. The third is to turn off the scan

by short pressing or long pressing the programmable button.

■ Zone

Select **[Menu]**→**[Zone]** to select the target zone. After the selection is successful, it will automatically return to the main interface and stay on the first channel in the selected zone.

■ Record

Select **[Menu]**→**[Record]**→**[On-Off]**, select On. After the recording is turned on successfully, the voice will announce “On”. The voice transmitted or received by the walkie-talkie will be completely recorded and saved to **[Recording File]**.

Select **[Menu]**→**[Record]**→**[Record File]**, select a recording to play. During playback of the recording, press the **[Play]** key to start playback, and press the **[CALL]** key to exit the playback.

■ Tone Set

Select **[Menu]**→**[Setting]**→**[Tone Set]**, select On or Off. After the selection is successful, the voice will announce “on” or “off”. After the prompt sound is turned off, both the button sound and the prompt sound will be turned off.

■ VOX

Select **[Menu]**→**[Setting]**→**[VOX]**→**[Level]**, the default is level 2, and the sensitivity gradually increases from level 1 to level 3.

Go back to the previous level, enter **[On-Off]**, and select On. After the voice control is turned on successfully, the voice will announce “On”, and the “V” icon will appear on the top.

■ Power Save

Select **[Menu]**→**[Setting]**→**[Power Save]**, there are three levels of power saving mode.

■ TOT

Select **[Menu]**→**[Setting]**→**[TOT]**, choose to turn off the launch time limit, and there is no limit to the launch time. When the transmission time is selected as 30 seconds/60 seconds/90 seconds/120 seconds/150 seconds/180 seconds, when the transmission time reaches the time limit, the transmission will be stopped forcibly, and the receiver will also stop receiving.

■ Brightness

Select **[Menu]**→**[Setting]**→**[Brightness]**, press the **[Menu]** key to select different levels of brightness.

■ Backlight

Select **[Menu]**→**[Setting]**→**[Backlight]**, select **[Infinite]**, and the display will be always on. When the backlight duration is set to 5 seconds/10 seconds/15 seconds/30 seconds/45 seconds/60 seconds/120 seconds/180 seconds/240 seconds/300 seconds, the screen will automatically turn off after the time of no operation is reached.

■ Language

Select **[Menu]**→**[Setting]**→**[Language]**, press **[Menu]** to select Chinese/English.

■ Firmware Ver

Select **[Menu]**→**[Setting]**→**[Firmware Ver]** to view the current software version.

■ Radio ID

Select **[Menu]**→**[Setting]**→**[Radio ID]** to view the radio ID.

Other Function Descriptions and Settings

■ Emergency alarm on digital channels

After the transmitter configures the analog alarm system through the **[programmable button]**, long press the **[programmable button]** to initiate an emergency alarm.

■ Emergency alarm on analog channels

After the transmitter configures the analog alarm system through the **[programmable button]**, long press the **[programmable button]** to initiate an emergency alarm.

■ Encryption

Configure the secret key value through CPS. The secret key value supports pure numbers, pure letters and mixed alphanumeric characters, and the maximum length can be 8 or 64 characters. The key values of the transmitter and receiver must be consistent in order to communicate normally. If the key values of the transmitter and receiver are inconsistent, or one of them does not enable the encryption function, the content of the call will become a sound similar to noise.

■ Remote monitoring

The receiver is in an idle state, and the transmitter initiates remote monitoring of the receiver. After the remote monitoring of the transmitter is successful, it enters the receiving state, and automatically ends the receiving after reaching the duration of remote monitoring. The maximum duration of remote monitoring is 120 seconds, and the default is 10 seconds. If the receiver presses the **[PTT key]** or other keys during the monitoring process, the remote monitoring will be interrupted.

■ Man Down

After tilting a certain angle to detect that the walkie-talkie has fallen to the ground, it will detect the alarm time of the fall. If the time is up, the handset is still in the state of the fall, and an emergency alarm will be

activated (emergency alarm needs to be configured. The alarm type is: regular, which is a remote alarm, and the rest are local alarms).

If the man-down alarm is activated/during the man-down alarm, if the hand platform is detected to be upright, the emergency alarm will not be activated/turned off.

■ Vibration

Vibrate when booting

After standby for more than one minute (the time can be configured), it will vibrate when a call comes in.

CPS can be configured (1-10 minutes, step 1 minute. It can also be configured without vibration).

Troubleshooting

Question	Solve
Can not boot	<ul style="list-style-type: none">• The battery may be exhausted, please replace it with a new one or charge it• The battery may not be installed correctly, please remove the battery and reinstall it
Battery power doesn't last long after charging	<ul style="list-style-type: none">• The life of the battery pack has expired, please replace the battery.
Cannot chat with other members of the group	<ul style="list-style-type: none">• Confirm whether the frequency and dumb audio signal you are using are the same as those of other members in the group• Other members in the group may be too far away, check whether you are within the effective range of other walkie-talkies
Other (non-group member) voices appear in the channel	<ul style="list-style-type: none">• Please change the CTCSS/DCS. At this time, be sure to change the CTCSS/DCS in the group.

FCC Statement:

Any Changes or modifications not expressly approved by the party responsible for compliance could void the user's authority to operate the equipment.

This device complies with part 15 of the FCC Rules. Operation is subject to the following two conditions:

- (1) This device may not cause harmful interference, and
- (2) This device must accept any interference received, including interference that may cause undesired operation.

SAR tests are conducted using standard operating positions accepted by FCC with the device transmitting at its highest certified power level in all tested frequency bands, although the SAR is determined at the highest certified power level, the actual SAR level of the device while operating can be well below the maximum value. Before a new model is available for sale to the public, it must be tested and certified to the FCC that it does not exceed the exposure limit established by the FCC. Tests for each product are performed in positions and locations as required by the FCC.

For body worn operation, this device has been tested and meets the FCC RF exposure guidelines when used with and accessory designated for this product or when used with and accessory that contains no metal.

To maintain compliance with FCC RF exposure guidelines hold the transmitter and antenna at least 1 inch (2.5 centimeters) from your face and speak in a normal voice, with the antenna pointed up and away from the face.

The equipment complies with FCC radiation exposure limits set forth for an uncontrolled environment. In order to comply with the FCC RF exposure requirement, the antenna installation must comply with following:

Users must be fully aware of the hazards of the exposure and able to exercise control over their RF exposure to qualify for the higher exposure limits.

Your wireless hand-held portable transceiver contains a low power transmitter. This product sends out radio frequency (RF) signals when the Push-to-Talk(PTT) button is pressed.

The device is authorized to operate at a duty factor not to exceed 50%.

Note: This equipment has been tested and found to comply with the limits for a Class B digital device, pursuant to part 15 of the FCC Rules. These limits are designed to provide reasonable protection against harmful interference in a residential installation. This equipment generates, uses and can radiate radio frequency energy and, if not installed and used in accordance with the instructions, may cause harmful interference to radio communications. However, there is no guarantee that interference will not occur in a particular installation. If this equipment does cause harmful interference to radio or television reception, which can be determined by turning the equipment off and on, the user is encouraged to try to correct the interference by one or more of the following measures:

- Reorient or relocate the receiving antenna.
- Increase the separation between the equipment and receiver.
- Connect the equipment into an outlet on a circuit different from that to which the receiver is connected.
- Consult the dealer or an experienced radio/TV technician for help.