



SOLAR LOYAL LIMITED

SL-4108 manual

Thank you very much for purchasing this controller which is a new design , compatible PC, SWITCH. Please read the manual carefully before using it and save it for later use.

Content

1. Bluetooth controller *1
2. 1M USB-C charging cable *1
3. Instruction manual *1



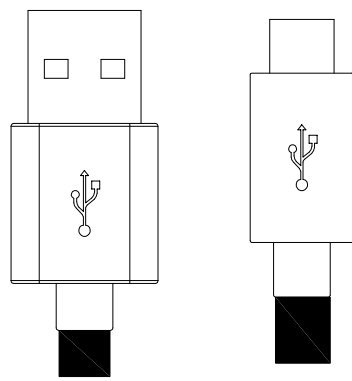

USB Cable

FEATURE

1. Compatible with Nintendo Switch host, PC
2. Bluetooth technology
3. Operation range up to 10M
4. Built in LI-polymer battery 600mA
5. Charging time: 2. 5 hours
6. Playing time: more than 8 hours
7. Sensitive LB RB button, joystick and Trigger design, core gamer loved D-pad design
8. 2 vibration motors
9. Laser engraved mould texture on handle, ergonomic design for comfortable use
10. With LED under face buttons and right joystick
11. Concaved joystick design with matt finish for better game control

PC XBOX 360 mode key layout:

Corresponds
Back button

Corresponds
Start button

Left joystick:

It is set in the different game according to the customer favorite.

Hold down left joystick is button L3.

Directional pad:

8-way point of view control button

Turbo button setting:

1. Hold the key which you want to set it into turbo function, then press Capture key one time. Backlight red flashing, is set successfully.
2. Hold the key which you have set turbo function, then press Capture key it can clear turbo setting. And the backlit return to blue.
3. Can be set the TURBO button: A, B, X, Y, L, R, ZL, ZR.

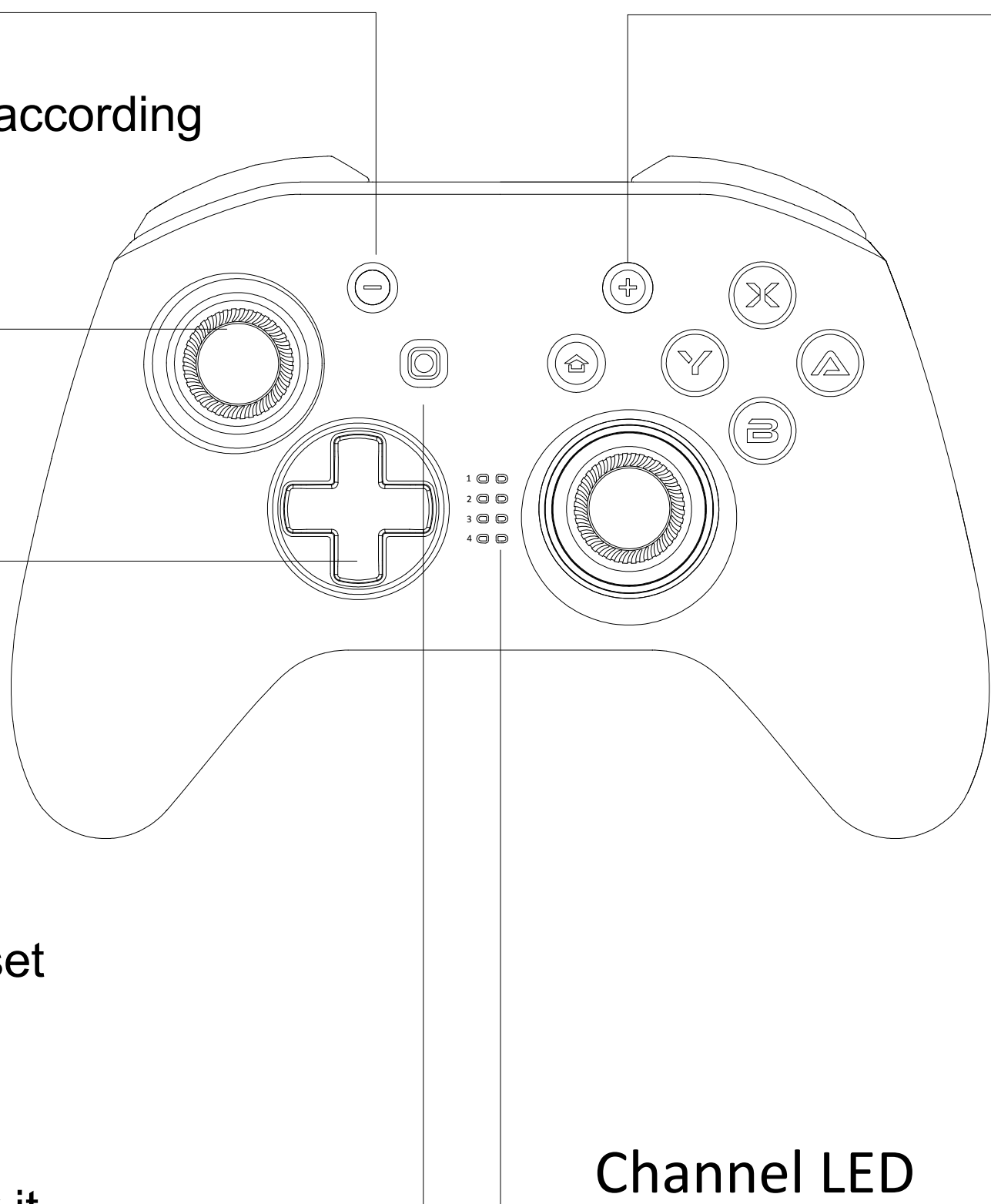

Home button

Hold the "home" button for 5 seconds to turn handle power off.

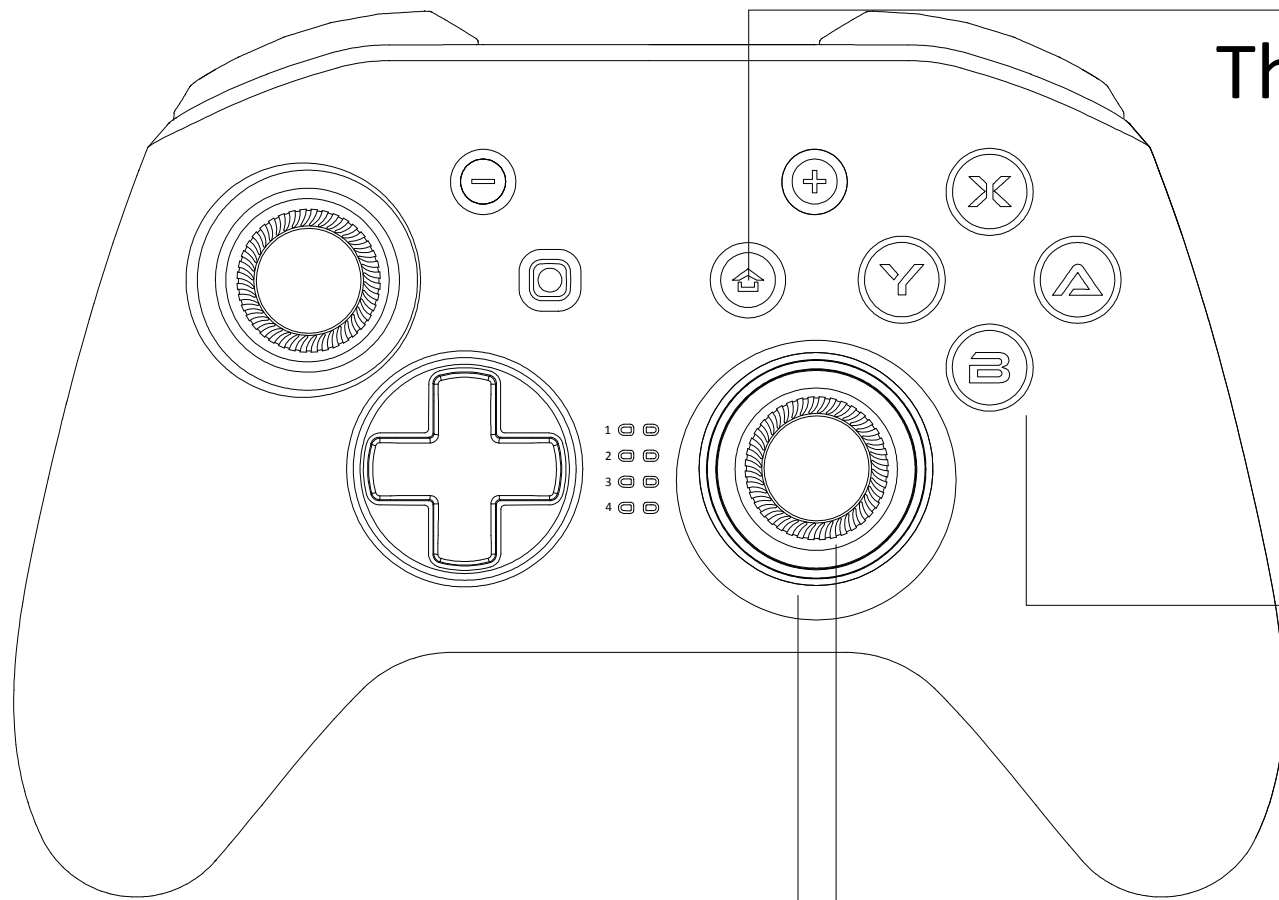

The function keys:A,B,X,Y

A, B, X, Y backlight LED is ON when Power on the handle . Hold down L + R, 5 seconds backlight LED to turn off.Hold down L+R again, 5 seconds backlight LED to turn on.

Right joystick:

It is set in the different game according to the customer favorite. Hold down right joystick is button R3.

Annular backlight

1. When starting up normally, blue backlight is on.
2. When TURBO function is activated, the red light is on.

Trigger Button ZL

Trigger Button ZR

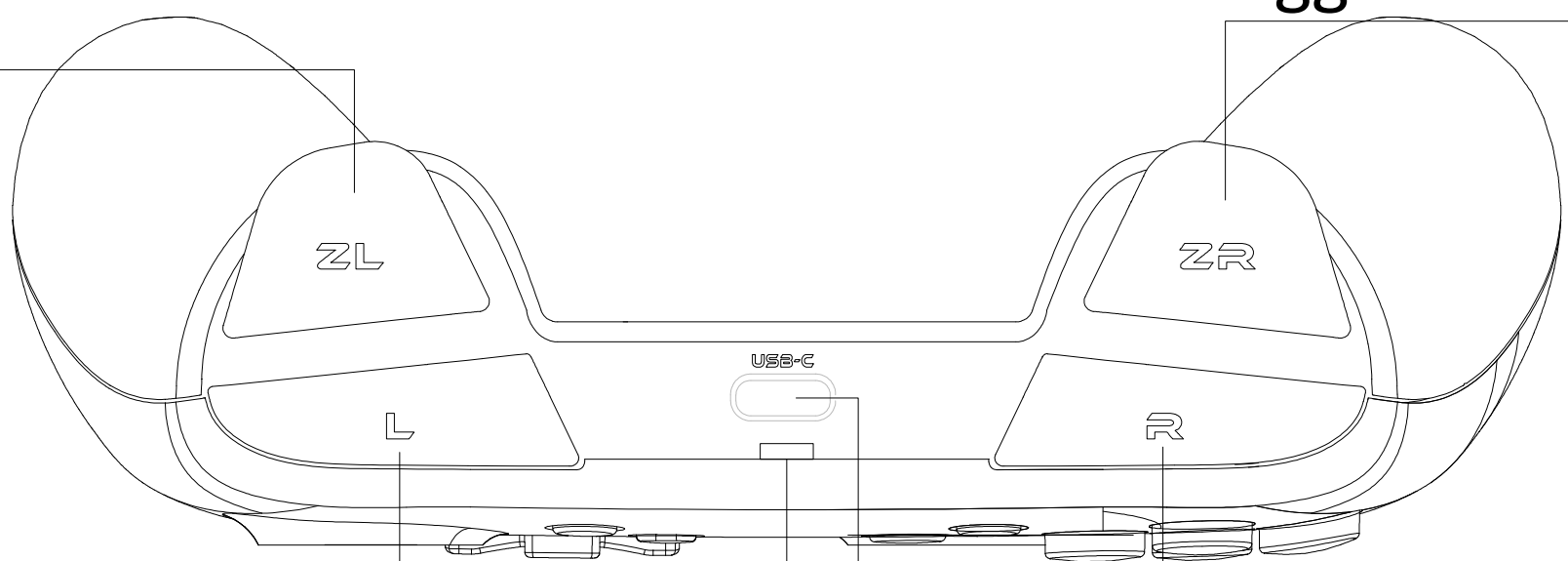

L button

R button

Charging indicator LED
When charging, LED is on,
LED off when full.

USB C :
1. USB data
2. INPUT:5V,500mA

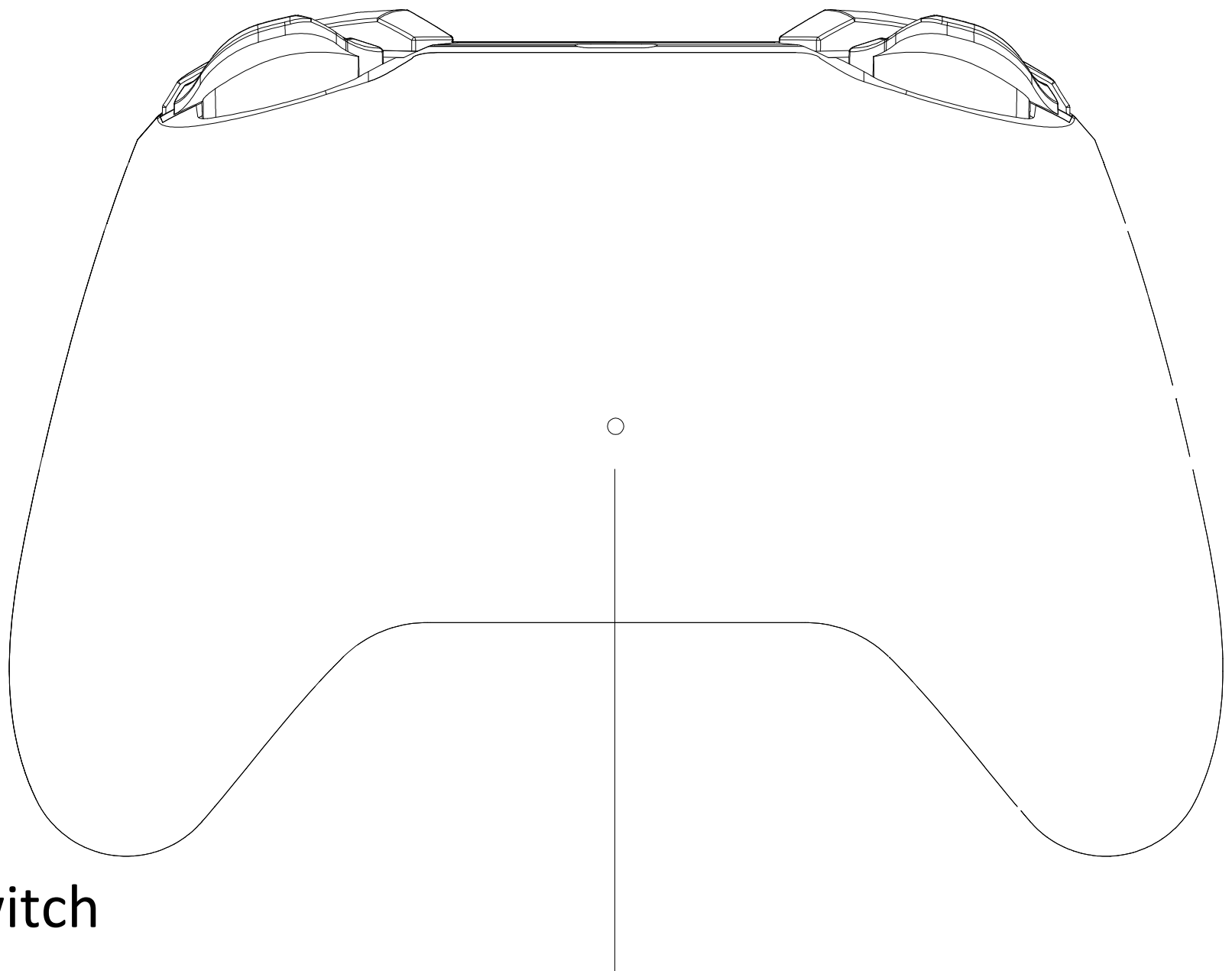

Motor vibration intensity adjustment

The motor adjusts a total of 5 gears, 100% of the vibration of the first gear, 75% of the vibration of the second gear, 50% of the vibration of the third gear, 25% of the vibration of the fourth gear, and 0% of the vibration of the fifth gear.

The methods of operation are as follows:

1. Hold down the turbo key first and then hold down the direction key up to strengthen the vibration of the motor. If in 2 gears, press the key up to become 1 gear, each shift, the motor should also vibrate for 1 second, if adjusted to 2 gears, then the motor is 75% vibration intensity vibration for 1 second.

(Note: when you change to gear 1, you can't adjust it up any more.)

2. Hold down the turbo key first and then hold down the direction key down to weaken the vibration of the motor. If in the second gear, press the key down, it will become 3 gears ,each shift, the motor should also vibrate for 1 second,if adjusted to 3 gears, then the motor is 50% vibration intensity vibration for 1 second.

Backlight led brightness adjustment

ZL+ZR+R3 and direction key up and down to adjust the light intensity of the handle, a total of 5 gear, 1 gear 100%, 2 gear 75%, 3 gear 50%, 4 gear 25%, 5 gear off backlight.

The methods of operation are as follows:

1. Hold down the ZL+ ZR+ R3 key and then hold down the direction key up to strengthe the brightness of LED. If in 2 gear, press the key up, then become 1 gear. (Note: when you change to gear 1, you can't turn it up any more.)
2. Hold down the ZL+ZR+R3 key and then hold down the direction key down, then the brightness of led decreases. If you press the key down when you are in the second gear, it becomes the third gear. (Note: annular and abxy led are brightened and weakened at the same time. And in turbo mode, the annular red led is weakened and strengthened at the same time.)

(Note: When programmed, the motor and led are the strongest by default, and both the motor and backlight have memory function.)

PC wired mode connection Settings :

1. Insert USB cable directly to the computer USB port .
2. When channel LED1 and LED4 is normally on ,connection is successful .
3. Enjoy your game on your devices.

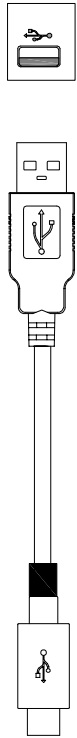

The switch connection/pair Settings :

- 1. On your Nintendo switch ,select the menu item "Controller"-----"Change Grip and Order".
- 2. When the handle is off, hold down the Y button and then hold down the home button. The channel lights flicker and start pairing.
- 3. When channel LED stay on ,connection is successful .
- 4. Enjoy your game on your devices.

SWITCH mode key layout:



Capture button

- 1. Default screenshot btton on the switch host.
- 2. Long press video function on switch host.

3. The "R3" button and the "capture" button can be pressed once at the same time to switch "Capture" tc the "turbo" button function, Red annular

backlight is always on when the switch is successful,Flicker when "turbo" function is activated,Press the "R3+ Capture" button again ,the key "Capture" can be switched return to the "Capture" function key.
Note:Press the R3 key first and then the capture key.

Channel LED:

If controller is paired,When the battery voltage is lower than 3.5 V, connected channel LED(s) flashing warning lower power, and close the vibration function.

Use the cable connection Settings :

1. On your Nintendo Switch, select the menu item "System Settings"----"Controllers and sensors"----"Pro Controller wired Communication" is on.
2. Insert USB cable directly to the nintendo switch charging dock.
3. When channel LED stay on ,connection is successful .
4. Enjoy your game on your devices.

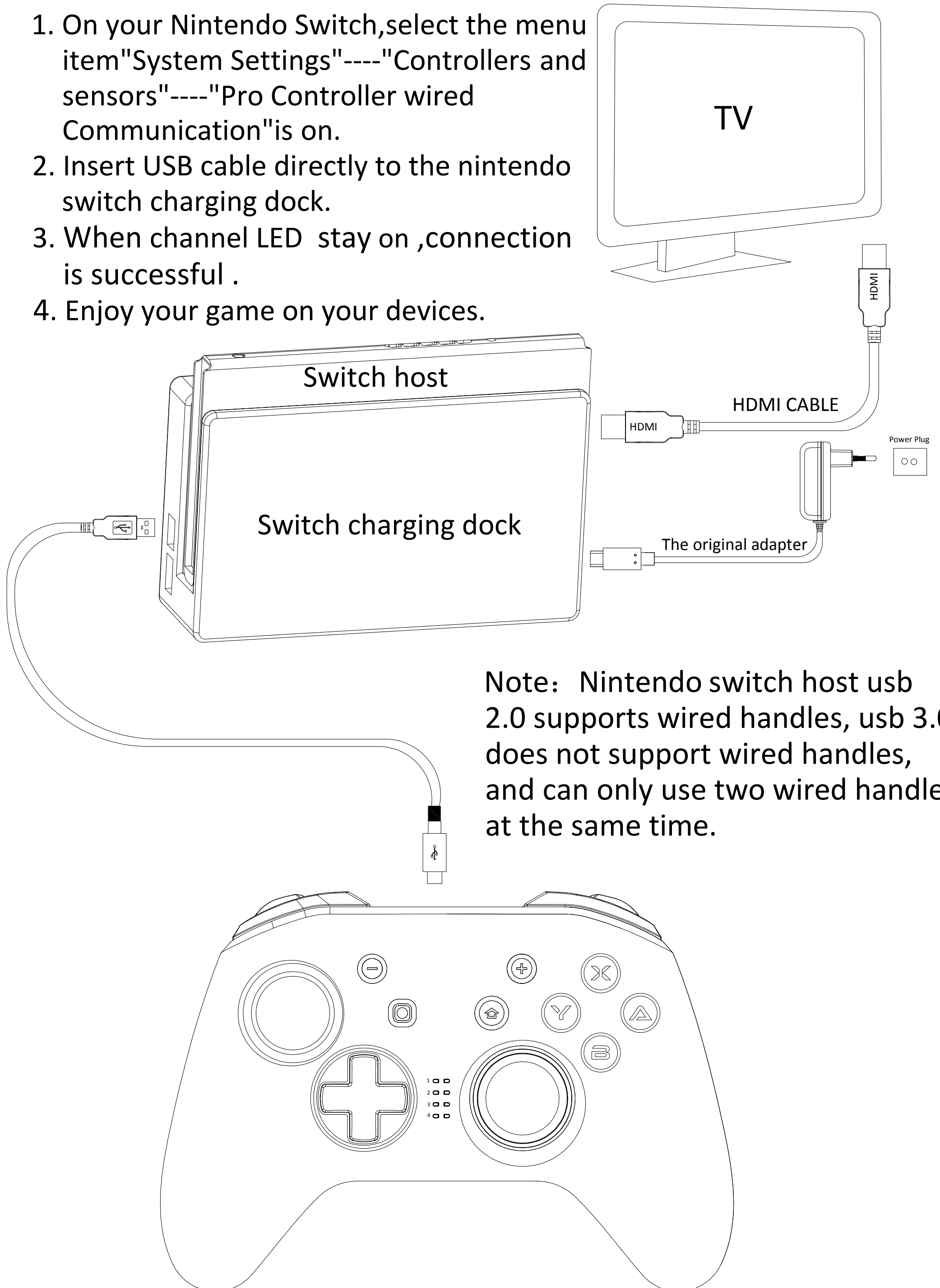

Note: Nintendo switch host usb 2.0 supports wired handles, usb 3.0 does not support wired handles, and can only use two wired handles at the same time.

Channel indicate :

The switch can connect 8 controller:

The first controller: LED1 is normally on.

The second controller: LED1+LED2 is normally on.

The third controller:LED1+LED2+LED3 is normally on.

The fourth controller:LED1+LED2+LED3+LED4 is normally on.

The fifth controller:LED1+LED4 is normally on.

The sixth controller:LED1+LED3 is normally on.

The seventh controller:LED1+LED3+LED4 is normally on.

The eighth controller:LED2+LED3 is normally on .

Player number	Glowing LEDs
1	<div><div></div><div></div><div></div><div></div><div></div></div>
2	<div><div></div><div></div><div></div><div></div><div></div></div>
3	<div><div></div><div></div><div></div><div></div><div></div></div>
4	<div><div></div><div></div><div></div><div></div><div></div></div>
5	<div><div></div><div></div><div></div><div></div><div></div></div>
6	<div><div></div><div></div><div></div><div></div><div></div></div>
7	<div><div></div><div></div><div></div><div></div><div></div></div>
8	<div><div></div><div></div><div></div><div></div><div></div></div>

Switch handle upgrade operation instructions:

Upgrade Preparation:

1. PC *1
2. Upgrade tool package
3. Upgrade program File

Upgrade operation:

Step 1:

Hold down the handle "+ and -" key , then connect the USB cable to the computer usb port.



Step 2:

1. Open the "GH800 upgrade tools" folder, Double-click to run the "testTool" program.
2. Select the only drive option that appears in the Device drop-down option box .
3. Click on the "..." in the Firmware option, Select the upgrade program file for the handle.
4. Click "Download" to upgrade, Indicate "update success" after completion .

FCC Caution.

§ 15.19 Labelling requirements.

This device complies with part 15 of the FCC Rules. Operation is subject to the following two conditions: (1) This device may not cause harmful interference, and (2) this device must accept any interference received, including interference that may cause undesired operation.

§ 15.21 Changes or modification warning.

Any Changes or modifications not expressly approved by the party responsible for compliance could void the user's authority to operate the equipment.

§ 15.105 Information to the user.

Note: This equipment has been tested and found to comply with the limits for a Class B digital device, pursuant to part 15 of the FCC Rules. These limits are designed to provide reasonable protection against harmful interference in a residential installation. This equipment generates uses and can radiate radio frequency energy and, if not installed and used in accordance with the instructions, may cause harmful interference to radio communications.

However, there is no guarantee that interference will not occur in a particular installation. If this equipment does cause harmful interference to radio or television reception, which can be determined by turning the equipment off and on, the user is encouraged to try to correct the interference by one or more of the following measures:

- Reorient or relocate the receiving antenna.
- Increase the separation between the equipment and receiver.
- Connect the equipment into an outlet on a circuit different from that to which the receiver is connected.
- Consult the dealer or an experienced radio/TV technician for help.