

AR+ SOUND

Bluetooth TOWER SPEAKER AR1005

User Manual



IN THE BOX:

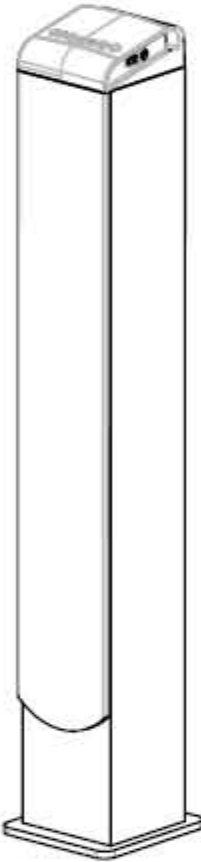

Tower Speaker
Base stand



User manual

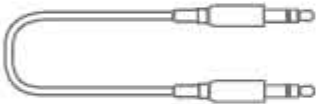

3.5mm
auxiliary cord



Remote control

LOCATION OF CONTROLS:

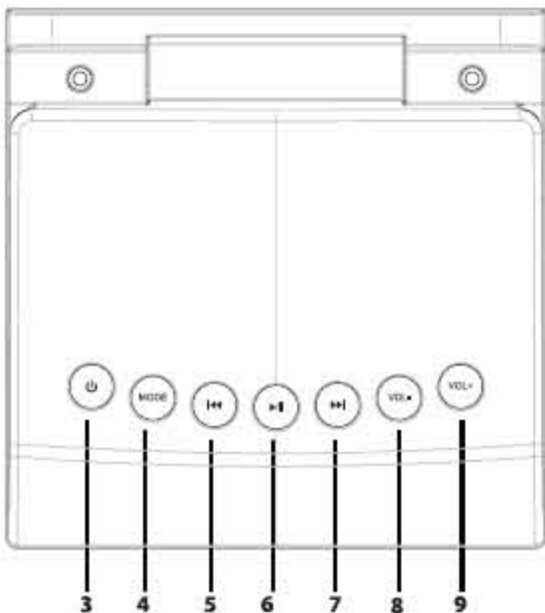
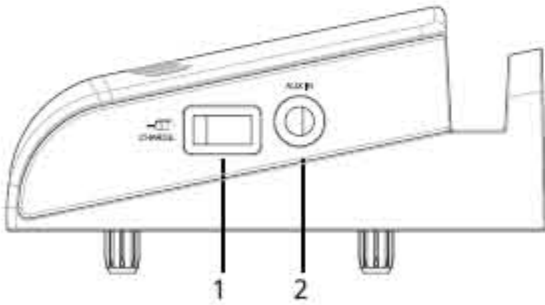

1. USB charging port (use to charge external devices only)
2. AUX IN jack/indicator light
3. [⏻]: press to turn ON/OFF

Standby display:



Power on display :

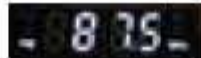

4. "MODE": Press to change playing mode – FM Radio, Bluetooth, AUX IN

Bluetooth Mode display"



AUX IN Mode display"



5. [⏮] button: Quickpress to skip to previous track (in Bluetooth mode); Press and HOLD to scan FM stations (in FM radio mode)

6. [⏸/⏭]

Quick press = play / pause (in Bluetooth mode)
Long press = enter Bluetooth pairing mode or unpair
Quick press = mute volume (in FM mode)
Long press = scan FM stations
Quick press = mute volume (in AUX mode)

7. [⏭] button: Quickpress to skip to next track (in Bluetooth mode); Press and HOLD to scan FM stations (in FM radio mode)

8. [VOL-] button: Decrease volume; Setting clock (under Standby mode)

9. [VOL+] button: Increase volume; Setting clock (under Standby mode)

CONTROLS

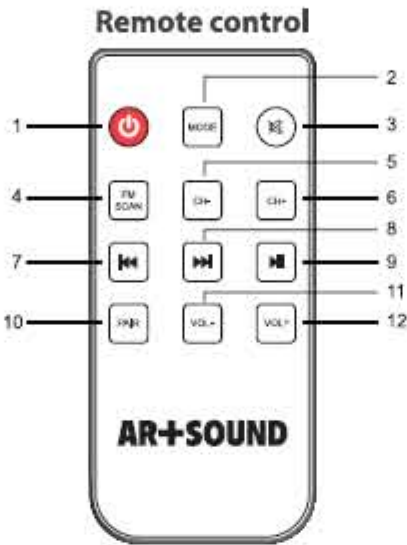

1. ⏻ KEY : Press to turn ON/OFF
- 2 "MODE" KEY: Press to change playing mode – FM Radio, Bluetooth, AUX IN
3. 🔇 KEY: Press to mute volume
4. "FM SCAN" KEY: Auto scan FM Radio
5. "CH-" KEY: preset FM Radio stations
6. "CH+" KEY: preset FM Radio stations
7. ⏮ KEY: Quickpress to skip to previous track (in Bluetooth mode); Press and HOLD to scan FM stations.(in FM mode)
8. ⏭ KEY: Quickpress to skip to next track (in Bluetooth mode); Press and HOLD to scan FM stations (in FM mode)»
9. ⏸/⏭ PLAY/PAUSE (in Bluetooth mode)
- 10 "PAIR": Press to enter pairing mode or unpair. (in Bluetooth mode)
11. "VOL- ": Derease volume
12. "VOL+ ": Increase volume

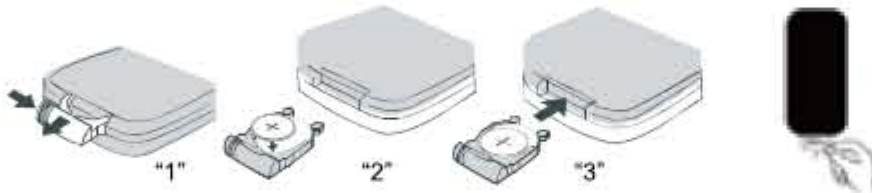

NOTE: The battery for the remote control (1 CR205 lithium battery) is included. To replace the battery, push and slide out the battery door in the remote control. Replace the battery with a new CR2025 battery with the polarity "+" facing up. Slide the door back.

SETUP

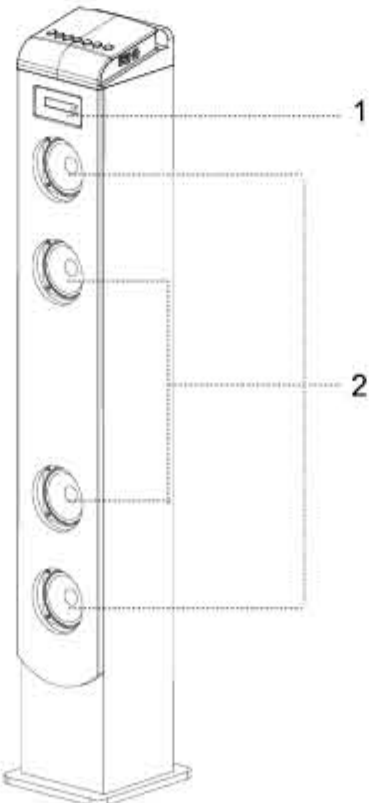

1. Display
2. Whole Tons Speakers

CLOCK SETTING

Under the Standby mode, press and HOLD "MOED" enter clock setting, then press "VOL-" or "VOL+" to select numbers. Press "MOED" for ok. (Remind: Time setting should be finished within 8 minutes, or it will be quit automatically). Under no operation 30 minutes later, the display will change to clock display automatically.

PAIRING THE SPEAKER WITH A BLUETOOTH ENABLED DEVICE

1. Plug the speaker into a power source.
2. Press the "⏻" "Standby power button on the speaker or on the remote control to turn no the unit.
3. Press the [MODE] button on the speaker or the [pair] key on the remote control repeatedly until the Bluetooth indicator light flashes Green
4. Keep the speaker and Bluetooth enabled device within 3 feet of each other during the pairing process.
5. Set your mobile phone or other Bluetooth enabled device to search for Bluetooth devices.

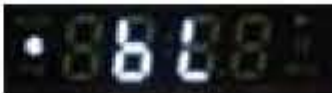

FM RADIO MODE

1. Press the [MODE] button on the speaker or the remote control repeatedly until the FM indicator turns GREEN.
2. Press the [⏮ or ⏭] buttons on the speaker or the remote control to rune down/up through radio stations.
3. To scan to the next available station, press and HOLD the ⏮ or ⏭ button for one full second and release. 20 stations will automatically be saved as presets.
4. Press the [FM SCAN] key on the remote control to search all available stations.
5. Press the ⏮ or ⏭ buttons on the speaker or the "CH+" or "CH-" key on the remote control to select a preset station.



FCC Compliance Statement: This device complies with Part 15 of the FCC rules. Operation is subjected to the following two conditions: (1) this device may not cause harmful interference, and (2) this device must accept any interference received, including interference that may cause undesired operation.

Changes or modifications not expressly approved by the party responsible for compliance could void your authority to operate the equipment.