



### OPERATION SYMBOLS

▶ Press

▶▶ Press and Hold



- PanoComputer data syncs with Topeak PanoBike App only.
- Please read all instructions before first use!
- Before riding, close the PanoBike App on your smart device to record ride data in Computer Mode.

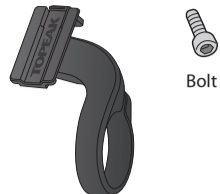
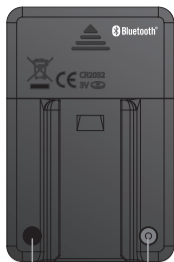

Bolt

**MODE Button** **M**

**RESET Button** **SET Button**

(▶▶ 3 sec to clear and reset all data)

PanoComputer Mount  
(Fits  $\varnothing$  31.8 mm Handlebar only)

- ▶ 1 sec: select digit
- ▶▶ 3 sec: go to next section / into setting mode
- ▶▶▶ 6 sec: switch COMPUTER MODE and CLONE MODE.

### REQUIRED ACCESSORIES

PanoBike Heart Rate Monitor  
Art No. TPB-HRM01



PanoBike Speed & Cadence Sensor  
Art No. TPB-CS01



### PanoComputer includes "DUAL MODE" function

#### [ COMPUTER MODE ]



Sensors transmit ride data to **computer** directly. After riding, data can be transferred to PanoBike App on your smart device.

#### [ CLONE MODE ]

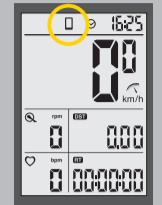

Sensors transmit ride data to **PanoBike App on your smart device** and displays ride data on computer. Smart device screen is turned off to save battery.

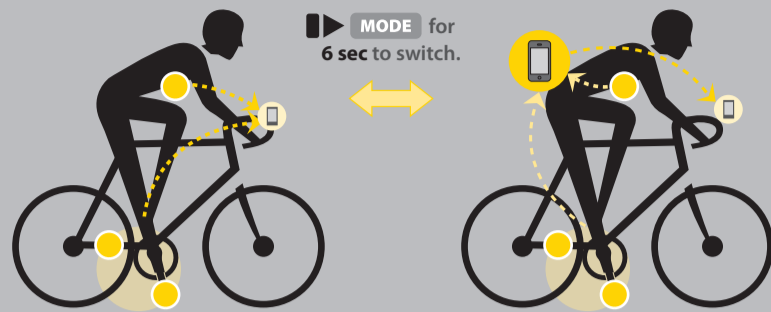

## HOW TO SET UP YOUR PANOCOMPUTER

### OPTION A [ COMPUTER MODE ] | OPERATE THE COMPUTER

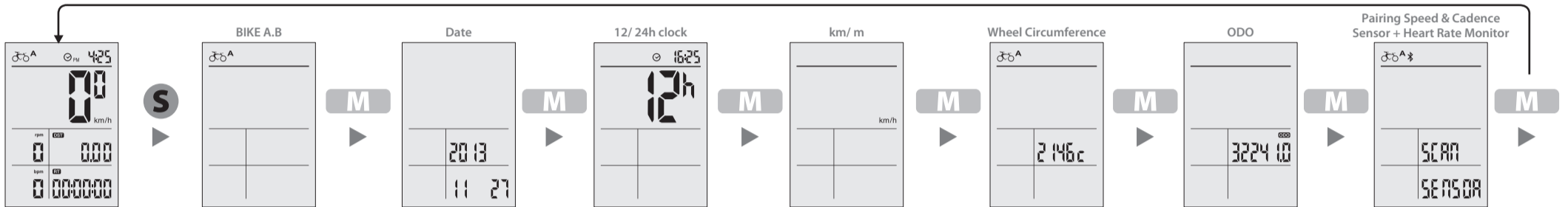

Follow the procedure in each section to set up your computer:

- ▶▶ **M** to enter each setting mode.
- ▶▶ **M** to change digit. ▶▶ **M** to next selection.
- Keep following the 1 & 2 processes for the rest of setting then ▶▶ **S** to confirm.

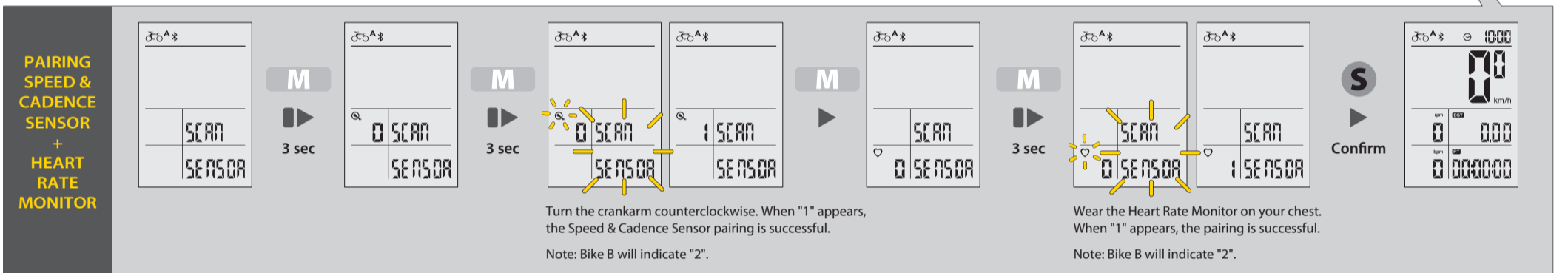

### SCREEN DISPLAY (RIDING STATUS) (COMPUTER MODE ONLY)

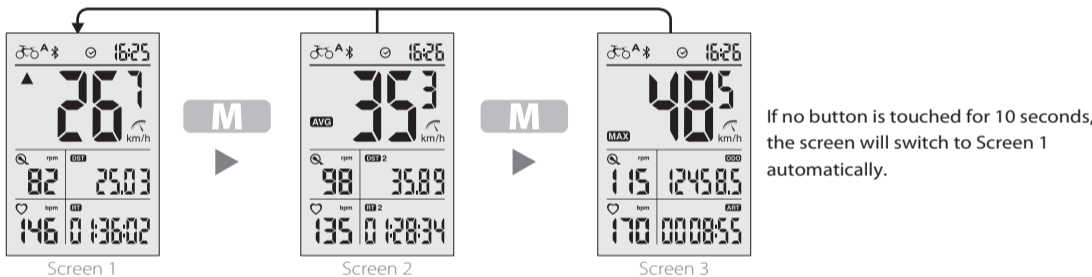

If no button is touched for 10 seconds, the screen will switch to Screen 1 automatically.

### SAVING RIDING DATA (COMPUTER MODE ONLY)

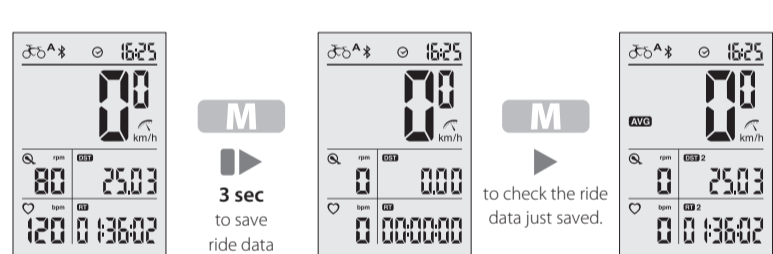

### OPTION B [ CLONE MODE ] | SETTING THE COMPUTER WITH PANOBIKE APP (Using English version as an example)

⚠ Please download and install Topeak PanoBike App from Apple App Store or GooglePlay to your smart device first.

- Open PanoBike App in your smart device then tap "Bluetooth" icon.
- ▶▶ **M** On computer for 6 sec to enter CLONE MODE.
- Tap "Setup" button to pair smart device with computer. Choose desired time and unit format. Insert power zones and wheel size setting. Tap "Save" to complete.
- ▶▶ **M** for 6 sec to return to COMPUTER MODE.

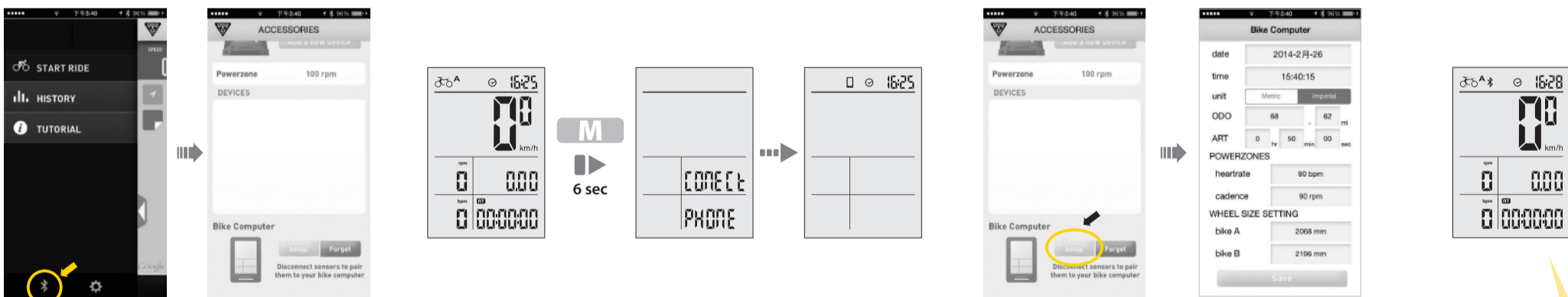

⚠ Follow the pairing procedures to pair Speed & Cadence Sensor and Heart Rate Monitor as in OPTION A.

### HOW TO OPERATE IN CLONE MODE (SECOND MONITOR function) (Using English version as an example)

- ▶▶ **M** On computer for 6 sec to enter CLONE MODE.
- Open Topeak PanoBike App. Tap "START RIDE", then tap "START" to record your ride.
- ▶▶ **M** for 6 sec to return to COMPUTER MODE after riding.

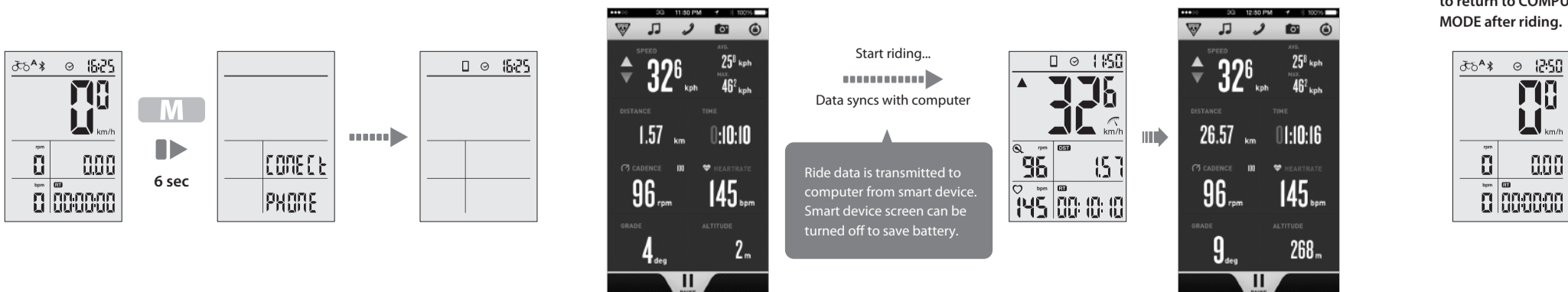

Tap **||** to stop and save ride data to your smart device.

PREPARE TO RIDE



## TRANSMITTING RIDE DATA TO PANOBIKE APP (COMPUTER MODE ONLY) (Using English version as an example)

1 **M** On computer for 6 sec to enter CLONE MODE.

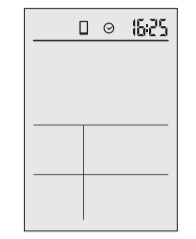

The computer is ready to transmit your riding data.

2 On Smart Device, open Topeak PanoBike App and tap "History" icon

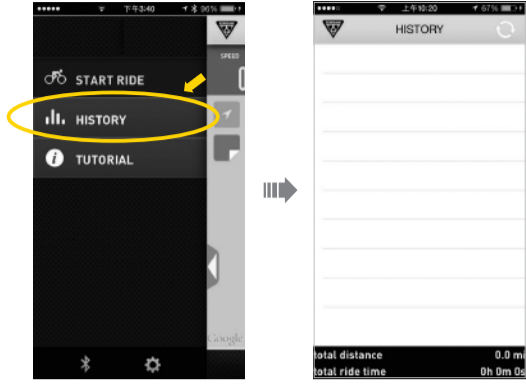

3 Tap "↻" to transfer new ride data to Topeak PanoBike App.

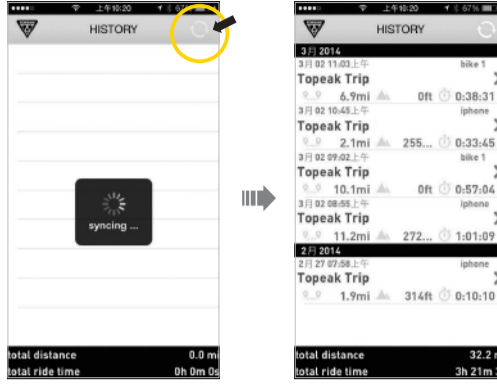

4 **M** for 6 sec to return to COMPUTER MODE.

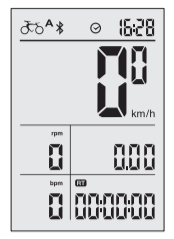
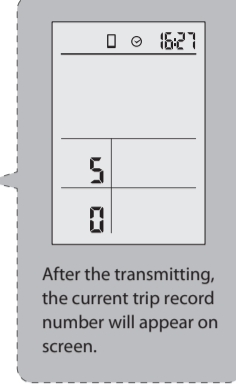

Turn-on Bluetooth® on your smart device first.

NOTE: Any transmitted data deleted from smart device history cannot be recalled from PanoComputer.

### HOW TO INSTALL PANOCOMPUTER

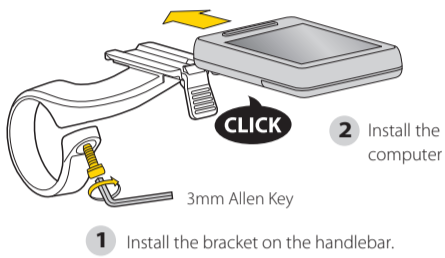

### HOW TO RELEASE PANOCOMPUTER

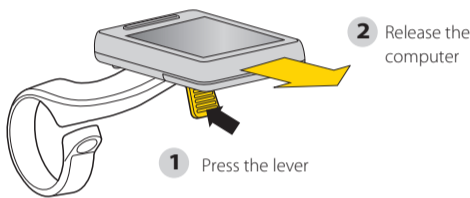

DISPLAY	FUNCTION	SPECIFICATIONS	INCREMENTS	ACCURACY
	Current Speed	199 km/h, 199 mi/h	0.1 km/h or mi/h	± 1 %
<b>AVG</b>	Average Speed	199 km/h, 199 mi/h	0.1 km/h or mi/h	± 0.1 %
<b>MAX</b>	Maximum Speed	199 km/h, 199 mi/h	0.1 km/h or mi/h	± 0.1 %
<b>DST</b>	Trip Distance	0.00~9999.99 km or m	0.1 km or m	± 0.1 %
<b>ODO</b>	Accumulated Distance	0.00~99999.9 km or m	0.1 km or m	± 0.1 %
<b>RT</b>	Ride Time	0 : 00 : 00~99 : 59 : 59	1 Second	± 0.1 %
<b>ART</b>	Accumulated Ride Time	0000 : 00~9999 : 59	1 Minute	± 0.1 %
<b>LO</b>	Low Battery Indicator	< 2.7 V		
	12H/ 24H clock	1 : 00 ~ 12 : 59 (12 H) 0 : 00 ~ 23 : 59 (24 H)	1 Minute	± 0.003 %
	Pace Indicator			
	Bike A and Bike B			
	Current Cadence *	0~199 RPM		
	Current Heart Rate *	0~199 BPM		
	Bluetooth® System			
	SmartPhone Connected			

\* "Current Cadence" Requires optional PanoBike Speed & Cadence Sensor.  
\* "Current Heart Rate" Requires optional PanoBike Heart Rate Monitor.  
\* Wheel circumference default: 2235 mm

### DETERMINE WHEEL CIRCUMFERENCE

#### METHOD A) CHOOSE FROM WHEEL CIRCUMFERENCE DATA BELOW

Tire Size Designation	Wheel Circumference	Tire Size Designation	Wheel Circumference		
40-305	16x1.50	1185	650C Tubular	1920	
47-305	16x1.75	1195	20-571	650x20C	1938
34-305	16x2.00	1245	23-571	650x23C	1944
40-355	18x1.50	1340	25-571	650x25C	1952
47-355	18x1.75	1350	57-584	27.5x2.25(650B)	2217
40-406	20x1.50	1490	60-584	27.5x2.35(650B)	2230
47-406	20x1.75	1515		700C Tubular	2130
47-507	24x1.75	1890	20-622	700x20C	2086
50-507	24x2.00	1925	23-622	700x23C	2096
40-559	26x1.50	2010	25-622	700x25C	2105
47-559	26x1.75	2023	28-622	700x28C	2136
50-559	26x1.95	2050	30-622	700x30C	2146
54-559	26x2.10	2068	32-622	700x32C	2155
56-559	26x2.20	2083	35-622	700x35C	2168
38-622	700x38C	2180	54-622	29x2.10	2288
56-622	29x2.00	2272	57-622	29x2.25	2320

#### METHOD B) MEASURE WHEEL CIRCUMFERENCE

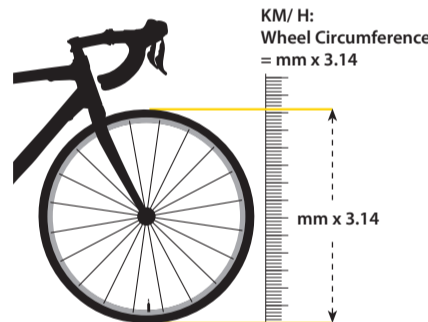

### LOW BATTERY

Battery < 2.7 V

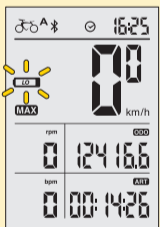

### MAX HEART RATE ALARM

For your safety, PanoComputer has a Max Heart Rate Alarm function. When Heart Rate exceed Max limit, the Heart icon will be shown in black. Set Max Heart Rate limit in Topeak PanoBike App.

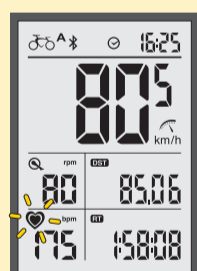

\* "HEART RATE" Requires optional PanoBike Heart Rate Monitor.

### CHANGING BATTERY

Operation Time up to 360 hrs.

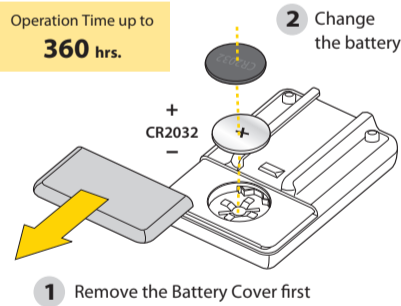

### IMPORTANT NOTE

- CLEAR ALL DATA SETTING will clear all stored data.
- CLEAR ALL DATA SETTING is required during FIRST SETUP or BATTERY CHANGE.
- All data will be cleared when replacing the battery. Before changing battery, write down stored data ODO and ART.
- The TOPEAK PANOCOMPUTER can be used in the rain but should not be intentionally submerged underwater.
- Do not leave the computer exposed to direct sunlight when not riding the bicycle.
- Do not disassemble the computer body or its accessories.
- Check relative positions and gap between sensor and magnet periodically.
- Do not use harsh chemicals to clean the computer body or its accessories.
- Remember to pay attention to the road while riding.
- Check the computer mount before each ride to ensure a secure connection.
- Dispose of used batteries according to local regulations.

### TROUBLE SHOOTING

Check the following before bringing unit in for repair.

PROBLEM	CHECK ITEMS	REMEDY
No display	1. Is the battery exhausted? 2. Is the battery installed correctly?	1. Replace the battery. 2. Make sure that the positive (+) pole of the battery is facing the battery cap.
No current speed or incorrect data	1. Is it in setup mode? 2. Are the relative positions and gap between sensor and magnet correct? 3. Is the wheel circumference correct?	1. Refer to the data setting procedure and complete the adjustment. 2. Refer to INSTALLATION and re-adjust correctly. 3. Refer to CIRCUMFERENCE SETTING and enter correct value.
Irregular display		Refer to "Clear All Data setting" and initiate the computer again.
LCD is black	Did you leave the computer in direct sunlight when not riding the bicycle for a long while?	Place the computer body in the shade to return to normal state.
Display is slow	Is the temperature below -10°C (14°F)?	The unit will return normal state when the temperature rises.
No current heart rate data	1. Is the chest strap being worn correctly? 2. Is the battery of heart rate monitor exhausted?	1. Make sure the position of chest strap is correct. 2. Replace the battery.

### SLEEP MODE

**in COMPUTER MODE**

During non-riding status, if no button is touched for 10 minutes, the computer will go into Sleep Mode. Please press "MODE" to wake up the computer.

**in CLONE MODE**

During non-riding status, if no Bluetooth® signal is connected, the computer will go into Sleep Mode after 2 minutes. Please press "MODE" to wake up the computer.

### SPECIFICATION

Tech: Bluetooth® Smart (BLE 4.0) super low energy technology  
 Mount: Handlebar Mount (ø 31.8 mm only)  
 Battery Lifetime (max.): 360 hours (1 hr/ day use) \*  
 Battery: CR2032 x 1 pc (included)  
 Transmission Range: <10 meter (33 ft)  
 Waterproof: IPX 7  
 Operating temperature: -10°C ~ 50°C (14°F~122°F)  
 Weight: 30 g / 1.06 oz (computer only)

\* Overall battery life is dependent on usage profile and battery condition.

### TOPEAK PANOBIKE APP

The ultimate cycling performance app that utilizes your smartphone's powerful Bluetooth® Smart capabilities and transforms it into your bike computer, personal training and health management device. This app combines the functions of phone, cycle computer, GPS, music player, camera, and heart rate monitor (requires purchase of separate PanoBike Heart Rate Monitor) into one program that allows you to have loads of fun on your bike ride.

PanoComputer Syncs with PanoBike App only.



iOS 5 or above



(Download for Free)



Android OS 4.3 or above



(Download for Free)

### OPTIONAL ACCESSORIES

RideCase Mount RX  
Art No. TC1022



PanoComputer Mount  
Art No. TPB-CM01



### WARRANTY

2-year Warranty: All electronic and mechanical components against manufacturer defects only. Batteries are not covered under any implied warranty.

#### Warranty Claim Requirements

To obtain warranty service, you must have your original sales receipt. Items returned without a sales receipt will assume that the warranty begins on the date of manufacture. All warranties will be void if the product is damaged due to user crash, abuse, system alteration, modification, or used in any way not intended as described in this manual.

\* The specifications and design are subject to change without notice.

Please contact your Topeak dealer with any questions.

For USA customer service, call: 1-800-250-3068

Website: www.topeak.com

