

FCC TEST ABOUT 0205 ANTENNA:

The antenna screw of 0205 is of M4×0.7 specifications. This specification of the antenna screw is different from the common specifications found in the market M2.5×0.45 and M3×0.5, which are incompatible.

The antenna fixing nut in the 0205 transmitter is of M4×0.7 specifications. This specification of the transmitter's nut is different from the common specification found in the market M2.5×0.45 and M3×0.5, which are incompatible.

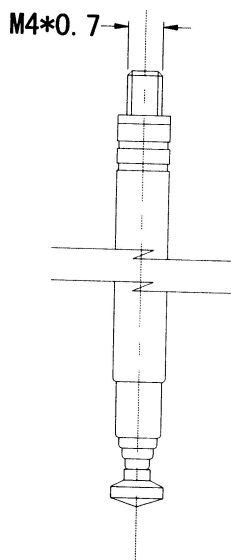

**0205 USING
ANTENNA**

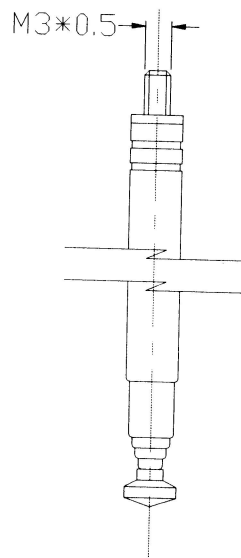

**COMMON
ANTENNA**

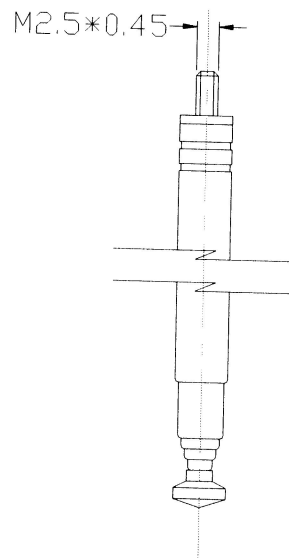

**COMMON
ANTENNA**