

MINI HELI

3 CHANNEL REMOTE CONTROL HELICOPTER



S100
2.4GHz

INSTRUCTION MANUAL

- Easy to fly with one key take-off & landing and auto-hover
- Extra durable and built to withstand crashes
- Intended for indoor use (or outdoors with little or no wind)

Accreditation standard: GB/T26701-2011

The materials, specifications, parts and packaging mentioned in this manual are for reference purposes only. We are not responsible for any changes made to this printed material, nor are we able to inform customers of any updates or changes. Please refer to our website: R3VOLT.com for the latest information.

Important safety information

Thank you for purchasing this REVOLT item. To ensure that you operate the aircraft correctly, please read these instructions carefully before first use and store them in a safe place for future reference.

Safety Information:

Conditions to be observed when using S100 MINI HELI:

- The S100 MINI HELI should be used with caution as skill is required to control the flight and avoid collisions with the user, objects, or third parties. Users should be aware of their surroundings and fly the helicopter responsibly.
- Keep the smaller-sized accessories out of reach of children.
- Children must be supervised by an adult when operating the aircraft. The aircraft should always remain within the line of sight of the pilot (or instructor).
- This aircraft can move quickly. When flying for the first time, push left joystick up slowly to prevent the aircraft from ascending too rapidly and causing damage or collisions.
- When the MINI HELI is airborne, it should be kept at least 2-3m away from the pilot and other people to avoid the risk of a collision.
- Maintain a safe distance from the spinning propellers! Do not fly near the face. Do not touch the rotating propellers, avoid loose clothing or hair that can be caught in the propellers.

- In order to prevent interference with air traffic control systems, it is forbidden to use remote controls within a 5,000m radius of an airport runway (calculated from the centre of the runway). Always comply with remote control restriction orders issued by national authorities.

Battery safety and maintenance:

- Do not recharge non-rechargeable batteries. When installing or changing the batteries, ensure that they are connected in the correct polarity. Do not mix old and new batteries or different types of batteries.
- Do not short circuit the battery terminals.
- You must only use the transformer included with MINI HELI for charging the helicopter's battery. The transformer is not part of the helicopter itself. Before cleaning the MINI HELI make sure to disconnect the charging cable from the MINI HELI.
- Regularly inspect the transformer wires, plug socket, outer casing, and other accessories for any signs of damage. If any damage is found, discontinue use immediately until the fault has been repaired.

- Do not store the battery in a hot environment (e.g. near open flames or a heating device).
- When the flight has ended, switch off the remote control before switching off the power on the aircraft.
- After use, ensure that the MINI HELI and remote control are switched off and remove the batteries in the remote control.

- If you do not plan to use the MINI HELI for at least 10 days, discharge the battery to 40%-50% (i.e. if the battery is fully charged, fly the helicopter for half of the total flight time). This helps to prolong the lifespan of the battery.

Repair and maintenance:

- Clean the helicopter with a clean, soft cloth.
- Avoid exposing the MINI HELI or battery to direct sunlight or heat.
- Do not submerge the MINI HELI or battery in water, as this may damage the electrical components.
- Regularly inspect the propellers, motor and battery. If there are any signs of damage, discontinue use immediately until the fault has been repaired.

-1-

CONTENTS

- Helicopter
- Remote Control
- Spare tail blade
- Instruction manual
- USB Charging cable



REMOTE CONTROL

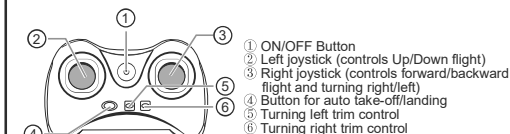

Remote Control Battery Installation

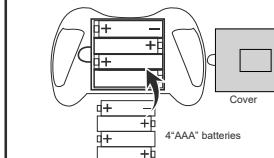

To insert batteries into the remote control, remove the screw and remove the battery cover. Insert 4 × AAAA alkaline batteries, ensuring that you observe the polarity markings (batteries are not included and must be purchased separately)

1. When installing the batteries, ensure that you match the + and - ends of the battery with the + and - signs inside the battery compartment.
2. Do not mix old and new batteries.
3. Do not mix different types of batteries.

-2-

FLIGHT PREPARATION, PAIRING THE REMOTE CONTROL WITH THE MINI HELI



Step 1: Press the power switch to turn on the remote control.

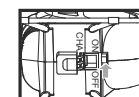

Step 2: Turn on the helicopter.



Step 3: Move the left joystick up to the highest point and then down to the lowest point.



After moving the left joystick up and down, the light on the remote control will stop flashing. The helicopter and remote control are paired.

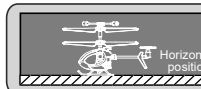

TIPS: When pairing the helicopter with the remote control, keep the helicopter in a horizontal position for fastest pairing and starting a stable flight.

-3-

FLIGHT CONTROL

Fly up and down

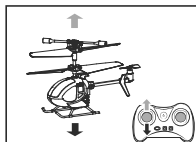

After pairing the MINI HELI with the remote control. Gently push the left joystick up to take off. Once you reach the desired height, release the joystick and the helicopter will hover automatically. Use small adjustments on the joystick to change the flight

Forward and backward

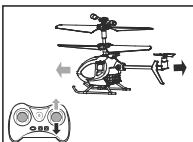

To fly the helicopter forward or backward, simply move the right joystick up or down. Moving it up will make the helicopter fly forward, while moving it down will make it fly backward.

Turn Left and Right



To rotate the MINI HELI, use the right joystick. Pushing it to the right will make the helicopter rotate right, while pushing it to the left will make it rotate left.

Right/Left Calibration Trim

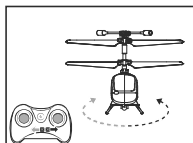

To address undesired rotation issues during flight, use the trim control buttons on the remote control. If the helicopter rotates counter-clockwise, press the "Left trim control" button until the rotation stops. Conversely, if it rotates clockwise, press the "Right trim control" button until the rotation stops.

-4-

OPTIONS FOR TAKING OFF/LANDING:

After pairing the remote control with the helicopter, there are two options for taking off & landing:

JOYSTICK CONTROLLED TAKE-OFF/LANDING:

Move the left joystick upwards to take off. Release the joystick (return to the centre position) once reaching the desired height. Move the left joystick down to reduce flight height and land.

ONE-BUTTON TAKE OFF/LANDING:

Press the "take-off" button and the helicopter will automatically take off and fly up to a height of appr. 1.5 meters (4-5 feet). Press the "take-off" button again and the helicopter will automatically land.

One-key take-off/landing



HELICOPTER CHARGING

Charging instructions:

- 1) Switch off the helicopter. (On/off switch is at the bottom of the helicopter)
- 2) Insert the charging cable into a USB port. (The indicator light on the charging cable will light up)
- 3) Connect the charging cable to the helicopter. (The indicator light on the charging cable will go off while charging)
- 4) Charging time is about 20 min. (The indicator light on the charging cable will light up when fully charged)
- 5) Unplug the charging cable once the helicopter is fully charged.

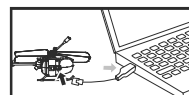

Charging time: about 20 minutes; Flying time: about 5 minutes

Note: Make sure helicopter power switch to OFF position when charging.

-5-

TROUBLE SHOOTING

Problem	Reason	Solution
No response from the helicopter	1. Insufficient power with the helicopter. 2. Insufficient power with the remote control. When the remote control power is low, the power indicator light will flash.	1. Please charge to the helicopter. 2. Replace the battery inside the remote control.
The helicopter is slow to respond or difficult to maneuver	1. Insufficient power with the remote control. 2. Remote control of the same frequency is used nearby.	1. Replace the battery in the remote control. 2. Use the helicopter out of the range of other RC helicopters.

DIMENSIONS

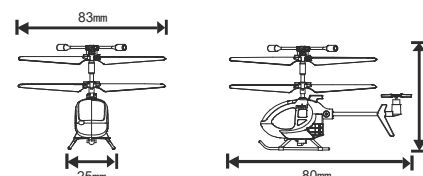

Body length: 80mm
Body width: 25mm
Body high: 60mm
Main blade diameter: 83mm
Main motor code: 6
Battery: 3.7V 70 mAh Li-poly



SPECIFICATIONS AND COLORS OF CONTENTS MAY VARY FROM PHOTO.

-6-

Manufacturer:
Guangdong SYMA Model Aircraft Industrial Co., Ltd.
Address: 2 West Xingye Rd, Laimei Industrial Area, Chenghai, Shantou, China
Postal Code: 515800
Sales department: +86 0754 86980668
After-sales service: +86 0754 86395095
Fax: +86 0754 86395098
Website: www.symatoys.com
Email: syma@symatoys.com

The company has the right of final interpretation of this user manual.

FCC STATEMENT

This device complies with Part 15 of the FCC Rules. Operation is subject to the following two conditions: (1) this device may not cause harmful interference, and (2) this device must accept any interference received, including interference that may cause undesired operation.

Changes or modifications to this unit not expressly approved by the party responsible for compliance could void the user's authority to operate the equipment.

NOTE: This equipment has been tested and found to comply with the limits for a Class B digital device, pursuant to Part 15 of the FCC Rules. These limits are designed to provide reasonable protection against harmful interference in a residential installation. This equipment generates uses and can radiate radio frequency energy and, if not installed and used in accordance with the instructions, may cause harmful interference to radio communications. However, there is no guarantee that interference will not occur in a particular installation. If this equipment does cause harmful interference to radio or television reception, which can be determined by turning the equipment off and on, the user is encouraged to try to correct the interference by one or more of the following measures:

- Reorient or relocate the receiving antenna.
- Increase the separation between the equipment and receiver.
- Connect the equipment into an outlet on a circuit different from that to which the receiver is connected.
- Consult the dealer or an experienced radio/TV technician for help.

This device and its antenna(s) must not be co-located or operation in conjunction with any other antenna or transmitter.

Radiation Exposure Statement

The device has been evaluated to meet general RF exposure requirement in portable exposure condition without restriction.