

Operations

(a) Using the Audio Streaming Function(A2DP Mode)

BD23 can transmit and stream an audio signal to a compatible Bluetooth headset, but it first needs to search for a headset to pair up with. To pair this device to a headset which PIN code is "0000". You need to do the following:

1. Check the BD23 is turned OFF, then press and hold down the "ON/OFF" button until LED light flash rapidly. Then release the button. This means the BD23 is searching for a headset to pair up with.
2. Once the BD23 searches and pairs a compatible headset the LED will flash more slowly - only once per second.
3. If you turn off BD23, when you turn BD23 ON again by pressing the ON/OFF button for no longer than 1 second. It will now connect automatically to the headset it was just paired with.

(b) Using the USB Port (HCI Mode)

As soon as the USB plug is connected to a USB port of your PC or notebook, BD23 will automatically turn on and the LED light will remain on constantly. Then simply activate the Bluetooth software "BlueSoleil".

Note: BD23 has a fixed PIN code number of "0000".

FCC Statement

This device complies with Part 15 of the FCC Rules. Operation is subject to the following two conditions: (1) this device may not cause harmful interference, and (2) this device must accept any interference received, including interference that may cause undesired operation.

Warning: Changes or modifications to this equipment not expressly approved by the party responsible for compliance could void the user's authority to operate the equipment.

NOTE: This equipment has been tested and found to comply with the limits for a Class B digital device, pursuant to Part 15 of the FCC Rules. These limits are designed to provide reasonable protection against harmful interference in a residential installation. This equipment generates, uses and can radiate radio frequency energy and, if not installed and used in accordance with the instructions, may cause harmful interference to radio communications. However, there is no guarantee that interference will not occur in a particular installation. If this equipment does cause harmful interference to radio or television reception, which can be determined by turning the equipment off and on, the user is encouraged to try to correct the interference by one or more of the following measures:

- Reorient or relocate the receiving antenna.
- Increase the separation between the equipment and receiver.
- Connect the equipment into an outlet on a circuit different from that to which the receiver is needed.
- Consult the dealer or an experienced radio/TV technician for help.

Supported Languages

- Danish
- Dutch
- English
- French
- Finnish
- German
- Italian
- Japanese
- Korean
- Norwegian
- Polish
- Portuguese
- Russian
- Spanish
- Swedish
- Simplified Chinese
- Traditional Chinese

Table of contents

Introduction	3
Package Contents	3
Appearance	4
Operation	5
Operation - Quick Guide	6
Important Information	7
Warranty	8
FCC statement	9
BlueSoleil - BlueSoleil VoIP version for Windows	10
Typical Usage Scenario	11
Platform Requirement	12
Supported Languages	13
Extended Features	14
Download & Install software	14
BlueSoleil VoIP Edition Quick Installation Guide	15
BlueSoleil General Function Guide	26
This User's Guide is published by ATA without any warranty. Improvements and changes to this User's Guide necessitated by typographical errors, inaccuracies of current information, or improvements to programs and/or equipment, may be made by ATA at any time and without notice.	

The Bluetooth trademarks are owned by Bluetooth SIG, Inc.USA.

Operations - Quick Guide

(a) Using the Audio Streaming Function (A2DP Mode)

Power	Action	LED Light
Off	Off	Off
After holding down ON/OFF for 5 seconds	Searching for an available headset to pair up with	Flashing rapidly
On	Paired up with a compatible Bluetooth headset	Flashing once per second

(b) Using the USB Port (HCI Mode)

Power	Action	LED Light
Off	USB Disconnected	Off
On	Connected to USB port	Constantly on

BlueSoleil™ - BlueSoleil VoIP version for Windows

This version is based on the standard version.

BlueSoleil VoIP is specially designed for Skype, including all features of BlueSoleil (Std). You can answer a Skype call at anytime and anywhere, even when you are listening to music.

With the unique Bluetooth AV/Mono data channel co-working feature, BlueSoleil supports users to enjoy music and talk via normal Bluetooth Stereo/Mono headsets at the same time, or switch between the two modes easily. The plug-in for Skype, further makes it incredible easy to receive/make VoIP phone calls via a normal Bluetooth headset.

By using a Bluetooth radio dongle, BlueSoleil VoIP enables computers form networks and exchange information wirelessly. It also provides computers a fast and reliable wireless connection to mobile phones, headsets, PDAs, LAN Access Points, Printers, Digital Cameras, PC peripherals, and so on.

Extended Features

The software extends the standard Bluetooth functionality with the following features:

- Support Skype
- Receiving incoming calls with Bluetooth headset (Mono and Mono/Stereo)
- Auto switch between Skype call and music

Download & Install software

1. Log in www.bluesoleil.com, enter the Downloads page and start to download the latest BlueSoleil VoIP version and BlueSoleil standard version.
2. Once the version you chose has been downloaded in your computer, click the file Setup.exe in the folder to install the specified software. After the installation, launch BlueSoleil. Quick Guide

Introduction

Thank you for purchasing the BD23 Bluetooth Dual Dongle by ATA. This dongle allows you to switch easily between "Audio" and "USB" modes. When in "Audio" mode you can connect the device to an audio source (for example a CD or MP3 player using the 3.5mm jack) and then the device will stream the audio signal to a compatible headset so you can listen to music. When it is switched to "USB" mode it can connect to relevant Bluetooth devices and perform actions such as Bluetooth File Transfer, Bluetooth Human Interface Device Service and Bluetooth Basic Imaging Services under the application program "BlueSoleil" which is installed in your PC or notebook.

Package Contents

BD23 Bluetooth Dual Dongle
USB Cable
User's Manual
AAA battery

The equipment is to be supplied from an identified USB port complying with the requirements to Limited Power Source.

Important Information

Please read all the below information before using this device.

1. Please note that only an ATA authorized dealer or service partner should remove, replace or repair this device and its components.
2. Please use ATA original accessories only. Use of non-ATA original accessories may result in damage, loss of performance to the product, injury, electrical shock or even fire.
3. Please do not expose the device to extreme high or low temperatures, moisture or fluid.
4. Please do not drop, throw or bend the device as rough treatment could damage it.
5. If this device is not going to be used for an extended period of time you should remove all batteries to prevent leakage, and store it in a dry, dust-free environment away from extreme temperatures.
6. Some medical equipment can be adversely affected by devices such as this. You should not use this device near medical equipment without permission.
7. Airline communications equipment can be adversely affected by devices such as this. You should not use this device on commercial aircraft.
8. Keep this device away from small children as it contains small parts.

Typical Usage Scenario

- BlueSoleil VoIP is specially designed for Skype, including all usage scenario of BlueSoleil (Std).
- Talk with your friends on an Instant messenger using Bluetooth headset



BlueSoleil VoIP Edition Quick Installation Guide

System Requirement
A PC or notebook running Windows 2000 or XP
Hardware Requirement
Processor - Minimum 266MHz, Recommend 1GHz
Memory - Minimum 64 MB RAM, Recommend 256 MB RAM
12 MB free space on hard disk

1. Install BlueSoleil
1.1 Click setup.exe to start installation.
1.2 Choose the setup language



Appearance

Front view

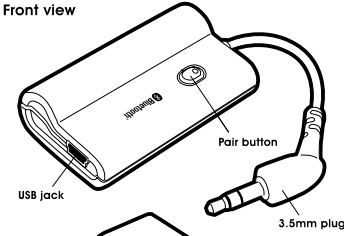

Back view

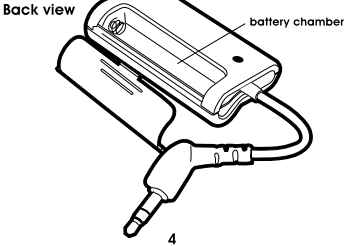

Warranty

Thank you for purchasing this Bluetooth Dual Dongle BD23. If this product fails to operate properly due to faulty assembly or materials within the specified warranty period then the authorized dealer will, at their option, either replace or repair the product in accordance with the following terms and conditions:

1. The warranty is valid only if the original receipt issued upon original purchase from an authorized ATA dealer is presented with the faulty product. The date of purchase and product serial number should be specified on the receipt. Please contact your local ATA dealer to find out more about their replacement policies and procedures.
2. The warranty does not cover any failure due to normal wear and tear or misuse (including but not limited to use in the manner outlined in this manual). The warranty also does not cover any failure of the product due to modification, adjustment, accident, acts of God or any improper use or storage.
3. The warranty does not cover product failure caused through the use of non-authorized ATA dealers or service partners.
4. The warranty does not cover product failures caused by the use of non-original ATA accessories.
5. ATA shall not be liable for any losses or damages whatsoever, including but not limited to any loss of profits, damage to property, personal injury or death arising under or related to the use of this product and/or any accompanying software or written material through any error deficiency or fault, whether such loss or damage is caused by negligence or otherwise.
6. The warranty terms and conditions are subject to change without notice.

Platform Requirement

- CPU: 600MHz or above
- RAM: 128M or above
- Screen: 800*600 or above
- OS: Windows 2000, Windows XP
- Skype: 1.3.0.67 or above

- 1.3 Go ahead following the instructions of the Wizard.
- 1.4 Restart your system.



- 1.5 Insert BD23 into USB port.

2. Install VoIP Software
BlueSoleil supports VoIP software Skype. Please make sure Skype has been installed on