

# HueDJ Lifestyle App

## Hue 彩光

### Light Bluetooth 彩光蓝牙



If linked, Pink with beep

Tap to link / 点击链接



### Remote

éloigné / entfernt / a distanza / remoto / 遙控 / 遙程 / 远 / リモート



Battery  
Green : > 85%  
Orange : 15% ~ 85%  
Red : < 15%

Light off

Sync Light / 节奏灯光  
Green : Fast / 快  
Blue : Slow / 慢

Home / Pink

Status / 状态灯光  
Green : Power on / 开机  
Blue : Bluetooth linked / 蓝牙已连接  
Orange : Wake on / 唤醒已设定

Tma : 35°C

Set up:

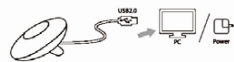

Where the MAINS plug or an appliance coupler is used as the disconnect device, the disconnect device shall remain readily operable

#### CAUTION

Danger of explosion if battery is incorrectly replaced. Replace only with the same or equivalent type.

A warning that batteries (battery pack or batteries installed) shall not be exposed to excessive heat such as sunlight, fire or the like

#### 注意

如果电池安装不当，会有爆炸的危险。

只准更换相同或同等类型的电池（或电池安装），不得曝露过多的热量，如阳光，火。

經型式認證合格之低功率射頻電機，非經許可，公司、廠、研發使用等均不得擅自變更。如大中華地區無線電頻率之修改及調整。  
低功率射頻電機之使用不得影響國家安全及無線電通訊；應設有干擾現象時，應立即停止使用，並按規定之時間及方式進行調整。  
如電機使用，應按電機使用說明書之規定進行調整。低功率射頻電機應符合法規之規定，如電機使用說明書之規定。



### Wake 唤醒

Alarm



Set up Wake Alarm

### Sleep 睡眠

Timer



Set up Sleep timer

### DJ



Play DJ (Beta version)  
Registration Required



Android and iOS APP

Q HueDJ

# Eye1 Lifestyle Stereo

Accessories	Eye1 Basic Pack 简配	Eye1A Full Pack 全配
 Micro USB cable	<input checked="" type="checkbox"/>	<input checked="" type="checkbox"/>
 Pouch	<input type="checkbox"/>	<input checked="" type="checkbox"/>
 Remote	<input type="checkbox"/>	<input checked="" type="checkbox"/>
 Soft cover	<input type="checkbox"/>	<input checked="" type="checkbox"/>

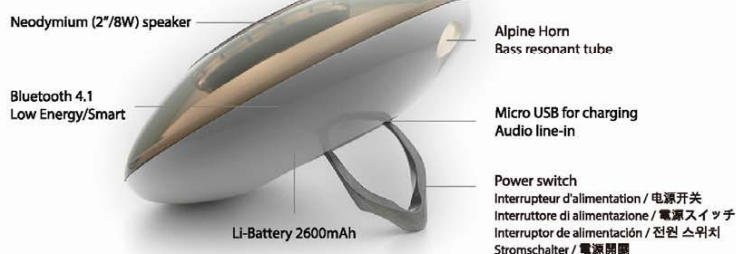

## Music Bluetooth 音乐蓝牙 + Light Bluetooth 彩光蓝牙

### Single 单机



Phone settings  
→ Bluetooth  
→ Eye1-xx yantouch

Tip: If bluetooth is failed to link:  
1) Delete "Eye1-xx yantouch" from your phone, and pair again.  
2) Power switch reset Eye1, and pair again.

~ 10m / 30' For most cases, distance should exceed 10m.

### Pair 对箱

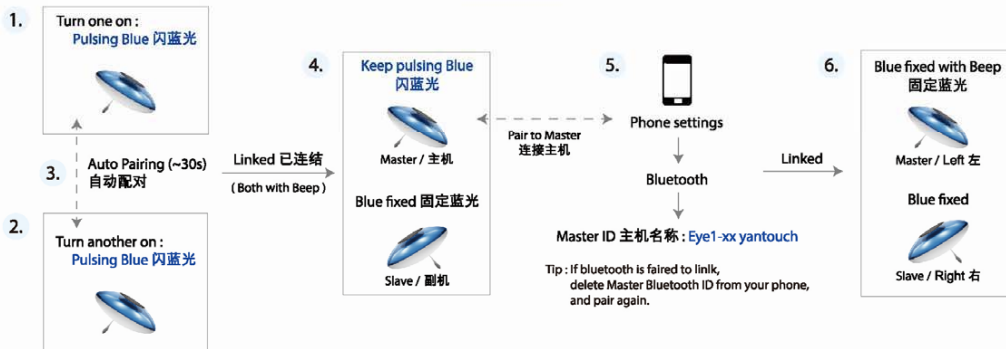

Tip: If auto pairing over 60 seconds, turn all devices off, and pair again.

~ 5m / 15'

~ 5m / 15'

For most cases, both working distances should exceed 5m. However, if there are many WiFi or Bluetooth devices around, the working distance may be less. When moving speakers around, it may take some adaptive time to settle

## **Federal Communication Commission Interference Statement**

This device complies with Part 15 of the FCC Rules. Operation is subject to the following two conditions: (1) This device may not cause harmful interference, and (2) this device must accept any interference received, including interference that may cause undesired operation.

This equipment has been tested and found to comply with the limits for a Class B digital device, pursuant to Part 15 of the FCC Rules. These limits are designed to provide reasonable protection against harmful interference in a residential installation. This equipment generates, uses and can radiate radio frequency energy and, if not installed and used in accordance with the instructions, may cause harmful interference to radio communications. However, there is no guarantee that interference will not occur in a particular installation. If this equipment does cause harmful interference to radio or television reception, which can be determined by turning the equipment off and on, the user is encouraged to try to correct the interference by one of the following measures:

- Reorient or relocate the receiving antenna.
- Increase the separation between the equipment and receiver.
- Connect the equipment into an outlet on a circuit different from that to which the receiver is connected.
- Consult the dealer or an experienced radio/TV technician for help.

FCC Caution: Any changes or modifications not expressly approved by the party responsible for compliance could void the user's authority to operate this equipment.

This transmitter must not be co-located or operating in conjunction with any other antenna or transmitter.

### **Radiation Exposure Statement:**

This equipment complies with FCC radiation exposure limits set forth for an uncontrolled environment. This equipment should be installed and operated with minimum distance 20cm between the radiator & your body.

Note: The country code selection is for non-US model only and is not available to all US model. Per FCC regulation, all WiFi product marketed in US must fixed to US operation channels only.