

NETGEAR®

Installation Guide

Ocuity 100 Wireless IP Camera HMNC100

Package Contents

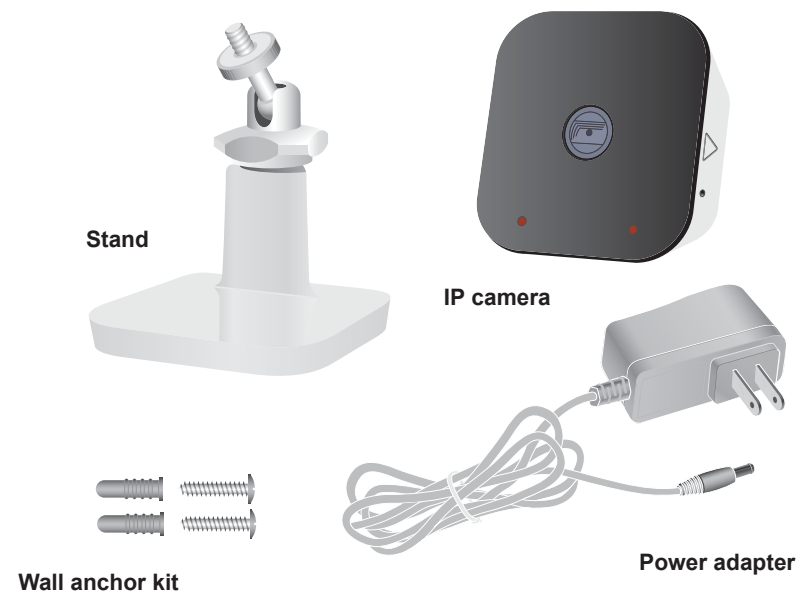

Camera Features



Connect the IP Camera

Note: To connect the camera, you need a router that is connected to a computer.

1. Connect the power adapter to the camera and plug it into an electrical outlet.
2. Connect your camera to a router.

Press the **WPS** button  on the side of the camera. Within two minutes, press the **WPS** button on your wireless router.

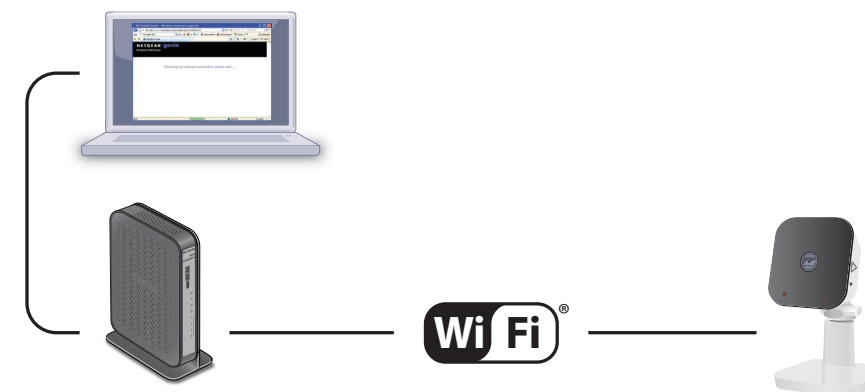

Support

Contact your service provider for technical support.

For compliance details, visit <http://www.netgear.com/about/regulatory/>.

For the current EU Declaration of Conformity, visit http://support.netgear.com/app/answers/detail/a_id/11621/.

Technical Specifications

Resolution	720p (1280 x 720)
Frame rate	30 FPS at 720p
Memory Buffer	30-second rolling buffer for pre-trigger event recording
Low-light capability	1 LUX (without IR LED)
Night vision	0 Lux -Range: 7M
Field of view	100 degrees diagonal
LEDs	2 bi-color (red/green) power and network LEDs
Power supply	1120 VAC to 5 VDC 2A with DC jack connector
WiFi	802-11n dual-band selectable - 2x2 with WPS 2.0
Mounting solution	<ul style="list-style-type: none">• Shelf or desk• Wall or ceiling (optional)
Connectors	<ul style="list-style-type: none">• Power• Network (over USB)
Multiple clients	Supports 4 simultaneous streams for multiple clients
API	PSIA

NETGEAR, the NETGEAR logo, and Connect with Innovation are trademarks and/or registered trademarks of NETGEAR, Inc. and/or its subsidiaries in the United States and/or other countries. Information is subject to change without notice. © NETGEAR, Inc. All rights reserved.



NETGEAR, Inc.
350 East Plumeria Drive
San Jose, CA 95134 USA

February 2014

Troubleshooting

To determine the status of the camera, use the LEDs on the front of the camera.

Left LED	Right LED	Behavior
Red	Red	The camera has power and is booting.
Off	Off	The booting sequence is complete, there is no WiFi link.
Off	Blinking green	The window is open for the camera to connect with other WPS-enabled devices.
Off	Green	The camera is connected to a WPS-enabled device.
Blinking green	Solid green	The camera is transmitting data over the WiFi link.

Wall Mounting

To wall-mount the camera, complete the following steps:

1. Drill holes in the wall where you will wall-mount the camera.
Holes should be xxx inches (xxx centimeters) center to center.

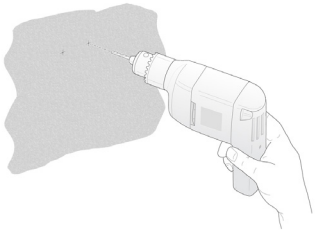

2. Install wall anchors in the holes.

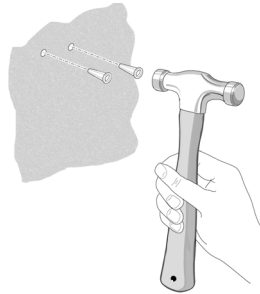

Use pan head Phillips wood screws, 3.5 x 20 mm (diameter x length, European) or #6 type screw, 1 inch long (U.S.).

3. Insert screws into the wall anchors, leaving 3/16 in. (0.5 cm) of each screw exposed.

