

Limited warranty

WHAT YOUR WARRANTY COVERS

This warranty extends only to the original user of the equipment ("you", "your") and is limited to the purchase price of each part. Amphony and its affiliated companies ("we", "our", "us") warrant this Wireless Subwoofer Kit against defects in materials or workmanship as follows.

LABOR: For a period of ninety (90) days from the original date of purchase, if we determine that the equipment is defective subject to the limitations of this warranty, we will replace it at no charge for labor. We warrant any such work done against defects in materials or workmanship for the remaining portion of the original warranty period.

PARTS: For a period of one (1) year from the original date of purchase, we will supply, at no charge, new or rebuilt replacement parts in exchange for parts we determine are defective subject to the limitations of this warranty. We warrant any such replacement parts against defects in materials or workmanship for the remaining portion of the original warranty period.

Note: "Parts" means items included in this package. It does *not* include other parts purchased separately.

WHAT YOUR WARRANTY DOES NOT COVER

This warranty *does not cover* consumer instruction, physical setup or adjustment of any consumer electronic equipment, or signal transmission problems.

This warranty *does not cover* cosmetic damage, damage due to the affixing of any attachment not provided with the product, loss of parts, connecting the product to any but the specified receptacles, lightning, electrical surges, fire, flood, or other acts of God, accident, misuse, abuse, repair or alteration by other than authorized service personnel, negligence, commercial or institutional use, or improper or neglected maintenance.

This warranty *does not cover* equipment sold AS IS or WITH ALL FAULTS, equipment removal or reinstallation, shipping damage if the equipment was not packed and shipped in the manner we prescribe, nor equipment purchased, serviced, or operated outside the contiguous United States of America.

LEGAL LIMITATIONS

REPLACEMENT AS PROVIDED UNDER THIS WARRANTY IS YOUR EXCLUSIVE REMEDY. WE SHALL NOT BE HELD LIABLE FOR ANY INCIDENTAL OR CONSEQUENTIAL DAMAGES FOR BREACH OF ANY EXPRESSED OR IMPLIED WARRANTY ON THIS EQUIPMENT, NOR FOR ANY INCIDENTAL OR CONSEQUENTIAL DAMAGES RESULTING FROM THE USE OF, OR INABILITY TO USE, THIS EQUIPMENT. UNDER NO CIRCUMSTANCES SHALL OUR LIABILITY, IF ANY, EXCEED THE PURCHASE PRICE PAID FOR THIS EQUIPMENT, EXCEPT TO THE EXTENT PROHIBITED BY APPLICABLE LAW. EXCEPT AS PROVIDED HEREIN, WE MAKE NO WARRANTIES, EXPRESS OR IMPLIED, INCLUDING WARRANTIES OF MERCHANTABILITY AND FITNESS FOR A PARTICULAR PURPOSE. WE RESERVE THE RIGHT TO REFUSE TO HONOR THIS WARRANTY IF WE DETERMINE ANY OF THE ABOVE EXCEPTIONS TO HAVE CAUSED THIS EQUIPMENT NOT TO HAVE PERFORMED PROPERLY. THIS WARRANTY SHALL BE VOID IF ANY FACTORY-APPLIED IDENTIFICATION MARK, INCLUDING BUT NOT LIMITED TO SERIAL NUMBERS AND WARRANTY LABELS, HAS BEEN ALTERED OR REMOVED. THIS WARRANTY SHALL ALSO BE VOID IF THE TRANSMITTER OR AMPLIFIER HAVE BEEN OPENED BY AN UNAUTHORIZED PERSON.

This warranty gives you specific legal rights which may vary from state to state. Some states do not allow the exclusion or limitation of incidental or consequential damages, or allow limitations on the duration of an implied warranty, so those limitations may not apply to you.

Note: No responsibility is assumed for the presence of interference outside of Amphony's control, such as other transmitters or cordless phones, which may hamper proper signal reception.

Amphony[®]

User and Installation Guide

iFinityTM Wireless Subwoofer Kit

Introduction

The iFinity wireless subwoofer kit solves your wiring dilemma when setting up a subwoofer or a pair of active speakers. Now you can easily place your subwoofer anywhere in your home or use a pair of speakers on your patio or by your pool.

Unpacking

Verify that this box contains:

- one wireless audio transmitter
- one wireless audio receiver
- two 7.5 Volt AC adapters (wallwarts)
- two RCA audio cables

Installation

Connect the first RCA audio cable to the transmitter audio input and your audio source. If you are connecting to a single (mono) audio output, simply leave the second audio plug unconnected. Then connect the first wallwart to the transmitter power input.

Next, connect the second RCA cable with the audio input of your active speakers, subwoofer or power amplifier. If you are connecting to a subwoofer, simply leave the second RCA plug unconnected. Finally, connect the second wallwart to the receiver power input.

Pairing

In order to stream audio, the receiver must first be paired with the audio transmitter.

First, press the pairing button of the audio transmitter. The transmitter network status light will start flashing quickly.

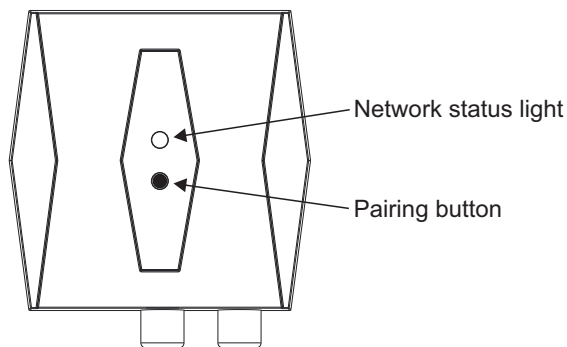

Please refer to the above drawing to locate the pairing button.

Now press the pairing button of the audio receiver within 5 minutes. Once the receiver locks to the transmitter signal, both the transmitter and receiver network status light will light continuously. You now should be able to hear the audio.

You can pair up to 4 wireless receivers with one transmitter.

Description of the network status light

Flashing Slowly: Not paired

Flashing Quickly: Pairing Mode

Always On: Audio is being streamed

Transmitter Connections

Note: Leave right RCA plug unconnected if you have a mono source.

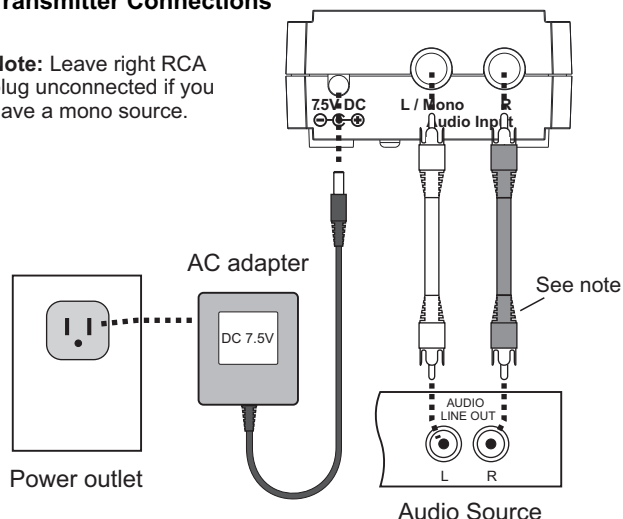

Copyright (C) 2014 Amphony. All rights reserved.

The information contained herein is subject to change without notice. Revisions may be issued to advise of such changes and/or additions.

All product names, trade names, or corporate names mentioned in this document are acknowledged to be the proprietary property of the registered owners.

Receiver Connections

Note: Leave right RCA plug unconnected if you are connecting to a subwoofer.

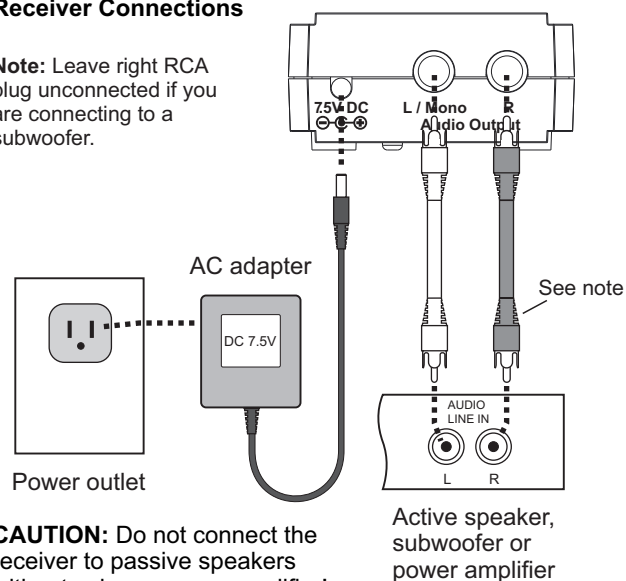

CAUTION: Do not connect the receiver to passive speakers without using a power amplifier! Do not connect the transmitter to amplified speaker outputs!

Technical Specifications

Audio transmission: Digital, uncompressed, bidirectional, adaptive FHSS

Transmitter frequency: 2.4 GHz

Transmitter operating range:

- max. 200 ft. line of sight
- max. 50 ft. through walls and ceilings

Frequency response: 2 Hz ... 20 kHz

Signal-to-noise ratio: 91 dB (A-weighted)

Total harmonic distortion: typ. -90 dB

Transmitter input voltage level: 0.7 Vrms

Receiver output voltage level: 1.1 Vrms

Max. number of receivers per transmitter: 4

Transmitted data rate: 5 Mbps

Channel separation: typ. 90 dB

Dimensions (transmitter & receiver): 2.6" x 2.3" x 1.1" (66 mm x 59 mm x 29 mm)

FCC ID: PMJTX2 (transmitter) and PMJRX2 (receiver)

This device complies with part 15 of the FCC Rules. Operation is subjected to the following two conditions: 1) This device may not cause harmful interference and 2) this device must accept any interference received, including interference that may cause undesired operation.

Caution: Any changes or modifications not expressly approved by the party responsible for compliance could void the user's authority to operate the equipment.

NOTE: This equipment has been tested and found to comply with the limits for a Class B digital device, pursuant to Part 15 of the FCC Rules.

These limits are designed to provide reasonable protection against harmful interference in a residential installation.

This equipment generates, uses and can radiate radio frequency energy and, if not installed and used in accordance with the instructions, may cause harmful interference to radio communications.

However, there is no guarantee that interference will not occur in a particular installation.

If this equipment does cause harmful interference to radio or television reception, which can be determined by turning the equipment off and on, the user is encouraged to try to correct the interference by one or more of the following measures:

- Reorient or relocate the receiving antenna.
- Increase the separation between the equipment and receiver.
- Connect the equipment into an outlet on a circuit different from that to which the receiver is connected.
- Consult the dealer or an experienced radio/TV technician for help.

FCC RF Radiation Exposure Statement:

1. This Transmitter must not be co-located or operating in conjunction with any other antenna or transmitter.
2. This equipment complies with FCC RF radiation exposure limits set forth for an uncontrolled environment. This device was tested for typical hand held operations with the device contacted directly to the human body to the sides of the device. To maintain compliance with FCC RF exposure compliance requirements, avoid direct contact to the transmitting antenna during transmitting.