

Instruction Manual

For

WC10HD



Digital Multimedia Technology Co., Ltd



Contents

I . Installing WC10HD

1. Component	3
2. Name of parts and role	3
2-1. Remote control.....	5
3. Installing	7

II . Notice

1. Dolby	8
2. UL.....	9
3. FCC.....	11

I . Installing WC10HD

1. Component

The following parts are included in the product package. Make sure that you received all the parts.

- Main body of WC10HD
- Remote Control
- Power adaptor
- RF Cable
- User Manual
- HDMI Cable

2. Name of parts and role

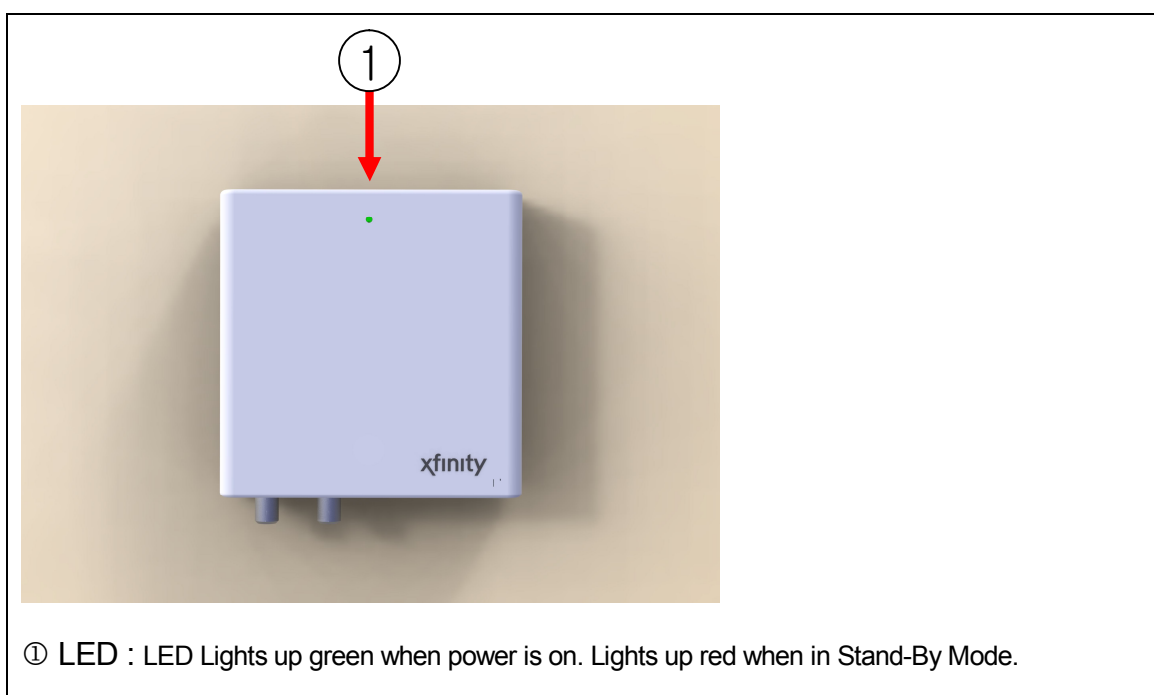

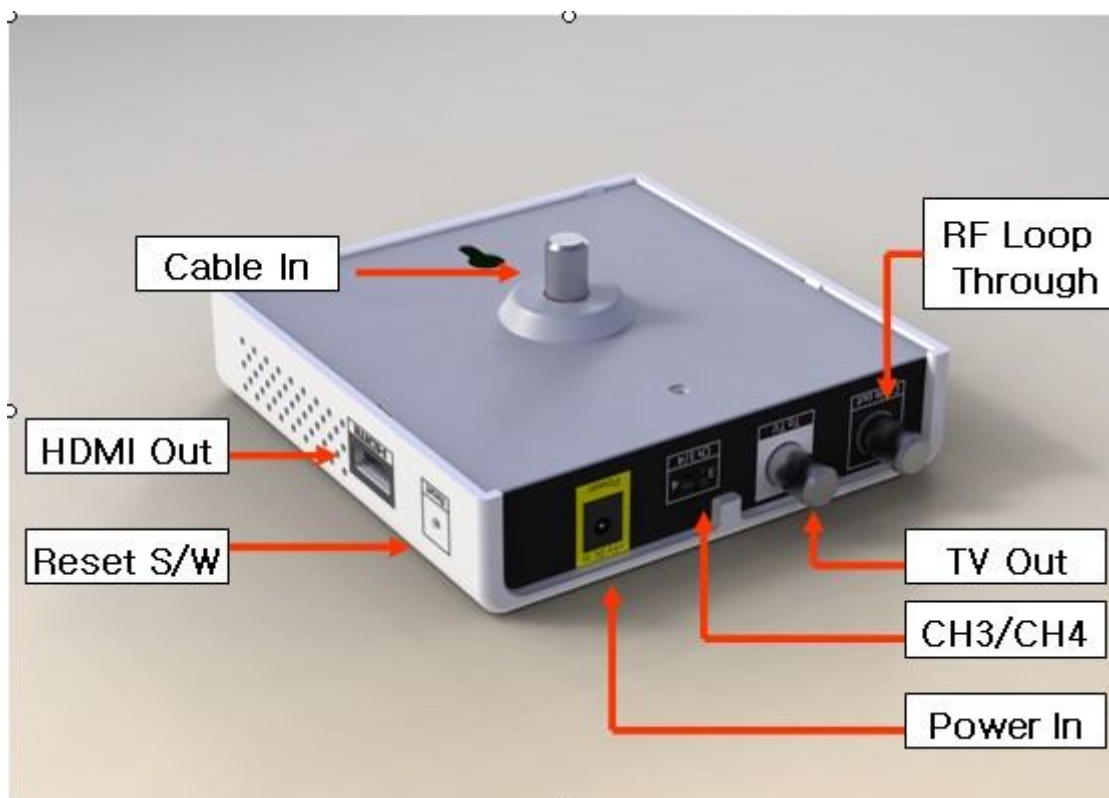

Cable In	(Coax Cable) Connects the All Digital Device to a TV, VCR or receiver using a coax cable.
TV Out	(Coax Cable) Connects the All Digital Device to a TV, VCR or receiver using a coax cable.
HDMI Out	(HDMI Cable) Connects All Digital Device to a high definition TV, VCR or receiver.
CH3/CH4	Selects TV Channel 3 or 4 as the output channel to your TV when the All Digital Device is connected using a coax cable from TV Out.
Power In	Connects the All Digital Device to a power source.

2-1. Remote control

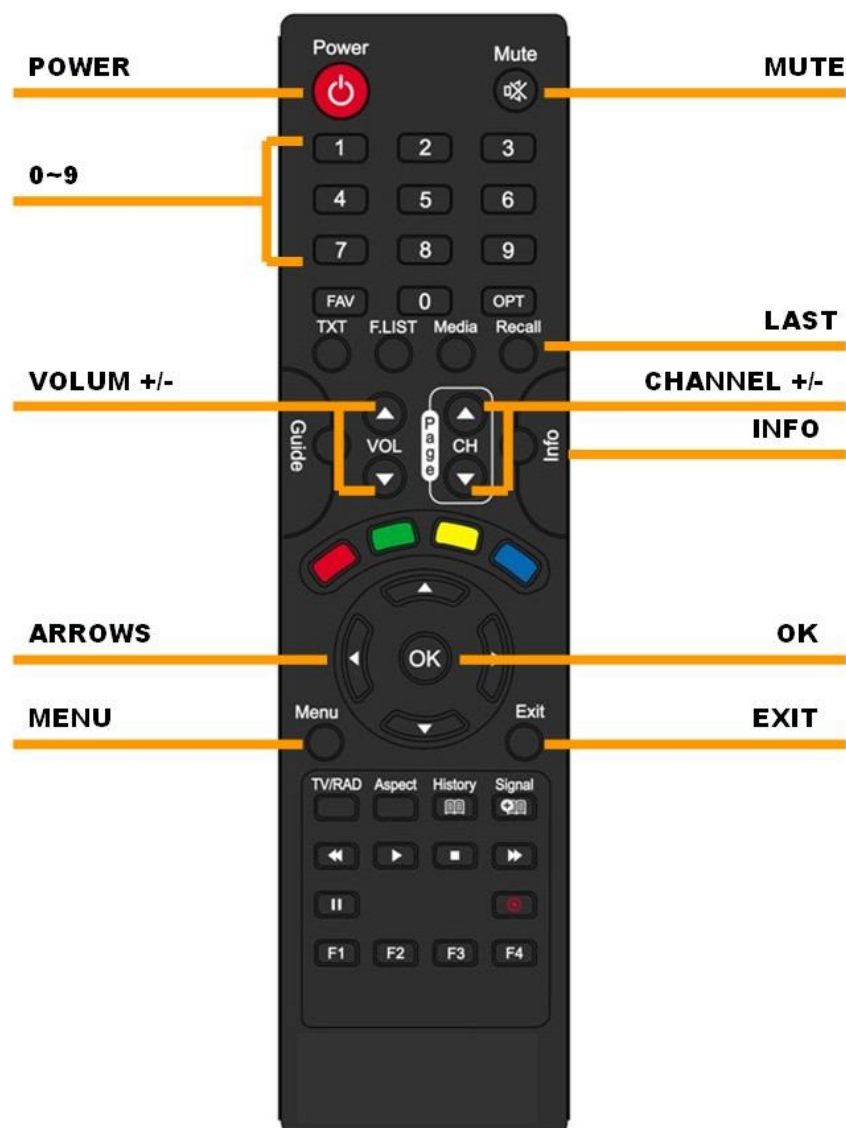

- ▶ Pressing the *MUTE* button on your remote control will mute the audio.
- ▶ Use the *VOLUME UP/DOWN* buttons (*V +/-*) on your remote control to raise and lower the volume.
- ▶ Use the *CHANNEL UP/DOWN* buttons (*CH +/-*) on your remote control to change channels.
- ▶ Press the *NUMERIC* buttons (*0-9*) on your remote control to tune directly to a specific channel.

- If the All Digital Device does not tune immediately after entering channel numbers, press the *ENTER* button on your remote control.

POWER	Switches the All Digital Device's power on or into Stand-By Mode.
MUTE	Mutes the audio.
0~9	Enters Channel Numbers. In text windows, enters PIN-Code Numbers and various characters.
LAST	Switches between the current and previous channel. In the MENU SYSTEM LAST returns to the previous screen.
VOLUME +/-	Increases or decreases volume levels.
CHANNEL +/-	Selects the previous and next available channels.
INFO	Displays various information about the current program.
ARROWS	Moves to highlight items in respective direction.
OK	Confirms a selection.
MENU	Opens the MENU FEATURES screen of the MENU SYSTEM.
EXIT	Returns video to full screen from any INFO or MENU SYSTEM screen.

3. Installing

1) Peripheral device setting

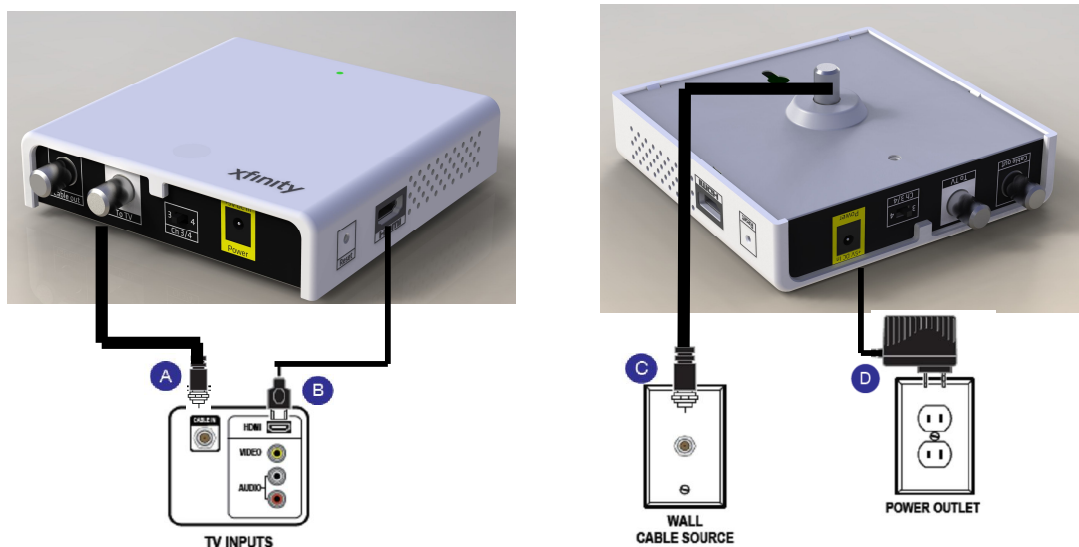

- A. Connect the All Digital Device to the TV. Use a coaxial cable to connect TV OUT on the All Digital Device to the ANT jack on the TV
- B. Connect the All Digital Device to the TV. Use an HDMI cable (not included) to connect HDMI OUT on the All Digital Device to the HDMI input on the TV
- C. Connect the wall cable source to CABLE IN on the All Digital Device.
- D. Connect the AC Adaptor to the POWER input on the All Digital Device. Connect the AC Adaptor to a power outlet on the wall.
(A surge protected power outlet is recommended.)

II . Notice

1. Dolby

Manufactured under license from Dolby Laboratories.

Dolby and the double-D symbol are trademarks of Dolby Laboratories.



2. UL

Care and Maintenance

Important Safety Instructions

1. Read these instructions.
2. Keep these instructions.
3. Heed all warnings.
4. Follow all instructions.
5. Do not use this apparatus near water.
6. Clean only with a dry cloth.
7. Do not block any of the ventilation openings. Install in accordance with the manufacturer's instructions.
8. Do not install near any heat sources such as radiators, heat registers, stoves, or other apparatus (including amplifiers) that produce heat.
9. Do not defeat the safety purpose of the polarized or grounding type plug. A polarized plug has two blades with one wider than the other. A grounding type plug has two blades and a third grounding prong. The wide blade or the third prong is provided for your safety. When the provided plug does not fit into your outlet, consult an electrician for replacement of the obsolete outlet.
10. Protect the power cord from being walked on or pinched particularly at plugs, convenience receptacles, and the point where they exit from the apparatus. Ensure that the power cord receptacle is accessible such that power can be easily disconnected if required.
11. Only use the attachments/accessories specified by the manufacturer.
12. Use only with a cart, stand, tripod, bracket, or table specified by the manufacturer, or sold with the apparatus. When a cart is used, use caution when moving the cart/apparatus combination to avoid injury from tip-over.
13. Unplug this apparatus during lightning storms or when unused for long periods of time.
14. Refer all servicing to qualified service personnel. Servicing is required when the apparatus has been damaged in any way, such as power supply cord or plug is damaged, liquid has been spilled or objects have fallen into the apparatus, the apparatus has been exposed to rain or moisture, does not operate normally, or has been dropped. The shock Hazard Marking and Associated Graphical Symbol is provided on the back panel of unit. Apparatus shall not be exposed to dripping or splashing and no objects filled with liquids, such as vases, shall be placed on the apparatus.

WARNING

TO REDUCE THE RISK OF FIRE OR ELECTRIC SHOCK, DO NOT EXPOSE THIS PRODUCT TO RAIN OR MOISTURE. DO NOT INSERT ANY METALLIC OBJECT THROUGH THE VENTILATION GRILLS OR OTHER OPENINGS ON THE EQUIPMENT.

Apparatus shall not be exposed to dripping or splashing and that no objects filled with liquids, such as vases, shall be placed on the apparatus

CAUTION**EXPLANATION OF GRAPHICAL SYMBOLS**

The lightning flash with arrowhead symbol, within an equilateral triangle, is intended to alert the user to the presence of “dangerous voltage” within the product’s enclosure that may be of sufficient magnitude to constitute a risk of electric shock to persons.



The exclamation point within an equilateral triangle is intended to alert the user to the presence of important operating and maintenance (servicing) instructions in the literature accompanying the product.

Class I construction

An apparatus with CLASS I construction shall be connected to a MAINS socket outlet with a protective earthing connection.

Battery

Batteries(battery pack or batteries installed) shall not be exposed to excessive heat such as sunshine, fire or the like.

Disconnection Device

Disconnect the main plug from the apparatus, if it’s defected. And please call a repair man in your location.

When used outside of the U.S., it may be used HAR code with fittings of an approved agency is employed.

CAUTION

These servicing instructions are for use by qualified service personnel only. To reduce the risk of electric shock do not perform any servicing other than that contained in the operating instructions unless you are qualified to do so.

FCC Information to User

This equipment has been tested and found to comply with the limits for a Class B digital device, pursuant to Part 15 of the FCC Rules. These limits are designed to provide reasonable protection against harmful interference in a residential installation. This equipment generates, uses and can radiate radio frequency energy and, if not installed and used in accordance with the instructions, may cause harmful interference to radio communications. However, there is no guarantee that interference will not occur in a particular installation. If this equipment does cause harmful interference to radio or television reception, which can be determined by turning the equipment off and on, the user is encouraged to try to correct the interference by one of the following measures:

- Reorient or relocate the receiving antenna.
- Increase the separation between the equipment and receiver.
- Connect the equipment into an outlet on a circuit different from that to which the receiver is connected.
- Consult the dealer or an experienced radio/TV technician for help.

Caution

Modifications not expressly approved by the party responsible for compliance could void the user's authority to operate the equipment.

FCC Compliance Information : This device complies with Part 15 of the FCC Rules. Operation is subject to the following two conditions: (1) This device may not cause harmful interference, and (2) this device must accept any interference received, including interference that may cause undesired operation

This device is intended to be attached to a receiver that is not used to receive over-the-air broadcast signals. Connection of this device in any other fashion may cause harmful interference to radio communications and is in violation of the FCC Rules, part 15.