

# **COMFAST**

## **Quick Installation Guide**



Wireless Expander/Repeater  
Version: V1.0

# 1 Introduction

## 1.1 Product Structure:

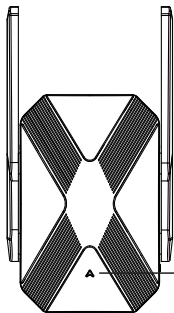

WiFi status light

Steady red indicates that the trunk is on and the signal is weak  
Steady blue indicates that the trunk is on and the signal is strong  
Steady green indicates that the trunk is not connected

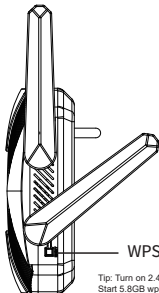

WPS/RESET

Tip: Turn on 2.4G wps for 1-2 seconds  
Start 5.8GB wps in 2-5 seconds  
5 seconds or more to reset the device

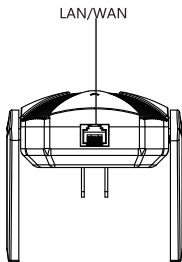

## 2 Relay installation steps

2.1 In factory mode, power on the device. If the white indicator turns green, the system is successfully started. (During the power-on process, a red light is normal.) Connect wifi "COMFAST\_XXXX\_2G" or" COMFAST\_XXXX\_5G".

2.2 After the connection is successful, enter comfast.com or 192.168.10.1 in the browser to enter the management page using ip/ domain name; Enter your password in the password box on the first login page and click "Set Password".

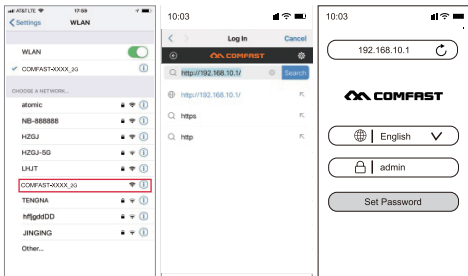

2.3. After you set the password for the first time, the trunk scan page is automatically displayed. To set the trunk, select the SSID to be routed, enter the password of the upper-level route and click Save Application to complete the trunk, and reconnect to the wireless network. The wireless password is the password of the upper-level route (After the extended signal, "-2G/5G" will be added to the name of the upper-level wifi, such as XXXX-2G/5G). After the relay is completed, the lan/wifi IP address is assigned by the superior. If you want to enter the management page after the relay is successful, connect the mobile phone to the wireless wifi of the device (turn off mobile data), and enter comfast.com in the browser to enter the management page.

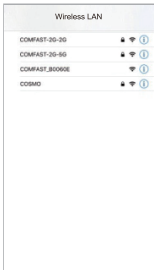
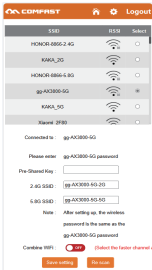

## Illustrate

Merge Wireless: Turn on this option, which merges 2G and 5G signals into a single SSID, showing only the SSID name after one relay in the list box.

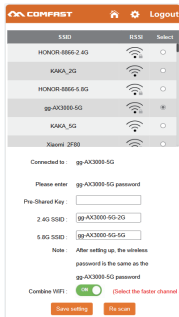

## 3 Introduction to working mode

3.1 the software has three working modes, including trunk mode, AP mode, routing mode (PPoE dial-up, static IP, dynamic IP).

3.2 AP Mode Setting: Go to the software management page and click AP mode. For ease of management, the IP address and default gateway entered here must be the IP network segment of the upper-layer router. The IP address cannot conflict with the IP address of the upper-layer router. After the configuration is complete, the WAN port of the device can access the external network through the configured IP address.

① Notice: When accessing the Internet in AP mode, the IP address segment obtained by the wireless device accessing the AP is assigned by the upper-layer device.

② Keep the default Settings and do not specify the specific Intranet IP address of the device. If you need to manage the device, manually set the IP address of the computer's local connection network card.

3.3 AP mode, you can set 2.4G/5.8G wireless SSID name and password. After the Settings are complete, the WAN port of the device is connected to the external network. Other mobile devices can connect to the Internet through the SSID name of the wirelessly connected device and enter the password.

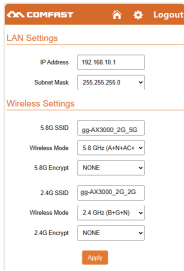

3.5 Routing Mode Setting: Enter the software management page, only the routing mode is displayed, click the routing mode, which can select "PPPoE", "static IP" and "dynamic IP" three Internet access parties

1, PPPOE dial-up mode: In this mode, you need to fill in the Internet account and password provided by the network service provider. The following can be set 2.4G/5.8G wireless SSID name and wireless password.

2, static IP mode: This mode needs to fill in the IP address provided by the network service provider to you, subnet mask, gateway, primary DNS address, the following can be set 2.4G/5.8G wireless SSID name, wireless password.

3, dynamic IP mode: In this mode, the WAN interface is assigned an IP address by the upper-layer network device to access the Internet. The following can be set 2.4G/5.8G wireless SSID name.

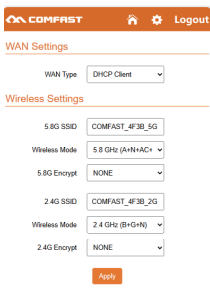

## 4 IPV6 Setting

4.1 IPV6 Settings: Support DHCPV6 client and static IP functions, and enable DHCPV6 client functions by default

Click  and select the  IPV6 Settings page.

IPV6 status: Displays information about the IPV6 address obtained by the device.

IPV6 Settings: Set IPV6 LAN and WAN information.

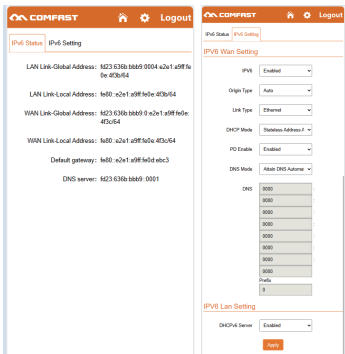

The screenshot shows two side-by-side panels from the COMFAST web interface. The left panel is titled 'IPv6 Status' and displays the following information:

- LAN Link-Global Address: fd23:636b:bbb9:0004::e2e1:a9ff:fe0e:4f3b:64
- LAN Link-Local Address: fe80::e2e1:a9ff:fe0e:4f3b:64
- WAN Link-Global Address: fd23:636b:bbb9:0::e2e1:a9ff:fe0e:4f3c:64
- WAN Link-Local Address: fe80::e2e1:a9ff:fe0e:4f3c:64
- Default gateway: fe80::e2e1:a9ff:fe0d:ebc3
- DNS server: fd23:636b:bbb9:0001

The right panel is titled 'IPv6 Setting' and shows configuration options for WAN and LAN settings:

- IPv6 Wan Setting:**
  - IPv6: Enabled
  - Origin Type: Auto
  - Link Type: Ethernet
  - DHCP Mode: Stateless Address P
  - PD Enable: Enabled
  - DNS Mode: Obtain DNS Automar
  - DNS: A list of 10 input fields, each containing '0000'.
  - Prefix: 0
- IPv6 Lan Setting:**
  - DHCPv6 Server: Enabled
  - Apply button

## 5 Light control status

	AP/Route Mode	Trunk
Relay status light	Blue light is always on	Steady red indicates that the trunk is on and the signal is weak Steady blue indicates that the trunk is on and the signal is strong Steady green indicates that the trunk is not connected

## **6** FAQ

Q: What's the role of WiFi extender?

A : Boost the range of your existing WiFi and creates stronger signal in hard-to-reach areas. Please note that it can't increase your wifi speed of your router, the speed of the extending wifi will be reduced.

Q : Where shall I place the WiFi extender?

A : We would suggest that after setting up successfully, please move this wifi extender on the halfway between your router and your weak signal area. The location that you choose must be within the range of your existing WiFi router network.

Q : How to reset the WiFi extender?

A : Press the WPS/Reset button of your extender for 10 seconds, wait to restore factory settings, when the lamp is off and then light up again, you can begin to set up it again.

Q: Why does WiFi keep disconnecting?

A: We recommend resetting the WiFi extender.

For more questions, please visit [www.szcomfast.com](http://www.szcomfast.com) official website



# Maintenance Regulations

Dear Valued Clients,

Thank you for purchasing acoMFnsT products and service to protect your rights, please read the following maintenanceregulations.

**The following does not belong to free maintenance ,our company can provide paid service ,please note:**

- Failure to require theinstallation manual ,use ,maintenances, torage lead to product failure or damage;
- Beyond the limited warranty , the warranty period;  
Unauthorized alteratiion, tearing up the product bar code;
- Without authorization to change the settings file or inherent disassemble without authorization;
- Unexpected factors or human actions lead to product damage,such as improperinput voltage,temperature, watermechanical damage,break,rust or serious oxidation of product ,etc;
- Other non-product itself, design ,technology,manufacturing, quality and other quality problems caused by the failedamage.

## Certificate Of Qualification

Quality Inspector \_\_\_\_\_

Production Date \_\_\_\_\_

Executive Standard YD/T 1965-2009



# Quick Installation Guide

## Statement

**Shenzhen Four Seas Global Link Network  
Technology CO.,Ltd.  
all rights reserved.**

Without our official written permission, no unit or individual shall be copied, reproduced, transcribed or translated in part or whole book. In any form or by any means (electronic, mechanical, printing, recording or other possible means) or for the propagation of goods any commercial, profitable purposes.

**COMFAST** is the registered trademark of Shenzhen Four Seas Global Link Network Technology Co., Ltd. All other trademarks or registered trademarks mentioned in this document, by respective owners.

Product specifications and information mentioned in this manual are for reference on subject to updates without notice. Unless there are other special agreements, this manual is used only as a user guide. All statements, information, etc. are not constitute any form of guarantee

Manufacturer: Shenzhen Four Seas Global Link Network  
Technology Co., Ltd.

Address: Room 607-610, Block B Tao JINDI Electronic  
Business Incubation Base, Tenglong Road, Longhua  
District, Shenzhen, China

Hotline: 4009-001-766

Website: [www.comfast.cn](http://www.comfast.cn) / [www.szcomfast.com](http://www.szcomfast.com)

## FCC Statement

This equipment has been tested and found to comply with the limits for a Class B digital device, pursuant to part 15 of the FCC Rules. These limits are designed to provide reasonable protection against harmful interference in a residential installation. This equipment generates, uses and can radiate radio frequency energy and, if not installed and used in accordance with the instructions, may cause harmful interference to radio communications. However, there is no guarantee that interference will not occur in a particular installation. If this equipment does cause harmful interference to radio or television reception, which can be determined by turning the equipment off and on, the user is encouraged to try to correct the interference by one or more of the following measures:

- Reorient or relocate the receiving antenna.
- Increase the separation between the equipment and receiver.
- Connect the equipment into an outlet on a circuit different from that to which the receiver is connected.
- Consult the dealer or an experienced radio/TV technician for help.

Caution: Any changes or modifications to this device not explicitly approved by manufacturer could void your authority to operate this equipment.

This device complies with part 15 of the FCC Rules. Operation is subject to the following two conditions: (1) This device may not cause harmful interference, and (2) this device must accept any interference received, including interference that may cause undesired operation.

## RF Exposure Information

This equipment complies with FCC radiation exposure limits set forth for an uncontrolled environment. This equipment should be installed and operated with minimum distance 20cm between the radiator and your body.