

## Product Description

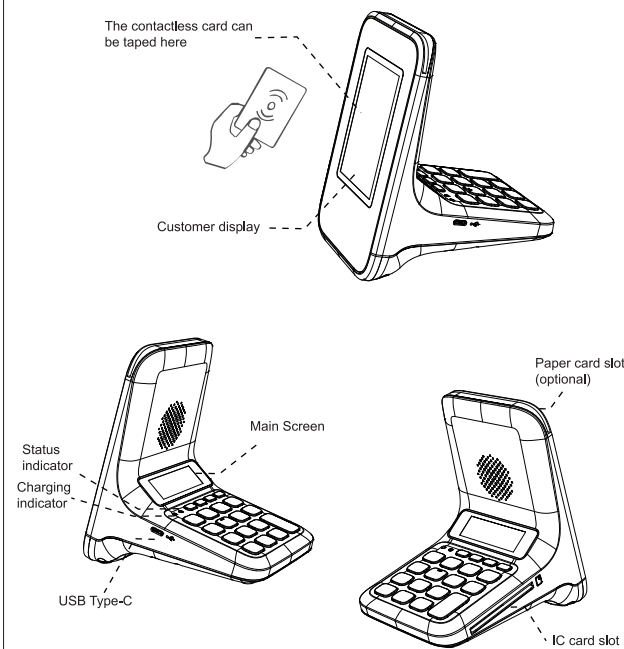

-1-

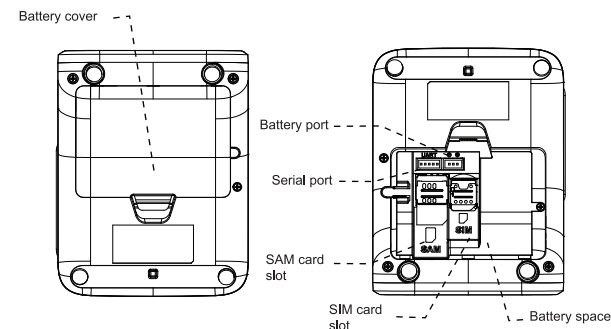

## Product accessories

Components Name	Quantity
QR code Terminal	1
Type-C USB power cable	1
Battery	1
Instructions (warranty card, certificate of conformity)	1

-2-

## Operation Instructions

### 1. Power On/Power off/Reset

- (1) When the device is off, long press the power key until the screen lights up.
- (2) When the device is powered on, long press the power key until the screen turns off.
- (3) Restart the device by removing and inserting the battery

### 2. Function settings

#### (1) Code scanning distribution network

- ① When the equipment is in standby mode, press **【F1】** and **【4】** to enter the code scanning distribution network mode;

- ② Turn on the mobile phone and connect it to the 2.4G band WIFI network. The WIFI connected to the mobile phone and the WIFI to be connected to the Q161 Pro must be the same WIFI;

- ③ Open the QR code scanning APP of the devices' QR code on your mobile phone, scan the QR code of the distribution network at the bottom of Q161 Pro with the mobile phone, and enter the configuration interface;

- ④ Click "Configuration" on the mobile interface;

- ⑤ Input the password of the WIFI to be connected to Q161 Pro on the mobile phone, click the "Connect" button and wait for the WIFI configuration to succeed. If WIFI does not have a password, it is not necessary to enter the password, and directly click the "Connect" button to wait for the success of WIFI distribution network;

Note: The distribution network should be completed within 150 seconds, otherwise the equipment will exit the distribution network mode, and the Q161 Pro can only connect to the WIFI network in the 2.4G band.

-3-

### (2) Switch network

Press **【F1】** and **【5】** in the standby interface to switch between 4G network and WIFI network.

- (3) Press up and down keys in standby interface to adjust the volume.

The merchant presses the up button to increase the volume gradually (up arrow) according to actual needs. The merchant presses the down button to gradually decrease the volume (down arrow) according to actual needs.

### 3. Payment operation

#### (1) Merchant passive collection

- ① Consumers use their mobile phones to scan the merchant's QR code for collection, and enter the consumption amount on their mobile phones to make payment.

- ② Payment completed.

#### (2) Merchant active collection

- ① The merchant uses the keyboard to input the consumption amount, and the main display screen displays the input amount.

- ② Consumers can choose the following three payment methods

- a. Use the QR code automatically generated on the mobile phone scanning device screen to check the amount before making payment;

- b. Use the NFC of the mobile phone to aim at the card reading area of the device to pay (only with non-contact version);

- c. Make payments by inserting a contact IC card into the IC card slot

- ③ Payment completed.

-4-

## Matters need attention

### Cautions for use

- Unauthorized disassembly of this device will cause the built-in security key to be destroyed resulting in unusable
- If the power adapter plug or power cord is damaged, please do not use them in case of electric shock or fire. Please do not touch power cord with wet hand or pull out the power adapter like pulling power cable.

- Please do not touch the device and power adapter with wet hand in case of short circuit, malfunction, or electric shock.

- Please stop using the power adapter and contact sales representatives for exchanging if the power adapter is caught in the rain, getting wet, or affected with damp seriously.

The charge must be certified by local regulations and meet the charging specifications of the device.

- If the device has to connect USB ports, please ensure that the USB ports has USB-IF identification, and its performance is qualified with the USB-IF requirements.

### Operating environment

- Do not use the device in thunderstorms which can cause the device malfunction or electric shock.

- Keep the device away from rain, moisture and liquids containing acidic substances that can corrode electronic circuit boards.

- Do not store or use the device in a dusty or dirty place.

- Do not store the device in a high temperature place. High temperature will shorten the life of the electronic device.

-5-

## After-sale service

If you have any questions, please contact your local dealer.

### Warranty card

Product Name: \_\_\_\_\_

Product Model: \_\_\_\_\_

### Warranty terms:

1. Our company will provide you with high quality after-sales service.
2. If the user causes product damage due to human factors, the company will charge maintenance fee when repairing.
3. Please take good care of this card, which will be the warranty basis of our company.

### Certificate

This product has passed inspection and is authorized for factory release.

## Aisino Vanstone Electronic (Beijing) Co.,Ltd.

Address: 3/F, No.2 Building, Aisino Information Park, No.18A, Xingshikou Road, Haidian District, Beijing.  
Zip Code: 100195.

Email: info@vanstone.com.cn  
Manufacture Name: Vanstone Electronic(Huizhou) Co.,Ltd.  
Manufacture Address: 4/F, No.12 Building, Aerospace Science And Technology industrial Park, No. 51, Zhongkai Road, Huizhou City, Guangdong Province, China.

Company Website: <https://www.vanstone.com.cn/en>

-6-

- Do not place the device in a super-cooling place. When the temperature of the device rises, moisture may be formed inside the equipment, which may damage the circuit board.
- Do not try to disassemble the device. Non-professional manipulating will damage the device.
- Do not use a pen, pencil, or other sharp objects to touch the screen surface to avoid scratching the screen.
- Do not drop, strike, or seriously crash the device. Rough behaviors may damage the device and may cause malfunction.

### Accessories requirements

- Please use only the battery, power adapter and other accessories that are authorized by product manufacturer and match to the device. Using unauthorized and incompatible accessories may cause fire, explosion, or other dangers.

- If using unauthorized accessories, the user may disobey the warranty rules and countries' related regulations and may lead to accidents. If users want to acquire authorized accessories, please contact your sales agents or distributors.

### Power adapter safety

- When the device is charged, the power socket should be installed near the device and should be easy to touch. The charging area of the equipment must be clean without debris, flammable or chemical substance.
- When charging is over or uncharged, please cut off the connection between the power adapter and the device, and please unplug the charger from the power socket.

- Please do not drop or crash the power adapter. Once the shell of the adapter is damaged, please contact the agent or distributor who sell the equipment to exchange the power adapter.

### Battery safety

- Please do not use short circuit batteries, or contact the battery terminals with metal or other conductive objects. Please do not disassemble, squeeze, twist, or cut the battery.

- Please do not insert external matter into the battery, contact the battery with water or other liquid, and expose the battery to open flame, explosion source, or other risk sources.

- Please do not place or store the battery in an over-temperature environment.

- Please do not throw the battery into water.

- Do not touch the skin or eyes if a battery leak occurs. If you are stained, rinse the contact area with plenty of water and seek medical attention immediately. Please do not use broken and damaged battery.

- When the standby duration of the device is obviously shorter than usual, please exchange a new battery.

### Cautions:

- There will be a danger of explosion using the wrong model of battery.

- The battery must be disposed in accordance with the instructions.

-7-

## FCC compliance statement

This device complies with Part 15 of the FCC Rules. Operation is subject to the following two conditions: (1) this device may not cause harmful interference, and (2) this device must accept any interference received, including interference that may cause undesired operation.

changes or modifications not expressly approved by the party responsible for compliance could void the user's authority to operate the equipment.

This equipment has been tested and found to comply with the limits for a Class B digital device, pursuant to Part 15 of the FCC Rules. These limits are designed to provide reasonable protection against harmful interference in a residential installation. This equipment generates, uses and can radiate radio frequency energy and, if not installed and used in accordance with the instructions, may cause harmful interference to radio communications. However, there is no guarantee that interference will not occur in a particular installation.

If this equipment does cause harmful interference to radio or television reception, which can be determined by turning the equipment off and on, the user is encouraged to try to correct the interference by one or more of the following measures:

-- Reorient or relocate the receiving antenna.

-- Increase the separation between the equipment and receiver.

-- Connect the equipment into an outlet on a circuit different from that to which the receiver is connected.

-- Consult the dealer or an experienced radio/TV technician for help.

## FCC SAR statement

This equipment complies with FCC radiation exposure limits set forth for an uncontrolled environment. End user must follow the specific operating instructions for satisfying RF exposure compliance. This transmitter must not be co-located or operating in conjunction with any other antenna or transmitter.

The portable device is designed to meet the requirements for exposure to radio waves established by the Federal Communications Commission (USA).

These requirements set a SAR limit of 4.0 W/kg averaged over ten grams of tissue. The highest SAR value reported under this standard during product certification for use when properly worn on the limbs.

## Aisino Vanstone Electronic (Beijing) Co.,Ltd.

### Quick Start Guide Q161 Pro QR Code Terminal

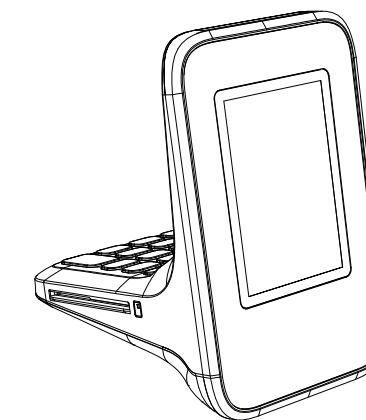

The pictures and instructions in this guide are for reference only. Please refer to the real object.