

对折正反印

90mm

90mm

FEDERAL COMMUNICATION INTERFERENCE STATEMENT COMMISSION

This equipment has been tested and found to comply with the limits for a Class B digital device.

Pursuant to Part 15 of the FCC Rules, these limits are designed to provide reasonable protection against harmful interference in a residential installation. This equipment generates usages and can radiate radio frequency energy. If not installed and used in accordance with the instructions, it may cause harmful interference to radio or television reception, which can be determined by turning the equipment off and on, the user is encouraged to try to correct the interference by one or more of the following measures:

- Reorient or relocate the receiving antenna.
- Increase the separation between the equipment and the receiver.
- Connect the equipment into an outlet on a circuit different from that to which the receiver is connected.
- Consult the dealer or an experienced Radio/TV technician for help.

This device complies with Part 15 of the FCC Rules. Operation is subject to the following two conditions: (1) This device may not cause harmful interference, and (2) This device must accept any interference received, including interference that may cause undesired operation.

FCC Caution: Any change or modifications not expressly approved by the party responsible for compliance could void the user's authority to operate this equipment.

IMPORTANT NOTE

FCC Radiation Exposure Statement:

1. This equipment complies with FCC radiation exposure limits set forth for an uncontrolled environment. End users must follow the specific operating instructions for satisfying RF exposure compliance.
2. This transmitter must not be co-located or operating in conjunction with any other antenna or transmitter.

KATE SPADE  
SATURDAY

SILICONE BLUETOOTH KEYBOARD  
USER GUIDE FOR  
IPAD 3 AND IPAD MINI

PACKING CONTENTS

- Wireless Bluetooth Keyboard
- USB Power Charging Cable

PRODUCT FEATURES

- Bluetooth V3.0 interface
- High-grade aluminum alloy material
- Arc-groove stand for iPad or iPhone
- Rechargeable lithium battery, with 30 day lifespan per charge
- Home screen key, for one-touch access to applications
- Energy-saving Sleep mode
- Power and Link buttons (top front of keyboard)
- Power, Bluetooth indicator and Caps Lock lights

SPECIFICATIONS

- Bluetooth V3.0 interface Standard
- Operating Distance: 5 meters
- Modulation System: GFSK 2.4G
- Transmitting Power: Class 2
- Working Current: <10mA
- Standby Current: 2.5mA
- Sleeping Current: <200μA
- Raing: 5.0V==100mA
- Standby time: 30 days
- Lithium Battery Life: 2 years
- Charging time: 2-4 hours
- Key Dynamics: 60±10g
- Key Life: 2 million strokes
- Operating Temperature: -10°C+55°C
- Lithium Battery Capacity: 180mAh

138mm

BLUETOOTH KEYBOARD PAIRING

1. Push Power button. Power and Bluetooth indicator lights will turn on for 5 seconds, then go off.
2. Press Link button. Bluetooth indicator light will blink, while power indicator light will remain on. Keyboard is now ready to be connected to device.
3. Turn on and unlock iPad/iPad Mini device.
4. On home screen, open Settings. In General tab, select Bluetooth. If Bluetooth is off, slide to turn on. Then search for Bluetooth devices within device range. Select "Bluetooth Keyboard" under "Devices" that are "Now Discoverable".



5. Blue instruction box will pop up, requesting to pair with your iPad/iPad Mini device, also providing PIN code number. Enter Pin Code "0000" on device, and click the Return or Enter key to connect.

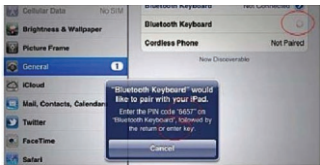

SPECIAL NOTE

The wireless keyboard can connect to iPad3, Mini iPad that has installed iOS 4.0 or later.  
For other Bluetooth-enabled devices, please verify the Bluetooth standard and compatibility before attempting to connect to the keyboard.

RECHARGING

When the battery power is low and needs recharging, the Power indicator light will start blinking.

1. Connect the USB power cable to the keyboard interface.
2. Connect the charging cable into USB power adapter/source.

The "charge" red indicator light will stay on for duration of recharging, and will turn off when recharging is complete.

SAFETY PRECAUTIONS

- Keep away from sharp objects.
- Do not place heavy objects on top of the keyboard.
- Do not put in Microwave.
- Do not use excessive force or distort the keyboard.
- Keep away from oil, chemical or any other organic liquid.

ENERGY-SAVING SLEEP MODE

The keyboard will go into Sleep mode when it is inactive for 15 minutes, and the keyboard power indicator light will go off. To "wake up," press any key and wait 3 seconds.

When you use the product and touch the port it may cause the device close down, then please restart the device to make it work properly.

CLEANING

Clean the silicon keyboard with water, alcohol, or alcohol based disinfectant.

TOUBLESHOOTING

If unable to connect, please make sure...

- The power switch is on.
- The keyboard is within device range.
- The battery is charged.
- Bluetooth is turned on in iPad/iPhone "Settings."
- The Keyboard has successfully paired with device.

If unable to charge keyboard, please make sure...

- USB power cable is connected properly to the keyboard and the power source.

SPECIAL KEYS ON THE IPAD OR IPHONE

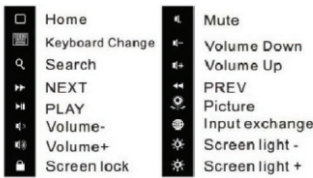

Also note: the "command" + "space" keys can be used to switch between various languages.