

4, Operation method :

- 1), Connect transmitter and PS3 console USB port using the short USB cable ,light flashing .
- 2), Long press power button for 3 seconds to power on the headset , the headset should auto pair with the transmitter and solid blue light light up , if the headset light keep flashing , please pair them once again .
- 3), During pairing , please power on PS3 and do not play audio , place headset close to transmitter within 50 cm and long press mute button on headset for 5 seconds and release your finger when light keep fast flashing , then the light on transmitter and headset will become solid blue.
- 4), Default setting for mute is off (chat on), if you want to mute your chat voice, please press the mute button once and transmitter light will become red.
- 5), Volume adjusting switch allow you to adjust the game background and chat volume .

5, Common issue and solution

Common issue	Solution
1) Can't power on headset 2) Charging light off	1、 Long press power on button for 3 seconds 2、 Using USB cable to charge the headset , charging red indicating light on during charging and off after fully charge at about 5 hours charging
Power off after 10 mins	Fully charge headset for 5 hours before use
No background sound	1.Optical cable not connected correctly , please remove protection cover and connect with right direction 2.Console setting should be : Settings--System--Console settings--Audio-- ①Digital Output -- DigitalStereo(don't choose Dolby Digital 5.1 or Dolby Digital with WMA Pro), ②Sound Effects--Enable Sound Effents , ③Ratings Collection Sound ---Turn On
No mic sound	1、 Plug in microphone for headset 2、 Use short USB cable for audio transmission 3、 Setting should be : Settings-Accessory Settings-Audio Device Settings-Input Device and Output Device - Select all options: 5.8G Wireless headset-OK-Enter 3.Press pairing button once for mute off 4、 Mic being muted , press the mute/pair button to active mic sound

⑩

6, Xbox 360S setting

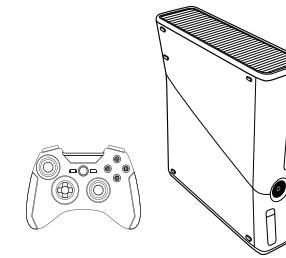

- 1, Connect Xbox 360S optical port with **B** Transmitter optical port **1** using **F** Optical cable (protection cover must be removed) ; Using Micro USB Audio cable to connect Xbox 360S USB port with **B** Transmitter **2** USB port as below :

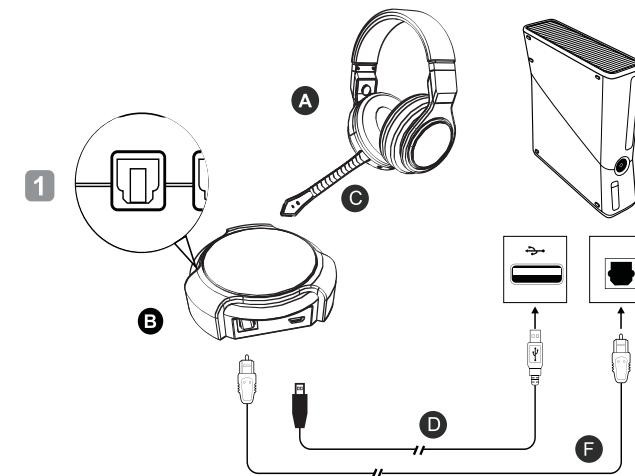

2, Detail connection diagram :

Using HDMI cable to connect Xbox360S console with TV (Display), connect 2.5mm to 3.5 mm Xbox cable with 3.5 mm plug to headset & 2.5mm plug to Xbox controller 2.5mm jack

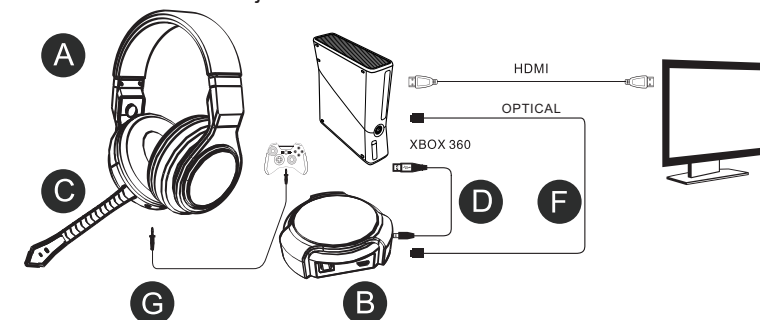

⑪

3, Connection for old version Xbox 360 & Xbox 360E (no optical port) if TV had optical port

Connect HDMI cable with console and TV (Display) , connect transmitter and TV (with optical port) using optical cable , connect transmitter USB port & console USB port with USB audio cable

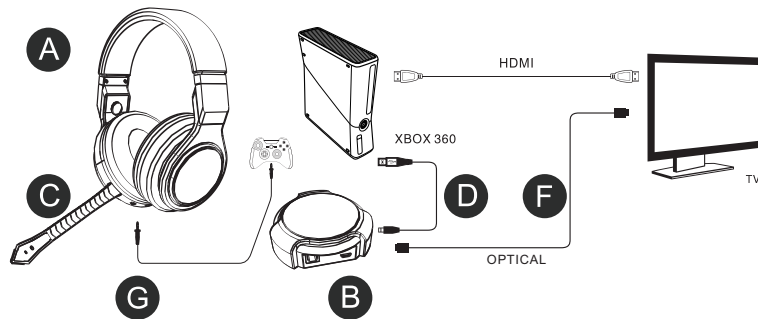

4, XBOX 360 System Setting

1), After power on Xbox 360 , select setting then select System

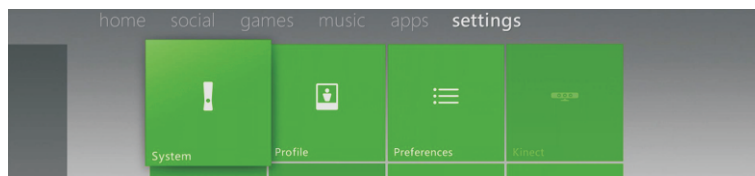

2), Select Console Settings

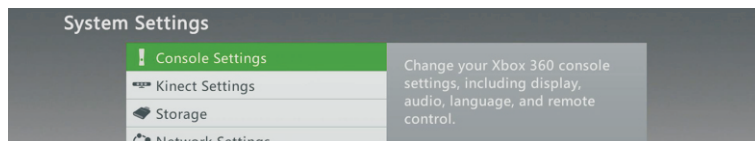

3), Select Audio

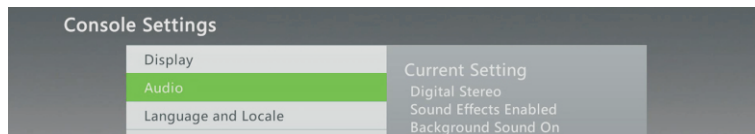

4), Select Digital Output

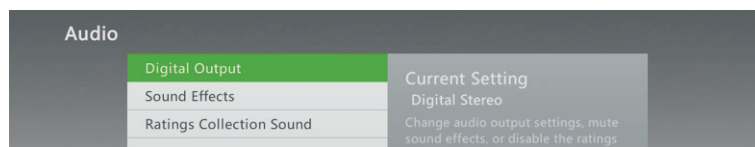

5), Select Digital Stereo and select Digital Stereo

(do not choose Dolby Digital 5.1 or Dolby Digital with WMA Pro)

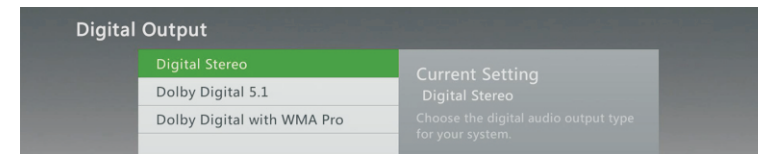

6), Select Sound Effects

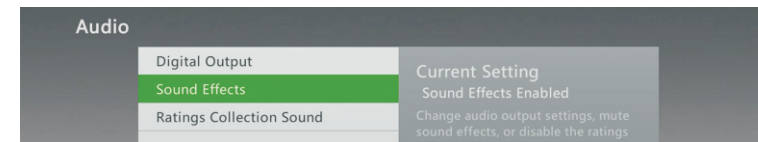

7), Select Enable Sound Effects

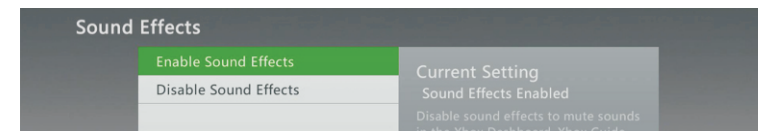

8), Back to settings in main screen and choose Preferences

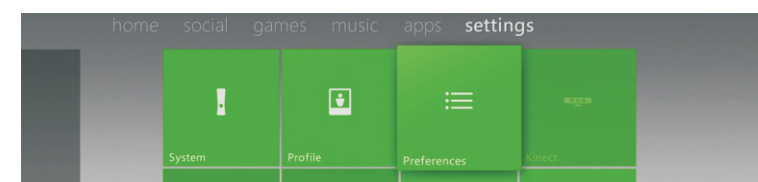

9), Select Voice

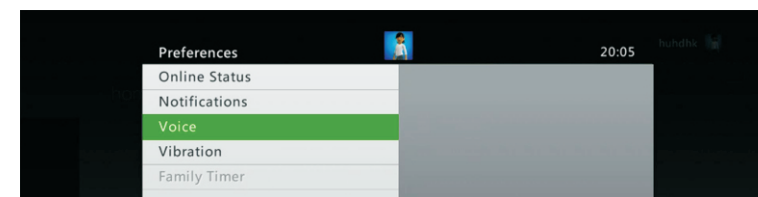

10), Adjust Volume level of Voice Volume & Game Volume and choose Play Through Both

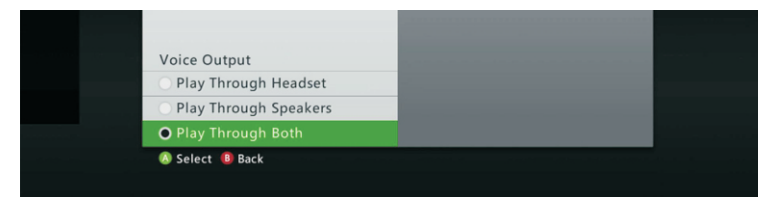

5, Operation method :

- 1), Connect transmitter and Xbox 360 console USB port using the short USB cable, light flashing .
- 2), Long press power button for 3 seconds to power on the headset, the headset should auto pair with the transmitter and solid blue light light up, if the headset light keep flashing , please pair them once again .
- 3), During pairing , please power on Xbox 360 and do not play audio, place headset close to transmitter within 50 cm and long press mute button on headset for 5 seconds and release your finger when light keep fast flashing , then the light on transmitter and headset will become solid blue.
- 4), Default setting for mute is off (chat on), if you want to mute your chat voice , please press the mute button once and transmitter light will become red.
- 5), Volume adjusting switch allow you to adjust the game background and chat volume .

6, Common issue and solution

Common issue	Solution
1) Can't power on headset 2) Charging light off	1、 Long press power on button for 3 seconds 2、 Using USB cable to charge the headset , charging red indicating light on during charging and off after fully charge at about 5 hours charging
Power off after 10 mins	Fully charge headset for 5 hours before use
No background sound	1. Optical cable not connected correctly , please remove protection cover and connect with right direction 2. Console setting should be : Settings--System--Console settings--Audio-- ①Digital Output -- Digital Stereo(don't choose Dolby Digital 5.1 or Dolby Digital with WMA Pro), ②Sound Effects--Enable Sound Effents, ③Ratings Collection Sound ---Turn On
No mic sound	1. Plug in microphone for headset 2. Please press the mic mute off , mic volume can be adjusted higher or lower by chat volume switch .

7, XBOX ONE setting

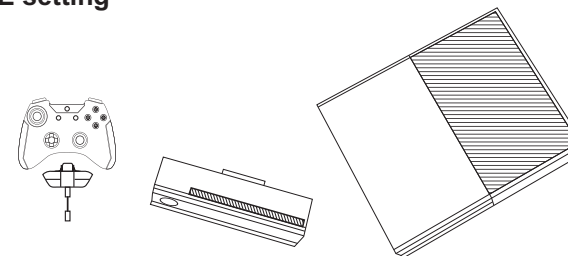

- 1, Connect Xbox One optical port with **B** Transmitter optical port **1** using **F** Optical cable (protection cover must be removed) ; Using Micro USB Audio cable to connect Xbox One USB port with **B** Transmitter **2** USB port as below :

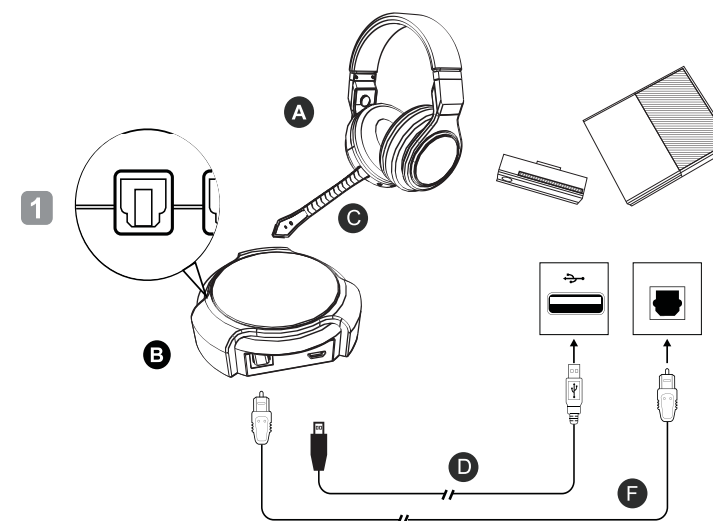

2, Detail connection diagram :

Using HDMI cable to connect Xbox console and TV (Display) recommend to use kinect for chatting (wireless) , if you don't have kinect , you can buy a Microsoft adapter using attached 3.5mm 3 poles to 3.5 mm 4 poles cable with 3.5 mm 3 poles plug to headset and 3.5 mm 4 poles plug to adapter's 3.5 mm jack .

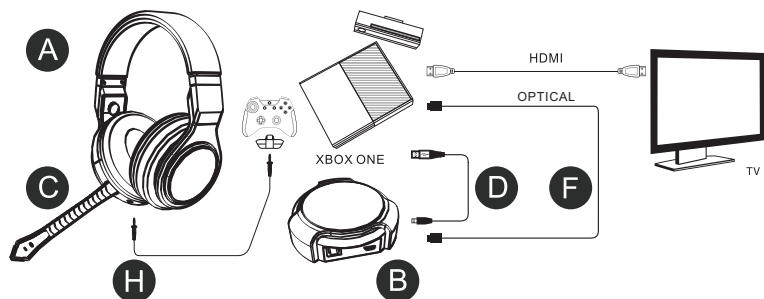

3, XBOX ONE System setting

1), After power on Xbox One , select setting --- all setting

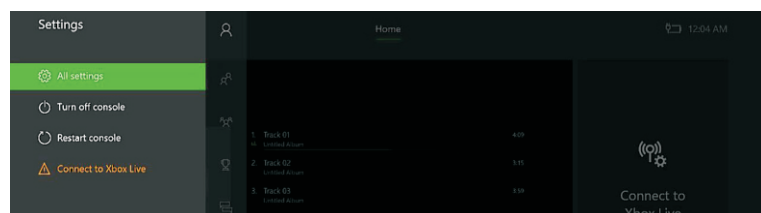

2), Select Display & sound

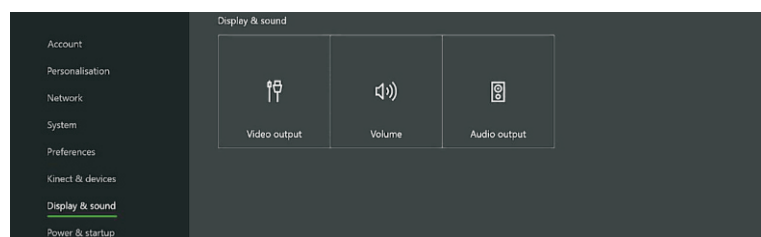

3), Select Audio output

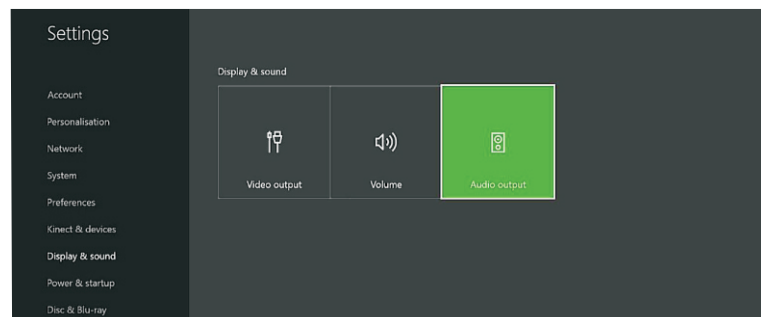

4), Select Optical audio

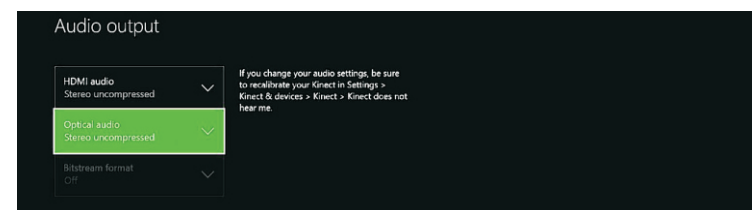

5), Choose Stereo uncompressed

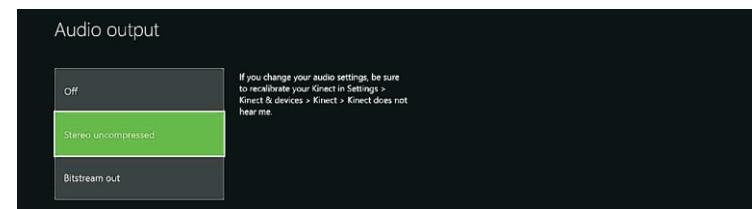

6), Back to Display & sound screen , select Volume

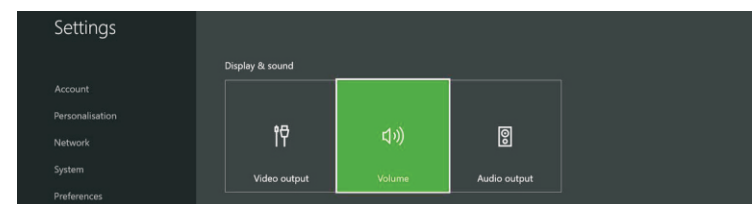

7), Select Chat mixer

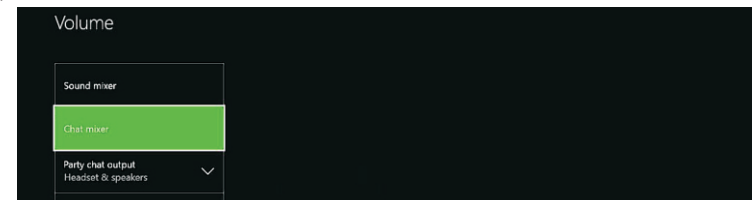

8), Choose Do nothing

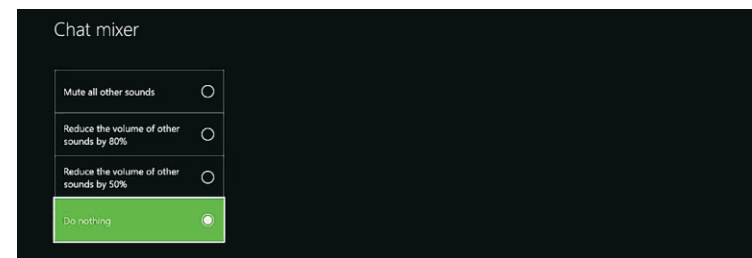

4, Operation method :

- 1) Connect transmitter and Xbox One console USB port using the short USB cable ,light flashing .
- 2) Long press power button for 3 seconds to power on the headset , the headset should auto pair with the transmitter and solid blue light light up , if the headset light keep flashing , please pair them once again .
- 3) During pairing , please power on Xbox One and do not play audio , place headset close to transmitter within 50 cm and long press mute button on headset for 5 seconds and release your finger when light keep fast flashing , then the light on transmitter and headset will become solid blue.
- 4) Default setting for mute is off (chat on), if you want to mute your chat voice , please press the mute button once and transmitter light will become red
- 5) Volume adjusting switch allow you to adjust the game background and chat volume .

5, Common issue and solution

Common issue	Solution
1) Can't power on headset 2) Charging light off	1、 Long press power on button for 3 seconds 2、 Using USB cable to charge the headset , charging red indicating light on during charging and off after fully charge at about 5 hours charging
Power off after 10 mins	Fully charge headset for 5 hours before use
No background sound	1、 Optical cable not connected correctly , please remove protection cover and connect with right direction 2、 setting should be : Setting -- Display & Sound -- ① optical --stereo uncompressed (don't choose stereo bitstream cut or off ② chat mixer -- Do nothing
No mic sound	1、 Plug in microphone for headset 2、 When using Kinet for chatting, please set kinet to open position and put kinet in a good position facing you to receive your chat voice 3、 When using Microsoft adapter , Please press the mic mute off , mic volume can be adjusted higher or lower by chat volume switch .

⑱

8, Suitable for PC/MAC

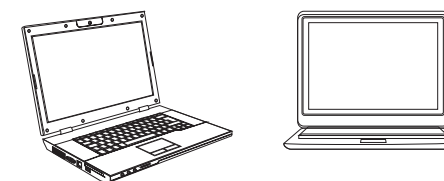

- 1, Using Micro USB-USB long cable to connect transmitter with PC , please keep the distance between transmitter & PC as far as possible



- 2, PC setting (Windows 8 version for example)

- 1), USB the 80 mm long USB cable to connect transmitter with your PC
- 2), Move your mouse to right bottom corner of desk top on the speaker icon as shown in Picture 1, click right button of mouse as shown in Picture 2,



Picture 1



Picture 2

- 3, Click mouse left button to choose the "Playback" as shown in Picture 3, and then choose the "5.8G wireless headset" as shown in Picture 4 , click mouse left button to choose the "Set Default " as shown in Picture 5

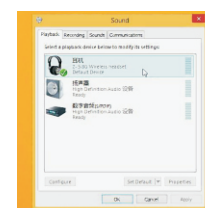

Picture 3

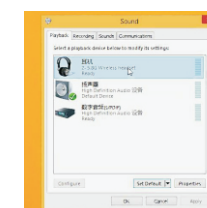

Picture 4

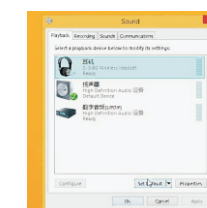

Picture 5

⑲

4, Click mouse left button to choose the “Recording” as Picture 6 , and then choose the “5.8G wireless headset” as shown in Picture 7 , and choose the “Set Default” as shown in Picture 8 , Now that the PC setting is finished.

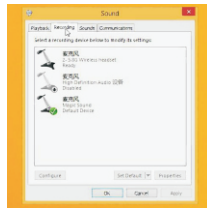

Picture 6

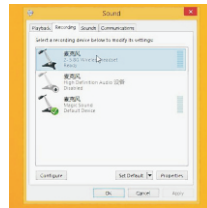

Picture 7

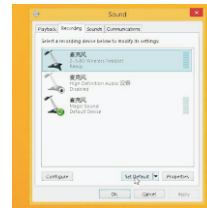

Picture 8

9, MAC setting

Step 1 -- Choose System preferences

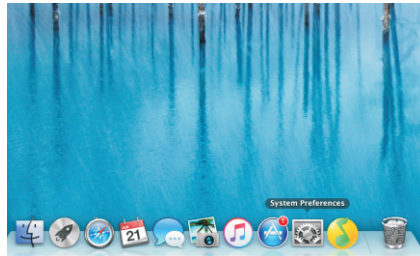

Step 2 choose Sound



Step 3 choose input setting and set to 5.8G Wireless Headset

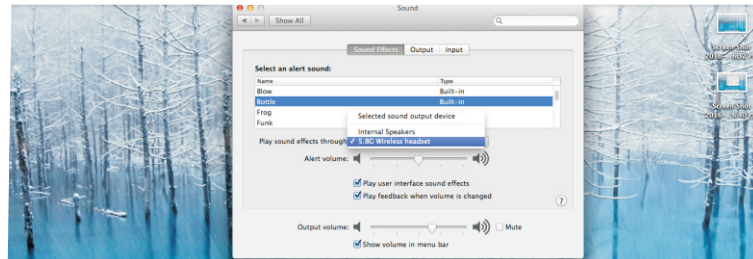

Step 4 Choose output setting and set to 5.8G Wireless Headset

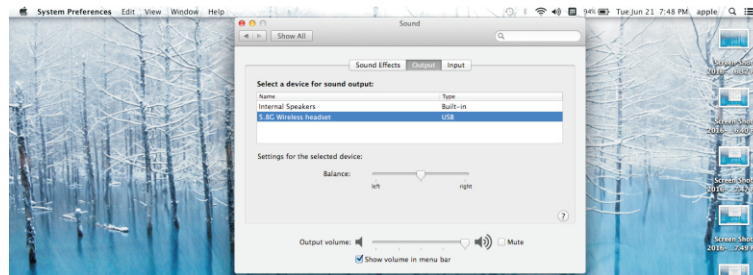

Step 5 Choose Sound Effects as Play sound effects though -- 5.8 G Wireless Headset , tick the three ticks shown in below diagram

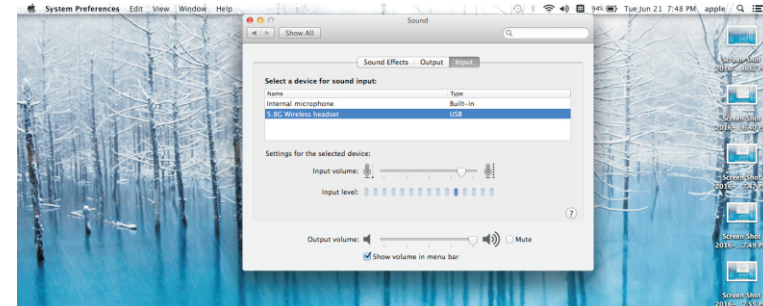

10, Specification

Headset :

Working voltage: 3.5-4.2V

Lithium battery: 1100mAh

Working hours: ≥6h

Charging time: ≈5h

Wireless Frequency: 5.730GHz - 5.803GHz

Speaker size: Φ40mm

Speaker impedance: 32Ω

Frequency response: 20~20KHz

Microphone sizes: Φ6.0*2.7mm

Microphone sensitivity: -58dB

Microphone direction: Omni directional

Microphone frequency response: 100Hz-8KHz

Transmitter :

Working voltage: 5V

Wireless Frequency: 5.730GHz - 5.803GHz

Receiving/transmit distance: 10M