

English

USER MANUAL

MASTERMIND H3

SBC-D10

turbob



LANGUAGE VERSIONS

- EN: This document is available for download in additional languages at www.specialized.com.
- CNS: 本档的其他语言版本可从 www.specialized.com 下载。
- CNT: 本文件有其他语言版本，请至 www.specialized.com 下载。
- CZ: Tento dokument je k dispozici ke stažení v dalších jazycích na adrese www.specialized.com.
- DA: Dette dokument kan downloades på flere sprog, på www.specialized.com.
- DE: Dieses dokument steht in weiteren sprachen zum download unter www.specialized.com zur verfügung.
- ES: Este documento está disponible para su descarga en otros idiomas en www.specialized.com.
- FI: Tämä asiakirja on ladattavissa muunkielisenä osoitteessa www.specialized.com.
- FR: Ce document peut être téléchargé dans d'autres langues sur le site www.specialized.com.
- HR: Ovaj dokument na dodatnim jezicima možete preuzeti na stranici www.specialized.com.
- IT: Questo documento può essere scaricato in altre lingue all'indirizzo www.specialized.com.
- JP: 本文書の他の言語によるバージョンは、www.specialized.com からダウンロードできます。
- KR: 이 문서를 기타 언어로 다운로드: www.specialized.com.
- NL: Dit document kan worden gedownload in andere talen via www.specialized.com.
- NO: Dette dokumentet er tilgjengelig for nedlasting på flere språk på www.specialized.com.
- PL: Niniejszy dokument można pobrać w innych wersjach językowych ze strony www.specialized.com.
- PT: Este documento está disponível para download em outros idiomas em www.specialized.com.
- RU: Настоящий документ доступен для загрузки на других языках по адресу www.specialized.com.
- SK: Tento dokument je k dispozícii na stiahnutie v ďalších jazykoch na lokalite www.specialized.com.
- SL: Ta dokument je na voljo za prenos v dodatnih jezikih na spletni strani www.specialized.com.
- SV: Detta dokument kan laddas ned i andra språkversioner från www.specialized.com.

SPECIALIZED BICYCLE COMPONENTS | 15130 Concord Circle, Morgan Hill, CA 95037 (408) 779-6229

0000144683_UM_R3 05/23

We may occasionally issue updates and addendum to this document. Please periodically check www.specialized.com or contact Rider Care to make sure you have the latest information. 877-808-8154

CONTENTS

1. INTRODUCTION	2
1.1. Warranty	2
2. SYSTEM INTERFACE	3
2.1. Powering On	3
2.2. MasterMind H3 HMI System	3
2.2.1 MasterMind H3 Remote	3
2.3. MasterMind H3 Display	4
2.4. MasterMind H3 Remote	5
2.5. MasterMind H3 Display	6
2.5.1 Screen Layout	6
2.5.2 Data Field icons	6
2.6. Support Modes	7
2.6.1 Micro Tune Mode	8
2.7. Customizing The Display	8
2.8. Auto Start	9
2.9. Pedal Coach	9
2.10. enviolo AUTOMATIQ Hub, Pedal Pace	10
2.11. Turbo System Lock	10
2.11.1 App Lock and Unlock	10
2.11.2 Pin Unlock	10
2.12. Radar	11
2.12.1 Startup	11
2.12.2 Visual Alerts	12
2.12.3 Sound Alerts	12
2.13. Error Messages	13
2.14. Legal Documentation	13
2.15. Standard And Factory Reset	14
2.16. Connectivity Options	14
3. SPECIALIZED APP	15
3.1. Specialized App Features	15
3.2. Sign In To The Specialized App	15
3.3. In-App Help Guide	15
3.4. Pairing Your Bicycle	15

4. BATTERY AND CHARGER	17
4.1. Important Safety Instructions	17
4.1.1 Instructions pertaining to the risk of fire or electric shock	17
4.2. Battery Damage	19
4.3. Battery Installation Instructions	19
4.3.1 Battery Removal & Replacement	19
4.4. Operating Instructions	20
4.4.1 Charging The Battery	20
4.4.2 Battery Discharge Information	21
4.4.3 Battery Charge Level Display	22
4.5. User Maintenance Instructions	22
4.5.1 Cleaning	22
4.5.2 Battery troubleshooting	23
4.6. Moving And Storage Instructions	23
4.6.1 Transport	23
4.6.2 6.6.2 Storage	23
4.7. Disposal	24
4.8. Range Extender (RE)	24
4.8.1 Range Extender Installation Instructions	25
4.8.2 Operating Instructions	27
4.8.3 Range Extender Battery Discharge	27
4.8.4 RE Battery Charge Level Display	28
4.9. 6.9. Battery Technical Data	29
4.10. Charger Technical Data	29
4.11. Charging Times	30
4.12. Battery Label	30
5. REGULATORY STATEMENTS	31
6. EC – DECLARATION OF CONFORMITY	33
7. UK – DECLARATION OF CONFORMITY	33

Congratulations on the purchase of your new Specialized Turbo bike! Before we get you set up for your first ride, a few words about electric bikes. As the name suggests, and unlike regular bicycles, Specialized electric bikes have very sophisticated and carefully engineered high-precision electrical components, including a built-in custom motor drive unit, a high-performance battery integrated into the frame, sensors, one or more display units, and wiring throughout to make sure everything is connected. You will also have a unique riding experience with added speed and acceleration from the motor support. Because of this, you need to treat your electric bicycle differently from a regular bicycle and you need to be careful not to damage electrical components. This means you should not expose any electrical components to water (e.g., do not pressure-wash your bicycle), drop or otherwise damage your battery, touch any live components, or open up or otherwise tamper with electrical components. This also means you should be mindful that your lithium-ion battery, when sufficiently charged, has enough energy stored to potentially start a fire. Follow the instructions in this manual when it comes to charging, transporting, cleaning, or storing your battery.

Not following these instructions may have serious consequences and can result in a fire, which may injure you and other people. Be sure you read this manual in its entirety and contact your local Rider Care team if you have any questions.

 **WARNING!** Please read and familiarize yourself with the Important Safety Instructions pertaining to the risk of fire or electric shock in the BATTERY AND CHARGING Section Of this User Manual before riding or servicing your bicycle.

 **WARNING!** Be careful not to damage or expose electrical components to water. Do not pressure wash your battery, motor, or any other electrical components. Damaging electrical components or exposing them to water may start a fire, resulting in serious injury or even death.

 **WARNING!** Always be present when charging your battery, and disconnect it when it is fully charged. Do not leave your battery plugged in or let it charge overnight. Immediately disconnect the battery from the charger when you encounter any problem during the charging process, e.g., when the charger or battery gets extremely hot or when the LED lights signal a problem. Failure to follow this warning can start a fire which can result in serious injury or even death.

 The term “battery” used in this user manual refers to all original Turbo batteries.

The images shown in this manual may differ from your bicycle, but are similar enough to help you understand the instructions. The specifications used for models are current as of the date this manual was written and are subject to change. Specialized reserves the right to change the configuration and function at any time and without notice, including modifying, reducing, and/or adding features.

SPECIALIZED BICYCLE COMPONENTS

15130 Concord Circle, Morgan Hill, CA 95037 (408) 779-6229

0000000000_UM_R1 00/23

We may occasionally issue updates and addendums to this document. Please periodically check www.specialized.com or contact Rider Care to make sure you have the latest version.

1. INTRODUCTION

THIS USER MANUAL CONTAINS IMPORTANT INFORMATION. PLEASE READ CAREFULLY AND STORE IN A SAFE PLACE.

This manual was drafted in the English language (Original instructions) and may have been translated into other languages as applicable (translation of original instructions).

This user manual is specific to your Specialized Turbo bicycle and should be read in addition to the Specialized Bicycle Owner's Manual ("Owner's Manual"). It contains important safety, performance, and technical information, which you should read before your first ride and keep for reference. You should also read the entire Owner's Manual because it has additional important general information and instructions which you should follow. If you do not have a copy of the Owner's Manual, you can download it at no cost at www.specialized.com, or obtain it from your nearest Authorized Specialized Retailer or Specialized Rider Care.

Please note all instructions and notices are subject to change and updates without notice. Please visit www.specialized.com for periodic tech updates.

Additional safety, performance, and service information for specific components such as suspension or pedals on your bicycle, or for accessories such as helmets or lights, may also be available. Make sure that your Authorized Specialized Retailer has given you all the manufacturers' literature that was included with your bicycle or accessories. In case of a conflict between the information in this user manual and information provided by a component manufacturer, please contact your nearest Authorized Specialized Retailer.

The Vado is classified as an EPAC (Electrically Power Assisted Cycle, otherwise known as a Pedelec), and is referred to in this manual as a bicycle unless otherwise noted.

ADDITIONAL LANGUAGES ARE AVAILABLE FOR DOWNLOAD AT www.specialized.com.

When reading this user manual, you will note various important symbols and warnings, which are explained below:



WARNING! The combination of this symbol and word indicates a potentially hazardous situation which, if not avoided, could result in serious injury or death. Many of the Warnings say "you may lose control and fall." Because any fall can result in serious injury or even death, we do not always repeat the warning of possible injury or death.



CAUTION: The combination of the safety alert symbol and the word **CAUTION** indicates a potentially hazardous situation, which, if not avoided, may result in minor or moderate injury, or is an alert against unsafe practices.

The word **CAUTION** used without the safety alert symbol indicates a situation which, if not avoided, could result in serious damage to the bicycle or the voiding of your warranty.



INFO: This symbol alerts the reader to information which is particularly important.



GREASE: This symbol means that high-quality grease should be applied as illustrated.



TECH TIP: Tech Tips are useful tips and tricks regarding installation and use.

1.1. WARRANTY

Please refer to the written warranty provisions provided with your bicycle, or visit www.specialized.com. A copy is also available at your Authorized Specialized Retailer.

2. SYSTEM INTERFACE

Your bicycle is equipped with the MasterMind H3 System (SBC-D10) which controls the system and functionality of the bicycle.



The functionality of the system interface as summarized in this manual is current as of the date this manual was written and is subject to change. Specialized reserves the right to change the functionality at any time and without notice, including modifying, reducing, and/or adding features.



WARNING! Use caution when viewing or using the display while riding, as it can be distracting and can lead to accidents. You should always stop before changing settings or operating the various functions of the display. Do not attempt to customize the pages or perform setup adjustments while riding.

2.1. POWERING ON



- To start the system, press and hold the POWER (Top) button on the MasterMind H3 remote until the display powers on.
- To power off the system, press and hold the POWER button again.

2.2. MASTERMIND H3 HMI SYSTEM

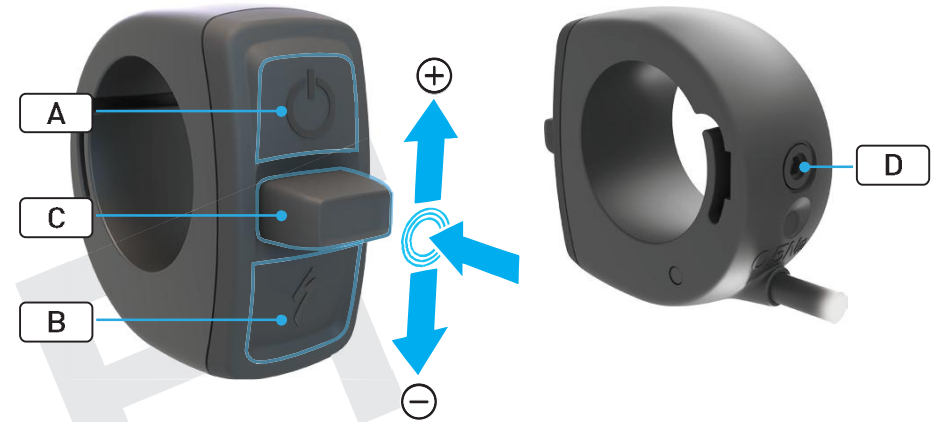

2.2.1 MASTERMIND H3 REMOTE

- The MasterMind H3 handlebar remote controls the function of the system. The remote powers on the bicycle, controls the level of motor support, and controls the operations and scrolling of the MasterMind H3 display.
- The remote has five function buttons used to control your bicycle's functions. **(A)** Top Button (Power), **(B)** Bottom Button (Walk Assist), and the **(C)** Joystick button, which is pushed upward, downward, and inward to perform different functions.
- The compression screw **(D)** is used to secure the remote to your preferred angle (2 mm hex key at 0.8 Nm / 7 in-lbf).

2.3. MASTERMIND H3 DISPLAY



- The MasterMind H3 displays realtime ride information on the display (E).
- **H3:** The display is mounted to a Twistlock mount (F) integrated into the stem. Removing the MasterMind display will require disassembling the stem and handlebar to free the cables. Any modifications or changes should be made by an Authorized Specialized Retailer. Please refer to the General Notes about Assembly section of this user manual for more information on the stem assembly.
- The USB-C port (G) on the left side of the display is for Specialized retailers and service centers. Ensure the rubber port seal is firmly closed when the bicycle is in use.
- The USB-C port (G) may also be used to charge your phone and other accessories with up to a 1A current.
- Do not expose the display to intense heat or sunlight for a prolonged

- period. This can damage the display and/or internal battery.
- Only use a damp or dry soft cloth to clean the display. Do not use harsh cleaning products.
- Do not disassemble or drop the display.
- Make sure the display and mount are firmly installed on the handlebar before riding.

2.4. MASTERMIND H3 REMOTE

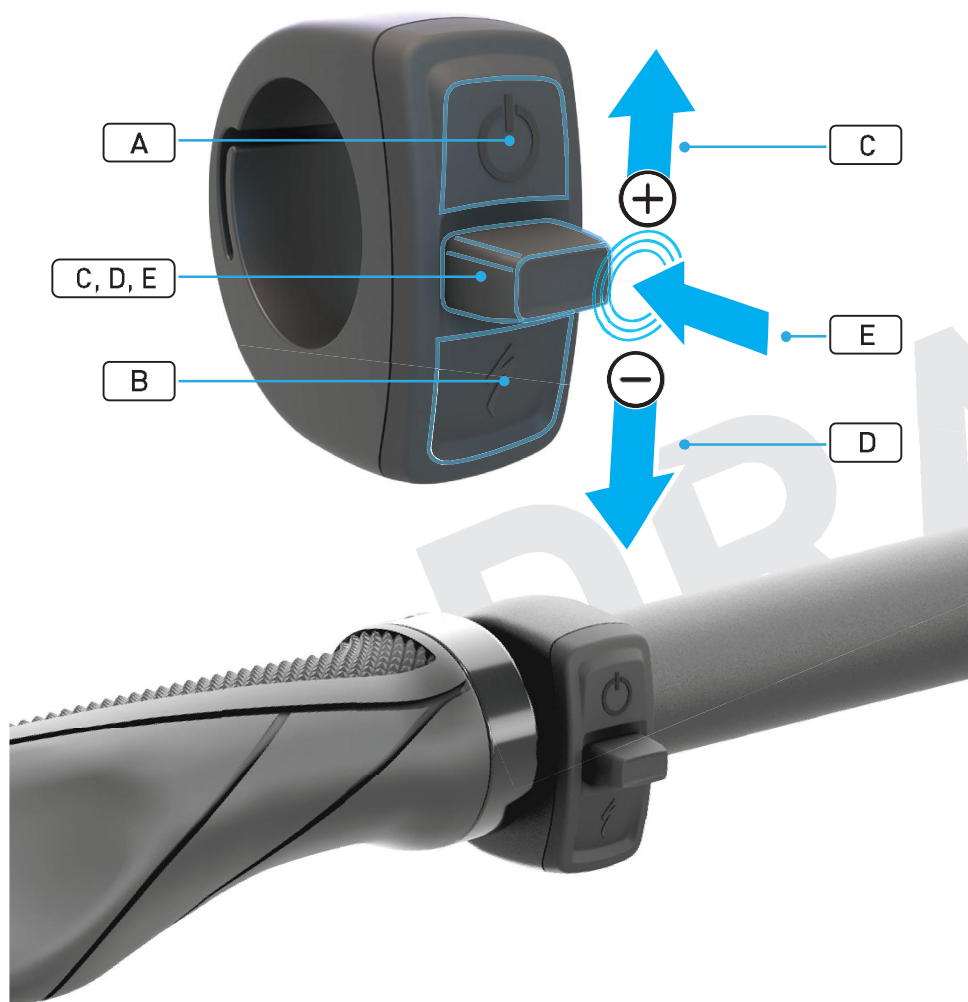

	DESCRIPTION	FUNCTION	
A	Top Button	Long press	Power On
		Long press	Power Off
		Long Press 40 sec	Factory Reset
B	Bottom Button	Press & hold	Activates the Walk Assist mode.*
C	Center Joystick Up-Press	Short press	Increases the amount of support.**
		Long press (2 secs)	Switches to Micro Tune mode
		Long press (10 secs)	Apple Find My Instructions
D	Center Joystick Down-Press	Short press	Decreases the amount of support.**
		Long press (2 secs)	Resets all the ride data and automatically stops your ride in the Specialized App if connected.
E	Center Joystick Center-Press	Short press	Toggles the MasterMind H3 pages to display more data fields such as odometer, speed, and distance.
C&E	Center Joystick Center-Press & Up-Press	Long press (5 Secs)	Opens the legal and regulatory information and is navigated by the up and down press buttons. Pressing the bottom button exits the information.

2.5. MASTERMIND H3 DISPLAY

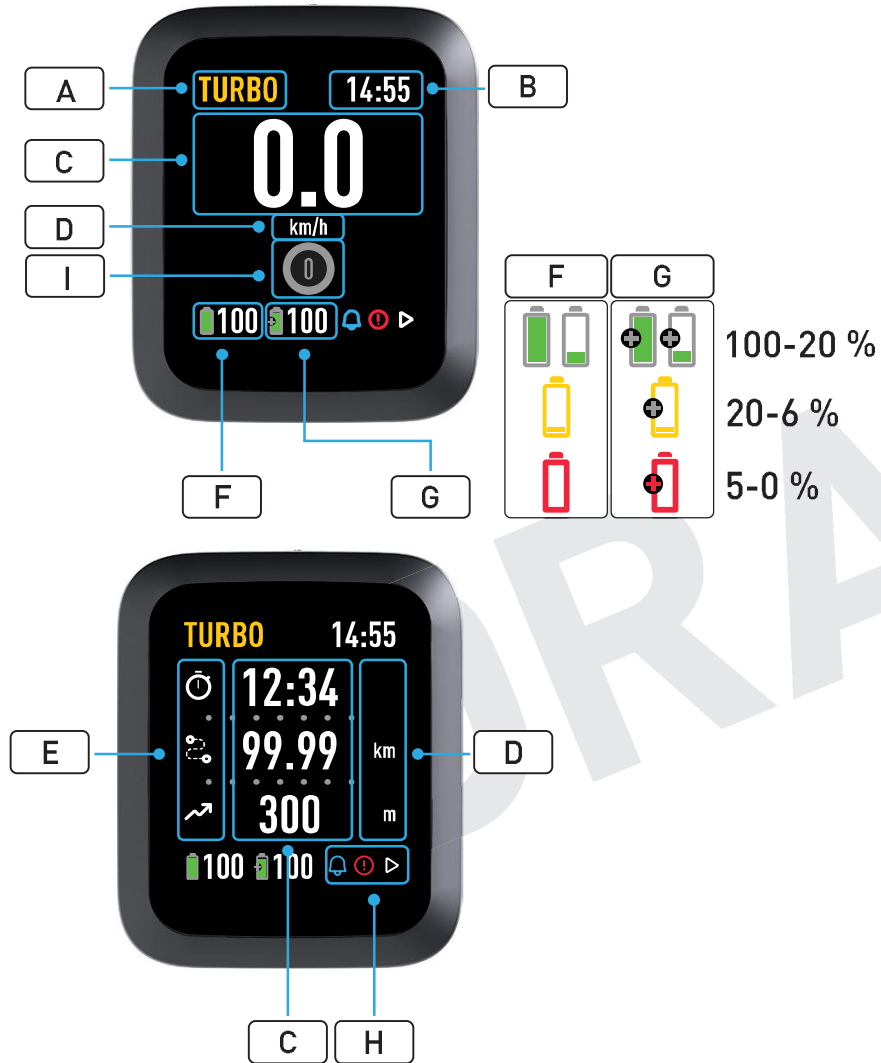

2.5.1 SCREEN LAYOUT

A	Assist Mode	E	Data Field Icon
B	Time Of Day	F	Battery Charge Status
C	Data Field	G	Range Extender Charge Status
D	Unit of Measurement	H	Notification Icon

2.5.2 DATA FIELD ICONS

	DESCRIPTION		DESCRIPTION		DESCRIPTION
	Countdown time remaining		Alt decent		Range trend
	Support peak power		Lock		Shifter battery
	Ride time		Heartrate		AXS
	Distance		Motor power electric		Jump count
	Odometer		Rider power		Jump time
	Cadence		Motor power		Jump distance
	Altitude		Grade		
	Alt gain		Estimated range		

2.6. SUPPORT MODES

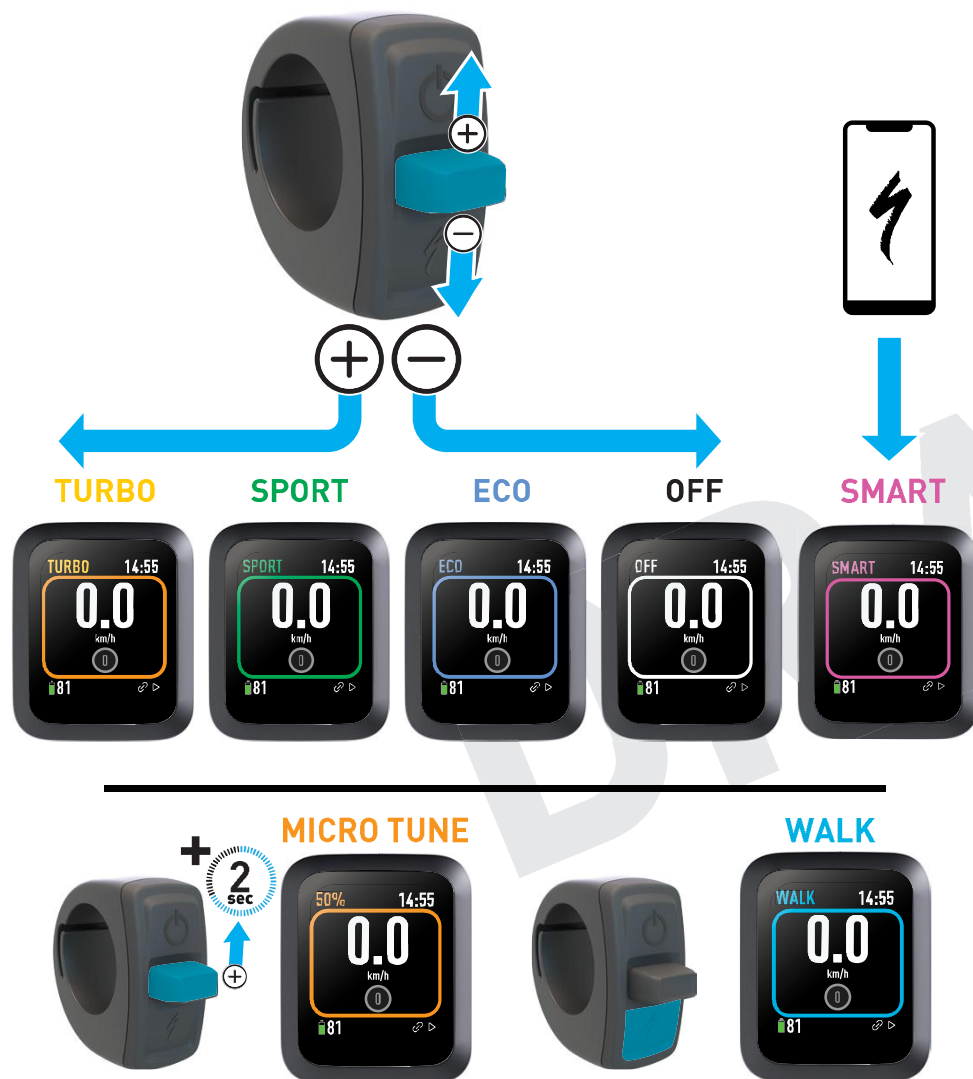

The Turbo motor offers six assist modes: **TURBO**, **SPORT / TRAIL**, **ECO**, **OFF**, **MICRO TUNE**, **SMART CONTROL**, and **WALK ASSIST**.

As a quick reference, each mode is associated with a color. When you change modes, the color on the display changes.

SUPPORT MODES:

- **TURBO**: Maximum power mode for high-speed sections and climbing.
- **SPORT/TRAIL**: Maximum control, with sufficient power on demand.
- **ECO**: Most efficient mode for maximum range while offering good power.
- **OFF**: The motor will not offer any assistance, but the display and lights will still function.
- **SMART CONTROL**: The motor, while pedaling, adjusts the power output based on the ride parameters determined in the Specialized App.
- **MICRO TUNE**: Micro Tune mode allows you to simultaneously change the support and peak power in 10% increments whilst riding.
- **WALK ASSIST**: Walk Assist provides motor assist at **6 km/h / 3.7 mph** to help push the bicycle uphill when walking.

i The default Support mode and the individual **support mode settings can be modified in the Specialized App.**

The Smart Control mode is only accessible when the bicycle is connected to the Specialized App and Smart Control mode is turned on. When more or less motor support is needed or desired, Smart Control can be bypassed for a short period of time by toggling between the OFF / SMART / SPORT-TRAIL modes. Smart Control will then automatically reactivate after a short period of time. Smart Control mode can only be turned off in the Specialized app.

i Smart Control can be bypassed for a short period of time by toggling between the OFF / SMART / SPORT-TRAIL modes. Smart Control will then automatically reactivate after a short period of time. Smart Control mode can only be turned off in the Specialized app.

2.6.1 MICRO TUNE MODE

2.7. CUSTOMIZING THE DISPLAY



Switching to Micro Tune mode allows you to simultaneously change the support and peak power in 10% increments while riding.

When Activated the Micro Tune setting will show in the assist field of the MasterMind H3 display.

- Long-pressing (2 secs) the Joystick Up Button on the remote will switch the system to Micro Tune mode.
- Use the Joystick up and down press buttons to increase or decrease the support percentage.
- To switch out of Micro Tune and back to standard modes, long press the Joystick Up-Press button.

The MasterMind H3 has customizable screens that show data fields such as speed, odometer, mode, heart rate, and many more.

To fully customize the setup of the MasterMind H3, pair your bicycle to the Specialized app and adjust your preferred settings and layout in the app.

2.8. AUTO START

You can record your rides in the Specialized App (app) using the ride recording feature, and with the “Auto Start” function activated, your ride can be automatically started, stopped, and recorded. When your bicycle is connected to the Specialized app, the display shows the recording status icons on the display.



- 1. CONNECTED ICON:** The bicycle is paired and connected to the app.
- 2. READY TO RECORD ICON:** The bicycle is connected and is ready to record your ride.
- 3. RECORDING ICON:** When you manually start recording your ride in the Specialized app or when the app detects motion and starts recording your ride when “Auto Start” is activated.
- 4. PAUSED ICON:** when you pause recording your ride in the app or when the app detects no motion and pauses recording your ride when “Auto Start” is activated.
- 5. STOPPED ICON (5 SECONDS):** When you physically stop your ride in the app.

Your ride will be saved when you have pressed stop in the app or the bike has been inactive for more than 3 hours. If not, the app will resume recording if it detects movement within 3 hours.

2.9. PEDAL COACH

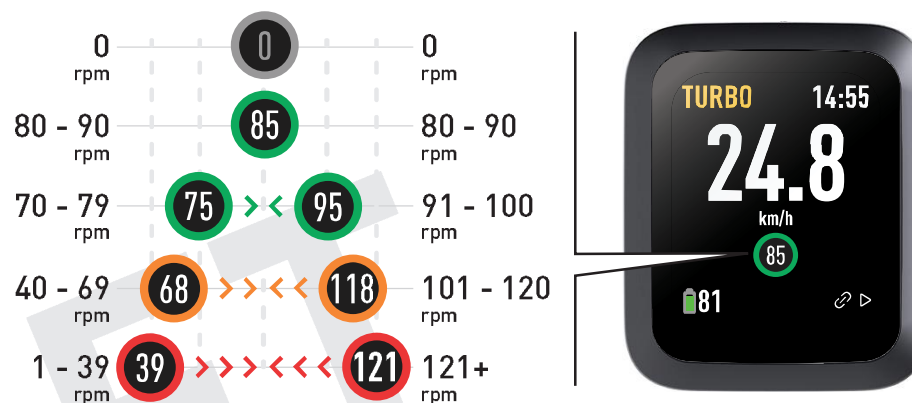

- The landing page of the MasterMind H3 shows the interactive pedal coach. The meter shows your current pedal pace (cadence) and guides you to the optimal pedal pace.
- When your pedal pace decreases, the icon on the cadence bar moves to the left and turns from green (ideal) to orange (low) to red (too low). When the pedal pace gets too high, the icon on the bar shifts to the right and turns from green (ideal) to orange (high) to red (too high).
- For best motor support, efficiency, and range, you should keep your pedal pace in the green zone of the pedal coach.

i The Pedal Coach can be switched off in the Specialized App

2.10. ENVIOLo AUTOMATiQ HUB, PEDAL PACE

On Bicycles equipped with the enviolo AUTOMATiQ IGH you can set your target Pedal Pace (cadence) at which you are most comfortable pedaling. The transmission is controlled automatically, so you can always pedal at the same pace, up or downhill. You can adjust your preferred pedal pace (cadence) in the Specialized App.

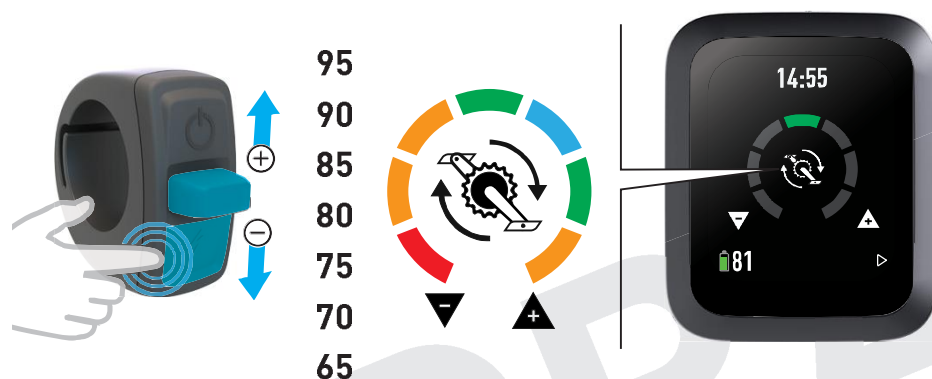

- Short-pressing the Bottom Button will activate the enviolo cadence adjustment setting.
- Short-pressing the Joystick Up-Press increases the desired pedal pace while short-pressing the Joystick Down-Press decreases the desired pedal pace.



The pedal pace page for the enviolo AUTOMATiQ IGH is displayed for 5 seconds after the last button push and will then revert to the previous layout.

2.11. TURBO SYSTEM LOCK



Your bicycle must first be Activated to use the system lock feature.

MasterMind H3 equipped bicycles include a Turbo System Lock that electronically locks the motor support of the bicycle. There is also an optional beeper alarm or lights if the bike is moved with System Lock Activated. You can unlock your bicycle with the Specialized App or enter your preset PIN using your MasterMind remote.

2.11.1 APP LOCK AND UNLOCK

The bicycle can be locked and unlocked manually or automatically with the Specialized App.

The Manual lock requires you to open the app and lock and unlock the bicycle in the app.

The Automatic lock functions when your mobile phone is near the bicycle, automatically locking and unlocking the system lock.



Some mobile phone operating systems might need to have the Specialized App already open for the automatic system lock to function.

2.11.2 PIN UNLOCK

If you cannot access your mobile phone, you can use the remote to insert your pin code and unlock the bicycle.

- Power on your bicycle, then press the Joystick Center button on your handlebar remote. The PIN entry field will appear on the MasterMind H3
- Press Joystick Up or Down button to change the number. Press the center button on the joystick to move to the next digit entry.
- Once the correct four digits are entered, press the Joystick Center Button to submit the PIN and unlock the bicycle.

2.12. RADAR

Some bicycle models are fitted with a Garmin radar system designed to warn you of vehicles approaching you from behind.

WARNING! Before using the Garmin radar system, please read the applicable sections in the provided manual(s), including all safety warnings and instructions.

WARNING! While the Garmin radar device can be used as general guidance with respect to vehicles approaching directly from behind you, make sure you are aware of your surroundings at all times. Depending on size, speed, location, not all traffic participants may be accurately detected and displayed.

i Some Turbo models do not have the Radar system integrated and the Garmin Radar Wireless system can be paired using the Specialized App

2.12.1 STARTUP



The Garmin radar system is integrated into the MasterMind H3 display and appears on the left side of the display on equipped models **(A)**.

When the bicycle powers on, the radar is shown as a flashing amber dot **(B)** on the top left side of the display, when the system is activated the dot will turn green **(C)**.

2.12.2 VISUAL ALERTS



- The vehicle position indicator, shown as a white dot, moves up the display the closer the vehicle gets to your bike (A). The further down on the display, the further away the vehicle will be.
- Multiple white indicator dots (B) indicate multiple vehicles. One indicator dot represents one vehicle.
- The first detection of a vehicle will be up to 140 m (150 yards) away and is shown as the lowest white indicator dot on the display.
- The white indicator dot will disappear once the vehicle has passed.
- When riding, the top indicator dot will change color based on the detected proximity and/or speed of the approaching vehicle.
 - C: Green indicator dot means that no vehicle was detected.
 - D: Amber indicator dot means that a vehicle is approaching.
 - E: Red indicator dot means that a vehicle is approaching at a higher-

than-normal speed.

2.12.3 SOUND ALERTS

The MasterMind H3 emits an alarm tone for various alerts.

- The alarm tone for an approaching vehicle differs from the tone when the vehicle has passed. The device will sound an alert as soon as another vehicle is detected.

i Activating or disabling tones can be set in the Specialized App.

2.13. ERROR MESSAGES

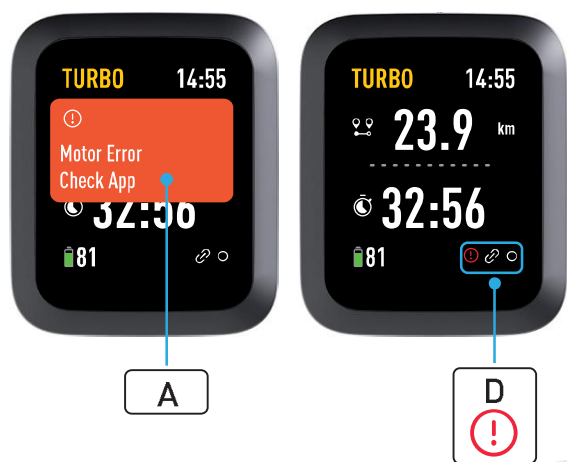

MasterMind H3 has a built-in diagnostic system to automatically check and identify the functionality of the system. If the system detects an error, it shows on the display. In some cases, the error message can be dismissed by pushing any button on the remote. When dismissed, the icon appears in the lower notification bar.

If you receive such an error, check the app for user actions. If the error message continues to display, power off your bicycle and contact your Authorized Specialized Retailer for further help.

Depending on the type of error message, the system may switch off automatically. In any case, the bicycle can be ridden without motor support with the system turned off.



The Specialized app supports the rider with user actions for errors and diagnostic reports which can be shared with Retailers who can give further advice based on the bike serial number.

2.14. LEGAL DOCUMENTATION

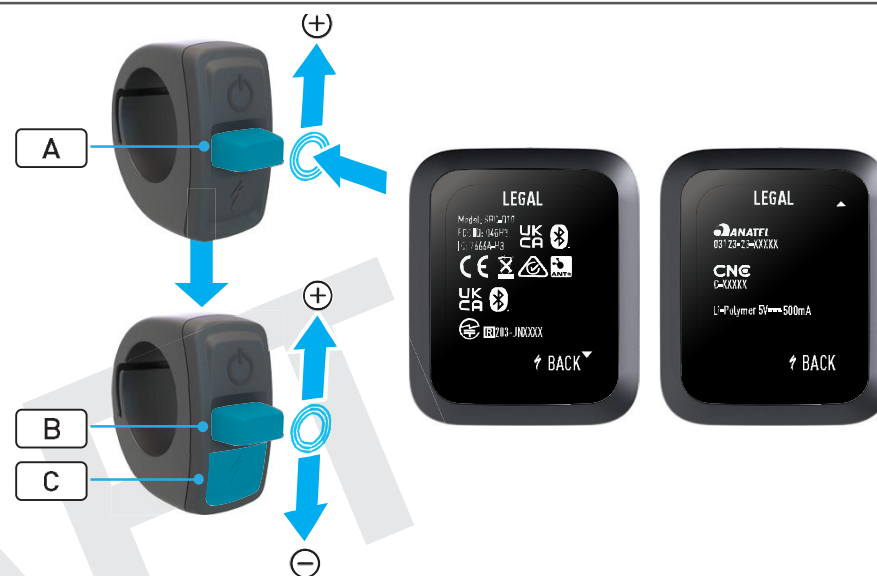

All legal and regulatory information can be accessed on the MasterMind H3 display.

- To open the legal and regulatory information page. Press the joystick center button **(A)** and then push the joystick upward on the remote and hold for 5 seconds.
- Use the joystick up and down buttons **(B)** to scroll through the pages.
- To exit the legal and regulatory information, press the bottom button **(C)**.

2.15. STANDARD AND FACTORY RESET

Under certain conditions, it might be required to perform a factory reset of the MasterMind H3 display.

- When a new or used bicycle is sold, the new user should perform a factory reset.
- To troubleshoot bicycle or display (e.g., app connection issues).
- Factory Reset will restore the default tune settings and reset all zeroable data on the MasterMind display (distance, ride time, etc.)
- Reset will clear any pairing with the Specialized App and any ANT+ or other BLE devices.
- Before pairing again with the Specialized app, you have to forget/clear the bike from your phone's list of known BLE devices.

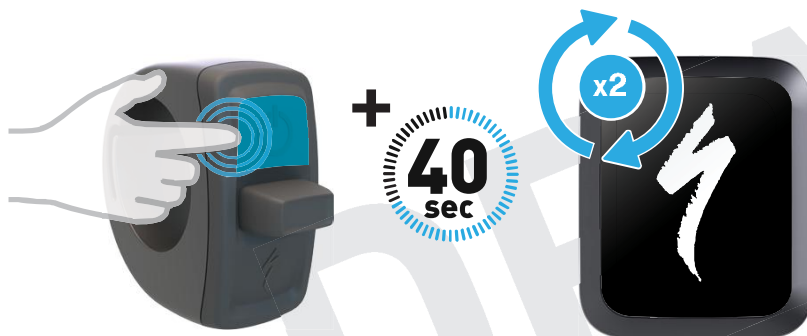

Factory Reset (Resets all Settings)

- Press and hold the POWER button for 40 seconds. During this process, the MasterMind H3 will reboot twice.
- Release the button when the MasterMind H3 reboots for the second time.

i Once a factory reset has been performed, reconnect your bicycle to the Specialized app to reset to your personal system settings.

i Factory Reset is disabled when the bicycle is in the locked mode.

2.16. CONNECTIVITY OPTIONS

The Turbo Technology System provides a high degree of interface flexibility through Bluetooth and/or ANT+ connectivity.

Bluetooth low energy (BLE)

- BLE is used for connecting the bicycle to the Specialized app.
- ANT+ can be used to connect to the sensors for Speed, Rider Power, and Cadence. The sensor data can be received via the ANT+ module built into the TCU.
- In your ANT+ device, search for those sensors and connect to them.
- Some bicycle-specific ANT+ devices feature so-called "LEV" data fields you can use to see all available e-bike data.
- You can also connect a heart rate sensor, Radar and AXS to your bike directly via the Specialized app.

3. SPECIALIZED APP

The Specialized app enables you to personalize and enhance your ride. In addition, it gives you tools to unleash your bicycle's full potential and achieve your cycling goals.

Most importantly, the app allows you to customize motor characteristics, diagnose the bicycle system, record rides, see real-time ride data, and control the bicycle range.



The Specialized app is constantly being improved and is subject to change without notice. Make sure you have the latest version of the App installed on your mobile device. Use the in-app guide to stay up to date on all the latest features and updates.

3.1. SPECIALIZED APP FEATURES

MOTOR TUNE

- Customize and transform your ride based on your wants by adjusting your motor performance based on Support and Peak Power.
- You can save your tune settings as a custom preset and save multiple presets for your different types of rides.

CONNECTED RIDE RECORDING

- See the live map and view live ride data.
- Record your route, speed, distance, rider power, and time with a single tap.
- View your recorded rides in the app or use the app integration to upload your rides to 3rd party apps.

SMART CONTROL

- Activating Smart Control means you don't have to worry about the mode setting or battery capacity during your ride. You can set the Smart Control by distance, duration, or heart rate goal and let your bike do the rest.

DIAGNOSE

- Diagnose can give you an overview of your bicycles motor, system, and battery health, including user guidance with some bike errors.

FIRMWARE UPDATES

- Update some of your bicycle firmware with over-the-air updates.

BICYCLE LOCK

- Bikes equipped with the MasterMind H3 include a Turbo System Lock that electronically locks the motor support for the bike. There is also an optional beeper alarm or lights if the bike is moved while locked. You can unlock your bike either with the Specialized app or by entering your PIN using your remote

3.2. SIGN IN TO THE SPECIALIZED APP

Once you've installed the App, you can sign in using the same email address and password you use for other Specialized digital platforms such as Specialized.com, Ride, or Retül. You can also create a new account in the app.

3.3. IN-APP HELP GUIDE

More in-depth information can be found on the individual screens within the app. This in-app help guide explains the key terms and features of the individual screens.

3.4. PAIRING YOUR BICYCLE

When connecting to the Specialized app for the first time, the app prompts you to add your bicycle.

Select the bicycle serial number that matches the bicycle you are pairing. The bicycle serial number can be found on the frame or the removable yellow sticker IN YOUR MANUAL.

When the app prompts you, confirm the six-digit pairing code shown on the display. Then, follow the instructions displayed on the display and in-

app messages to complete the connection. More bicycles may be added to the app in the MY BIKES Section.



You'll only need to pair your bicycle with the Specialized app once unless you clear your device's Bluetooth history or switch to a new device.

DRAFT

4. BATTERY AND CHARGER

Your bicycle includes a powerful high-performance Lithium-Ion battery integrated into the bicycle frame. The Turbo SL battery is fitted inside the down tube and can only be removed by first removing the motor. Any work required on the motor and battery should be carried out by an Authorized Specialized Turbo Retailer.

Be mindful of the energy stored in your battery and make sure you read and follow the below instructions regarding handling, charging, storing, and cleaning. Not following these instructions may have serious consequences and can result in a fire, which may seriously injure you and/or other people.

Refer to the Battery technical data section of this manual for all operating and storage temperature ranges.

Any work required on the motor and battery should be carried out by an Authorized Specialized Turbo Retailer.

4.1. IMPORTANT SAFETY INSTRUCTIONS

4.1.1 INSTRUCTIONS PERTAINING TO THE RISK OF FIRE OR ELECTRIC SHOCK



WARNING! When using this product, basic precautions should always be followed, including the following.



WARNING! Risk of fire - no user serviceable parts.

1. Read all the instructions before using the bicycle.
2. Close supervision is necessary to reduce the risk of injury when the product is used near children. Children should also not play with the battery system.
3. This battery system is not intended for use by persons (including children) with reduced physical, sensory, or mental capabilities or lack

of experience and knowledge unless they have been given supervision or instruction concerning the use of the battery system by a person responsible for their safety.

4. Do not put your fingers or hands into the product.
5. Rechargeable battery systems need to be charged before use. For charging, please follow the producer's instructions or the instructions in the manual of the device.
6. After a prolonged storage time, it may be necessary to charge and discharge the battery system multiple times to get back to performance.
7. Do not use this product if the flexible power cord or output cable is frayed or has broken insulation or any other signs of damage.
8. Only use the type of battery specifically designed for and approved by Specialized for use with your bicycle. The same applies to the charger, charger cord, and output cable. Only use charger components approved by Specialized to work with your battery.
9. Rechargeable battery systems have the greatest performance when kept and used at normal room temperature **20 °C (68°F)**.
10. This equipment is not intended to be used at ambient temperatures less than **-10°C (14°F)** or above ambient temperatures of **40°C (104°F)**.
11. This battery is intended to be charged only when the ambient temperature is between **0°C (32°F) and 40°C (104°F)**. Never charge the battery when ambient temperatures are out of this range.
12. Do not expose the battery to big temperature changes.
13. Exposing the battery to temperatures above **70°C (158°F)** may result in battery leakage and rupture.
14. Never use or charge a battery with external damage, such as a cracked or chipped enclosure, or if it leaks any battery fluid. The same applies to your charger, charger cord, and output cable. If your charger has any external damage, do not use it. If the charger cord or output cable shows signs of fraying or has damaged insulation, do not use them.
15. Do not expose battery systems to strong mechanical impacts. A hard

enough impact can potentially damage the battery, which may or may not be visible from the outside but can render the battery unsafe.

16. Always keep the battery and battery system dry and clean.
17. Store the battery in a dry place, away from open flames and food.
18. Water inside a battery or charger can cause a short circuit and fire. Do not pressure-wash your battery or charger. Do not submerge them in water or leave them out in the rain or snow.
19. Do not expose battery systems to any solvent materials (i.e., dilution, alcohol, oil, anticorrosive) or chemicals that could impact the surfaces of the battery (i.e., detergents).
20. Chargers are designed for indoor use only. When you connect the charger to the battery, make sure the connections are dry and clean.
21. Always be present when charging your battery, and disconnect the charger from the battery when it is fully charged. Do not leave your battery plugged in or let it charge overnight. Immediately disconnect the battery from the charger when you encounter a problem during the charging process, e.g., if the charger or battery gets abnormally hot (e.g., hot to the touch) or if the LED lights or display(s) signal a problem.
22. The charger may get warm during the charging process. Place it on a level, stable surface unaffected by heat and allow for sufficient ventilation. Do not place the charger on a rug or carpet or cover it up during charging, as it may cause a fire. If the charger stays warm for an extended period after charging, it may be damaged and should be replaced. The same applies to the battery.
23. Never open up, disassemble, or modify the battery or charger. Do not touch any live components. Always turn the battery off before working on your bicycle, before charging the battery, and when the bicycle is not in use.
24. Products with broken seals shall not be used and immediately forwarded for appropriate recycling.
25. Do not allow metallic objects such as keys, coins, or screws to come in contact with the battery, charging socket, or the charger's charging connector. The magnetic charging connector may attract small metallic objects, which could cause a short circuit. Be careful not to pierce the battery with a sharp object like a screwdriver or nail.
26. Do not expose the battery to an open fire or excessive heat, e.g., inside a hot car or in strong sunlight. Review the Battery technical data section, which lists acceptable temperature ranges where the battery can be charged, used, or stored. Never place the battery in a microwave oven or dryer.
27. In the event that you experience symptoms clearly resulting from inhalation or ingestion of combustion gases or if there is direct contact with your skin or eyes, it is imperative to seek immediate medical aid.
28. After inhalation: leave the area immediately for fresh air. Seek medical assistance.
29. In the event of contact with the skin: promptly eliminate any solid particles. It is essential to swiftly remove any clothing that has come into contact with contaminants.
30. In the event of a fire, we urge you to follow these essential steps:
31. Battery Safety:
 - Exercise extreme caution and, if feasible, carefully remove any additional batteries connected to your bicycle.
 - Note: Always prioritize your personal safety, and do not endanger yourself by attempting to remove batteries if it puts you at risk.
32. Immediate Evacuation:
 - Promptly evacuate all individuals from the immediate vicinity of the fire.
 - Ensure everyone moves to a safe location away from the flames, heat, and smoke.
33. Fire Suppression Techniques:
 - Utilize copious amounts of cold water to extinguish the fire.
 - It is recommended to use at least ten times the weight of the battery pack in cold water.

- This substantial amount of water helps to cool down the affected area and douse the flames effectively.
34. Before storing the battery, reduce the charge to approximately 50%. Charge the battery back up to 50% of charge every three to six months to ensure the battery does not completely discharge itself, which can lead to the battery being unable to be charged again.
 35. Always keep the battery and charger out of reach of children. They are not toys.
 36. Keep original printed papers with product information for later consultation.

SAVE THESE INSTRUCTIONS for future reference so that they can be easily accessed when needed.



WARNING! Failure to follow the instructions in this section may result in damage to electrical components and may cause a fire or electric shock, which may result in serious personal injury or even death. If your battery is damaged, do not charge it. If possible, bring the charge down to under 50% and do not store it inside your home or office. Store it outside in a safe area or in an appropriate specialty battery container. If your battery presents an immediate danger, call your local Fire Department.

4.2. BATTERY DAMAGE

Always keep in mind that when sufficiently charged, your battery has enough energy stored inside to cause a fire. Charging, using, handling, or transporting a damaged battery may seriously injure you and others.

Because of this, it is important to regularly inspect the battery for physical damage, especially after a crash or impact. If your battery is fully hidden inside the frame, checking it may require partial disassembly of the bicycle which should be performed by your Authorized Specialized Retailer. It is also important to regularly check your battery health by connecting it to the Specialized app. The app may alert you to any internal issues with the

battery in which case you should follow the instructions given to you in the app. You should also have it inspected regularly by your Authorized Specialized Retailer which has additional tools available and can also make sure you have the latest firmware installed. Abnormal behavior, e.g., the battery becomes hot to the touch while charging or stays warm for long periods of time after disconnecting it from the charger, may be signs that the battery is damaged.

The following are signs of physical damage which may render your battery unsafe requiring immediate replacement:

- Cracking or chipping of the battery enclosure
- Thermal deformation (e.g., bulging)
- Odor, smoke, or a hissing sound coming from the battery
- Leaking of battery fluid
- Damaged connectors
- Signs of water ingress into the battery (e.g. rust)



WARNING! If your battery has signs of damage, do not charge it. If possible, bring the charge down to under 50% and do not store it inside your home or office. Store it outside in a safe area or in an appropriate specialty battery container. If your battery presents an immediate danger, call your local Fire Department.



WARNING! Battery liquid can cause skin irritation and burns. If you come in contact with battery fluid, immediately flush with water and seek medical assistance, if needed.

4.3. BATTERY INSTALLATION INSTRUCTIONS

4.3.1 BATTERY REMOVAL & REPLACEMENT

The Battery in your bicycle can only be removed by removing the motor. from the frame. Any work required on the motor and battery should be carried out by an Authorized Specialized Turbo Retailer.

4.4. OPERATING INSTRUCTIONS

4.4.1 CHARGING THE BATTERY

Before charging the battery, make sure that the system is turned off.

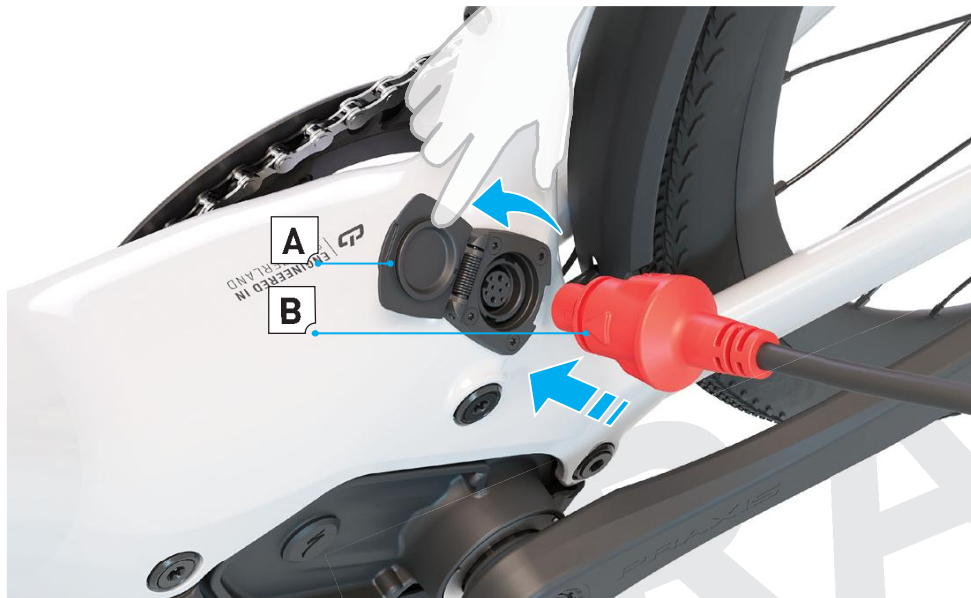

- Plug the charger's plug into an outlet, using the appropriate plug for the country's standards. Do not plug the charger into an extension cord.
- Open the charge port on the non-drive side of the frame near the motor **(A)**.
- Insert the charging plug into the charge port. Use the arrow on the connector as guidance for the correct orientation **(B)**.



CAUTION: Make sure your charger is rated appropriate for the voltage output in your area. Check the charger label for more information. Connecting the charger to an outlet that has too much or too little output may damage it.



WARNING! When charging your battery, always make sure the charger cord is fully inserted into the charger and the plug is fully inserted into the outlet. A loose connection can potentially start a fire.



- Once the battery is charging, you should see visual cues on the MasterMind H3 indicating the charging status **(A)**.
- During the charging process, the diode **(B)** on the charger glows red **(1)**. When the battery is fully charged, the diode on the charger will turn green **(2)**.



WARNING! If the diode on the charger flashes red **(3)**, a charging error has occurred. Immediately remove the charger from the charging socket and outlet and contact your Authorized Specialized Retailer.

- When charging is complete, disconnect the charging plug from the battery charging socket and unplug the charger from the outlet.

- Close the charge port lid to seal it against water and debris.

 **CAUTION:** Always fully close the charge port cover after charging and during riding. It should remain open only when the optional RE is plugged in.

 Please note that Li-ion batteries gradually lose capacity depending on age and use. Strongly reduced operating time after fully charging can be a sign that the battery is reaching the end of its useful life and has to be replaced. Provided the bicycle has been used properly, approximately 75% of the battery's original capacity should remain after 300 charging cycles or two years. Replacement batteries can be purchased from your Authorized Specialized Retailer.

CAUTION: Do not move the bike or rotate the crank arms when the charger plug is inserted into the charge port. This may cause damage to the charger plug and/or the charger socket.

If the bike, charger, or charger are damaged by moving the bike or crank arms while charging, stop using the charger, have an Authorized Specialized Turbo Retailer inspect the damage, and replace all damaged parts.

 **Power off the bicycle to turn off the lights. The bicycle will remain charging while powered off.**

4.4.2 BATTERY DISCHARGE INFORMATION

- At approximately 15-20% (depending on cell temperature and other factors) battery charge remaining, the system starts to reduce the amount of motor support to ensure continuous assistance at lower charge levels.
- At approximately 3%, the system switches off motor support leaving the bicycle powered on. This not only supports battery health and lifetime, but it also allows you to keep any wired lights powered for about 2 hours.
- The timing of the motor shut-off may slightly vary depending on cell temperature or discharge scenario (e.g. when using a Range Extender in single or parallel discharge).
- If your bicycle is at a standstill for 15 minutes or longer, the system turns itself off to save power. In order to continue riding with support, you have to turn the system on again.



WARNING! When the battery level has dropped low enough for the motor system to shut off and the bicycle to go into power-saving mode, wired lights will be powered only for a limited time, up to approximately 2 hours providing some visibility. Therefore, you should stop riding as soon as possible and charge the battery. Lights may shut off at any time without further warning.

4.4.3 BATTERY CHARGE LEVEL DISPLAY

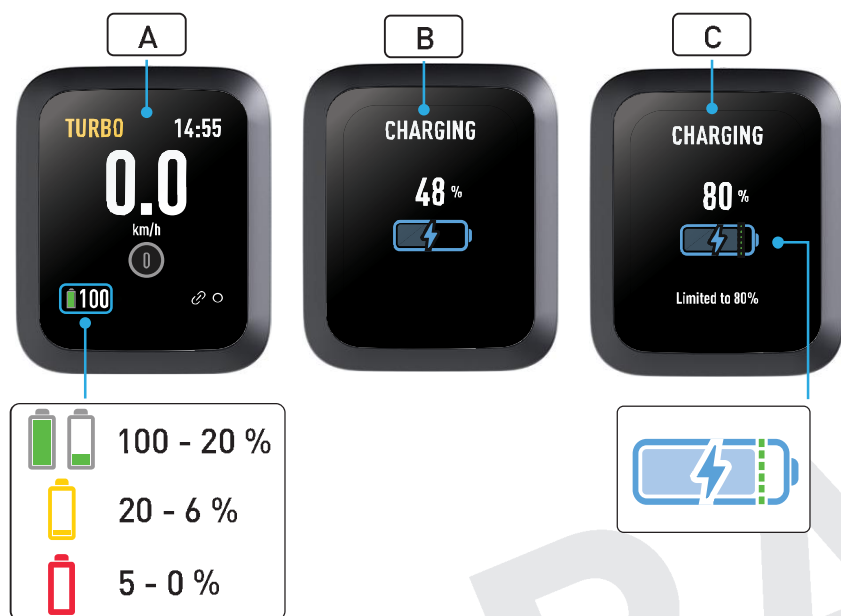

A: RIDING MODE

When riding the charge level of the internal battery is displayed in the bottom left corner of the MasterMind H3.

B: CHARGING MODE

When Charging the charge level of the internal battery is displayed on the MasterMind H3.

C: BATTERY CHARGE LIMIT

To promote good battery health, you can activate the Battery Charge Limit in the Specialized app, This Function will limit the battery charge to 80% of full capacity.

4.5. USER MAINTENANCE INSTRUCTIONS

4.5.1 CLEANING

- Always turn the battery off and remove the charger from the charge port and wall socket before cleaning the battery or bicycle.
- Use a dry or slightly damp cloth for cleaning the battery or bicycle frame. If there is dirt in or around the charge port, trying using low air pressure or a soft brush to remove it. For instructions on how to clean drivetrain components, please refer to the drivetrain manufacturer's instructions.
- When cleaning, make sure the charge port on the bicycle is fully closed and no water comes into contact with the electrical components. If wet, leave the charge port open to dry out completely before connecting the charger.
- If your bicycle is fitted with a RE, remove the connector from the charge port and close the charge port before cleaning.



WARNING! Be careful not to damage or expose electrical components to water. Do not pressure wash your battery, motor, or any other electrical components. Damaging electrical components or exposing them to water may start a fire which can result in serious injury or even death. Do not use or charge a battery you believe had water seep inside. Likewise, all connectors, including the charge port, must be completely dry and clean before using or charging the bicycle.



WARNING! Do not use alcohol, solvents, or abrasive cleaners to clean the charger. Instead, use a dry or slightly damp cloth.

4.5.2 BATTERY TROUBLESHOOTING

Bike does not power on:

- Try to charge the internal battery with the standard charger through the charge port
 - Observe the charger LEDs; a red blinking charger LED can indicate a battery issue. Should charging not initiate, there may be an internal connection issue or a problem with the battery itself. Disconnect the charger from the bike and the power socket.
- Remove the MasterMind H3 and inspect it.
 - Check that the USB C cover is in place and sealed; If not sealed correctly, check the ports for water ingress and corrosion
 - Inspect the cables and connectors for any signs of damage and corrosion. Ensure the connectors are securely connected.
- Connect a powered USB C cable to the display
 - Especially after long-term storage, it is possible that the internal MasterMind display battery is not sufficiently charged. This means the bicycle will not power on directly
 - It is advisable to keep the MasterMind display connected to a power source for around 30 minutes to charge the internal battery to at least 50%; riding with the bike powered on always charges up the internal MasterMind battery
- Connect a Range Extender battery
 - If an SL bike does not turn on, the internal battery can most likely not supply 12V to the TCU. To bypass this, a Range Extender battery can be used to check if it really is the internal battery or the connection from the main harness to the battery.
- If the problem persists, contact your Authorized Specialized Retailer.

4.6. MOVING AND STORAGE INSTRUCTIONS

4.6.1 TRANSPORT



WARNING! When shipping or transporting the battery over long distances, including air travel, the charge should be reduced to 30% or less in case it gets damaged during transit. Package it carefully. Never transport a damaged battery on an airplane.



Transporting and/or shipping your battery may be subject to certain restrictions and may require special handling, labeling, and/or packaging. Be sure to inform yourself beforehand of all applicable legal requirements and regulations in your country or state. Your Authorized Specialized Retailer may also have helpful information available. When carrying the battery outside the frame, Specialized recommends using an approved battery transport box.



CAUTION: Be aware that your electric bicycle may be significantly heavier than a bicycle without motor support. Use caution when handling, carrying, or lifting.

4.6.2 6.6.2 STORAGE



WARNING! When the bicycle is not in use for an extended period of time, store it in a dry, cool, and well-ventilated area. Protect the battery against water and moisture. Before storing, reduce the charge to approximately 50%. Charge the battery back up to 50% of charge every three to six months to ensure the battery does not completely discharge itself which can lead to the battery not being able to be charged again.



WARNING! Do not leave the charger connected to the bicycle when storing it.

4.7. DISPOSAL



Batteries, chargers, and electronic devices must not be disposed of in your household trash! They must be disposed of in an environmentally friendly manner in accordance with the applicable regulations in your country or state. Ask your Authorized Specialized Retailer for information and any applicable battery take-back program.



EUROPE: According to European Guideline 2012/19/EC and European Guideline 2006/66/EC, electronic devices/tools and batteries must be recycled separately and disposed of in an environmentally friendly manner.



BRAZIL: Após o uso, as pilhas e/ou baterias devem ser entregues ao estabelecimento comercial ou rede de assistência técnica autorizada.

BRAZIL: After use, batteries must be delivered to a commercial establishment or authorized technical assistance network.

4.8. RANGE EXTENDER (RE)

Your bicycle is compatible with the Range Extender (RE) to increase range and ride time. The RE is securely held in the specified bottle cage (Zee Cage II - Right) and the Specialized battery retention band supplied with the RE.

The RE connects to the motor through a dedicated power cable that plugs into the charge port. One RE adds **160Wh** to the system adding additional range which will vary considerably depending on the riding conditions, such as the gradient of your route and the support mode. Refer to the Battery and charger section of this manual for general and safety information about handling, using, and charging the RE.

Please see your Authorized Specialized Retailer for the RE(s), cable, retaining band, and the specified bottle cage.



WARNING! Due to the portable nature of the RE, handle it carefully during installation and removal and do not drop it. Do not use or charge an RE that has sustained a significant impact (e.g. from a drop or crash) or is otherwise damaged as it may not be safe to charge or use.



WARNING! Please read and familiarize yourself with the Important Safety Instructions pertaining to the risk of fire or electric shock in the BATTERY AND CHARGING Section Of this User Manual before riding or servicing your bicycle.

4.8.1 RANGE EXTENDER INSTALLATION INSTRUCTIONS

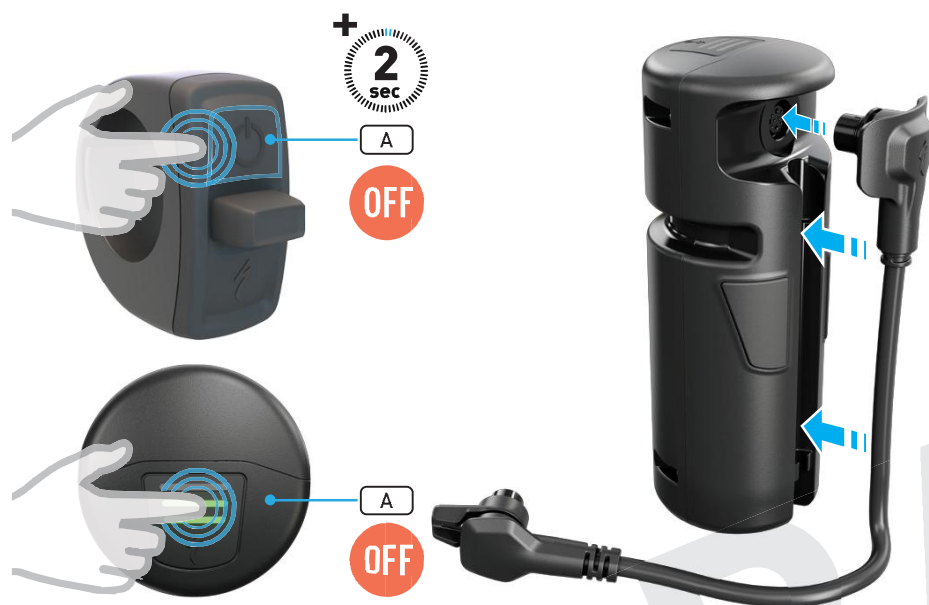

- Ensure the bicycle **(A)** and the Range Extender **(B)** are powered off.
- Insert the end of the power cable with the rounded cover into the onnetor and cable groove of the RE.
- The Vado SL uses the 220 mm RE cable to connect to your bicycle.



- Insert the RE into the bottle cage, then secure the RE into the bottle cage, using the supplied Specialized battery retention band.



WARNING! Always use the supplied battery retainer band when riding.



WARNING! When reinstalling the bottle cage make sure to use the supplied bolts and washers. Longer bolts can cause damage to the internal battery, and larger bolt heads can cause damage to the RE.

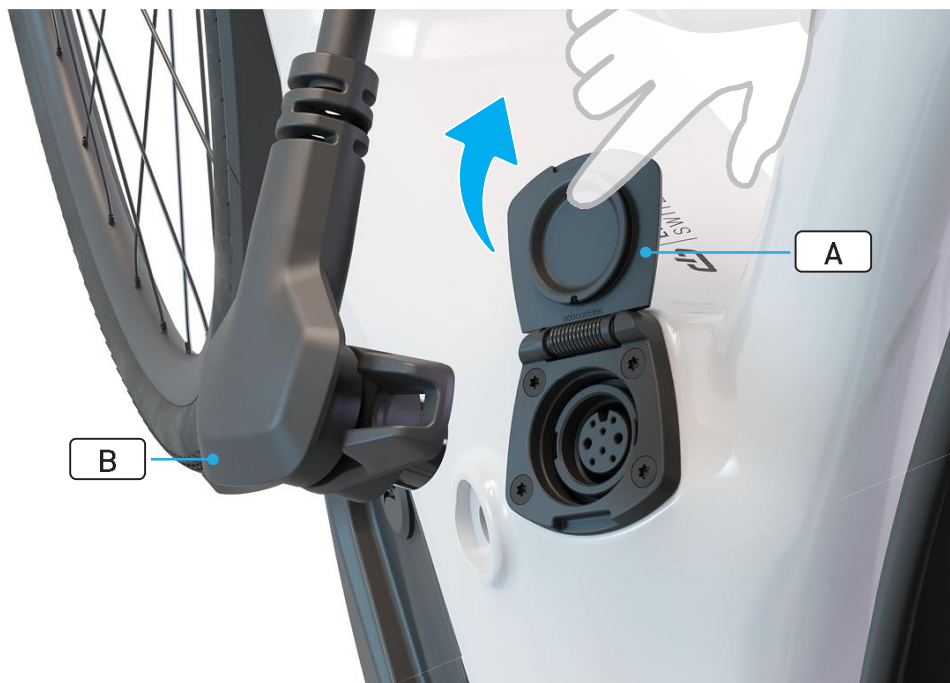

- Open the charge port lid **(A)** on the non-drive side of the frame, near the bottom bracket and insert the RE plug **(B)** into the charge port.



- Once the plug is seated correctly, twist the lever on the connector clockwise to lock the cable in place.
- To verify the RE is successfully connected to the system, check that the RE battery level is indicated on the MasterMind H3.

WARNING! When riding with an RE, always keep the RE cable plugged and locked into the charge port of the bicycle. A loose cable can cause damage to your bicycle and the RE and can become an obstruction which may cause you to lose control and fall.

WARNING! Always use the supplied battery retainer band when riding.

4.8.2 OPERATING INSTRUCTIONS

CHARGING YOUR RANGE EXTENDER

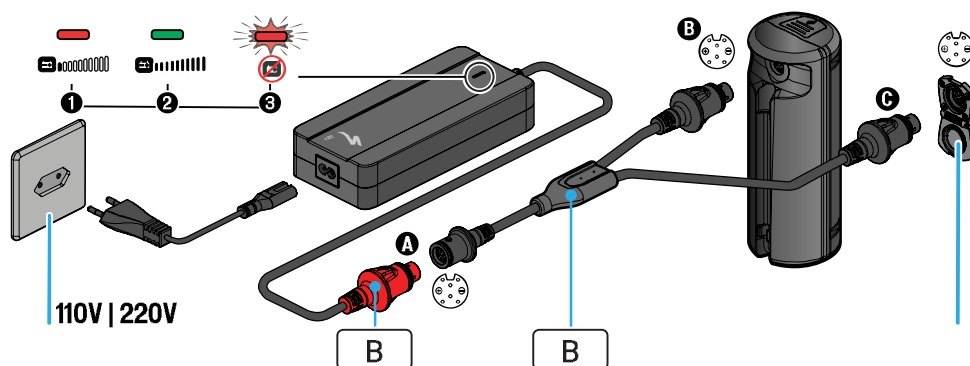

- When charging the RE, use the standard charger and cable (A) supplied with your bicycle to charge the RE.
- If you want to charge both the internal battery and the RE at the same time, an optional Y-splitter cable (B) can be plugged into the charger.
- Refer to the **INSTRUCTIONS PERTAINING TO THE RISK OF FIRE OR ELECTRIC SHOCK** section for general and safety information about handling, using, and charging the RE.



Due to a lower charging current, charging the RE alone takes longer than charging the internal battery and as long as charging RE + internal battery through Y-cable. The reason for slower charge times is to maintain battery health for riders (higher currents would stress the cells and decrease health quicker).



WARNING: The Y-Splitter cable is designed to charge one RE and one internal battery at the same time. Do not connect the Y-Splitter cable to two REs or two internal batteries, or connect more than one Y-Splitter cable to the same charger.



The Y-Splitter cable is available through your Authorized Specialized Retailer.



Please note that Li-ion batteries gradually lose capacity depending on age and use. Strongly reduced operating time after fully charging can be a sign that the RE is reaching the end of its useful life and has to be replaced. Provided the bicycle has been used properly, approximately **75%** of the RE's original capacity should remain after **300** charging cycles or two years. Replacement batteries can be purchased from your Authorized Specialized Retailer.



CAUTION: Always turn off the bicycle before plugging or unplugging the charger or RE.

4.8.3 RANGE EXTENDER BATTERY DISCHARGE

- When the RE is plugged in, the system default is to discharge both the RE and the internal battery simultaneously.
- Parallel discharging is the recommended discharge scenario when using a RE. It offers optimal motor assist over the discharge spectrum and reduces stress on the RE battery compared to discharging the RE first.
- Using the Specialized app, you can adjust the default to completely discharge the RE first. **This will require you to restart the bike to take effect.**
- When riding in "RE first" mode, once the RE reaches 15-20% (depending on cell temperature and other factors) battery charge remaining, the power assistance reduces in multiple stages before the system automatically switches, at approximately 3%, to the internal battery. This also applies if the internal battery is fully charged. This reduction is due to the battery management system protecting the RE from high currents which can damage the RE.

4.8.4 RE BATTERY CHARGE LEVEL DISPLAY

MASTERMIND H3

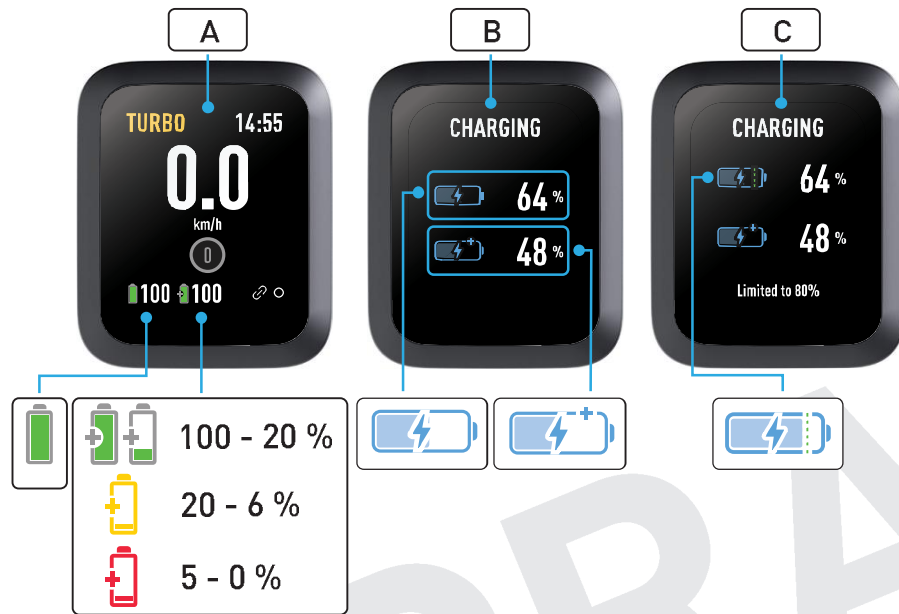

A: RIDING MODE

When riding the charge level of the Range Extender battery is displayed next to the main battery charge level indicator in the bottom left corner of the MasterMind H3.

B: CHARGING MODE

When Charging the bicycle and range extender together with the Y-Splitter cable the charge level of the Range Extender battery is displayed under the the main battery charge level indicator. on the MasterMind H3.

i The Range Extender battery does not have the Battery Charge Limit functionality.

CHARGE LEVEL DISPLAY RANGE EXTENDER

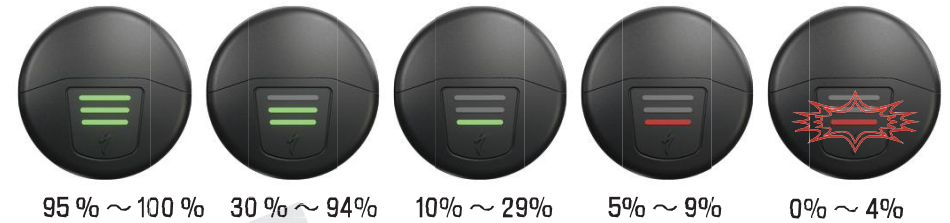

The charge level is displayed on the top of the RE with three colored bars. To check the battery level when not connected to the bike, power on the RE by pressing the button on the top and the battery level will be displayed.

i If the RE has been powered off for more than 2 hours, the RE will need a long push to wake it from deep sleep mode.

4.9. 6.9. BATTERY TECHNICAL DATA

DESCRIPTION	UNIT	SPECIFICATION	
		SBC - B15	SBC - B16 (RE)
Operating voltage	V	46.8	46.8
Charging temperature	°C	0 – +40	0 – +40
	°F	+32 – +104	+32 – +104
Operating temperature	°C	-10 – +40	-10 – +40
	°F	+14 – +104	+14 – +104
Storage temperature	°C	-20 – +60	-20 – +60
	°F	-4 – +140	-4 – +140
Weight	Kg	1.85	1
	Lb	4	2.2
Rated capacity	Ah	6.7 Ah	3.35 Ah
Charging cut current	mA	250+-150mA	250+-150mA
Energy	Wh	320 Wh	160 Wh
Charge time		2:35	3:20

4.10. CHARGER TECHNICAL DATA

DESCRIPTION	UNIT	SPECIFICATION
Charger model number		SBC-C06
Charging temperature	°C	00 – +40
	°F	+32 – +104
Storage temperature	°C	-20 – +60
	°F	-4 – +140
Operating voltage	V	54
AC input voltage	V	100 – 240
Frequency	Hz	50 / 60
Max charge current	A	3
Dimensions	mm	177 x 78 x 38.5

The range of the battery can vary considerably depending on the model/ capacity of the battery and riding conditions, such as the gradient of your route and the support mode.

4.11. CHARGING TIMES

CHARGING SETUP	3% - 100%	STOPS CHARGING (CHARGER LED TURNS GREEN & BIKE TURNS OFF)	CHARGING CURRENT
Internal battery	2h 35 min	2h 55 min	2.5 +/- 0.3A
Range Extender	3h 20 min	3h 25 min	1.0 +/- 0.2A*
Internal battery + Range Extender using Y-Cable	3h 20 min	3h 35 min	3.0+/-0.3A = 1.0+/-0.1A (RE) + 2.0+/- 0.2A (Int.)

The range of the battery can vary considerably depending on the model/ capacity of the battery and riding conditions, such as the gradient of your route and the support mode.

4.12. BATTERY LABEL

WARNING! Before use, read and familiarize yourself with the information on the battery and charger labels.

MAIN BATTERY



RANGE EXTENDER

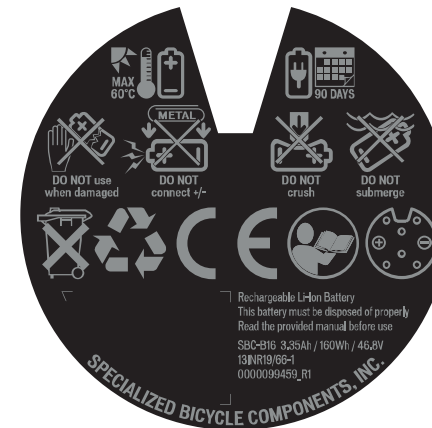

5. REGULATORY STATEMENTS

RoHS:

Specialized Bicycle Components, Inc. certifies that this product and its packaging are in compliance with European Union Directive 2011/65/EU on the Restriction of the Use of Certain Hazardous Substances in Electrical and Electronics Equipment, commonly known as RoHS.

FCC STATEMENT:

This device complies with Part 15 of the FCC Rules.

Operation is subject to the following two conditions: (1) This device may not cause harmful interference, and (2) This device must accept any interference received, including interference that may cause undesired operation.

Caution: If any changes or modifications not expressly approved by the party responsible for compliance could void the user's authority to operate the equipment

The grantee is not responsible for any changes or modifications not expressly approved by the party responsible for compliance. Such modifications could void the user's authority to operate the equipment.

The RF Exposure Compliance distance is 20 millimeters.

NOTE: This equipment has been tested and found to comply with the limits for a Class B digital device, pursuant to part 15 of the FCC Rules. These limits are designed to provide reasonable protection against harmful interference in a residential installation. This equipment generates, uses and can radiate radio frequency energy and, if not installed and used in accordance with the instructions, may cause harmful interference to radio communications. However, there is no guarantee that interference will not occur in a particular installation. If this equipment does cause harmful interference to radio or television reception, which can be determined by

turning the equipment off and on, the user is encouraged to try to correct the interference by one or more of the following measures:

- Reorient or relocate the receiving antenna.
- Increase the separation between the equipment and receiver.
- Connect the equipment into an outlet on a circuit different from that to which the receiver is connected.
- Consult the dealer or an experienced radio/TV technician for help.

ISED STATEMENT:

This device contains licence-exempt transmitter(s)/receiver(s) that comply with Innovation, Science and Economic Development Canada's licence-exempt RSS(s). Operation is subject to the following two conditions: (1) this device may not cause interference, and (2) this device must accept any interference, including interference that may cause undesired operation of the device.

CAN ICES-3(B)/NMB-3(B)

The device meets the exemption from the routine evaluation limits in section 2.5 of RSS 102 and compliance with RSS-102 RF exposure, users can obtain Canadian information on RF exposure and compliance.

This transmitter must not be co-located or operating in conjunction with any other antenna or transmitter. This equipment should be installed and operated with a minimum distance of 20 millimeters between the radiator and your body.

IFT STATEMENT:

L'émetteur/récepteur exempt de licence contenu dans le présent appareil est conforme aux

CNR d'Innovation, Sciences et Développement économique Canada applicables aux appareils

radio exempts de licence. L'exploitation est autorisée aux deux conditions suivantes :

- 1) L'appareil ne doit pas produire de brouillage;
 2) L'appareil doit accepter tout brouillage radioélectrique subi, même si le brouillage est susceptible d'en compromettre le fonctionnement.
 Le dispositif rencontre l'exemption des limites courantes d'évaluation dans la section 2.5 de RSS 102 et la conformité à l'exposition de RSS-102 rf, utilisateurs peut obtenir l'information canadienne sur l'exposition et la conformité de rf.
 Cet émetteur ne doit pas être Co-placé ou ne fonctionnant en même temps qu'aucune autre antenne ou émetteur. Cet équipement devrait être installé et actionné avec une distance minimum de 20 millimètres entre le radiateur et votre corps.









KC MARK STATEMENT:

- < 경고 > 발열, 화재, 폭발 등의 위험을 수반할 수 있으니 다음 사항을 지켜주시기 바랍니다.
- a) 육안으로 식별이 가능할 정도의 부풀음이 발생한 전지는 위험할 수 있으므로 제조자또는 판매자로 즉시 문의할 것
 - b) 지정된 정품 충전기만을 사용할 것
 - c) 화기에 가까이 하지 말 것(전자레인지에 넣지 말 것)
 - d) 여름철 자동차 내부에 방치하지 말 것
 - e) 찌질방 등 고온다습한 곳에서 보관, 사용하지 말 것
 - f) 이불, 전기장판, 카펫 위에 올려 놓고 장시간 사용하지 말 것
 - g) 전원을 켜 상태로 밀폐된 공간에 장시간 보관하지 말 것
 - h) 전지 단자에 목걸이, 동전, 열쇠, 시계 등 금속 제품이 닿지 않도록 주의할 것
 - i) 휴대 기기, 제조 업체가 보증한 리튬2차전지 사용할 것
 - j) 분해, 압착, 관통 등의 행위를 하지 말 것
 - k) 높은 곳에서 떨어뜨리는 등 비정상적 충격을 주지 말 것.
 - l) 60°C이상의 고온에 노출하지 말 것
 - m) 습기에 접촉되지 않도록 할 것
 - n) 폐기 지침 사용이 끝난 전지는 나라 혹은 지방 자치체의 법령에 따라서 폐기하는 것
 - o) 충전 방법에 대한 권고 지침 전용 충전기 또는 본체 기기 사용하는 것 혹은 취급 설명서의 설명에 따르는 것



EU IMPORTER ADDRESS:

Specialized Europe GmbH
 Werkstattgasse 10
 6330 Cham
 Switzerland

CERTIFICATIONS

 ICASA: TA-2020/7345		 203 - JN1154	 CNC ID: C-25552
 R-R-D99-TCU2	 18030-20-11817	 CCAM20LP3380T4	 IFT: RCPSPSB20-2484
 E535626			

6. EC – DECLARATION OF CONFORMITY

The manufacturer:		
Specialized Bicycle Components Inc. 15130 Concord Circle Morgan Hill, CA 95037, USA Tel: +1 408 779-6229		
Hereby confirms for the following products:		
Product description:	EPAC (Electrically Power Assisted Cycle)	Li-ion Battery Charger
Model designation:	SBC-C04 / SBC-C05 / SBC-C07	
Compliance with all of the relevant requirements of:	Machinery Directive (2006/42/EC) Radio Equipment Directive (RED) (2014/53/EU) Electromagnetic Compatibility (2014/30/EU) Low Voltage Directive (LVD) (2014/35/EU)	
The following harmonizing norms were applied to the product:	EN 15194:2017 Cycles – Electrically power assisted cycles – EPAC Bicycles EN 60335-1 Household and similar electrical appliances - safety EN 60335-2-29 Safety of household and similar appliances Part 1: General requirements Part 2: Particular requirements for battery chargers	
Serial number:	Frame decal adhered to the back page of the user manual	
EU technical documentation by:	Dominik Geyer (Leader, Global Turbo Business) Specialized Europe GmbH, Werkstattgasse 10, 6330 Cham, Switzerland	
Signature: 	Dominik Geyer (Leader, Global Turbo Business)	
Specialized Europe GmbH, 6330 Cham, Switzerland, August 1st, 2021		

NOTE: THIS DECLARATION OF CONFORMITY APPLIES ONLY TO BICYCLES SOLD IN COUNTRIES FOLLOWING THE CE MARKING DIRECTIVES.

NOTE: IN ORDER TO CONNECT THE BICYCLE AND THIS USER MANUAL TOGETHER, THE YELLOW SERIAL NUMBER DECAL LOCATED ON THE FRAME OF THE BICYCLE MUST BE PLACED OVER THE FACSIMILE OF THE DECAL ON THE BACK PAGE OF THIS USER MANUAL.

7. UK – DECLARATION OF CONFORMITY

The manufacturer:		
Specialized Bicycle Components Inc. 15130 Concord Circle Morgan Hill, CA 95037, USA Tel: +1 408 779-6229		
Hereby confirms for the following products:		
Product description:	EPAC (Electrically Power Assisted Cycle)	Li-ion Battery Charger
Model designation:	SBC-C04 / SBC-C05 / SBC-C07	
Compliance with all of the relevant requirements of:	Supply of Machinery (Safety) Regulations 2008 Radio Equipment Regulations 2017 Electromagnetic Compatibility Regulations 2016 Electrical Equipment (Safety) Regulations 2016	
The following harmonizing norms were applied to the product:	BS EN 15194:2017 Cycles – Electrically power assisted cycles – EPAC Bicycles BS EN 60335-1 Household and similar electrical appliances - safety BS EN 60335-2-29 Safety of household and similar appliances Part 1: General requirements Part 2: Particular requirements for battery chargers	
Serial number:	Frame decal adhered to the back page of the user manual	
UK technical documentation by:	Leigh Smithers (Operations Manager) Specialized UK Ltd, 65 Woodbridge Road, Guildford, Surrey, GU1 4RD	
Signature: 	Dominik Geyer (Leader, Global Turbo Business)	
Specialized Europe GmbH, 6330 Cham, Switzerland, August 1st, 2021		

NOTE: THIS DECLARATION OF CONFORMITY APPLIES ONLY TO BICYCLES SOLD IN COUNTRIES FOLLOWING THE UKCA MARKING DIRECTIVES.

NOTE: IN ORDER TO CONNECT THE BICYCLE AND THIS USER MANUAL TOGETHER, THE YELLOW SERIAL NUMBER DECAL LOCATED ON THE FRAME OF THE BICYCLE MUST BE PLACED OVER THE FACSIMILE OF THE DECAL ON THE BACK PAGE OF THIS USER MANUAL.

DRAFT

DRAFT

DRAFT

DRAFT

turbob

IT'S YOU, ONLY FASTER

SPECIALIZED BICYCLE COMPONENTS
15130 Concord Circle, Morgan Hill, CA 95037 (408) 779-6229