

## FEATURES

1. Thank you for using Our company's Wireless off Bed zoning pre-alarm system. Please read the user manual carefully for your first use and keep it for future reference.
2. The system unit is small in size and easy to use, with multiple functions such as sound and light warning/vibration reminder /SOS emergency help, bed alarm/near bed warning, etc., which can be applied to the elderly or people with mobility difficulties in homes, nursing homes, hospitals and other places. Wheelchair assistance.
3. System unit AA\*2 battery/pressure pad sensor CR2477\*2 battery/Emergency button CR2032\*1 Battery operation, low power consumption, standby time up to one year, with low power reminder function.
4. System alarm main unit : High volume + vibration / low volume + vibration / only vibration ,multiple modes are optional, press the MODE key to set the mode you need.

## COMPONENTS

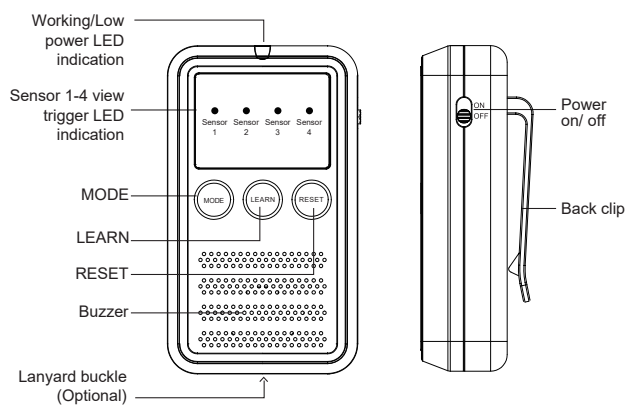

- 1 -

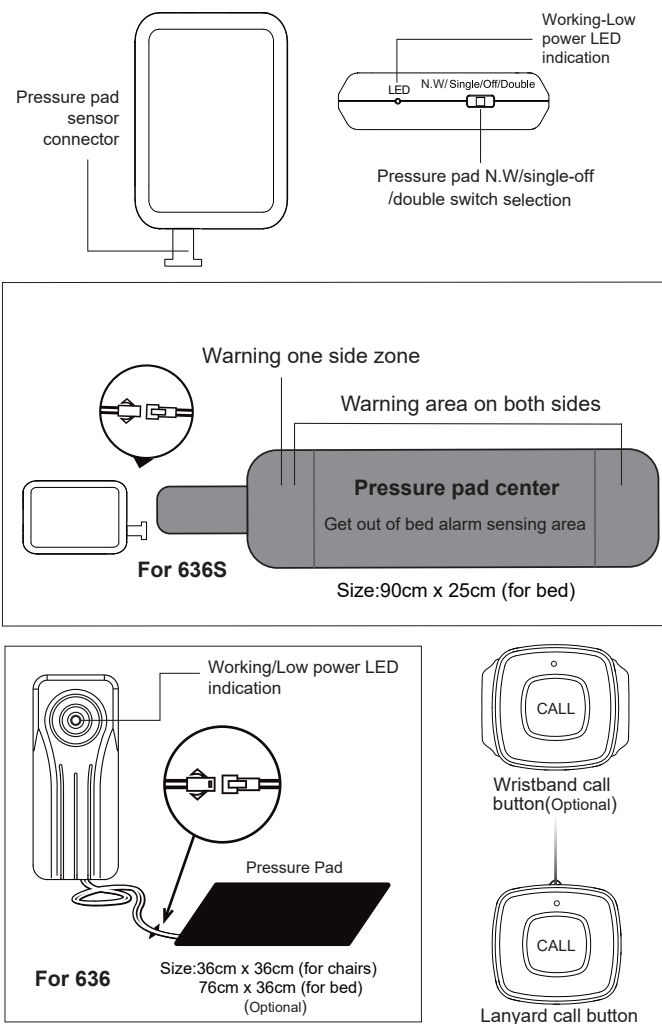

- 2 -

## INSTALL AND USE

1. Start the system main unit. Transmit sensor.Call button battery cover, load the battery according to the battery +/- polarity mark, (Note: AA\*2 Pcs alkaline battery is suitable for the alarm main unit, AAA \* 2PCS for 636S small transmitter, CR2477\*2 battery is suitable for the pressure pad sensor, CR2032\*1 battery is suitable for the Call button), the main unit power ON/OFF switch is on right side, Set transmit sensor Single / Double and N.W switch option as required.

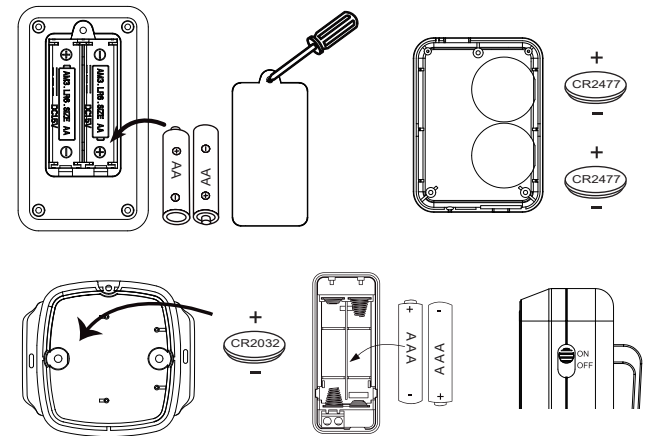

2. System main unit and sensors. The Call button ( Optional ) has been paired in the factory, the sensor pressure pad is placed flat on the bed or wheelchair, the small bag equipped with the transmitter is hung on the edge of the bed or wheelchair, and the optimal position of the pressure pad is adjusted according to the position of the human body lying or sitting (suggest that the pressure pad be placed flat on the shoulders or under the hip of the human body). Set the N.W/Single/Double switch option of the pressure pad sensor according to the need of use (N.W indicates that both sides are off,Single represents only the pre-warning area near one end of the transmitter,Double represents the pre-warning area at both ends of the pressure pad, when the human gravity pressure is placed in the pre-warning area, the alarm main unit will immediately sound alarm).

- 3 -

size: 100x 150 mm  
p/n: 610-6360X-000R  
white paper print black words

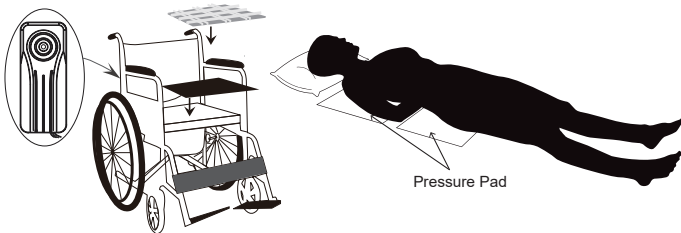

### 3 Leave bed testing:

- a. simulate the human body lying or sitting on the pressure pad and then leave, the pressure pad Sensor immediately sends a signal (Model 636 pressure pad sensor delay 3 seconds), activates the alarm to sound alarm or vibration while the sensor area of the sensor LED lighten ( Go on forever ). Press the Reset key twice to release the current alarm, and the main unit enters the working standby state again. The wireless distance between the alarm main unit and the pressure pad sensor is about 40 to 50 meters.

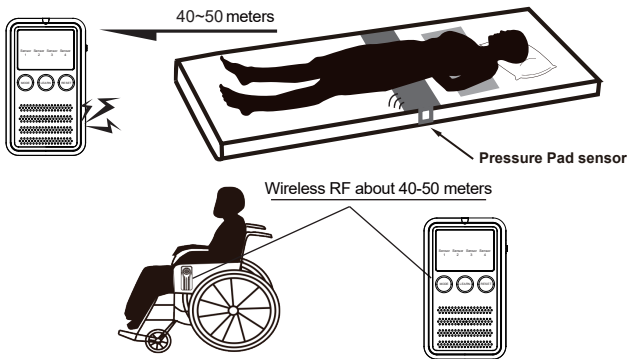

- b. Pre-warning testing (For 636) : The simulated human body lies on the pressure pad sideways or moves to the warning area at both ends of the pressure pad placed on the edge of the bed. In that case, the pressure pad sensor detects that the human body will falling from the bed is in danger and immediately sends a signal to activate the alarm main unit to prompt family members or caregivers to adjust the bed position of the caregivered to the safe area in the center of the bed.

- 4 -

- c. Emergency CALL test: press the call button and activate the alarm host to prompt family members or caregivers to help.
4. Alarm mode/volume setting:Tap the MODE key repeatedly to set the mode and volume you want, high volume + vibration/Low volume + Vibration/Vibration mode only.
5. Learn code pairing and deletion
  - a. The product has learn code paired when left factory ,if you need to change the pairing SENSOR area or increase the pairing use (1main unit can be paired with 4 sensors), long press the LEARN key for 5 seconds to enter the pairing mode, SENSOR 1 LED flashing, indicating that the area can be paired.Trigger the SENSOR to be paired (the pressure pad SENSOR can press the pressure pad with the palm and then loose the palm, and the CALL button can press the CALL key), and hear the Bi sound of the main unit. SENSOR 1 If the LED is long on, the pairing is successful. For example, If the SENSOR 1 LED is long on, it indicates that there is pairing in the area.Tap the LEARN key to select the SENSOR 1-4 pairing area and repeat the SENSOR 1 pairing operation for pairing. Press the RESET key or no operation for 30 seconds to exit the learning code pairing mode.
  - b. Delete the SENSOR pairing. At the same time, Press the MODE+RESET key for 5 seconds to enter the deletion mode.and the SENSOR 1 LED will light long. on(press the LEARN key to recycle select the existing SENSOR 1-4 for deletion), and hold down the LEARN key for 3 seconds to delete the pairing in the SENSOR 1 area.  
SENSOR 1 LED Blinking indicates that the SENSOR 1 is successfully deleted. SENSOR 2-4 can repeat SENSOR 1 operation. Press the RESET key or do not perform any operation for 30 seconds to exit the deletion mode.

## CAUTIONS

1. The surface material of the pressure pad is PVC. Please don't direct touch with human skin when using it. You can put the pressure pad under the bed sheet or thin cushion and test whether it can work normally.
2. Alarm main unit. The red LED indication when the pressure pad sensor battery is low, and the LED light dimms when the button battery is low. Please replace the battery in time to ensure normal use.
3. If the product is not used for a long time, please take out the battery to avoid battery leakage and damage to the device.
4. This product is an electronic safety auxiliary product, and users must confirm the necessary reliability according to the usage properties.
5. If you have any questions during the use of the product, please contact with local distributor.

610-6360X-000R

- 5 -

## Wireless off bed zoning pre-alarm system

MODE: 636 / 636S

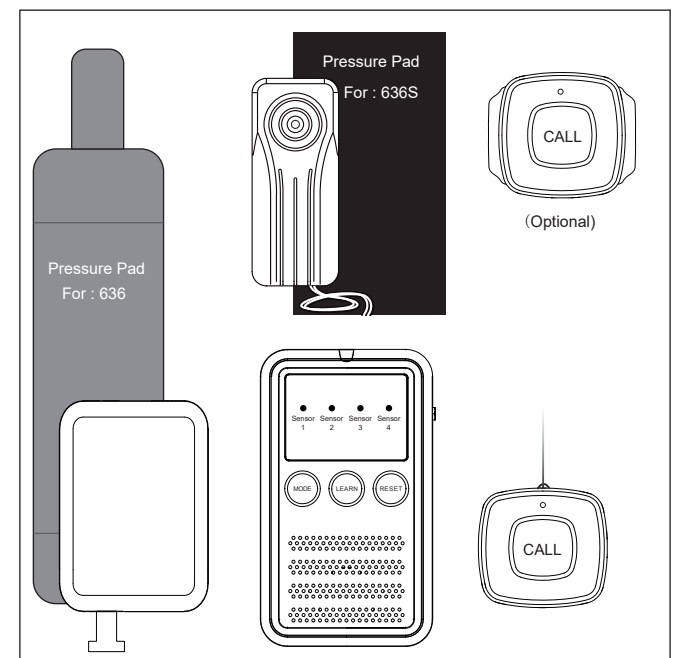

## USER'S MANUAL

**FCC WARNING**

This device complies with part 15 of the FCC Rules.

Operation is subject to the following two conditions: (1) this device may not cause harmful interference, and (2) this device must accept any interference received, including interference that may cause undesired operation.

Any changes or modifications not expressly approved by the party responsible for compliance

could void the user's authority to operate the equipment.

NOTE: This equipment has been tested and found to comply with the limits for a Class B digital device, pursuant to Part 15 of the FCC Rules. These limits are designed to provide reasonable protection against harmful interference in a residential installation. This equipment generates, uses and can radiate radio frequency energy and, if not installed and used in accordance with the instructions, may cause harmful interference to radio communications. However, there is no guarantee that interference will not occur in a particular installation.

If this equipment does cause harmful interference to radio or television reception,

which can be determined by turning the equipment off and on, the user is encouraged to try to correct the interference by one or more of the following measures:

-- Reorient or relocate the receiving antenna.

-- Increase the separation between the equipment and receiver.

-- Connect the equipment into an outlet on a circuit different from that to which the receiver is connected.

-- Consult the dealer or an experienced radio/TV technician for help. The device has been evaluated to meet general RF exposure requirements. The device can be used in portable exposure condition without restriction