

## SYSTEM COMPONENTS

The **B.A.S.I.S.™ V** System is an electronic access control system that can be programmed to meet your facilities access control needs. The system is designed to secure your facility by granting specific access rights to authorized people, based on a defined time schedule for each lock in the system. By tracking events at the locks, the system provides information to help you maintain the security of your facility.

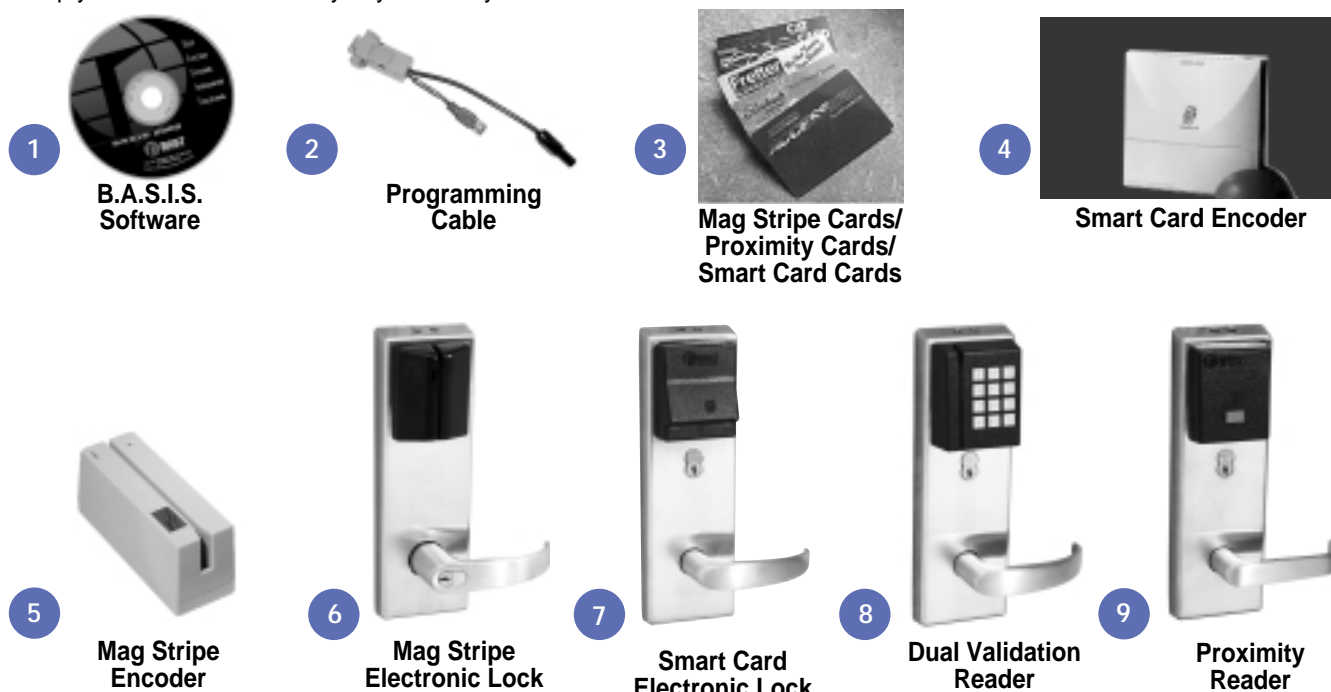

## SYSTEM COMPONENTS DESCRIPTION

- 1 **B.A.S.I.S. Software**— Software that lets you define programming settings and the user database for groups of locks, as well as individual locks. The software lets you view and print information about locks at any time.  
(To order, contact your local Best Access Systems office.)
- 2 **Programming Cable** — Programming cable allows you to connect to individual locks.  
(To order, contact your local Best Access Systems office.)
- 3 **Smart Card Cards** — A credit-card-size card with a smart card chip containing information. These cards can be encoded and sent to the user or encoded by the user at their facility. (To order, see page 10.)
- 3 **Mag Stripe Cards** — A credit-card-size card with a magnetic stripe containing information. These cards can be encoded and sent to the user or encoded by the user at their facility. (To order, see page 10.)
- 3 **Proximity Cards** — A credit-card-size card with a proximity chip containing information. These cards can be encoded and sent to the user or encoded by the user at their facility. (To order, see page 10.)
- 4 **Smart Card Encoder** — The device that “reads”, “writes” and “erases” information on the smart card. This also includes the software that controls the card encoder. Requires a PC B.A.S.I.S. software. (To order, see page 11.)
- 5 **Mag Stripe Card Encoder** — The device that “reads”, “writes” and “erases” information on the magnetic-stripe card. This also includes the software that controls the card encoder. Requires a PC & B.A.S.I.S. software. (To order, see page 11.)
- 6 **Mag Stripe Electronic Lock** — A battery-powered, self-contained swipe reader electronic lock that uses standard mag stripe cards. Controls access to door and can be programmed with B.A.S.I.S. software. (To order, see page 10.)
- 7 **Smart Card Electronic Lock** — A battery-powered, self-contained insertion reader electronic lock that uses smart cards. Controls access to door and can be programmed with B.A.S.I.S. software. (To order, see page 10.)
- 8 **Dual Validation Reader** — A battery-powered, self-contained dual validation reader electronic lock that combines standard mag stripe and keypad validation. Controls access to door and can be programmed with B.A.S.I.S. software.  
(To order, see page 10.)
- 9 **Proximity Reader** — A battery-powered, self-contained proximity card reader electronic lock that uses standard proximity cards. Controls access to door and can be programmed with B.A.S.I.S. software. (To order, see page 10.)
- 10 **PDA (palm top not shown)** — A PDA (Personal Digital Assistant) is a palm top device that connects to a PC to transport programming data from a B.A.S.I.S. system to the lockset or retrieve history data. The PDA can also provide diagnostic data from the lockset. Software for the palm device is included in the B.A.S.I.S. software.  
(Contact your local Best Access Systems office or visit our web site for a recommended BEST-supported device.)