

Panasonic

900MHz Cordless Phone

Operating Instructions

Model No. **KX-TC1466LAB**
KX-TC1466LCB
KX-TC1467LAB

Pulse-or-tone dialing capability



KX-TC1466LAB

**PLEASE READ BEFORE USE
AND SAVE.**

**Charge the battery for 15 hours
before initial use.**

Contents by Section

- 1 Getting Started
- 2 Making/Answering Calls
- 3 Speed Dialer
- 4 Special Features
- 5 Things You Should Know
- 6 Quick Guide

WARNING:

TO PREVENT FIRE OR SHOCK HAZARD, DO NOT EXPOSE THIS PRODUCT TO RAIN OR ANY TYPE OF MOISTURE.

If there is any trouble, disconnect the unit from the telephone line and connect a known working phone. If the known working phone operates properly, do not reconnect the unit to the telephone line until the trouble has been repaired. If the known working phone does not operate properly, consult your telephone company.

For your future reference

Serial No. _____ Date of purchase _____
(found on the bottom of the unit)

Name and address of dealer _____

Panasonic Communications Co., Ltd.

1-62, 4-chome, Minoshima, Hakata-ku, Fukuoka 812-8531, Japan

PQQX13565ZA F1102-0 ©

1 Getting Started

Section 1

1-A Accessories

- AC Adaptor one

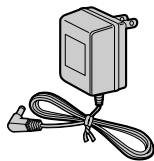

- Telephone Line Cord one



- Battery one

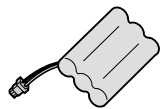

- Handset Cover one



1-B Location of Controls

Handset

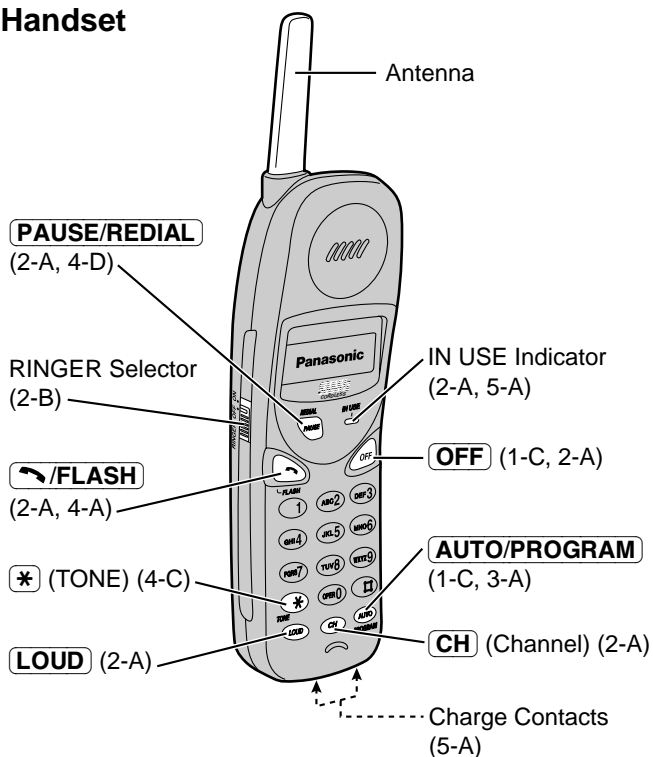

Base unit

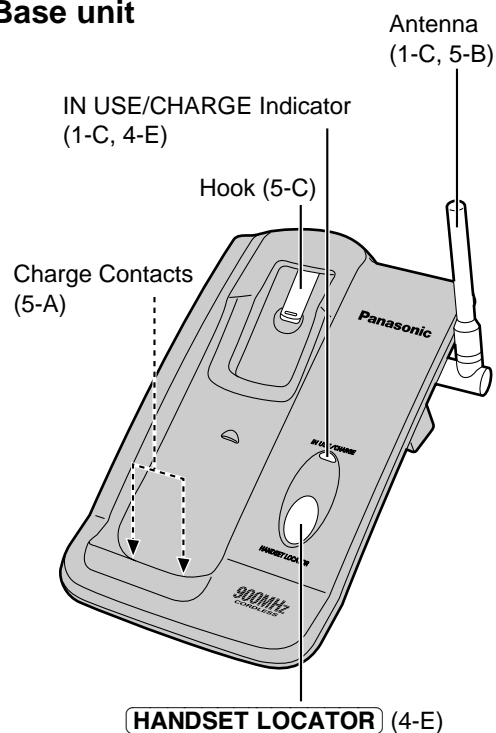

1-C Settings

1 Connect as shown.

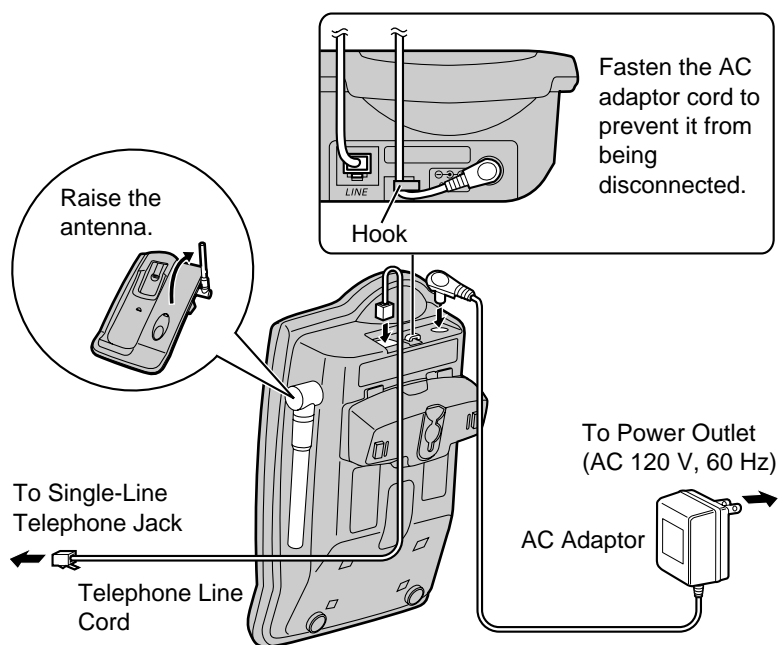

- Use only with Panasonic AC adaptor PQWATC1461M.
- The AC adaptor must remain connected at all times. (It is normal for the adaptor to feel warm during use.)
- To connect a standard telephone on the same line, see section 5-E.
- When more than one unit is used, the units may interfere with each other. To prevent or reduce interference, please keep ample space between the base units.

2 Install the battery in the handset and close the handset cover, locking it into place.

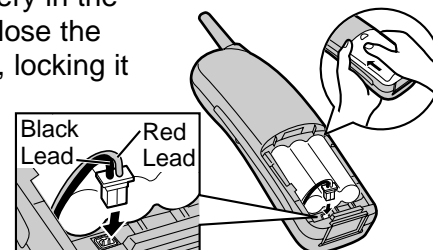

3 Charge the battery for 15 hours.

- See section 5-A for more details.
- The IN USE/CHARGE indicator lights and a beep sounds.

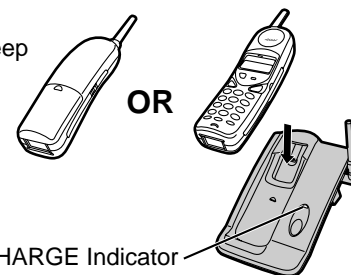

To select the dialing mode TONE (preset) or PULSE

You can program the dialing mode using the handset near the base unit. The IN USE indicator light must be off before programming.

Press **AUTO/PROGRAM** → ***** → **#** (PULSE) OR **AUTO/PROGRAM** → ***** (TONE)

- To cancel during programming, press **OFF**. Start again from the beginning.

2 Making/Answering Calls

Section 2

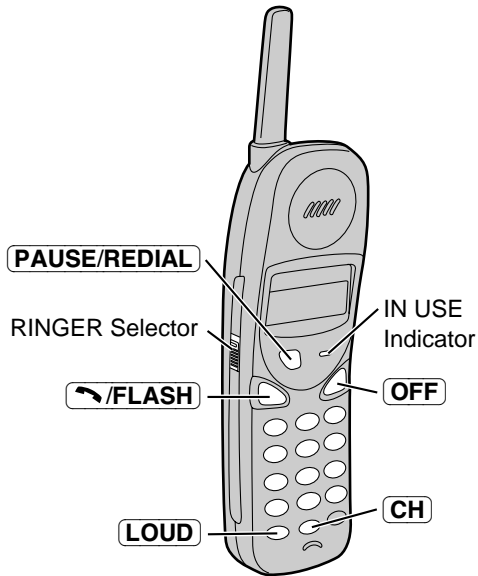

•For best operating performance, see section 5-B.

Lighted handset keypad (KX-TC1467LAB only)

The handset dialing buttons will light when you press a button, lift the handset off the base unit, or when a call is received. The lights will stay on for a while after pressing a button, lifting the handset or answering a call.

2-A Making Calls

- 1 Press **/FLASH**.
 - The IN USE indicator lights.
 - If an alarm tone sounds, see section 5-F.
 - 2 Dial a phone number.
 - 3 To hang up, press **OFF** or place the handset on the base unit.
 - The indicator light goes out.
- If additional dialing is necessary after using speed dialing functions such as AUTO (3-B) or REDIAL, wait until speed dialing is finished to continue further dialing. Otherwise, the unit may not dial properly.

To redial the last number dialed

Press **/FLASH** → **PAUSE/REDIAL**.

To adjust the receiver volume

4 levels (HIGH, MEDIUM, NORMAL, LOW) are available.

Press **LOUD** while talking.

- Each time you press **LOUD**, the volume level will change.

If noise interferes with the conversation

Press **CH** to select a clearer channel or move closer to the base unit.

2-B Answering Calls

Lift the handset off the base unit and press **/FLASH**.

- You can also answer a call by pressing any button except **OFF** (Any Key Talk).

Selecting the ringer volume

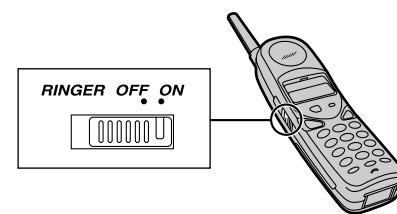

Set the RINGER selector to ON or OFF.

- When set to OFF, the unit will not ring.

3 Speed Dialer

Section 3

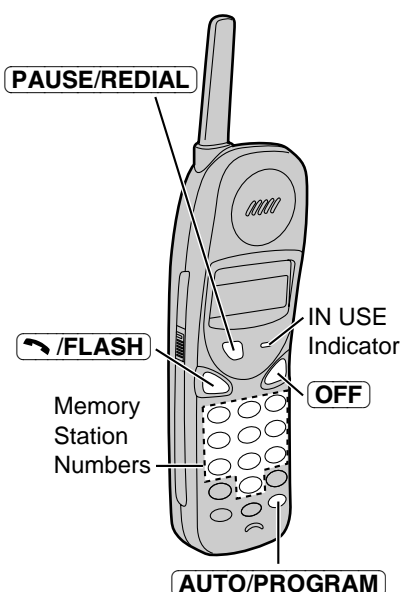

3-A Storing Phone Numbers in Memory

You can store up to 10 phone numbers in the handset. The dialing buttons (0 to 9) function as memory stations. **The IN USE indicator light must be off before programming.**

- 1 Press **AUTO/PROGRAM**.
 - The IN USE indicator flashes.
- 2 Press a memory station number (0 to 9).
- 3 Enter a phone number up to 16 digits.
 - When you store the last number dialed, press **PAUSE/REDIAL** instead of entering a phone number.
- 4 Press **AUTO/PROGRAM**.
 - A beep sounds.
 - To store other numbers, repeat steps 1 through 4.

- If a pause is required for dialing, press **PAUSE/REDIAL** where needed. Pressing **PAUSE/REDIAL** counts as one digit (4-D).

If you misdial

Press **OFF** to end storing. → Start again from step 1.

To erase a stored number

Press **AUTO/PROGRAM** → the memory station number (0 to 9) for the phone number to be erased → **AUTO/PROGRAM**.

- A beep sounds.

3-B Dialing a Stored Number

Press **/FLASH** → **AUTO/PROGRAM** → the memory station number (0 to 9).

4 Special Features



Special

4-A For Call Waiting Service Users

- Press **[FLASH]** if you hear a call-waiting tone while talking.
- The first call is put on hold and you can answer the second call.
 - To return to the first caller, press **[FLASH]** again.
 - The call waiting service cannot be used when a parallel connected telephone is in use.
 - If this function does not operate properly, consult your telephone company for details.

4-B Automatic Security Code Setting

Each time you place the handset on the base unit, the unit automatically selects one of 65,000 security codes. These codes help prevent the unauthorized use of your telephone line by another cordless telephone user.

4-C Temporary Tone Dialing (For Rotary or Pulse Service Users)

- Press **[*]** (TONE) before entering access numbers which require tone dialing.
- The dialing mode changes to tone. You can enter numbers to access an answering service, electronic banking service, etc. When you hang up, the mode will return to pulse.

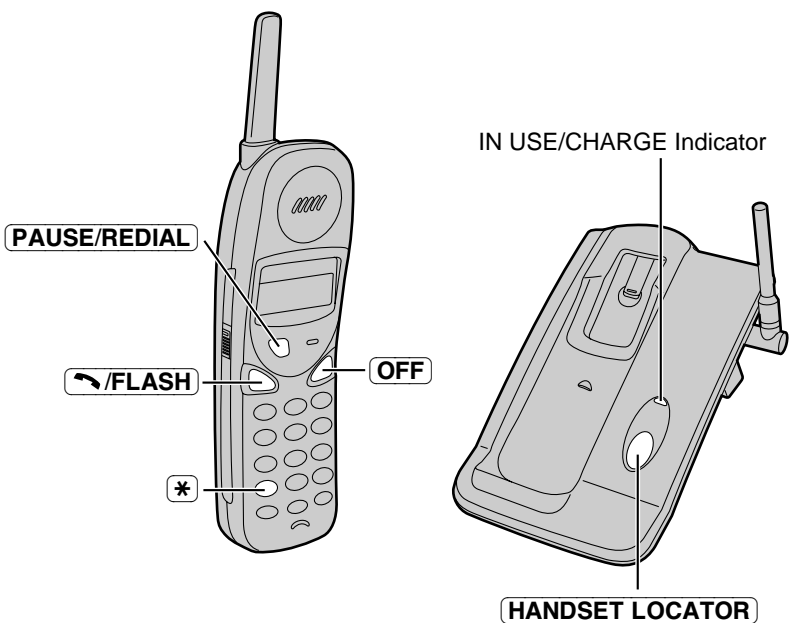

5 Things You Should Know



Things

5-A Battery

Recharge

If the unit beeps or the IN USE indicator flashes slowly when you press **[FLASH]** or while talking, the call will be disconnected within about 3 minutes.

If the unit produces a continuous beep, it will not be able to operate. Place the handset on the base unit to recharge the battery for 15 hours.

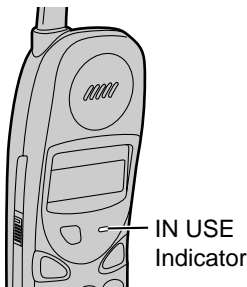

Battery information

After your Panasonic battery is fully charged:

| Operation | Operating time |
|----------------------------|---------------------|
| While in use (TALK) | Up to about 5 hours |
| While not in use (Standby) | Up to about 5 days |

- The battery operating time may vary depending on usage conditions and ambient temperature.
- Clean the handset and the base unit charge contacts with a soft, dry cloth once a month. Clean more often if the unit is subject to grease, dust or high humidity.** Otherwise the battery may not be charged properly.
- If the battery is fully charged, you do not have to place the handset on the base unit until the IN USE indicator flashes. This will maximize the battery life.
- The battery cannot be overcharged.

4-D How to Use the PAUSE Button (For PBX Line/Long Distance Calls)

We recommend you press **PAUSE/REDIAL** if a pause is required to dial with a PBX or to make a long distance call.

Ex: Line access number **9** (PBX)

9 ➔ **PAUSE/REDIAL** ➔ Phone number

- Pressing **PAUSE/REDIAL** once creates a 3 second pause. This prevents misdialing when you redial or dial a stored number.
- Pressing **PAUSE/REDIAL** more than once increases the length of the pause between numbers.

4-E Handset Locator

You can locate the handset or page the handset user with beep tones from the base unit.

- 1 Press **HANDSET LOCATOR** on the base unit.
 - The IN USE/CHARGE indicator flashes and the handset beeps for 2 minutes.
- 2 To stop paging, press **HANDSET LOCATOR** again or press **OFF** on the handset.

Things You Should Know

➔

5-B Base Unit Location

Calls are transmitted between the base unit and the handset using wireless radio waves. **For maximum distance and noise-free operation**, the recommended base unit location is:

- Away from electrical appliances such as a TV or personal computer.
- In a HIGH and CENTRAL location with no obstructions such as walls.

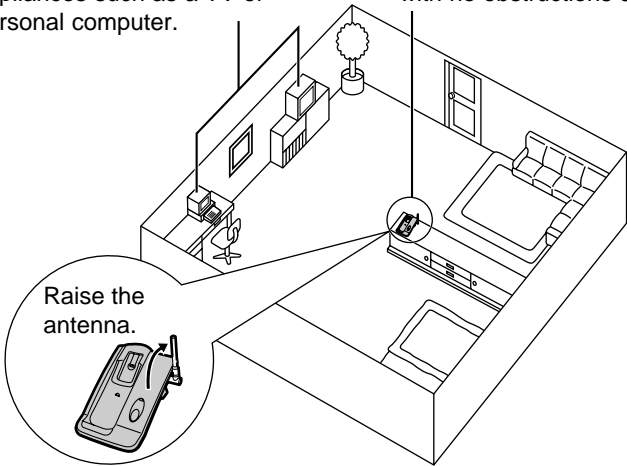

5 Things You Should Know



Things

5-C Wall Mounting

This unit can be mounted on a wall.

- 1 Push the lower side of the hook (①) and pull down the hook until it locks (②), **so the tab holds the handset.**

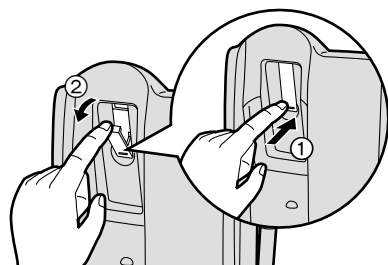

- 2 Remove the wall mounting adaptor.

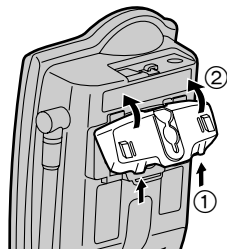

- 3 Connect the AC adaptor. Tuck the telephone line cord inside the wall mounting adaptor, then push it in the direction of the arrow (① and ②).
•The word "UP WALL" should face upward.

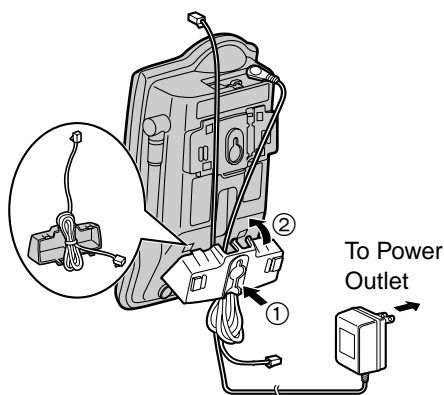

- 4 Install screws using the wall template below. Connect the telephone line cord. Mount the unit, then slide down.
•Raise the antenna.

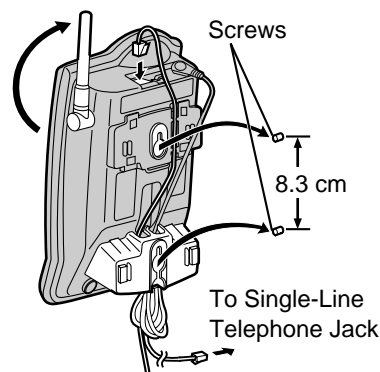

Wall Template

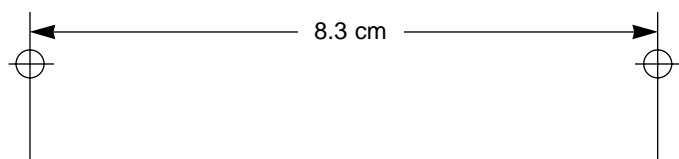

- 5 **To charge the battery:** Fit the handset hole in the tab (①) and fix the charge contacts (②).

- Make sure to place the handset with the keypad facing down.
- The IN USE/CHARGE indicator lights and a beep sounds.

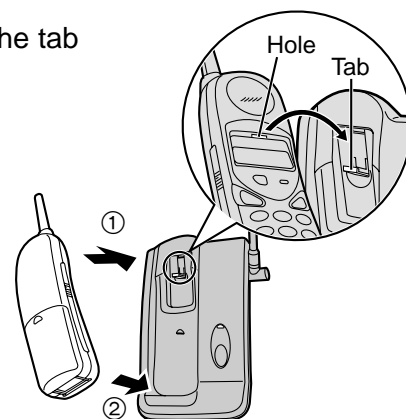

5-D Battery Replacement

If the IN USE indicator flashes after a few telephone calls even if the battery was fully charged, replace the battery with a new Panasonic PQWBTC1461 (P-P504) battery.

- 1 Press the notch on the handset cover firmly (①) and slide it as indicated by the arrow (②).

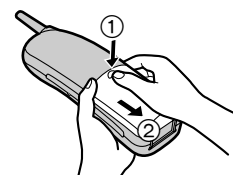

- 2 Remove the old battery. Then install the new one.

- Insert the battery plug into the connector as shown in the picture.
- Be sure wires are free from being pressed by the battery body or handset cover.

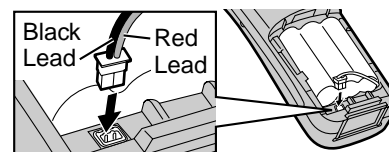

- 3 Close the cover. Make sure you charge the new battery for about 15 hours.

5-E Adding Another Phone

This unit will not function during a power failure. To connect a standard telephone on the same line, use a T-adaptor.

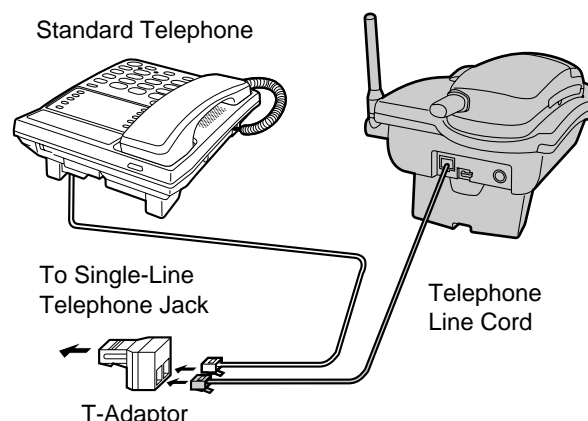

5-F Before Requesting Help

| Problem | Cause and Remedy |
|---|--|
| The unit does not work. | <ul style="list-style-type: none">●Check the settings (1-C).●Charge the battery fully (5-A).●Clean the charge contacts and charge again (5-A).●Install the battery properly (1-C, 5-D).●Place the handset on the base unit and unplug the AC adaptor to reset. Plug in, and try again. |
| An alarm tone sounds. | <ul style="list-style-type: none">●You are too far from the base unit. Move closer and try again.●Place the handset on the base unit and try again.●Plug in the AC adaptor.●Raise the base unit antenna. |
| Static, sound cuts in/out, fades. Interference from other electrical units. | <ul style="list-style-type: none">●Locate the handset and the base unit away from other electrical appliances (5-B).●Move closer to the base unit.●Raise the base unit antenna.●Press [CH] to select a clearer channel. |
| The handset does not ring. | <ul style="list-style-type: none">●The ringer volume is set to OFF. Set to ON (2-B).●If a power failure occurs, the handset loses communication with the base. When power returns, place the handset on the base unit once then try again. |
| While storing a phone number, the handset starts to ring. | <ul style="list-style-type: none">●To answer the call, press [📞/FLASH] . The program will be canceled. Store the number again. |

| Problem | Cause and Remedy |
|--|---|
| You cannot store a phone number in memory. | <ul style="list-style-type: none">●You cannot store a number while the unit is in the talk mode.●Do not pause for over 20 seconds while storing. |
| You cannot redial by pressing [PAUSE/REDIAL] . | <ul style="list-style-type: none">●If the last number dialed was more than 16 digits long, the number will not be redialed correctly. |
| [HANDSET LOCATOR] does not function. | <ul style="list-style-type: none">●The handset is too far from the base unit or is engaged in an outside call. |
| The IN USE indicator flashes slowly or the handset beeps while it is in use. | <ul style="list-style-type: none">●Charge the battery fully (5-A). |
| While talking, the call is disconnected. | <ul style="list-style-type: none">●The battery needs to be recharged. Charge the battery fully (5-A). |
| The handset produces a continuous beep, then it cannot be operated. | <ul style="list-style-type: none">●The battery needs to be recharged. Charge the battery fully (5-A). |
| You charged the battery fully, but the IN USE indicator flashes slowly. | <ul style="list-style-type: none">●Clean the charge contacts and charge again (5-A).●Install a new battery (5-D). |
| The IN USE/CHARGE indicator light does not go out while charging. | <ul style="list-style-type: none">●This is normal. |

5-G Safety Instructions

Take special care to follow the safety suggestions listed below.

Safety

- 1) The unit should be connected to a power supply only of the type described in the operating instructions or as marked on the unit.
- 2) When left unused for a long period of time, the base unit should be unplugged from the household AC outlet.

Installations

Environment

- 1) Do not use this unit near water—for example, near a bathtub, washbowl, sink, etc. Damp basements should also be avoided.
- 2) The unit should be kept away from heat sources such as radiators, kitchen range, etc. It also should not be placed in rooms where the temperature is less than 5°C or greater than 40°C.
- 3) The AC adaptor is used as the main disconnect device, ensure that the AC outlet is located/installed near the unit and is easily accessible.

Placement

- 1) Do not place heavy objects on top of this unit.
- 2) Care should be taken so that objects do not fall onto, and liquids are not spilled into, the unit. Do not subject this unit to excessive smoke, dust, mechanical vibration or shock.
- 3) Place the unit on a flat surface.

For best performance

- 1) If noise prevents the conversation from being understood at the handset, approach the base unit to lessen the noise.
- 2) The handset should be used at the HIGH volume setting when the reception tone is difficult to hear.

- 3) The handset should be fully recharged on the base unit when the IN USE indicator flashes.
- 4) The handset antenna should not be touched during use because of its high sensitivity.
- 5) The maximum calling distance may be shortened when the unit is used in the following places: Near obstacles such as hills, tunnels, undergrounds, near metal objects such as wire fences, etc.

5-H Specifications

| | |
|--------------------------|--|
| ■ Base unit | |
| Power Supply: | AC Adaptor (120 V AC, 60 Hz) |
| Power Consumption: | Standby: Approx. 3.1 W Maximum: Approx. 4 W |
| Frequency: | 902.10 MHz–904.05 MHz |
| Dimensions (H × W × D): | Approx. 89 mm × 127 mm × 180 mm |
| Mass (Weight): | Approx. 260 g |
| ■ Handset | |
| Power Supply: | Ni-Cd battery (3.6 V, 600 mAh) |
| Frequency: | 925.90 MHz–927.85 MHz |
| Dimensions (H × W × D): | Approx. 236 mm × 55 mm × 44 mm |
| Mass (Weight): | Approx. 220 g |
| Security Codes: | 65,000 |
| ■ Dialing Mode: | Tone (DTMF)/Pulse |
| ■ Operating Environment: | 5°C–40°C |

Specifications are subject to change without notice.

6 Quick Guide

Section 6

6-A Preparation

1 Connect as shown.

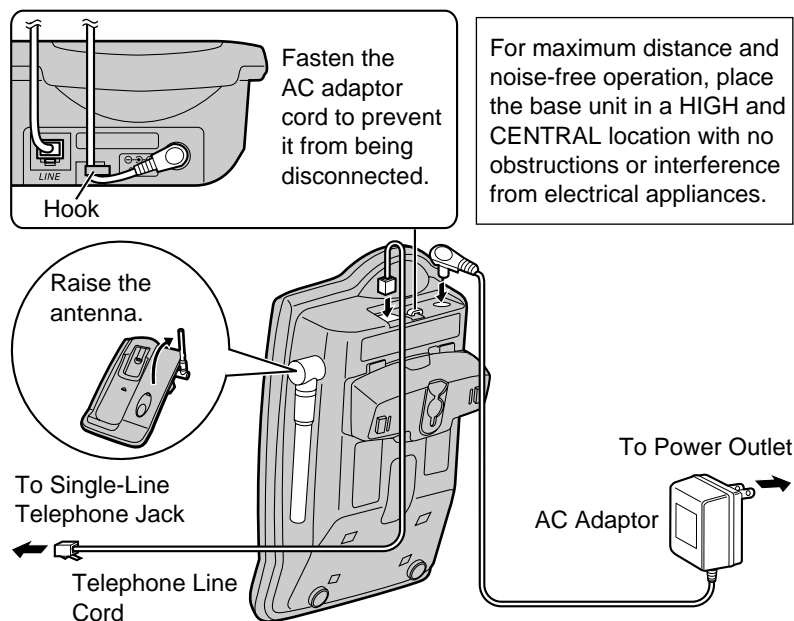

- The AC adaptor must remain connected at all times.

2 Install the battery in the handset and close the handset cover, locking it into place.

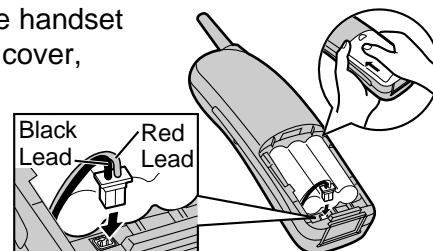

3 Charge the battery for about 15 hours.

- The IN USE/CHARGE indicator lights and a beep sounds.

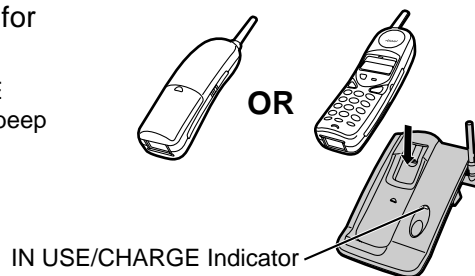

To select the dialing mode TONE (preset) or PULSE

You can program the dialing mode using the handset near the base unit. The IN USE indicator light must be off before programming.

Press **AUTO/PROGRAM** → ***** → **#** (PULSE) OR ***** (TONE) → **AUTO/PROGRAM**.

6-B Operation



- When the IN USE indicator flashes or the unit beeps while it is in use, charge the battery.

Making Calls

Press **FLASH**. → Dial a telephone number.

- To hang up, press **OFF** or place the handset on the base unit.
- If noise interferes with your conversation, press **CH** to select a clearer channel or move closer to the base unit.

Answering Calls

Lift the handset off the base unit and press **FLASH** or any button except **OFF**.

Speed Dialer

You can store up to 10 phone numbers in the handset. The dialing buttons (**0** to **9**) function as memory stations. The IN USE indicator light must be off before programming.

To store phone numbers in memory

Press **AUTO/PROGRAM** → Station Number (**0** to **9**) →
→ Phone number (up to 16 digits) → **AUTO/PROGRAM**.

To dial a stored number

Press **FLASH** → **AUTO/PROGRAM** → Station Number (**0** to **9**).

Handset Locator

Press **HANDSET LOCATOR** on the base unit.

- The handset beeps for 2 minutes.
- To stop paging, press **HANDSET LOCATOR** again or press **OFF** on the handset.

Important Safety Instructions

When using this unit, basic safety precautions should always be followed to reduce the risk of fire, electric shock, or personal injury.

1. Read and understand all instructions.
2. Follow all warnings and instructions marked on this unit.
3. Unplug this unit from AC outlets before cleaning. Do not use liquid or aerosol cleaners. Use a damp cloth for cleaning.
4. Do not use this unit near water, for example, near a bathtub, washbowl, kitchen sink, or the like.
5. Place this unit securely on a stable surface. Serious damage and/or injury may result if the unit falls.
6. Do not cover slots and openings on the unit. They are provided for ventilation and protection against overheating. Never place the unit near radiators, or in a place where proper ventilation is not provided.
7. Use only the power source marked on the unit. If you are not sure of the type of power supplied to your home, consult your dealer or local power company.
8. Do not place objects on the power cord. Install the unit where no one can step or trip on the cord.
9. Do not overload wall outlets and extension cords. This can result in the risk of fire or electric shock.
10. Never push any objects through slots in this unit. This may result in the risk of fire or electric shock. Never spill any liquid on the unit.
11. To reduce the risk of electric shock, do not disassemble this unit. Take the unit to an authorized servicer when service is required. Opening or removing covers may expose you to dangerous voltages or other risks. Incorrect reassembly can cause electric shock when the unit is subsequently used.
12. Unplug this unit from the wall outlet and refer servicing to an authorized servicer when the following conditions occur:
 - A. When the power supply cord or plug is damaged or frayed.
 - B. If liquid has been spilled into the unit.
 - C. If the unit has been exposed to rain or water.
 - D. If the unit does not work normally by following the operating instructions. Adjust only controls covered by the operating instructions. Improper adjustment may require extensive work by an authorized servicer.
 - E. If the unit has been dropped or physically damaged.
 - F. If the unit exhibits a distinct change in performance.
13. During thunderstorms, avoid using telephones except cordless types. There may be a remote risk of an electric shock from lightning.
14. Do not use this unit to report a gas leak, when in the vicinity of the leak.

SAVE THESE INSTRUCTIONS

CAUTION:

To reduce the risk of fire or injury to persons, read and follow these instructions.

1. Use only the battery(ies) specified.
2. Do not dispose of the battery(ies) in a fire. They may explode. Check with local waste management codes for special disposal instructions.
3. Do not open or mutilate the battery(ies). Released electrolyte is corrosive and may cause burns or injury to the eyes or skin. The electrolyte may be toxic if swallowed.
4. Exercise care in handling batteries in order not to short the battery to conductive materials such as rings, bracelets, and keys. The battery and/or conductor may overheat and cause burns.
5. Charge the battery(ies) provided with or identified for use with this product only in accordance with the instructions and limitations specified in this manual.

WARNING:

TO PREVENT FIRE OR SHOCK HAZARD, DO NOT EXPOSE THIS PRODUCT TO RAIN OR ANY TYPE OF MOISTURE.

- The AC adaptor is used as the main disconnect device, ensure that the AC outlet is located/installed near the unit and is easily accessible.

FCC and Other Information

This equipment complies with Part 68 of the FCC rules and the requirements adopted by the ACTA. On the bottom of this equipment is a label that contains, among other information, a product identifier in the format US:AAA-----.

If requested, this number must be provided to the telephone company.

Registration No. (found on the bottom of the unit)
Ringer Equivalence No. (REN) 0.1B

A plug and jack used to connect this equipment to the premises wiring and telephone network must comply with the applicable FCC Part 68 rules and requirements adopted by the ACTA. A compliant telephone cord and modular plug is provided with this product. It is designed to be connected to a compatible modular jack that is also compliant.

The REN is used to determine the number of devices that may be connected to a telephone line. Excessive RENs on a telephone line may result in the devices not ringing in response to an incoming call. In most but not all areas, the sum of RENs should not exceed five (5.0). To be certain of the number of devices that may be connected to a line, as determined by the total RENs, contact the local telephone company. For products approved after July 23, 2001, the REN for this product is part of the product identifier that has the format US:AAAEQ##TXXXX. The digits represented by ## are the REN without a decimal point (e.g., 03 is a REN of 0.3).

If this equipment causes harm to the telephone network, the telephone company will notify you in advance that temporary discontinuance of service may be required. But if advance notice isn't practical, the telephone company will notify the customer as soon as possible. Also, you will be advised of your right to file a complaint with the FCC if you believe it is necessary.

The telephone company may make changes in its facilities, equipment, operations or procedures that could affect the operation of the equipment. If this happens the telephone company will provide advance notice in order for you to make necessary modifications to maintain uninterrupted service.

If trouble is experienced with this equipment, for repair or warranty information, please contact a Factory Servicenter or other Authorized Servicer. If the equipment is causing harm to the telephone network, the telephone company may request that you disconnect the equipment until the problem is resolved.

Connection to party line service is subject to state tariffs. Contact the state public utility commission, public service commission or corporation commission for information.

If your home has specially wired alarm equipment connected to the telephone line, ensure the installation of this equipment does not disable your alarm equipment. If you have questions about what will disable alarm equipment, consult your telephone company or a qualified installer.

WHEN PROGRAMMING EMERGENCY NUMBERS AND(OR) MAKING TEST CALLS TO EMERGENCY NUMBERS:

- 1) Remain on the line and briefly explain to the dispatcher the reason for the call.
- 2) Perform such activities in the off-peak hours, such as early morning or late evenings.

This device complies with Part 15 of the FCC Rules. Operation is subject to the following two conditions: (1) This device may not cause harmful interference, and (2) this device must accept any interference received, including interference that may cause undesired operation.

Privacy of communications may not be ensured when using this phone.

CAUTION:

Any changes or modifications not expressly approved by the party responsible for compliance could void the user's authority to operate this device.

Note:

This equipment has been tested and found to comply with the limits for a Class B digital device, pursuant to Part 15 of the FCC Rules. These limits are designed to provide reasonable protection against harmful interference in a residential installation. This equipment generates, uses, and can radiate radio frequency energy and, if not installed and used in accordance with the instructions, may cause harmful interference to radio communications. However, there is no guarantee that interference will not occur in a particular installation. If this equipment does cause harmful interference to radio or television reception, which can be determined by turning the equipment off and on, the user is encouraged to try to correct the interference by one or more of the following measures:

- Reorient or relocate the receiving antenna.
- Increase the separation between the equipment and receiver.
- Connect the equipment into an outlet on a circuit different from that to which the receiver is connected.
- Consult the dealer or an experienced radio/TV technician for help.

The USOC jack is RJ11C and the jack is Part 68 compliance.

This equipment is hearing aid compatible as defined by the FCC in 47 CFR Section 68.316.

When you hold the phone to your ear, noise might be heard in your Hearing Aid. Some Hearing Aids are not adequately shielded from external RF (radio frequency) energy. If noise occurs, use an optional headset accessory or the speakerphone option (if applicable) when using this phone. Consult with your audiologist or Hearing Aid manufacturer about the availability of Hearing Aids which provide adequate shielding to RF energy commonly emitted by digital devices.

- **Environment**—do not place the unit in a room where the temperature is less than 5°C (41°F) or greater than 40°C (104°F). Allow 10 cm (4") clearance around the unit for proper ventilation. Avoid excessive smoke, dust, mechanical vibration, shock, or direct sunlight.
- **Routine care**—wipe the unit with a soft cloth. Do not use benzine, thinner, or any abrasive powder. When you leave the unit unused for a long period of time, unplug the AC adaptor from the outlet.
- **If there is any trouble**—disconnect the unit from the telephone line and connect a known working phone. If the known working phone operates properly, have your unit repaired by one of the authorized Panasonic Factory Service Centers. If the known working phone does not operate properly, consult your telephone company.

**PANASONIC CONSUMER
ELECTRONICS COMPANY, DIVISION
OF MATSUSHITA ELECTRIC
CORPORATION OF AMERICA**
One Panasonic Way
Secaucus, New Jersey 07094

**PANASONIC SALES COMPANY,
DIVISION OF MATSUSHITA
ELECTRIC OF PUERTO RICO, INC.,**
Ave. 65 de Infanteria, Km. 9.5
San Gabriel Industrial Park
Carolina, Puerto Rico 00985

Panasonic Telephone Limited Warranty

Limited Warranty Coverage

If your telephone (identified in your Operating Instructions) does not work properly because of a defect in materials or workmanship, Panasonic Consumer Electronics Company or Panasonic Sales Company (collectively referred to as "the warrantor") will, for the length of the period indicated on the chart below, which starts with the date of original purchase ("warranty period"), at its option either (a) repair your product with new or refurbished parts, or (b) replace it with a new or a refurbished product. The decision to repair or replace will be made by the warrantor.

Parts

One (1) Year

Labor

One (1) Year

During the "Labor" warranty period there will be no charge for labor. During the "Parts" warranty period, there will be no charge for parts. You must mail-in your product during the warranty period. This Limited Warranty excludes both parts and labor for batteries, antennas, and cosmetic parts (cabinet). This warranty only applies to products purchased and serviced in the United States or Puerto Rico. This warranty is extended only to the original purchaser of a new product which was not sold "as is". A purchase receipt or other proof of the original purchase date is required for warranty service.

To obtain service in the USA please contact:

Panasonic Services Company, Panasonic Plus Department
20421 84th Avenue South
Kent, WA 98032
Tel: 1-800-833-9626 Fax: 1-800-237-9080

For assistance in Puerto Rico call Panasonic Sales Company (787)-750-4300 or fax (787)-768-2910.

When shipping the unit carefully pack and send it prepaid, adequately insured and preferably in the original carton. Include a letter detailing the complaint and provide a day time phone number where you can be reached.

Limited Warranty Limits And Exclusions

This warranty ONLY COVERS failures due to defects in materials or workmanship, and DOES NOT COVER normal wear and tear or cosmetic damage. The warranty ALSO DOES NOT COVER damages which occurred in shipment, or failures which are caused by products not supplied by the warrantor, or failures which result from accidents, misuse, abuse, neglect, mishandling, misapplication, alteration, faulty installation, set-up adjustments, misadjustment of consumer controls, improper maintenance, power line surge, lightning damage, modification, introduction of sand, humidity or liquids, commercial use such as hotel, office, restaurant, or other business or rental use of the product, or service by anyone other than a Factory Servicenter or other Authorized Servicer, or damage that is attributable to acts of God.

For product service

- Call 1-800-211-PANA(7262) or 1-800-833-9626 for the location of an authorized servicenter.
- Panasonic's e-mail address for customer inquiries:
consumerproducts@panasonic.com
for customers in the USA or Puerto Rico ONLY

When you ship the product

- Carefully pack your unit, preferably in the original carton.
- Attach a letter, detailing the symptom, to the outside of the carton.

Symptom

- Send the unit to an authorized servicenter, prepaid and adequately insured.
- Do not send your unit to the Panasonic Consumer Electronics Company listed on the back cover or to executive or regional sales offices. These locations do not repair consumer products.

- This cordless telephone is designed for use in the United States of America. Sale or use of this product in other countries may violate local laws.
- Ce téléphone sans fil est conçu pour être utilisé aux États-Unis d'Amérique. La vente ou l'emploi de cet appareil dans certains autres pays peut constituer une infraction à la législation locale.
- Este teléfono sin cordón fue elaborado para uso en los Estados Unidos de América. La venta o el empleo de este producto en ciertos países puede constituir violación de la legislación local.
- このコードレス電話機は、日本国外での使用を目的として設計されており、日本国内での使用は法律違反となります。従って、当社では日本国内においては原則として修理などのサービスは致しかねます。

**If you need assistance with the set-up or operation,
please call 1-800-211-PANA(7262)**

**Panasonic Consumer Electronics Company,
Division of Matsushita Electric Corporation of America**
One Panasonic Way, Secaucus, New Jersey 07094

**Panasonic Sales Company,
Division of Matsushita Electric of Puerto Rico, Inc.**
Ave. 65 de Infantería, Km. 9.5, San Gabriel Industrial Park
Carolina, Puerto Rico 00985