

## Annex C Photo documentation

Appendix to Test Report No.: 1-4869/22-02-03

### Testing Laboratory

**CTC advanced GmbH**

Untertürkheimer Straße 6 – 10

66117 Saarbrücken/Germany

Phone: + 49 681 5 98 - 0

Fax: + 49 681 5 98 - 9075

Internet: <http://www.ctcadvanced.com>

e-mail: [mail@ctcadvanced.com](mailto:mail@ctcadvanced.com)

**Accredited Test Laboratory:**

The testing laboratory (area of testing) is accredited according to DIN EN ISO/IEC 17025 (2005) by the Deutsche Akkreditierungsstelle GmbH (DAkkS)

The accreditation is valid for the scope of testing procedures as stated in the accreditation certificate with the registration number: D-PL-12076-01-01

Photo 1: Measurement System DASY

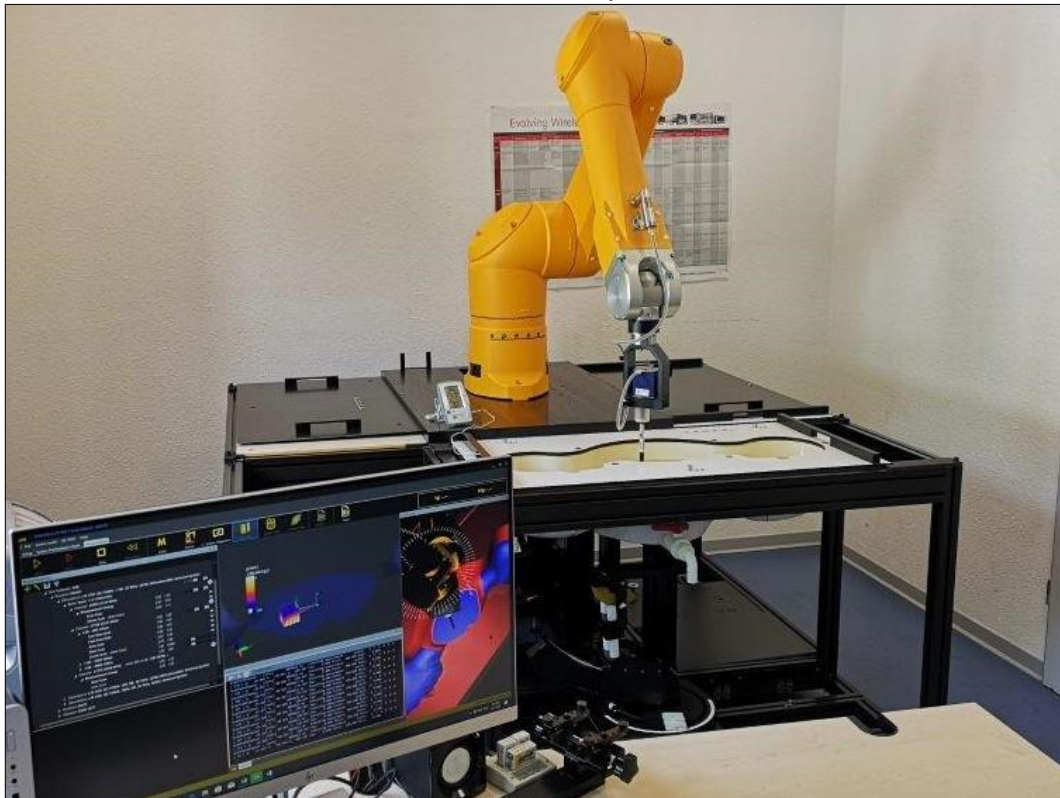

Photo 2: DUT - front view

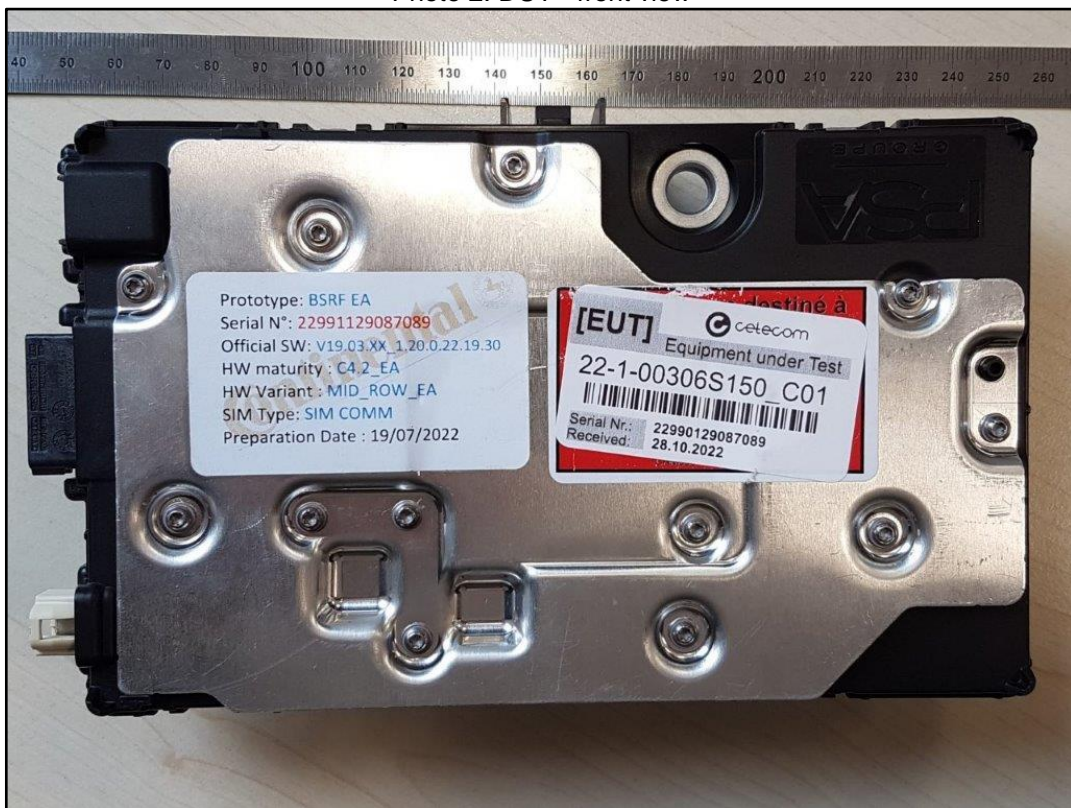



Photo 3: DUT - back view

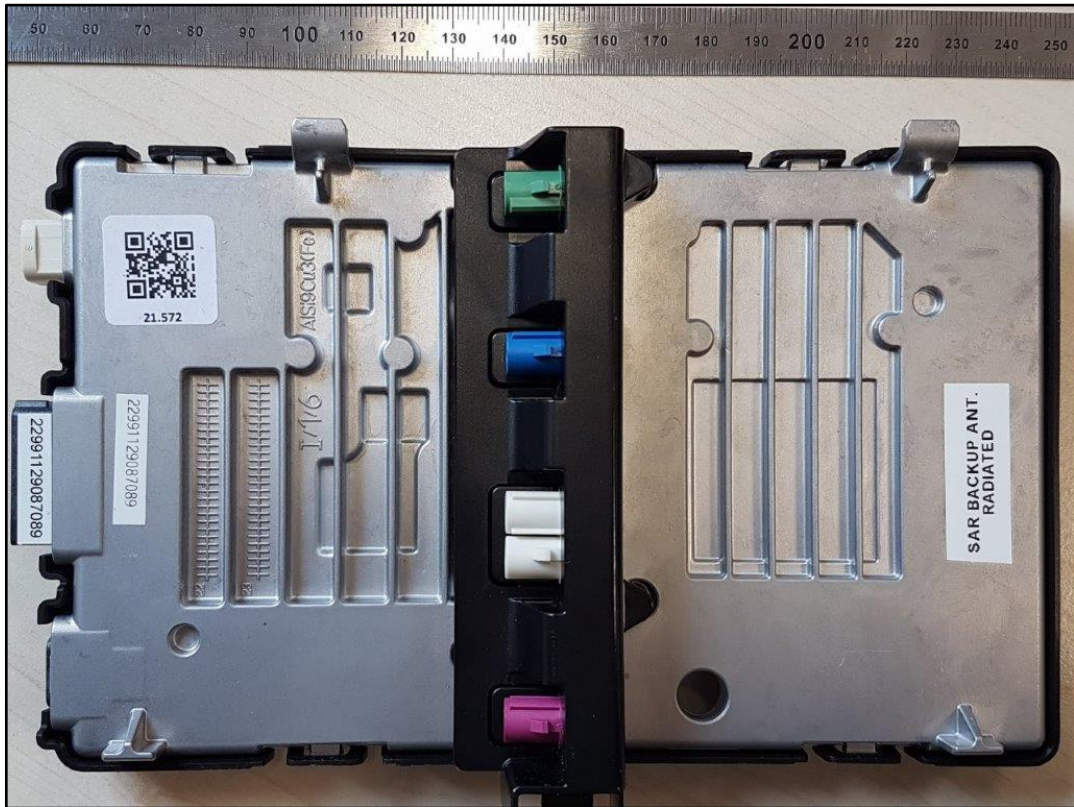

Photo 4: Test position front side with 15 mm distance

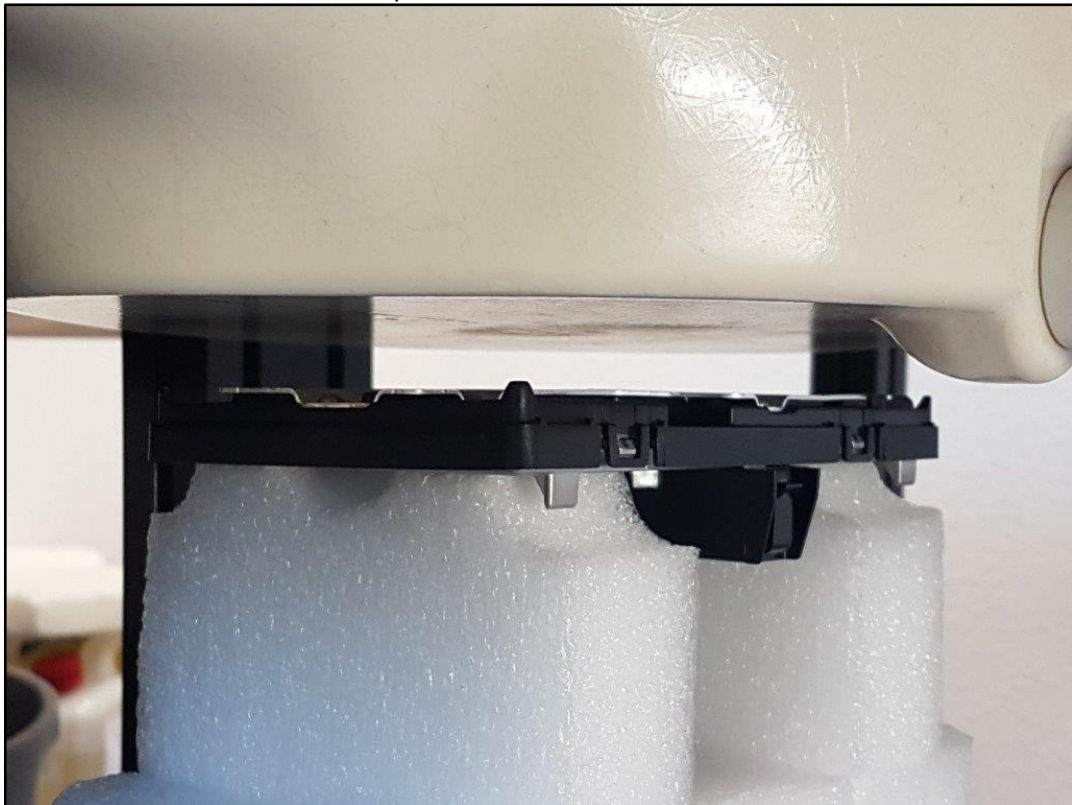

Photo 5: Test position left side with 15 mm distance



Photo 6: Test position right side with 15 mm distance





Photo 7: Test position top side with 15 mm distance

