

SPA-1 Power Amplifier

The SPA-1 is a linear amplifier that can be connected to the FTX-1 field.

The FTX-1 operates on the 1.8MHz through 430MHz amateur bands at a power output level of 100 Watts (144MHz and 430MHz:50W). The SPA-1 includes a built-in antenna tuner with 100 memories for tuning data.

Please refer to the FTX-1 Operation Manual for operating instructions.

Installation to the FTX-1

1. Connect the SPA-1 cables to the "ANT", "EXT SPKR", "TUNER/LINEAR", and "13.8 V" jacks on the FTX-1.

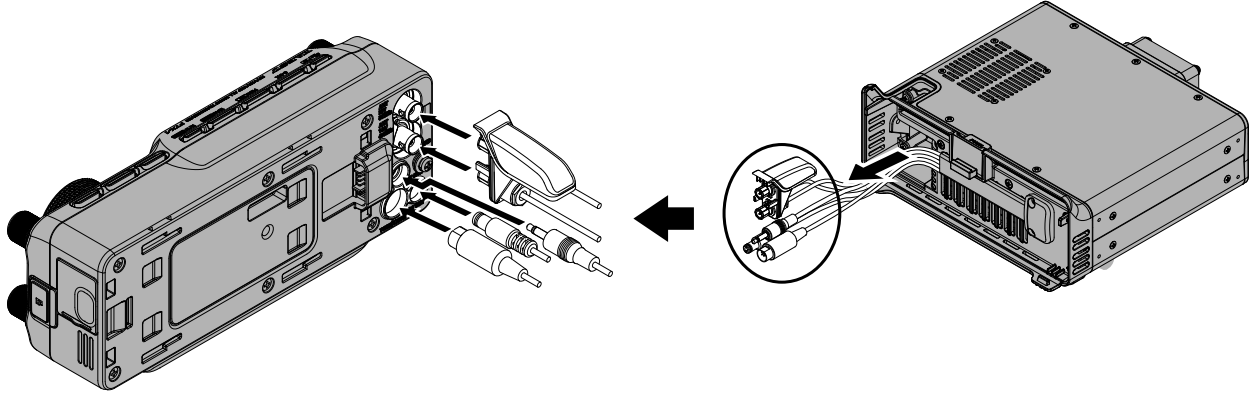

2. Install the FTX-1 to the SPA-1; you will hear a "click" when the FTX-1 locks into place.

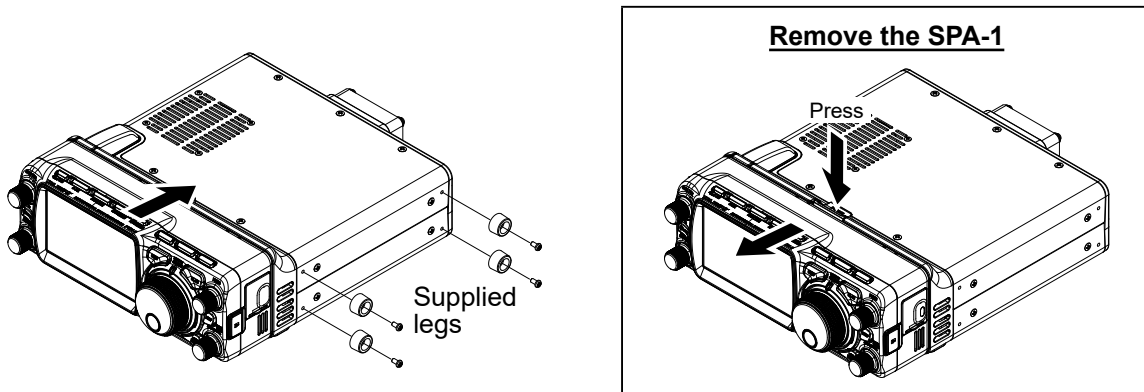

Antenna and Power Cable Connections

Carefully follow the illustration regarding the proper connection of antennas, coaxial cables and DC power cable. Use the DC power cable supplied with the SPA-1 to make the power connections to the power supply.

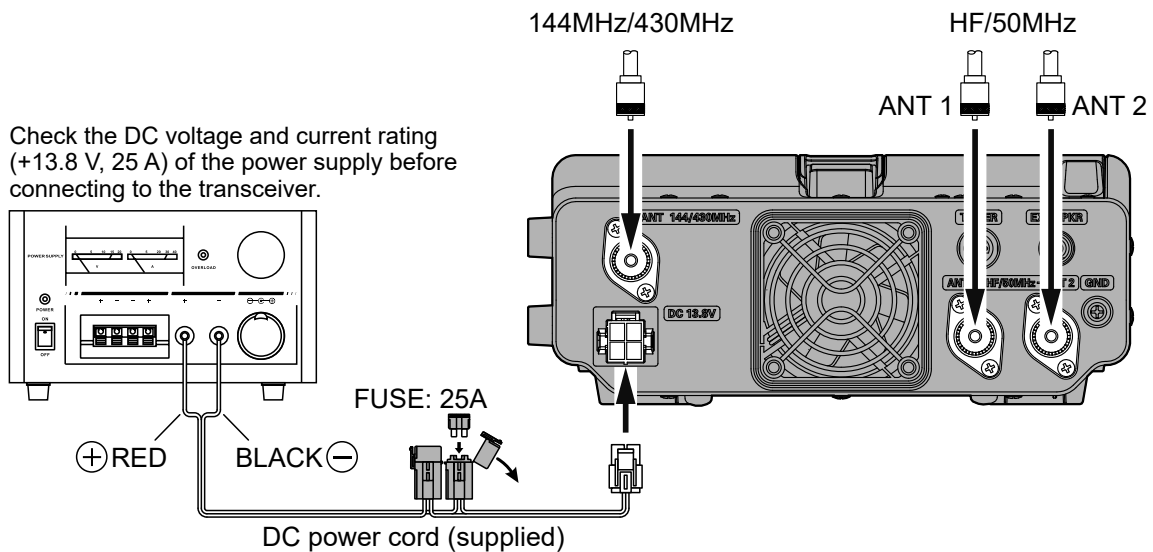

Supplied Accessories

Spare Fuse (25A)
DC Power Cord
Legs

Specifications

Frequency Range: 1.9MHz - 430MHz
Power Output: 100W (HF/50MHz), 50W (144MHz/430MHz)
Antenna Impedance: 50Ω, unbalanced
Spurious Radiation: less than -50dB @ 1.8 ~ 28MHz (Amateur Bands)
less than -63dB @ 50MHz
less than -60dB @ 144MHz, 430MHz
Supply Voltage: DC13.8V ± 15% (Negative Ground)
Power Consumption (approx.): 21A (TX 100W), 16A (TX 50W)
Operating Temperature Range: +14°F to +122°F (-10°C to +50°C)

This device complies with part 15 of the FCC Rules. Operation is subject to the following two conditions: (1) This device may not cause harmful interference, and (2) this device must accept any interference received, including interference that may cause undesired operation.

FCC CAUTION

Changes or modifications not expressly approved by the party responsible for compliance could void the user's authority to operate the equipment.

Note: This equipment has been tested and found to comply with the limits for a Class B digital device, pursuant to part 15 of the FCC Rules. These limits are designed to provide reasonable protection against harmful interference in a residential installation. This equipment generates, uses and can radiate radio frequency energy and, if not installed and used in accordance with the instructions, may cause harmful interference to radio communications. However, there is no guarantee that interference will not occur in a particular installation.

If this equipment does cause harmful interference to radio or television reception, which can be determined by turning the equipment off and on, the user is encouraged to try to correct the interference by one or more of the following measures:

- ☐ Reorient or relocate the receiving antenna.
- ☐ Increase the separation between the equipment and receiver.
- ☐ Connect the equipment into an outlet on a circuit different from that to which the receiver is connected.
- ☐ Consult the dealer or an experienced radio/TV technician for help.

RF Exposure Information

To comply with CFR Title 47 Part 97.13(C) and the Guidelines and Limits for Human Exposure to RF electromagnetic fields adopted by the FCC, you should evaluate your Radio Station Facilities as described in the Office of Engineering and Technology (OET) Bulletin 65, Supplement B.

Safety Precautions (Be Sure to Read)

Be sure to read the safety precautions of Operating Manual of the compatible transceiver to use this product safely.

Disposal of your Electronic and Electric Equipment

Products with the symbol (crossed-out wheeled bin) cannot be disposed as household waste. Electronic and Electric Equipment should be recycled at a facility capable of handling these items and their waste by products. In EU countries, please contact your local equipment supplier representative or service center for information about the waste collection system in your country.



YAESU MUSEN CO., LTD.

Omori Bellport Building D-3F
6-26-3 Minami-Oi, Shinagawa-ku, Tokyo, 140-0013, Japan

YAESU USA

6125 Phyllis Drive, Cypress, CA 90630, U.S.A.

YAESU UK

Unit 4, Concorde Park, Concorde Way, Segensworth North,
Fareham, Hampshire PO15 5FG, United Kingdom

2504P-AS

