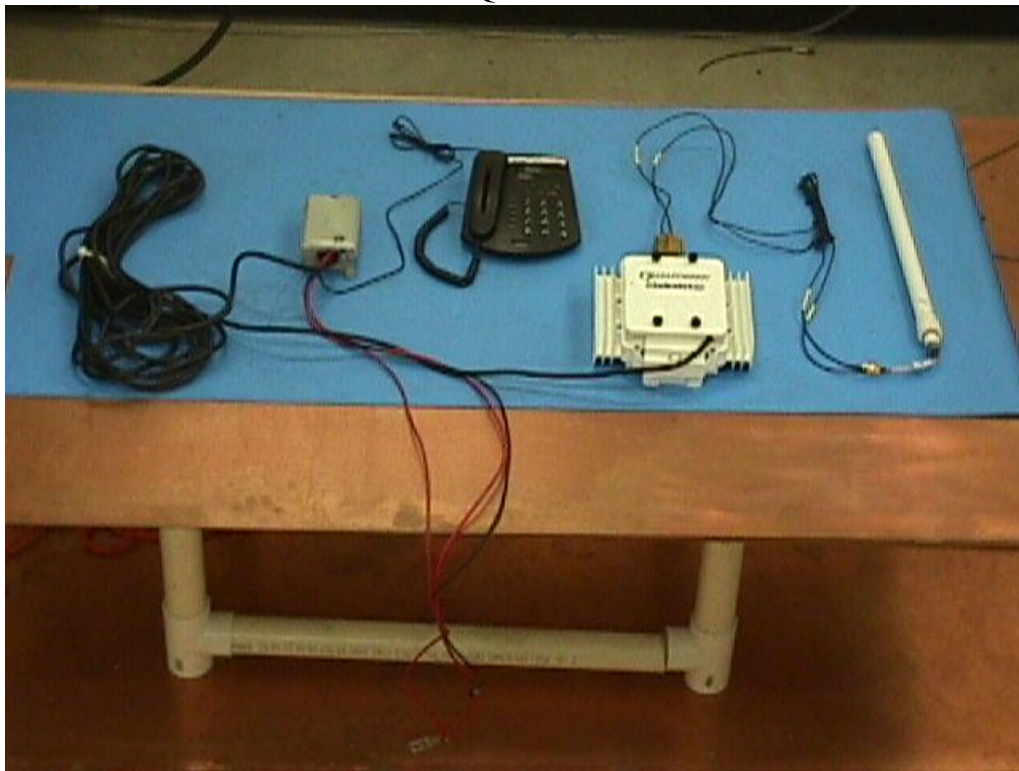

Exhibit 9 External Photos

9.1 General External Photos

GSP-2800RA with Quadrifilar Helix Antenna



GSP-2800RA with DRA Antenna



Deskset



Front View RAU

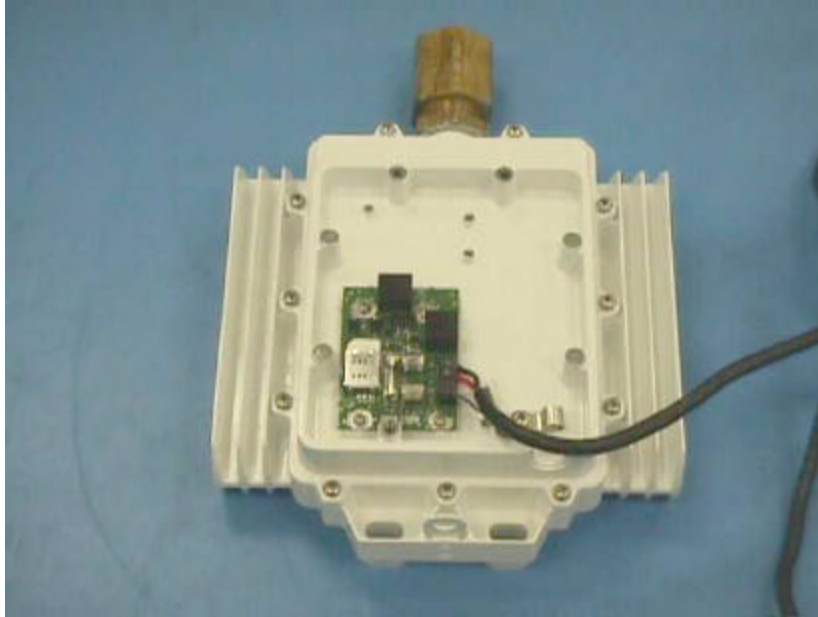

Rear View RAU



9.2 Helical Antenna Photos/Drawings

Quadrifilar Helix Antenna



ALL DATA AND INFORMATION CONTAINED IN OR DISCLOSED BY THIS DOCUMENT IS
CONFIDENTIAL AND PROPRIETARY INFORMATION OF QUALCOMM INCORPORATED AND
ALL RIGHTS THEREIN ARE EXPRESSLY RESERVED. BY ACCEPTING THIS MATERIAL
THE RECIPIENT AGREES THAT THIS MATERIAL AND THE INFORMATION CONTAINED
THEREIN IS HELD IN CONFIDENCE AND IN TRUST AND WILL NOT BE USED, COPIED,
REPRODUCED IN WHOLE OR IN PART, NOR ITS CONTENTS REVEALED IN ANY MANNER
TO OTHERS WITHOUT THE EXPRESS WRITTEN PERMISSION OF QUALCOMM INCORPORATED.
THIS TECHNOLOGY IS CONTROLLED BY THE UNITED STATES GOVERNMENT. DIVERSION
CONTRARY TO U.S. LAW PROHIBITED.

DWG NO.	80-81099-1	SH	3	REV	X6	1
REVISIONS						
REV	DESCRIPTION				DATE	APPROVED
X6	SEE SHEET 1					

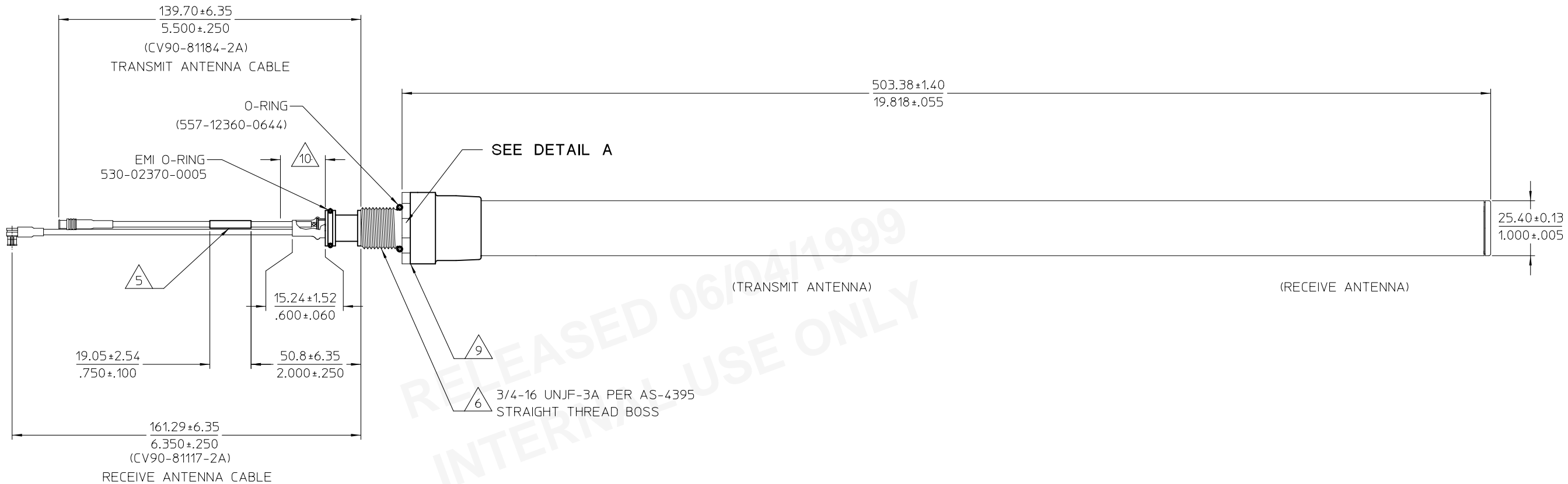

CV90-70842-4



QUALCOMM PROPRIETARY
COPYRIGHT (C) 1999 QUALCOMM INCORPORATED
ALL RIGHTS RESERVED.

6455 LUSK BOULEVARD	SAN DIEGO, CA 92121-2779	SIZE	D	CAGE CODE	1DN14	DRAWING NO	80-81099-1	REV	X6
		SCALE	NONE				SHEET 3		

9.3 DRA Antenna Photos/Drawings

DRA Antenna



NAME:EFRCUSER OBJECT:10-82283_1 DATE:19-Jun-00 10:34:04

ALL DATA AND INFORMATION CONTAINED IN OR DISCLOSED BY THIS DOCUMENT IS CONFIDENTIAL AND PROPRIETARY INFORMATION OF QUALCOMM INCORPORATED AND ALL RIGHTS THEREIN ARE EXPRESSLY RESERVED. BY ACCEPTING THIS MATERIAL THE RECIPIENT AGREES THAT THIS MATERIAL AND THE INFORMATION CONTAINED THEREIN IS HELD IN CONFIDENCE AND IN TRUST AND WILL NOT BE USED, COPIED, REPRODUCED IN WHOLE OR IN PART, NOR ITS CONTENTS REVEALED IN ANY MANNER TO OTHERS WITHOUT THE EXPRESS WRITTEN PERMISSION OF QUALCOMM INCORPORATED. EXPORT OF THIS TECHNOLOGY MAY BE CONTROLLED BY THE U.S. GOVERNMENT. DIVERSION CONTRARY TO U.S. LAW PROHIBITED.

DWG NO.	10-82283	SH	REV	1
REVISIONS				
REV	DESCRIPTION		DATE	APPROVED
XI	SEE DCR 34000		3/22/00	-

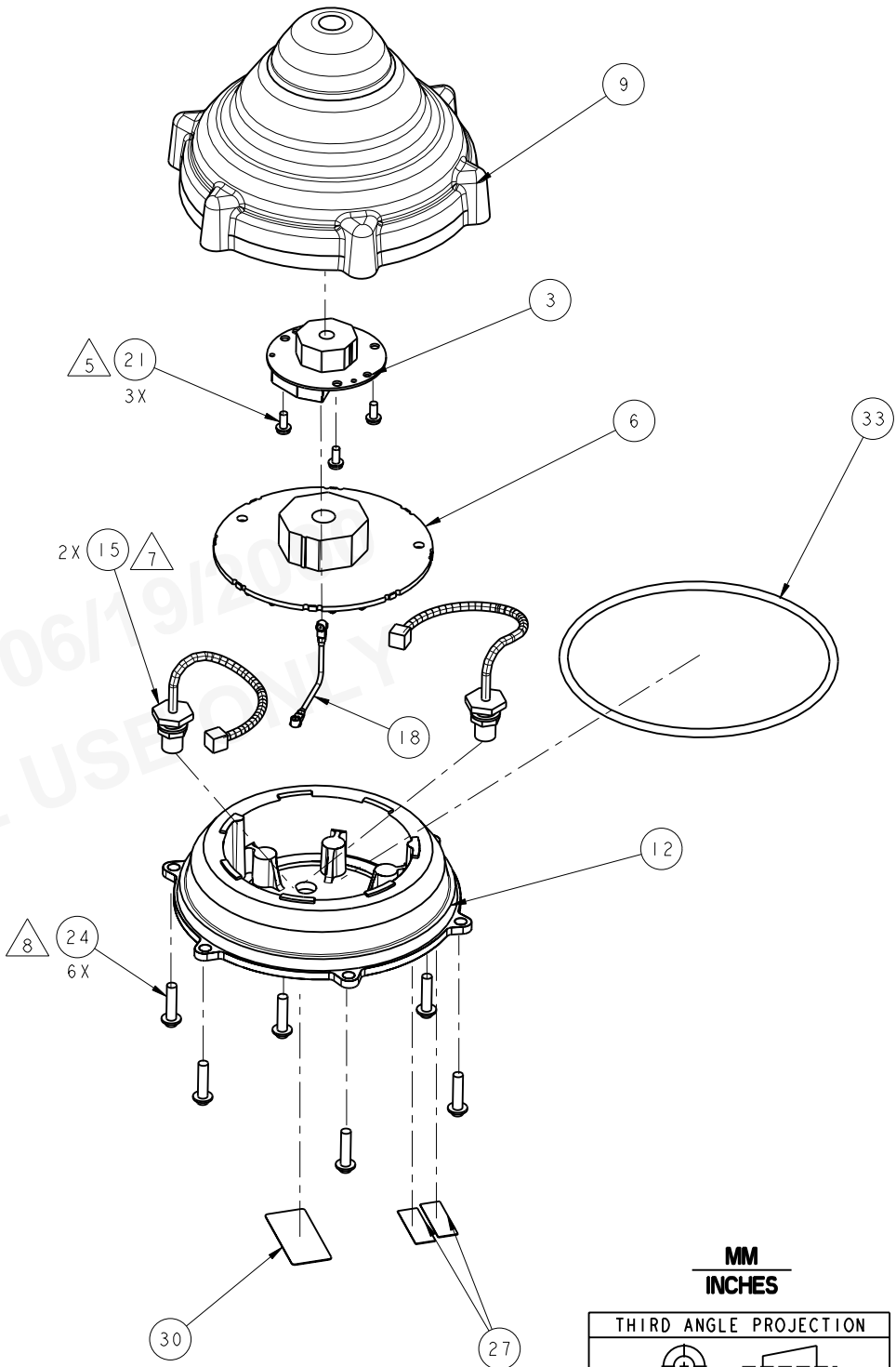

- 9 LOCATE ITEM 27 (LABEL) AND ITEM 30 (LABEL) WHERE SHOWN.
- 8 INSTALL ITEM 24 (SCREW), 6PL. TORQUE ITEM 24 (SCREW) TO 7LBS/IN #0.7LBS/IN.
- 7 TORQUE SMA CONNECTOR TO 15LBS/IN 2LBS/IN TO ITEM 12 (BASE).
- 6 ENSURE ITEM 15 (CABLE ASSY'S), 2PL, PASS THRU CORRECT LABELLED D-HOLE.
- 5 INSTALL ITEM 3 (CCA, RX) TO ITEM 9 (RADOME) USING ITEM 28 (SCREW), 3PL. TORQUE ITEM 21, 3PL, TO 2.5LBS/IN ± 0.5 LBS.
4. WORKMANSHIP SHALL BE IN ACCORDANCE WITH QUALCOMM MECHANICAL WORKMANSHIP STANDARD 80-10767-1.
3. INTERPRET DIMENSIONS AND TOLERANCES PER ASME Y14.5M-1994.
2. MILLIMETERS (MM) ARE THE CONTROLLING DIMENSIONS ON THIS DRAWING. INCH DIMENSIONS ARE FOR REFERENCE ONLY.
1. INTERPRET DRAWING PER MIL-STD-10.

NOTES: UNLESS OTHERWISE SPECIFIED

MODEL INFORMATION		
CAD TOOL: PRO/ENGINEER VER. <20>		
NAME	REVISION	VERSION
10-82283-1	XI	0+

QUALCOMM PROPRIETARY
COPYRIGHT (C) 2000 QUALCOMM INCORPORATED
ALL RIGHTS RESERVED

SEE SEPARATE PARTS LIST:
10-82283-1

MM INCHES	
THIRD ANGLE PROJECTION	
UNLESS OTHERWISE SPECIFIED	
DIMENSION UNITS ARE AS NOTED/PER NOTE 2 AND APPLY AFTER SURFACE TREATMENT	
TOLERANCES	
MM	INCHES
LINEAR	ANGULAR
X ± 2.5	.1 $\pm .1$
X.X ± 0.76	.XX $\pm .03$
X.XX ± 0.25	.XXX $\pm .010$
HOLE DIAMETERS	
MM	INCHES
0.34 - 6.35	$+0.13 - 0.03$.013 - .250 $+0.005 - .001$
6.37 - 12.70	$+0.15 - 0.03$.251 - .500 $+0.006 - .001$
12.72 - 25.40	$+0.25 - 0.03$.501 - 1.000 $+0.010 - .001$

CONTRACT NO.	NONE	DATE	5/30/00
DRW	N. BURNS	CHK	READ SIG ON FILE
ENG		ENG	
P.E.		P.E.	
MFG		MFG	
QUALCOMM		5775 MOREHOUSE DRIVE SAN DIEGO, CA 92121-1714	
ODU, GLOBALSTAR MODULE		TITLE	
SIZE	CAGE CODE	DRAWING NO	REV
D	IDN14	10-82283	XI
SCALE	1.000	SHEET 1 OF 5	

NAME:EFRCUSER OBJECT:10-82283_2 DATE:19-Jun-00 10:34:10

ALL DATA AND INFORMATION CONTAINED IN OR DISCLOSED BY THIS DOCUMENT IS
CONFIDENTIAL AND PROPRIETARY INFORMATION OF QUALCOMM INCORPORATED AND
ALL RIGHTS THEREIN ARE EXPRESSLY RESERVED. BY ACCEPTING THIS MATERIAL
THE RECIPIENT AGREES THAT THIS MATERIAL AND THE INFORMATION CONTAINED
THEREIN IS HELD IN CONFIDENCE AND IN TRUST AND WILL NOT BE USED, COPIED,
REPRODUCED IN WHOLE OR IN PART, NOR ITS CONTENTS REVEALED IN ANY MANNER
TO OTHERS WITHOUT THE EXPRESS WRITTEN PERMISSION OF QUALCOMM INCORPORATED.
EXPORT OF THIS TECHNOLOGY MAY BE CONTROLLED BY THE U.S. GOVERNMENT.
DIVERSION CONTRARY TO U.S. LAW PROHIBITED.

DWG NO.	10-82283	SH	2	REV	XI
REVISIONS					
REV	DESCRIPTION			DATE	APPROVED
XI	SEE SHEET I			---	-----

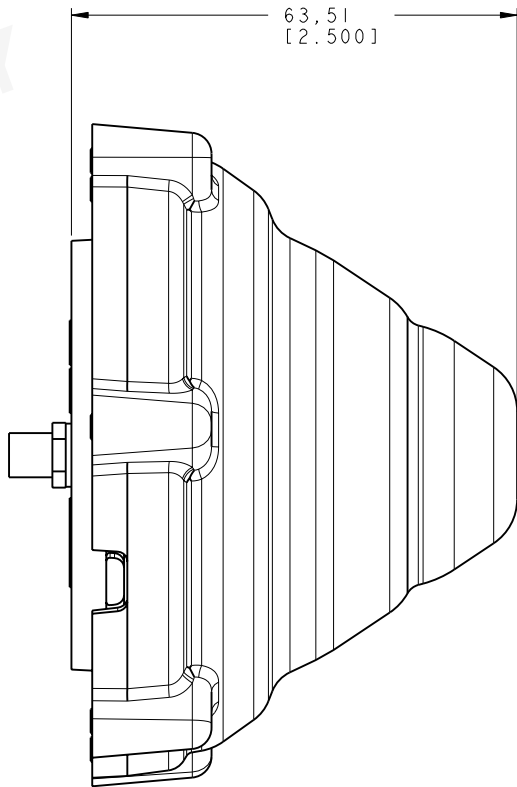
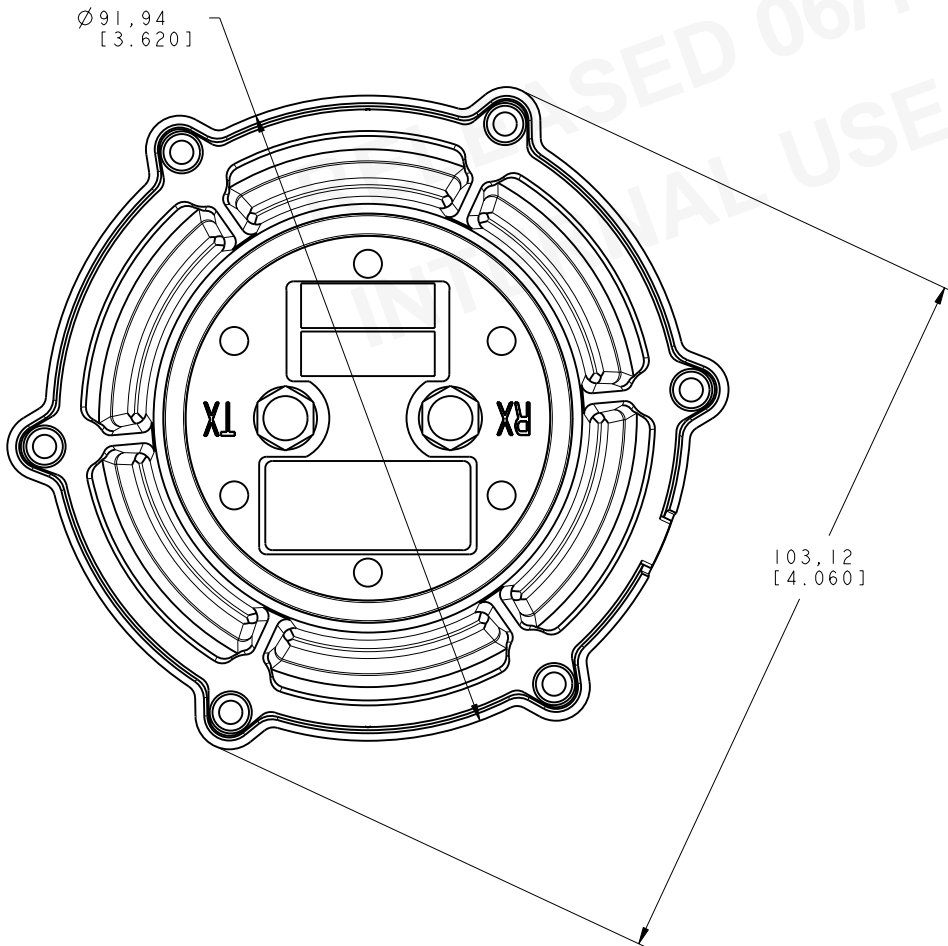
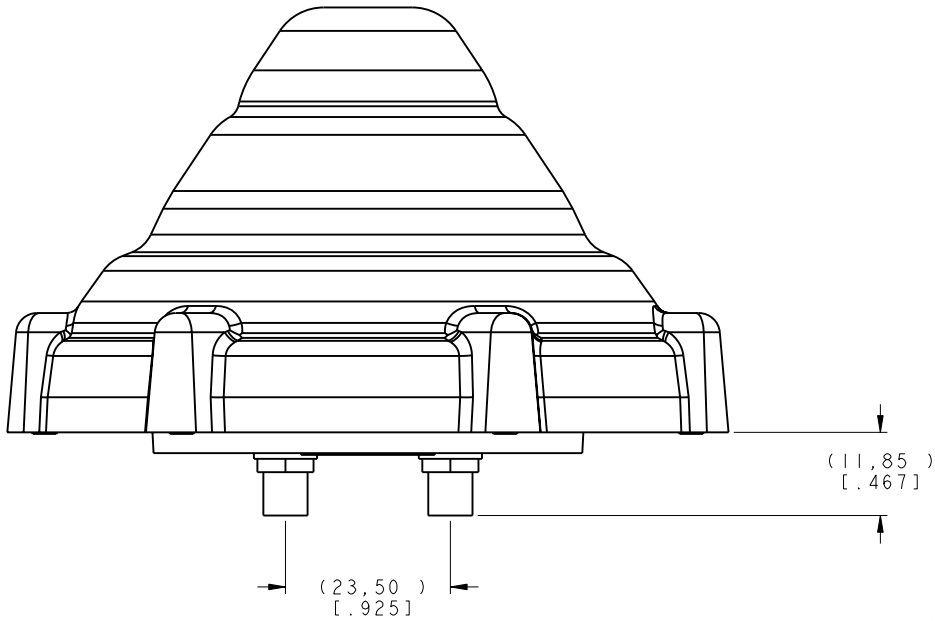

QUALCOMM PROPRIETARY
COPYRIGHT (C) 2000 QUALCOMM INCORPORATED
ALL RIGHTS RESERVED.

5775 MOREHOUSE DRIVE	SAN DIEGO, CA 92121-1714	SCALE 1:000	SHEET 2 OF 5
SIZE D	CAGE CODE IDN14	DRAWING NO 10-82283	REV XI
VER 0+			

NAME:EFRCUSER OBJECT:10-82283_3 DATE:19-Jun-00 10:34:17

ALL DATA AND INFORMATION CONTAINED IN OR DISCLOSED BY THIS DOCUMENT IS
CONFIDENTIAL AND PROPRIETARY INFORMATION OF QUALCOMM INCORPORATED AND
ALL RIGHTS THEREIN ARE EXPRESSLY RESERVED. BY ACCEPTING THIS MATERIAL
THE RECIPIENT AGREES THAT THIS MATERIAL AND THE INFORMATION CONTAINED
THEREIN IS HELD IN CONFIDENCE AND IN TRUST AND WILL NOT BE USED, COPIED,
REPRODUCED IN WHOLE OR IN PART, NOR ITS CONTENTS REVEALED IN ANY MANNER
TO OTHERS WITHOUT THE EXPRESS WRITTEN PERMISSION OF QUALCOMM INCORPORATED.
EXPORT OF THIS TECHNOLOGY MAY BE CONTROLLED BY THE U.S. GOVERNMENT.
DIVERSION CONTRARY TO U.S. LAW PROHIBITED.

DWG NO.	10-82283	SH	3	REV	XI
REVISIONS					
REV	DESCRIPTION			DATE	APPROVED
XI	SEE SHEET I			---	-----

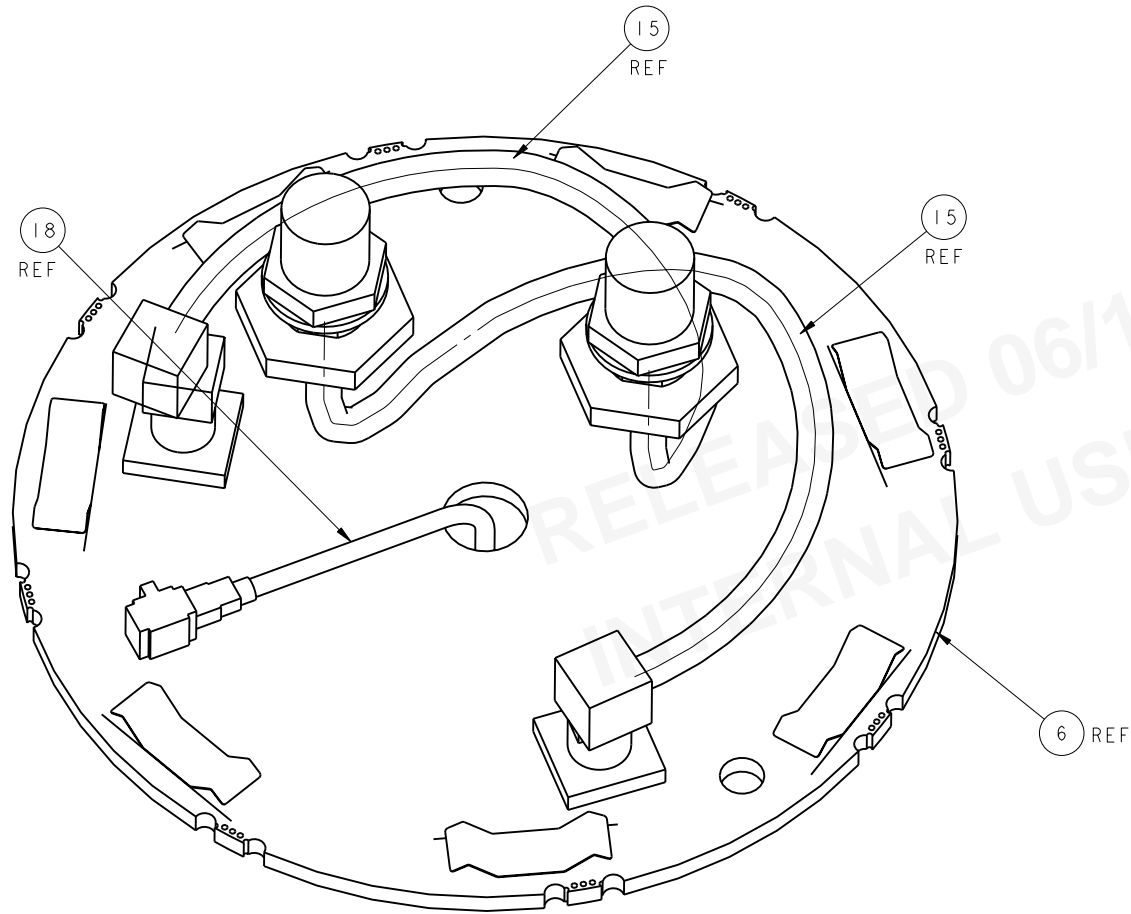

VIEW SHOWING CABLE
ORIENTATION ON TX BOARD

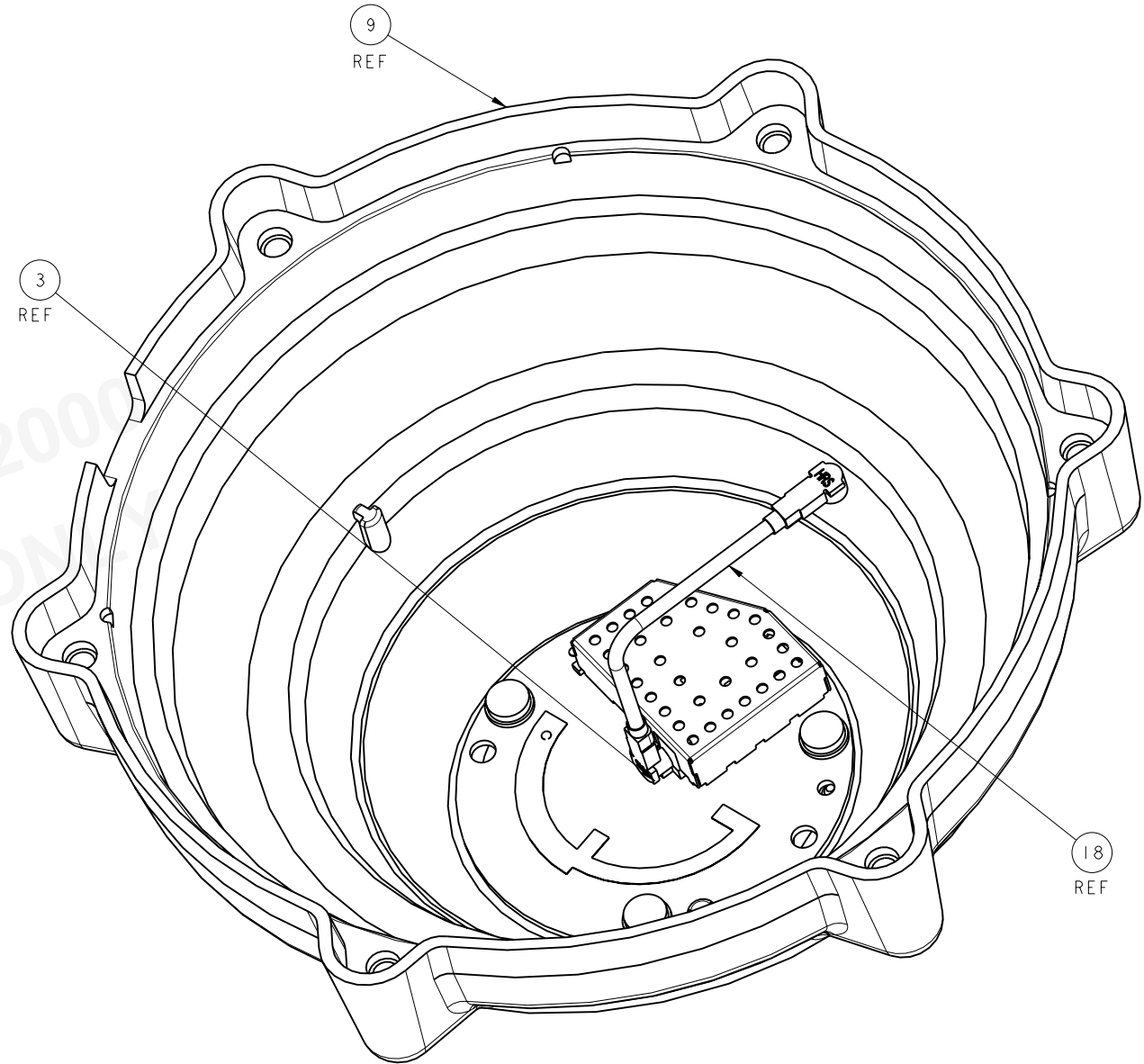

VIEW SHOWING CABLE
ASSY TERMINATION AT RX BOARD



QUALCOMM PROPRIETARY
COPYRIGHT (C) 2000 QUALCOMM INCORPORATED
ALL RIGHTS RESERVED.

SIZE	CAGE CODE	DRAWING NO	REV	VER
D	IDN14	10-82283	XI	0+
SCALE 4.000		SHEET 3 OF 5		

ALL DATA AND INFORMATION CONTAINED IN OR DISCLOSED BY THIS DOCUMENT IS
CONFIDENTIAL AND PROPRIETARY INFORMATION OF QUALCOMM INCORPORATED AND
ALL RIGHTS THEREIN ARE EXPRESSLY RESERVED. BY ACCEPTING THIS MATERIAL
THE RECIPIENT AGREES THAT THIS MATERIAL AND THE INFORMATION CONTAINED
THEREIN IS HELD IN CONFIDENCE AND IN TRUST AND WILL NOT BE USED, COPIED,
REPRODUCED IN WHOLE OR IN PART, NOR ITS CONTENTS REVEALED IN ANY MANNER
TO OTHERS WITHOUT THE EXPRESS WRITTEN PERMISSION OF QUALCOMM INCORPORATED.
EXPORT OF THIS TECHNOLOGY MAY BE CONTROLLED BY THE U.S. GOVERNMENT.
DIVERSION CONTRARY TO U.S. LAW PROHIBITED.

DWG NO.	10-82283	SH	4	REV	XI
REVISIONS					
REV	DESCRIPTION			DATE	APPROVED
XI	SEE SHEET I			---	-----

MAKE SURE CORRECT
CABLE ASSY IS FED THRU
CORRECT D-HOLE.
1 - RX FOR RX CABLE TERMINATION
2 - TX FOR TX CABLE TEMINATION

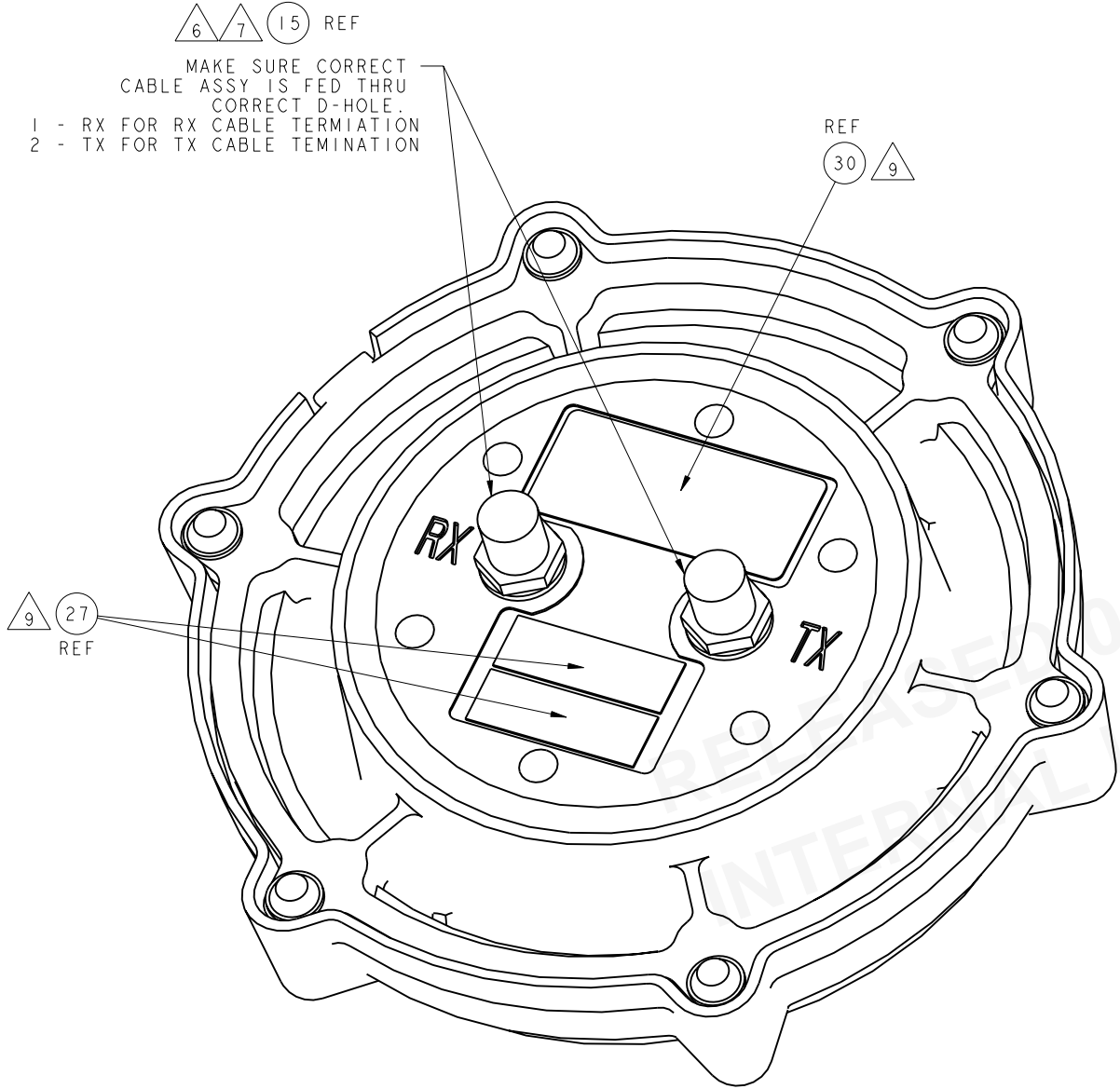

VIEW SHOWING LABEL
PLACEMENT AND SMA ORIENTATION

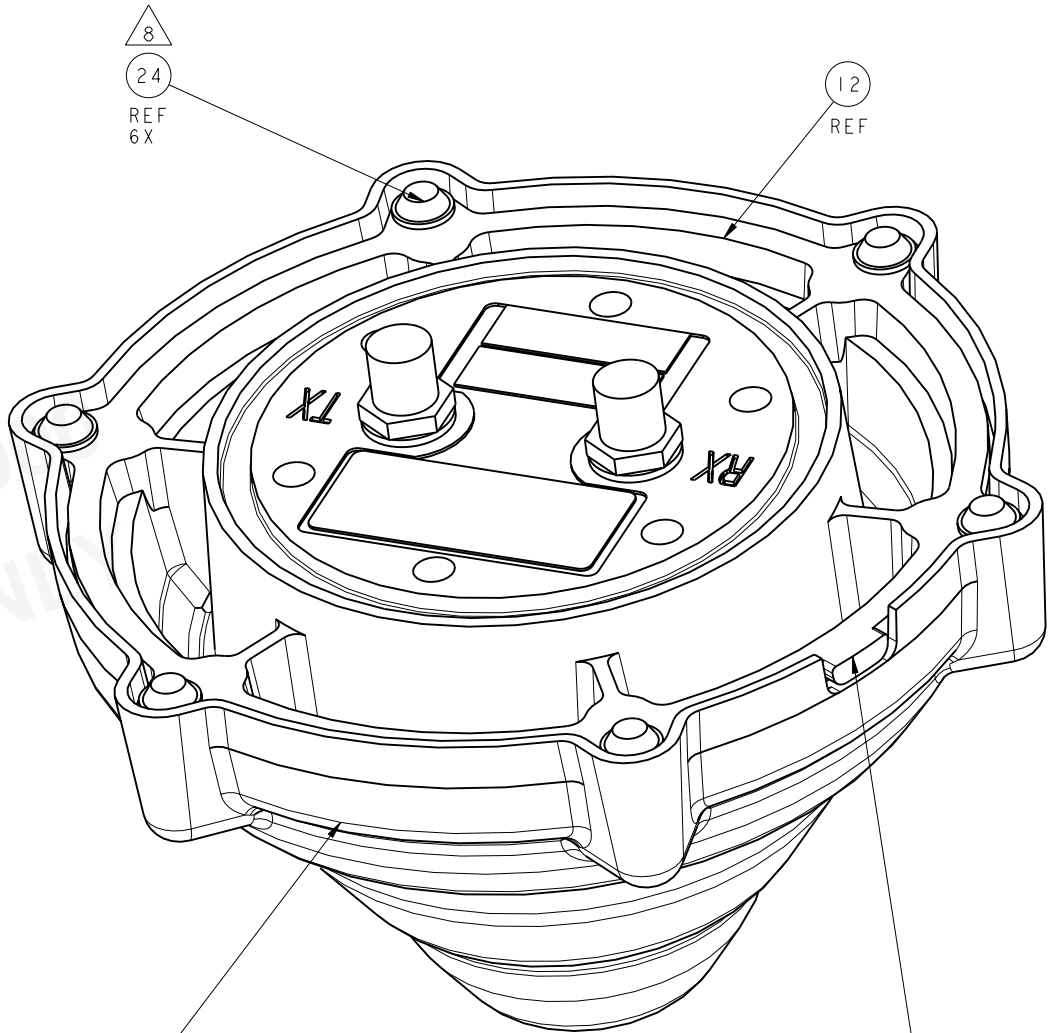

VIEW SHOWING ALIGNMENT
OF BASE TO RADOME



QUALCOMM PROPRIETARY
COPYRIGHT (C) 2000 QUALCOMM INCORPORATED
ALL RIGHTS RESERVED.

5775 MOREHOUSE DRIVE	SAN DIEGO, CA 92121-1714	SIZE	CAGE CODE	DRAWING NO	REV	VER
		D	IDN14	10-82283	XI	0+
SCALE 3.000		SHEET 4 OF 5				

NAME:EFRCUSER OBJECT:10-82283_5 DATE:19-Jun-00 10:34:30

ALL DATA AND INFORMATION CONTAINED IN OR DISCLOSED BY THIS DOCUMENT IS
CONFIDENTIAL AND PROPRIETARY INFORMATION OF QUALCOMM INCORPORATED AND
ALL RIGHTS THEREIN ARE EXPRESSLY RESERVED. BY ACCEPTING THIS MATERIAL
THE RECIPIENT AGREES THAT THIS MATERIAL AND THE INFORMATION CONTAINED
THEREIN IS HELD IN CONFIDENCE AND IN TRUST AND WILL NOT BE USED, COPIED,
REPRODUCED IN WHOLE OR IN PART, NOR ITS CONTENTS REVEALED IN ANY MANNER
TO OTHERS WITHOUT THE EXPRESS WRITTEN PERMISSION OF QUALCOMM INCORPORATED.
EXPORT OF THIS TECHNOLOGY MAY BE CONTROLLED BY THE U.S. GOVERNMENT.
DIVERSION CONTRARY TO U.S. LAW PROHIBITED.

DWG NO.		10-82283	SH	5	REV	XI
REVISIONS						
REV	DESCRIPTION				DATE	APPROVED
XI	SEE SHEET I				---	-----

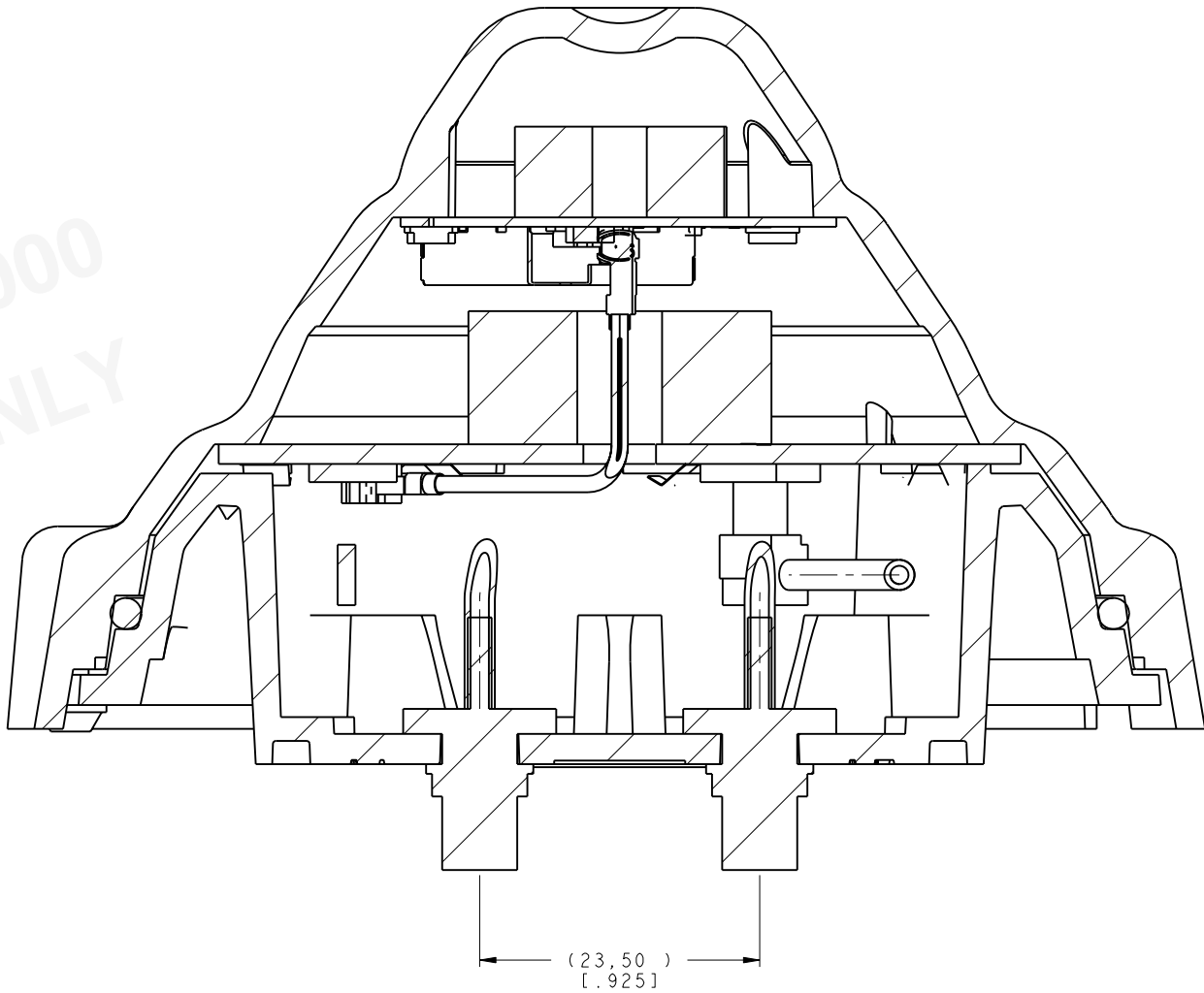
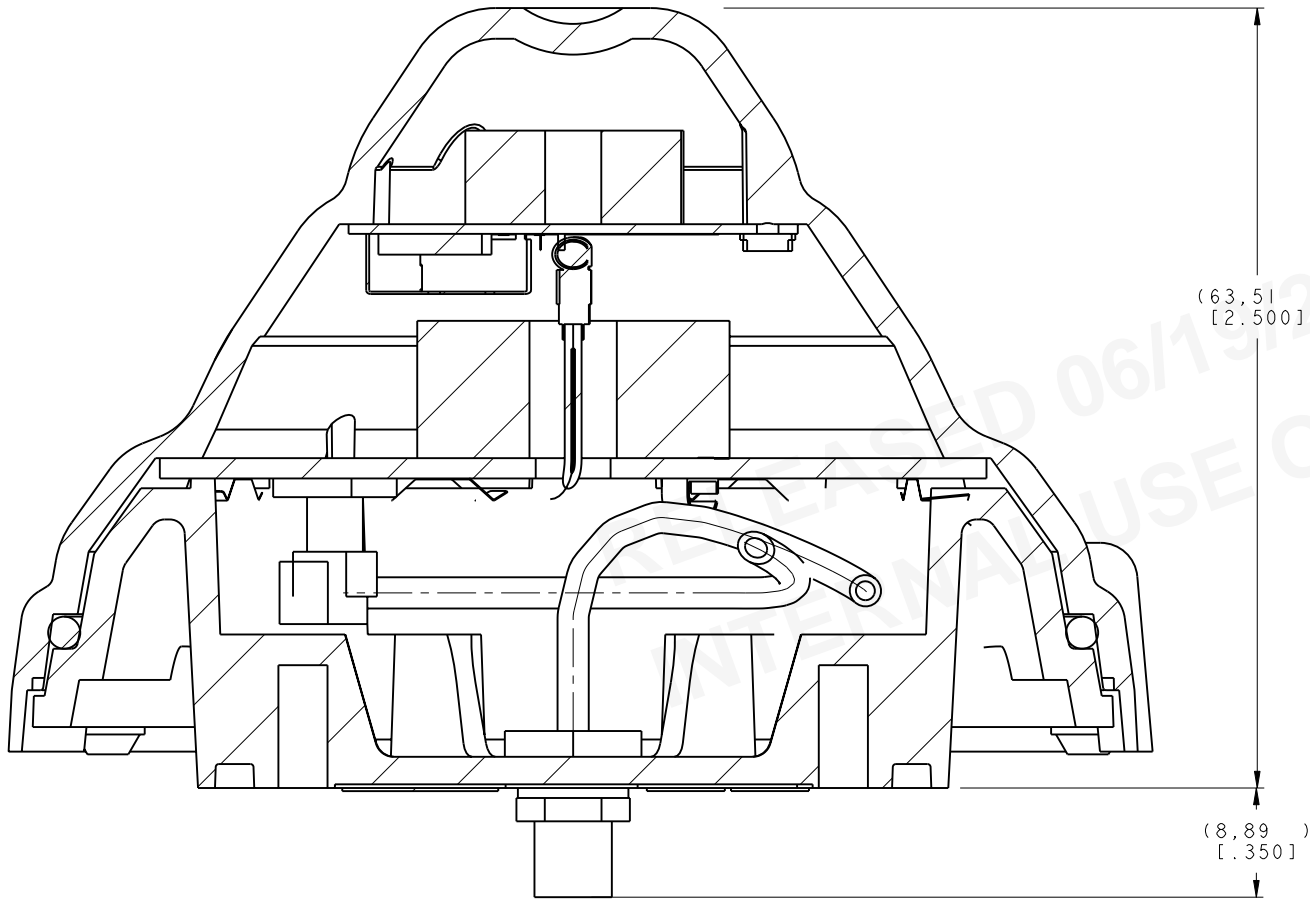

QUALCOMM PROPRIETARY
COPYRIGHT (C) 2000 QUALCOMM INCORPORATED
ALL RIGHTS RESERVED.

5775 MOREHOUSE DRIVE	SAN DIEGO, CA 92121-1714	SIZE	CAGE CODE	DRAWING NO	REV	VER
		D	IDN14	10-82283	XI	0+
SCALE 1.000		SHEET 5 OF 5				