

GARMIN®

A04741

Quick Start Manual

Device Overview



Device Pairing

garmin.com/connectapp

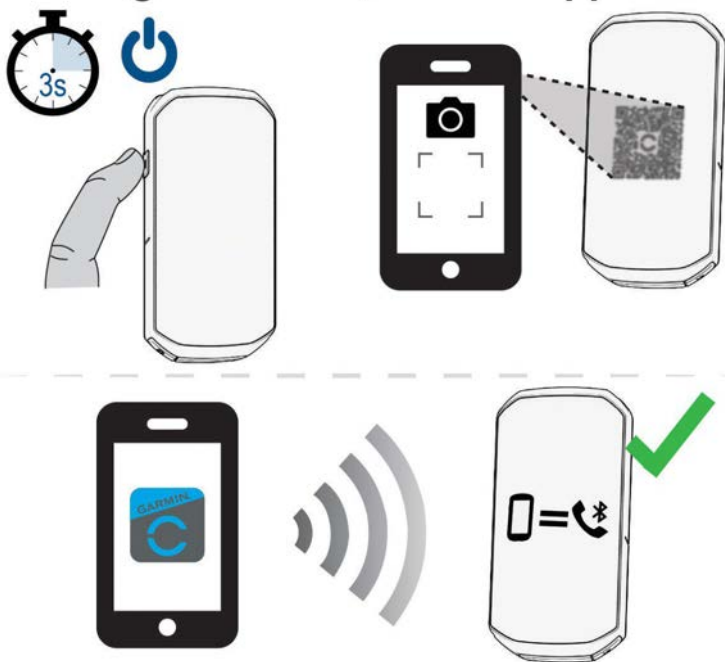

Device Charging

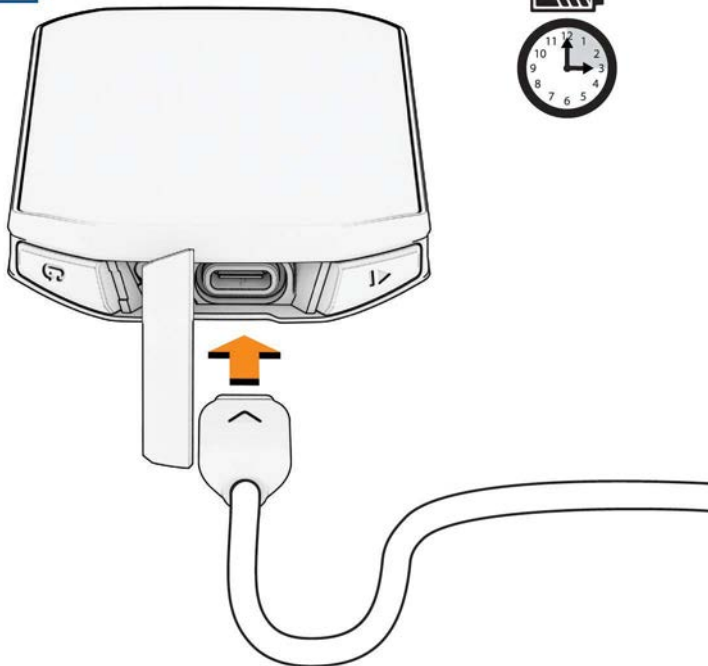

Standard Mount Installation

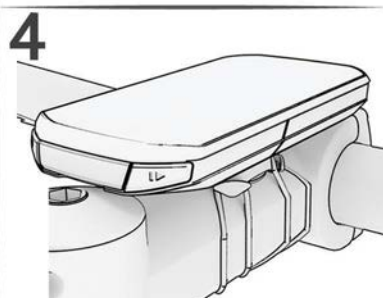
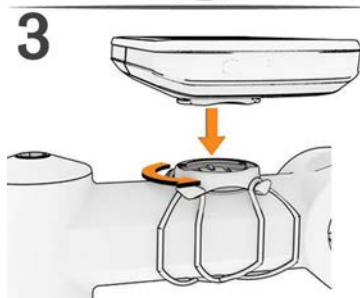
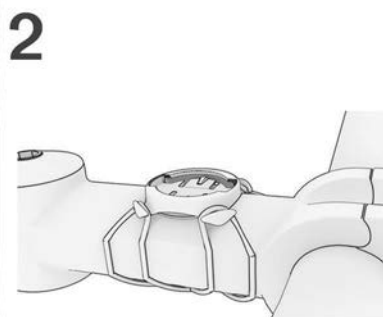
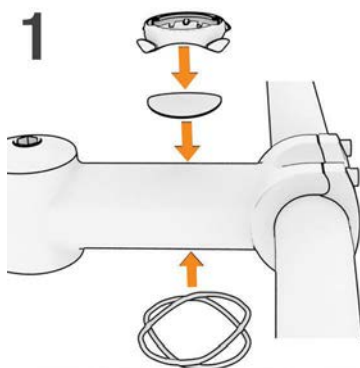

Out-Front Mount Installation

1



2

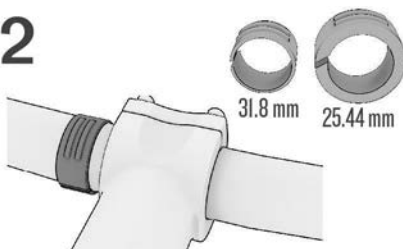

3

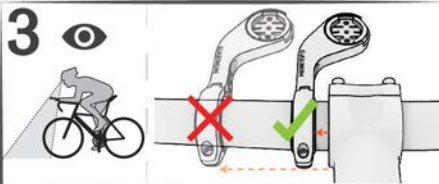

4

7 lbf-in. (0.8 N-m)



5

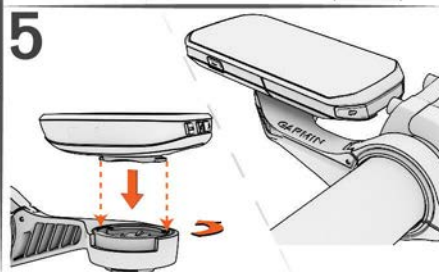

Cadence Sensor Installation

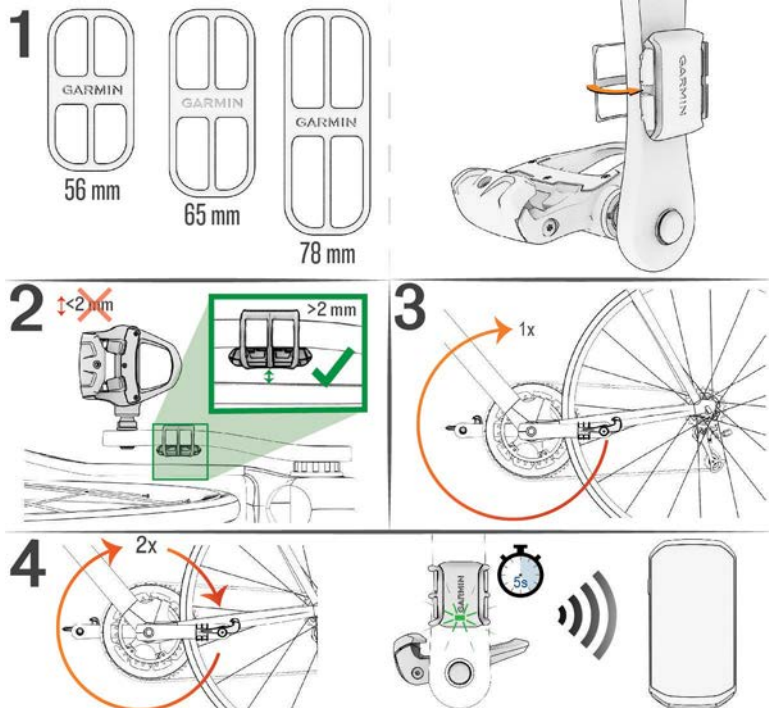

Speed Sensor Installation

1

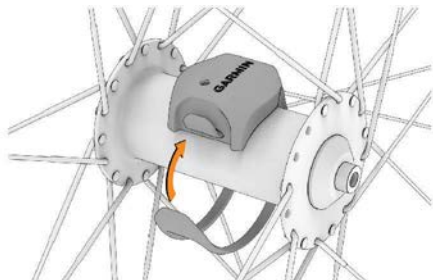

2

$\updownarrow < 2 \text{ mm}$

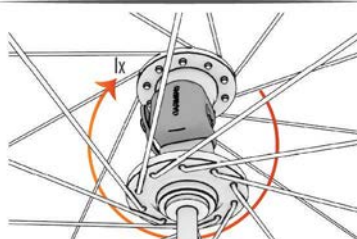
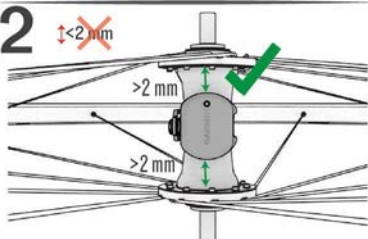

3

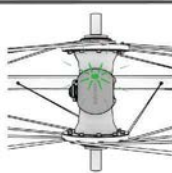
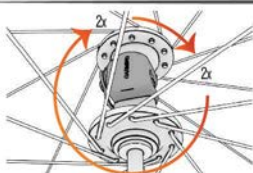

HRM-Dual™ Overview

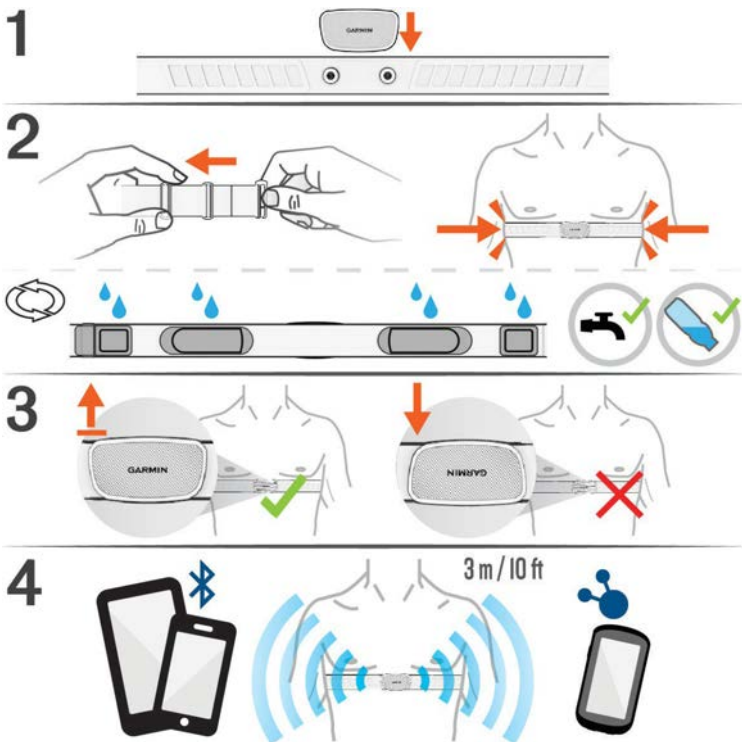

Optional Accessories

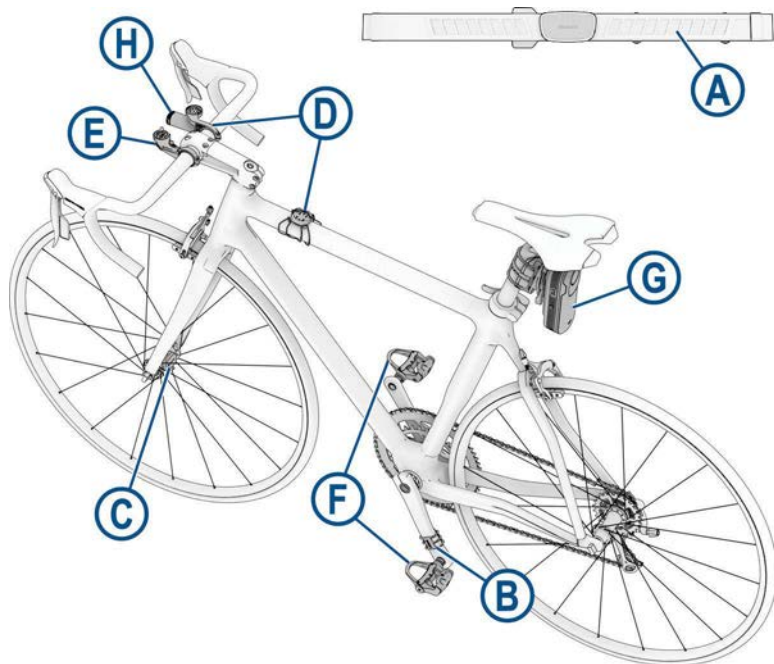

WARNING

- See the *Important Safety and Product Information* guide in the product box for product warnings and other important information.
- Always consult your physician before you begin or modify any exercise program.

NOTICE

To prevent corrosion, thoroughly dry the USB port, the weather cap, and the surrounding area before charging or connecting to a computer.



Optional Accessories

Go to www.buy.garmin.com to purchase optional accessories.



A	HRM-Dual (included in bundles)
B	Cadence sensor (included in bundles)
C	Speed sensor (included in bundles)
D	Standard and out-front mounts (included with all devices)

E	Mountain biking mount
F	Rally™ power meter system
G	Varia™ rearview radar, tail light, or camera
H	Varia headlight

Device Buttons

	Press to enter sleep mode and wake the device.
	Press to mark a new lap.
	Press to start and stop the activity timer.

Using the Touchscreen

- When the timer is running, tap the screen to view the timer overlay. The timer overlay allows you to return to the home screen during a ride.
- Select  to return to the home screen.
- Swipe or select the arrows to scroll.
- Select  to open a menu.
- Select  to return to the previous page.

- Select **✓** to save your changes and close the page.
- Select **X** to close the page and return to the previous page.
- Select **🔍** to search near a location.
- Select **🗑️** to delete an item.
- Select **ℹ️** for more information.

Device Information

Specifications

Operating temperature range: From -20° to 60°C (from -4° to 140°F)

Charging temperature range: From 0° to 45°C (from 32° to 113°F)

Speed sensor and cadence sensor operating temperature range: From -20° to 60°C (from -4° to 140°F)

Heart rate monitor operating temperature range: From -5° to 50°C (from 23° to 122°F)

Wireless frequencies: 2.4 GHz @ 16.27 dBm maximum, 13.56 MHz @ -38 dBm maximum

Charging Requirements

The power delivered by the charger must be between min 2.5 Watts required by the radio equipment, and max 15 Watts in



order to achieve the maximum charging speed.

Product Updates

Your device automatically checks for updates when connected to Bluetooth® or Wi-Fi®. You can manually check for updates from the system settings. On your computer, install Garmin Express™ (garmin.com/express). On your phone, install the Garmin Connect™ app.

This provides easy access to these services for Garmin® devices:

- Software updates
- Map updates
- Course updates
- Data uploads to Garmin Connect
- Product registration

Getting More Information

- Go to support.garmin.com for additional manuals, articles, and software updates.
- Go to buy.garmin.com, or contact your Garmin dealer for information about optional accessories and replacement parts.

Getting the Owner's Manual

The owner's manual includes instructions for using device features and accessing regulatory information.

Go to www.garmin.com/manuals/.

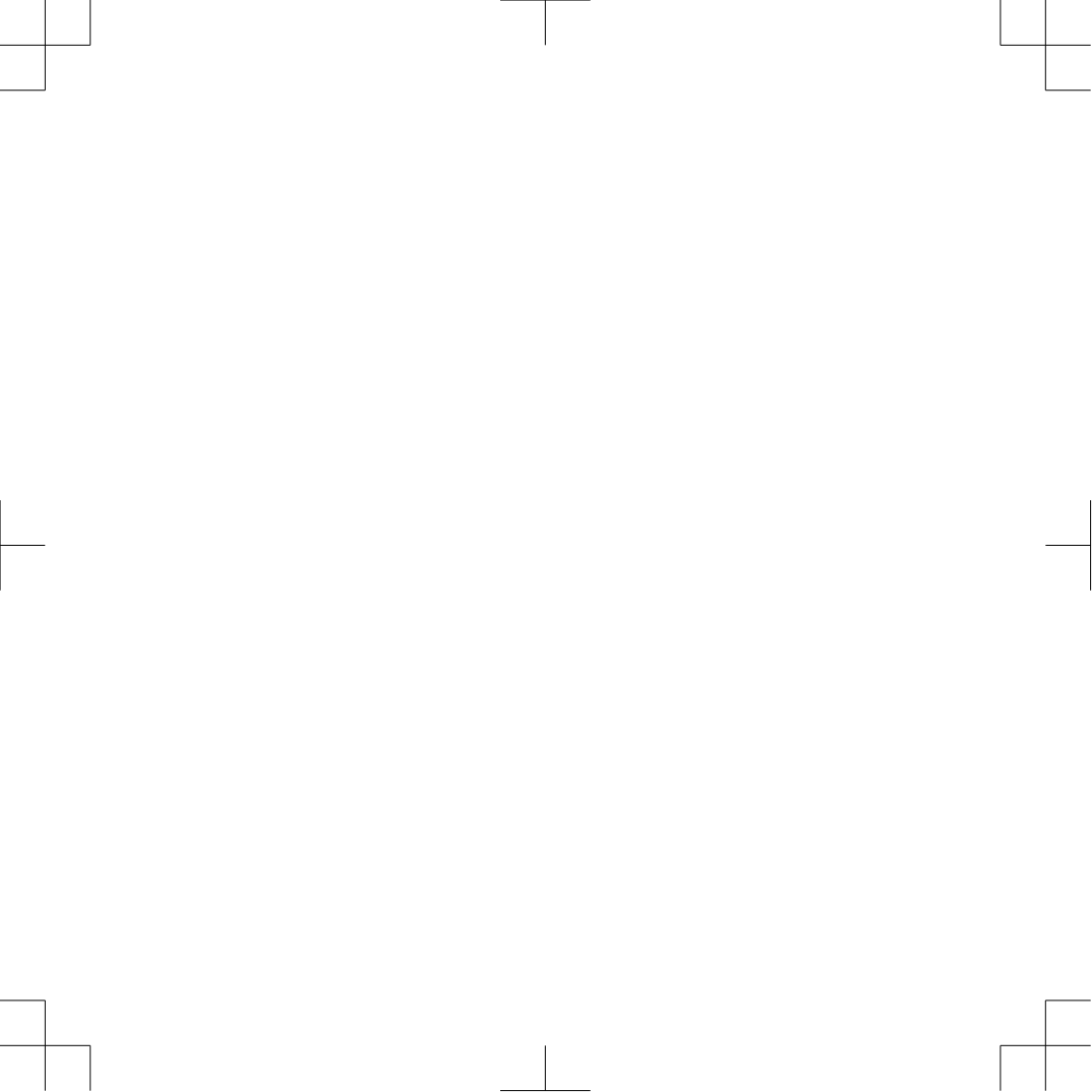

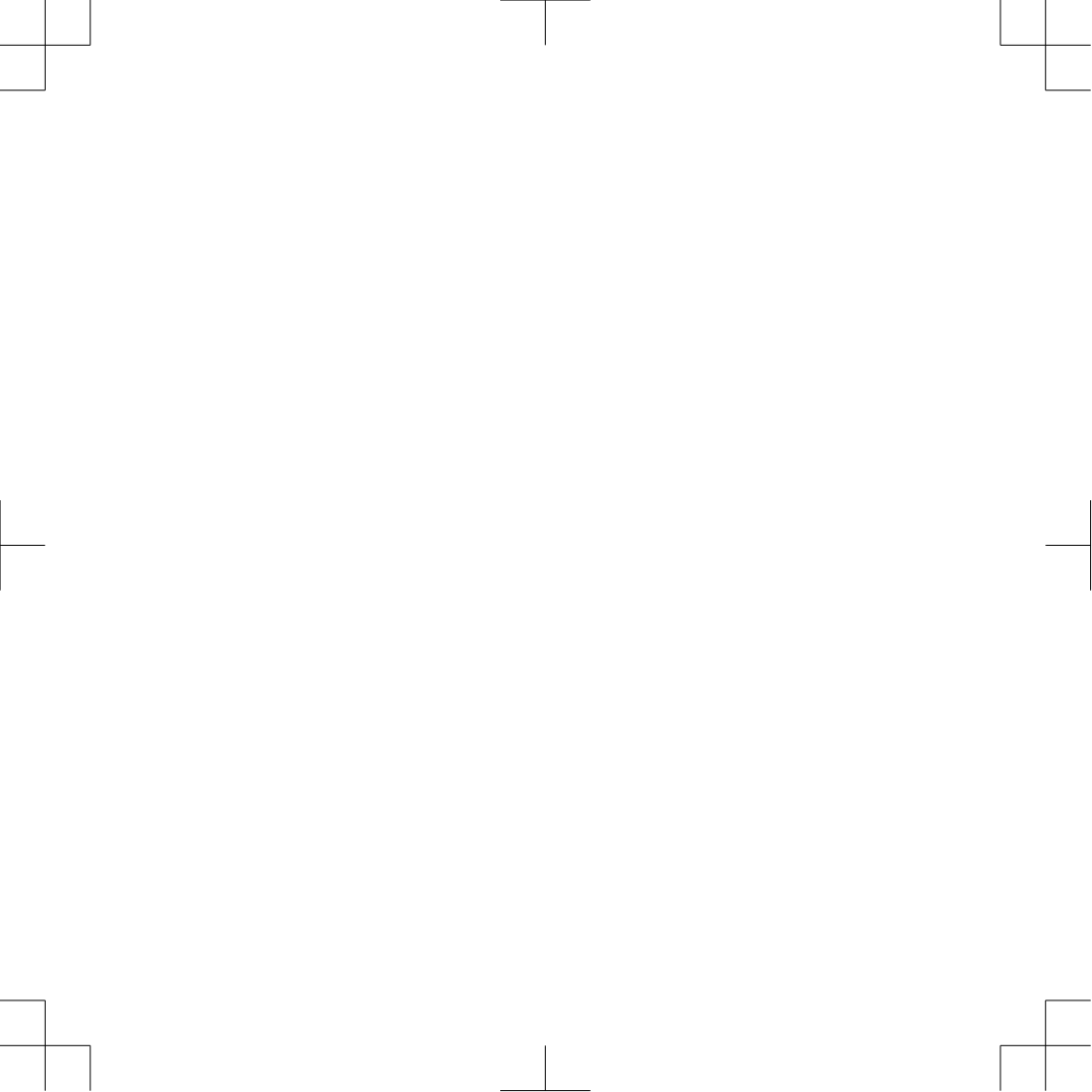

support.garmin.com

© 2024 Garmin Ltd. or its subsidiaries

Garmin®, the Garmin Logo, ANT+®, are trademarks of Garmin Ltd. or its subsidiaries, registered in the USA and other countries. These trademarks may not be used without the express permission of Garmin. Garmin Connect™, Garmin Express™, HRM-Dual™, Rally™, and Varia™ are trademarks of Garmin Ltd. or its subsidiaries. These trademarks may not be used without the express permission of Garmin.

The BLUETOOTH® word mark and logos are owned by the Bluetooth SIG, Inc. and any use of such marks by Garmin is under license. Wi-Fi® is a registered mark of Wi-Fi Alliance Corporation. Other trademarks and trade names are those of their respective owners.

M/N: A0xxxx

Printed in Taiwan
March 2024
190-03094-90

