

## ⚠ Troubleshooting :

### Wireless RF Keyboard not detected

If the Keyboard don't respond to activity, follow this steps :

- (1) Ensure that the receiver cable is properly connect to the USB ports.
- (2) Ensure that the batteries have been installed correctly.
- (3) Ensure that you have established a connection between the RF receiver, the mouse and the keyboard.

If the RF Keyboard don't respond to activity after replacing. The batteries, follow these steps :

- (1) Ensure that the batteries have been installed correctly.
- (2) Ensure that the batteries are not discharged.
- (3) Ensure that you have established a connection between the RF receiver, the mouse and the keyboard.

## Notice ⚠ Important :

### International Standards and Safety.

This optical device complies with International Standard IEC 60825-1 : 2001-08, Class 1 Laser Product, and also complies with 21 CFR 1040.10 and 1040.11, except for deviations pursuant to Laser Notice No. 50, dated July 26, 2001 :

- (1) Emission of a parallel beam of infrared user-invisible light;
- (2) Maximum power of 716 microWatts  $\mu W$ , wavelength range 832-865 nanometers;
- (3) Operating temperature between 0°C (32°F) to 40°C (104°F).

### CAUTION :

This optical device has no serviceable parts. Use of controls or adjustments or performance of procedures other those specified herein may result in hazardous radiation exposure.

### Safety and Usage Guidelines.

- (1) Do not point infrared beam at eye.
- (2) Do not disassemble your product or expose it to liquid, humidity, moisture, or temperatures outside the specified operating of 0°C (32°F) to 40°C (104°F).
- (3) If your product is exposed to out-of-range temperatures, switch it off and allow the temperature to return to the normal operating range.

## QUICK GUIDE

### RF Keyboard Combo



- 🔇 Mute : Turn off the sound. Press again to turn the sound back on.
- 🔊 Volume Down : Hold down this key to quick decrease the volume.
- 🔊 Volume Up : Hold down this key to quick increase the volume.
- 💤 Sleep : User can put the system into sleep mode, if the PC supports power management. The user can put the computer to sleep by press this key.

## 1. Package Contents :

- (A) Input Voltage : DC 3V(min).
- (B) Power Consumption : 6 mA (max).
- (C) Available Distance : 8~10 m(max).
- (D) Wireless RF : 2.4 GHz.
- (E) System Requirements : Windows NT 4.0 / 98SE / 2000 / ME / XP / Vista / Windows 7.

## 2. Package Contents :

- (A) Keyboard
- (B) Battery 1.5V/AAx2

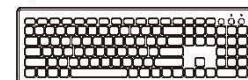

## 3. Install the Batteries :

- (A) Keyboard
- 

## 3. Installation :

- (A) Plug-in the receiver.
- (B) LED on receiver will flash for 20 seconds.

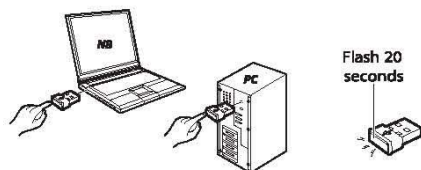

- (C) Press ID connect button on Wireless RF Keyboard within 20 seconds.  
When ID matched, the LED will stop flashing. Then the Device could work.



## ID Select ⚠ Important :

- ※ Note ! Repeat this Step when connecting the Mouse for the first time and after replacing the batteries.
- ※ Place the receiver at least 20 Inches (50cm) from electrical devices such as the computer or monitor.

## FCC statement

This equipment has been tested and found to comply with the limits for a class B digital device, pursuant to Part 15 of the FCC Rules. These limits are designed to provide reasonable protection against harmful interference in a residential installation.

This equipment generates uses and can radiate radio frequency energy and, if not installed and used in accordance with the instructions, may cause harmful interference to radio communications. However, there is no guarantee that interference will not occur in a particular installation if this equipment does cause harmful interference to radio or television reception, which can be determined by turning the equipment off and on, the user is encouraged to try to correct the interference by one of the following measures:

- Reorient or relocate the receiving antenna.
- Increase the separation between the equipment and receiver.
- Connect the equipment into an outlet on a circuit different from that to which the receiver is connected.

To assure continued compliance, any changes or modifications not expressly approved by the party responsible for compliance could void the user's authority to operate this equipment. (Example-use only shielded interface cables when connecting to computer or peripheral devices).

This device complies with Part 15 of the FCC Rules. Operation is subject to the following two conditions:

- (1) This device may not cause harmful interference, and
- (2) This device must accept any interference received, including interference that may cause undesired operation.