

Model: iBTW88
 Instruction manual - US English
 size: 408 x 150
 Folded Size: 102 x 150 mm
 Date: May 10, 2019
 Mat'l: 260gsm paper art card
 Color:

CMYK 0/100/100/0

Front

iHome

Rechargeable Speaker +
 Wireless Charging Pad
 Model: iBTW88

QUICK START GUIDE

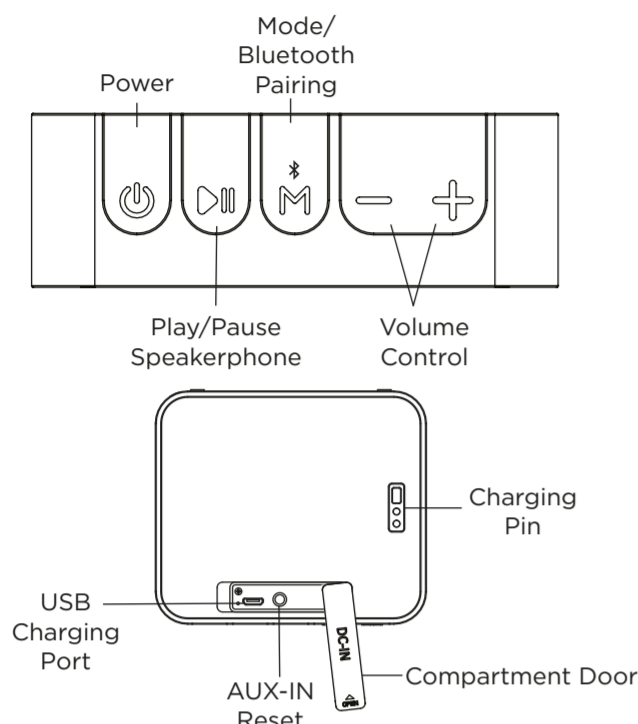

**CHARGE UNIT
 BEFORE USE
 ABOUT 6 HOURS**

Questions? www.ihome.com
 1-800-288-2792

BC

CHARGING THE IBTW88

Charging via USB

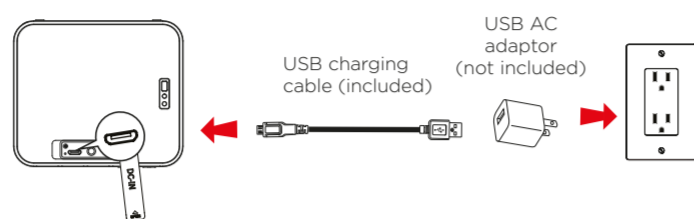

Using The Charging Pad

To power the Wireless Charging Pad, connect a USB cable to the USB port on the side of the unit. Connect the other end of the cable to the adaptor made for your smartphone. Then plug the adaptor into a power outlet.

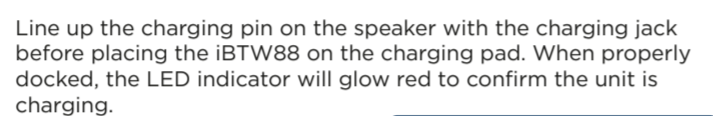

Line up the charging pin on the speaker with the charging jack before placing the iBTW88 on the charging pad. When properly docked, the LED indicator will glow red to confirm the unit is charging.

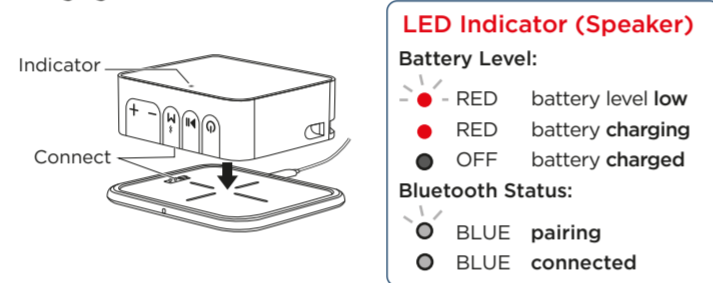

1

BLUETOOTH PAIRING

Pairing The First Time



Manual Pairing



PLAYING BLUETOOTH AUDIO



USING SPEAKERPHONE

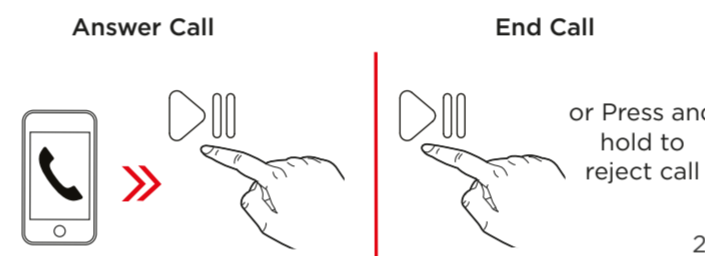

2

AUX-IN / RESET

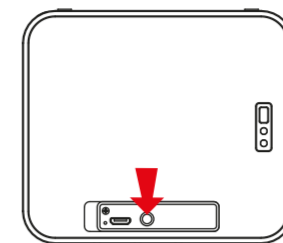

AUX-IN Audio
 Connect one end of a 3.5mm audio cable (not included) into the AUX-IN jack on the speaker, and the other end to the headphone jack of your audio device.

- * Press PLAY on your audio device to start playback.
- * Control/navigate tracks from your audio device, too.

Reset
 In the event of interrupted operation, use the extended tip of a paperclip or other thin tool to press in the Reset button (located inside the AUX-IN jack). Press the Power Button to turn back on.

3

Back

WATER-RESISTANT OPERATION

For proper water-resistant operation, make sure the cover on the back of the speaker is completely flush with the unit by pressing along the entire edge of the cover until it is completely and securely in place.

Note:
 Charging pad is NOT water-resistant.

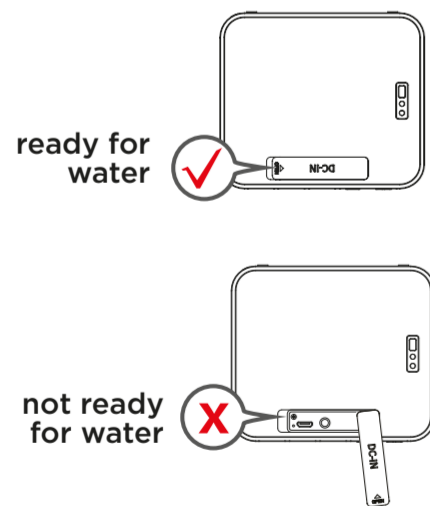

4

WIRELESS CHARGING PAD

How to Wirelessly Charge Your Device

Normal Charging - Use a 5V 2A USB AC adaptor.
Fast Charging - Use a 9V 1.67A USB AC adaptor.

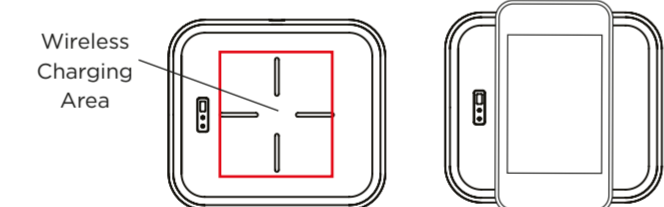

Place your smartphone face up on the wireless charging area as shown above. The LED indicator on the charging pad will glow red while your device charges, and will automatically shut off once your device is fully charged.

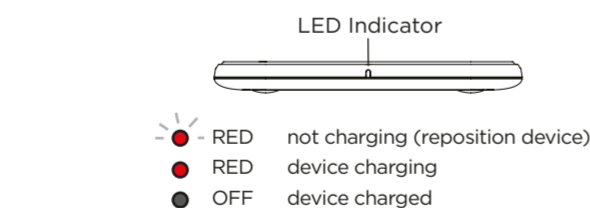

WARNING: Remove metal protective or magnetic case from phone before charging. When charging phone, do not place magnetic-stripped or other metal objects on the charger. Doing so could damage the object or this unit. Qi compatible phones with metallic looking finishes will charge normally.

Note: The wireless charging process generates heat that may cause phones and chargers to get warm to the touch. This is natural for wireless charging devices.

5

IMPORTANT SAFETY INSTRUCTIONS

- Please heed all warnings, read and follow all instructions and keep these instructions handy for future reference.
- Heat - The unit should be situated away from heat sources such as radiators, heat registers, stoves or other appliances (including amplifiers) that produce heat.
 - Only use attachments/accessories specified by the manufacturer. This product is suitable for use in tropical and/or moderate climates.
 - No naked flame sources, such as lighted candles, should be placed on the apparatus.
 - Do not use this apparatus near water.
 - Clean only with dry cloth.
 - Do not block any ventilation openings, install in accordance with the manufacturer's instructions.
 - This product should be serviced by qualified service personnel when the apparatus has been damaged in any way, such as power-supply cord or plug is damaged, liquid has been spilled or objects have fallen into the apparatus, the apparatus has been exposed to rain or moisture, does not operate normally, or has been dropped.

INTERNAL RECHARGEABLE LITHIUM-ION BATTERY

This device uses an internal rechargeable lithium-ion battery that should last the lifetime of the device. If you suspect your battery may be dead, try charging it several times.

- WARNING/DISPOSAL OF UNIT**
 Please do NOT attempt to change the battery yourself. Doing so may damage the unit and void the warranty. When disposing of unit, follow the disposal instructions below:
- Never dispose of used batteries/electronics with ordinary solid wastes, since they contain toxic substances.
 - Always dispose of used batteries/electronics in accordance with the prevailing community regulations that apply to the disposal of batteries/electronics. If there are no local regulations concerning battery/electronics disposal, please dispose of the device in a waste bin for electronic devices.
 - Many electronics retailers now recycle batteries and other electronic components at no charge. Check to see which ones in your area do so.

- CAUTION**
The battery used in this device may present a risk of fire, explosion or chemical burn if mistreated
- Never use or charge the battery if it appears to be leaking, discolored, deformed, or in any way abnormal.
 - Never disassemble the unit or attempt to remove battery as that could cause leakage of alkaline solution or other electrolytic substance.
 - Always confirm that the temperature is 5°C - 35°C (41° - 95° Fahrenheit) before you charge the battery. Leakage or deterioration of the battery may occur if this warning is not heeded.
 - Never expose the battery to any liquid.
 - Never expose the battery to excessive heat such as direct sunlight or fire. Never use the battery pack in an unventilated vehicle where excessive internal temperatures may be encountered.
 - Always keep the battery out of the reach of infants and small children.
 - Attention should be drawn to the environmental aspects of battery disposal.
 - CAUTION - Danger of explosion if battery is incorrectly replaced. Replace only with the same or equivalent type.

6

FCC INFORMATION

Model: iBTW88

FCC ID: EMOIBTW88
 IC: 9868-IBTW88

This equipment complies with FCC radiation exposure limits set forth for an uncontrolled environment. CAUTION: Exposure to Radio Frequency Radiation. This equipment should be installed and operated with a minimum distance of 20 cm between the radiator and your body.

This device complies with Part 15 of the FCC Rules, operation is subject to the following two conditions: (1) This device may not cause harmful interference, and (2) this device must accept any interference received, including interference that may cause undesired operation.

- Warning: Changes or modifications to this unit not expressly approved by the party responsible for compliance could void the user's authority to operate the equipment.
- NOTE: This equipment has been tested and found to comply with the limits for a Class B digital device, pursuant to Part 15 of the FCC Rules.

These limits are designed to provide reasonable protection against harmful interference in a residential installation. This equipment generates, uses and can radiate radio frequency energy and, if not installed and used in accordance with the instructions, may cause harmful interference to radio communications.

However, there is no guarantee that interference will not occur in a particular installation. If this equipment does cause harmful interference to radio or television reception, which can be determined by turning the equipment off and on, the user is encouraged to try to correct the interference by one or more of the following measures:

- Reorient or relocate the receiving antenna.
- Increase the separation between the equipment and receiver.
- Connect the equipment into an outlet on a circuit different from that to which the receiver is connected.
- Consult the dealer or an experienced radio/TV technician for help.

CAN ICES-3 (B)/NMB-3(B), CAN RSS216 / CNR-216

Canada Statement
 This device contains licence-exempt transmitter(s)/receiver(s) that comply with Innovation, Science and Economic Development Canada's licence-exempt RSS(s). Operation is subject to the following two conditions:
 (1) This device may not cause interference.
 (2) This device must accept any interference, including interference that may cause undesired operation of the device.

L'émetteur/récepteur exempt de licence contenu dans le présent appareil est conforme aux CNR d'Innovation, Sciences et Développement économique Canada applicables aux appareils radio exempts de licence. L'exploitation est autorisée aux deux conditions suivantes:

- L'appareil ne doit pas produire de brouillage;
- L'appareil doit accepter tout brouillage radioélectrique subi, même si le brouillage est susceptible d'en compromettre le fonctionnement.

The device meets the exemption from the routine evaluation limits in section 2.5 of RSS 102 and compliance with RSS-102 RF exposure, users can obtain Canadian information on RF exposure and compliance.

This equipment should be installed and operated with a minimum distance of 20 cm between the radiator and your body.

WARRANTY

For product support information and warranty please visit:
www.ihome.com/support

© 2019 SDI Technologies, Inc. All rights reserved
 Questions? Visit www.ihome.com
 or call 1-800-288-2792 Toll Free

iBTW88-190510-B

Printed in China

修正範圍
 May 10 2019

修正範圍
 May 10 2019