

## A wired computer mouse with a braided cable and a USB connector, shown with its packaging and a USB receiver. The mouse is black with a textured grip and a small square logo. The cable is braided and has a USB connector at the end. The packaging is a small, dark, rectangular box with a square logo. A USB receiver is also shown, which is a small, dark, rectangular device with a USB connector. The entire setup is displayed against a background of a large, stylized diamond shape in shades of red and orange.

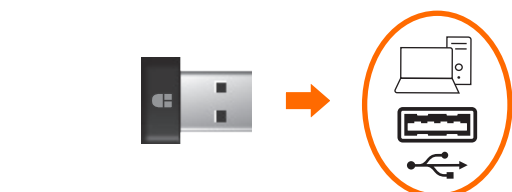

The diagram illustrates the connection of a USB cable to a USB adapter. It shows a USB cable with a standard USB-A connector on one end and a custom connector on the other. The custom connector is shown being inserted into a USB adapter. The adapter is then shown being plugged into a USB port on a device. The steps are numbered 1 and 2, with arrows indicating the direction of the connection.

PRINTER: Replace this box with Printed- In (PI) Statement(s) as per spec.  
NOTE: This box is simply a placeholder. PI Statement(s) do not have to fit inside the box but should be placed in this area.

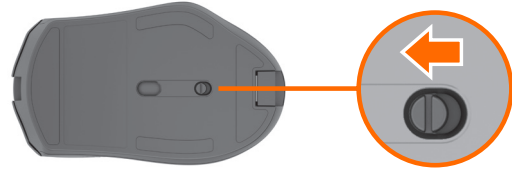
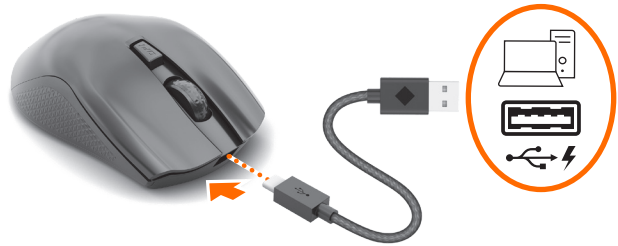

ENGLISH

ARABIC

BAHASA INDONESIA

ARABIC

BULGARIAN

CZECH

DANISH

GERMAN

INTERNATIONAL SPANISH

GREEK

FRENCH

CROATIAN

ITALIAN

KAZAKH

LATVIAN

For more information about programming the mouse, go to <http://www.hp.com/support> and follow the instructions to find your product. Then select **Manuals**.



