

English Version

Legion H410 Headset is a wireless gaming headset that supports Bluetooth and 2.4G dual mode and is equipped with a rotary silent microphone. It can be charged through the headset type C port, and has LED indication for pairing and charging instructions. The following is the general description and operation instructions.

Overview

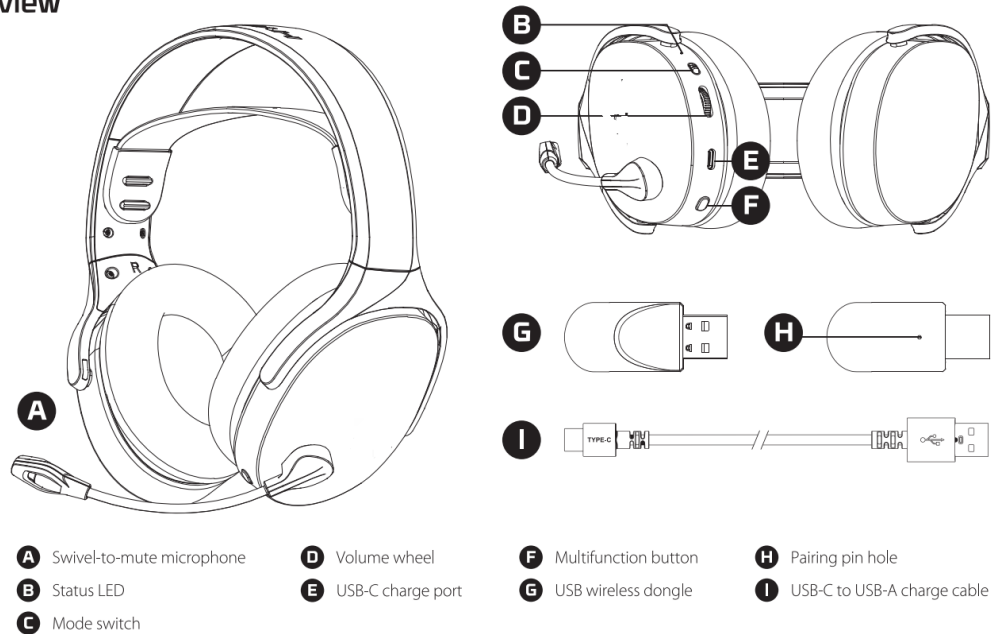

Usage method

2.4G Receiver mode

1. Slide the mode switch to  location
2. Connect the USB wireless receiver to your computer or game console.
3. Power on the headset.

Bluetooth mode

1. Slide the mode switch to  location. The headset will flash blue when first set up.
2. Go to your device's Bluetooth Settings page, search for and connect to "Legion H410 Gaming Headset"

Bluetooth pairing

1. Slide the mode switch to  mode. Turn off the headset.

2. Hold down the multifunction button for 5 seconds. When the LED flashes blue and the voice prompts "Bluetooth pairing", match The mode is active.
3. Go to your device's Bluetooth Settings page and connect to "Legion H410 Gaming Headset"

Windows 11

To ensure that the headset is configured correctly on your computer, follow below steps.

1. Right-click the sound icon in the system tray and select Sound Settings.
2. Set the output device as Legion H410 Gaming Headset(BT mode)

If it is 2.4G mode, it is a Legion H410 Gaming Headset Receiver.

3. Set the input device to the microphone Legion H410 Gaming Headset (BT mode).

If it is 2.4G mode, it is a Legion H410 Gaming Headset Receiver.

Status LED

STATUS	LED
Pairing	Adapter Mode: Blinking-fast white Bluetooth Mode: Blinking-fast blue
Searching	Adapter Mode: Blinking white Bluetooth Mode: Blinking blue
Connected	Adapter Mode: Solid white for 5s Bluetooth Mode: Solid blue for 5s
Low Battery	< 10%: Blinking red every 3s

Charging indication

NIVEAU DE CHARGE	LED Status
Charging completed	Solid Green
0%- 99%	Solid Red

Multifunction Button

- Power on/off - Hold button for 2 seconds to power headset on/off.
- Media controls:
 - o 1 x Play/Pause
 - o 2 x Play next song
 - o 3 x Play previous song

Volume Wheel

- Scroll up and down to adjust volume level.

Microphone

Microphone from the top 0 degrees down to 45 degrees between mute, when from 45 degrees down again to mute

When the bottom is about 135 degrees, it is in non-silent mode (there will be a prompt tone when switching between silent and non-silent)

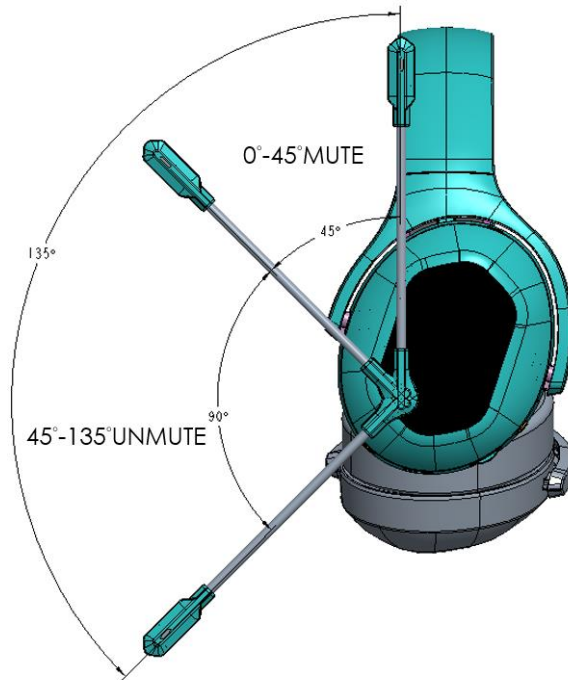

This equipment has been tested and found to comply with the limits for a Class B digital device, pursuant to Part 15 of the FCC Rules. These limits are designed to provide reasonable protection against harmful interference in a residential installation. This equipment generates, uses, and can radiate radio frequency energy and, if not installed and used in accordance with the instructions, may cause harmful interference to radio communications. However, there is no guarantee that interference will not occur in a particular installation. If this equipment does cause harmful interference to radio or television reception, which can be determined by turning the equipment off and on, the user is encouraged to try to correct the interference by one or more of the following measures:

- Reorient or relocate the receiving antenna.
- Increase the separation between the equipment and receiver.
- Connect the equipment into an outlet on a circuit different from that to which the receiver is connected.
- Consult an authorized dealer or service representative for help.

Lenovo is not responsible for any radio or television interference caused by using other than specified or recommended cables and connectors or by unauthorized changes or modifications to this equipment. Unauthorized changes or modifications could void the user's authority to operate the equipment.

This device complies with Part 15 of the FCC Rules. Operation is subject to the following two conditions: (1) this device may not cause harmful interference, and (2) this device must accept any interference received, including interference that may cause undesired operation.

This equipment complies with FCC radiation exposure limits set forth for an uncontrolled environment.

Responsible Party:

Lenovo (United States) Incorporated
7001 Development Drive
Morrisville, NC 27560
Email: FCC@lenovo.com



This device contains licence-exempt transmitter(s)/receiver(s) that comply with Innovation, Science and Economic Development Canada's licence-exempt RSS(s).

Operation is subject to the following two conditions:

(1) This device may not cause interference. (2) This device must accept any interference, including interference that may cause undesired operation of the device.

Le présent appareil est conforme aux CNR d'Industrie Canada applicables aux appareils radio exempts de licence. L'exploitation est autorisée aux deux conditions suivantes : (1) l'appareil ne doit pas produire de brouillage, et (2) l'utilisateur de l'appareil doit accepter tout brouillage radioélectrique subi, même si le brouillage est susceptible d'en compromettre le fonctionnement.

This equipment complies with ISED radiation exposure limits set forth for an uncontrolled environment.

Cet équipement est conforme aux limites d' exposition aux rayonnements IC établies pour un environnement non contrôlé.