

HeadUnit Owner's Manual

Model: JBLJAM3000

Brand: JBL

Table of Contents

Wiring the stereo.....	pg. 2
Mounting the stereo.....	pg. 2
General button operation.....	pg. 3
System setup.....	pg. 4
Adjusting the brightness.....	pg. 6
Selecting sources.....	pg. 6
AM/FM tuner/Weather Band operation.....	pg. 8
Bluetooth operation.....	pg. 10
USB operation.....	pg. 12
Selecting the camera view.....	pg. 15
Specifications.....	pg. 15
Warnings.....	pg. 16

WIRING THE STEREO

IMPORTANT: Disconnect the vehicle's negative (-) battery terminal before beginning the installation.

1. Plug the vehicle harness into the connectors on the back of the stereo.

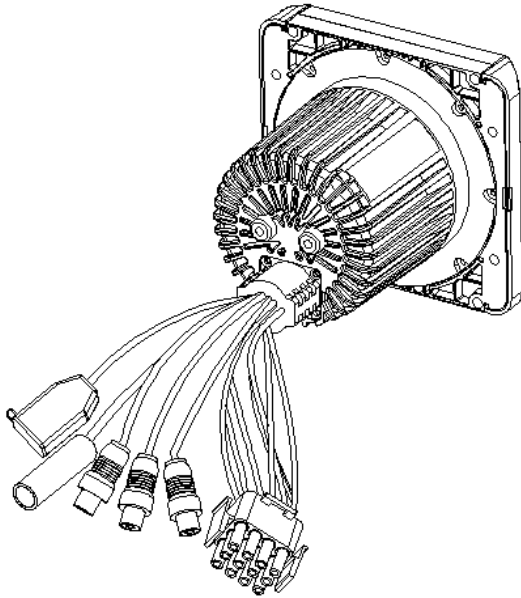

MOUNTING THE STEREO

You can choose either one mounting method shows below:

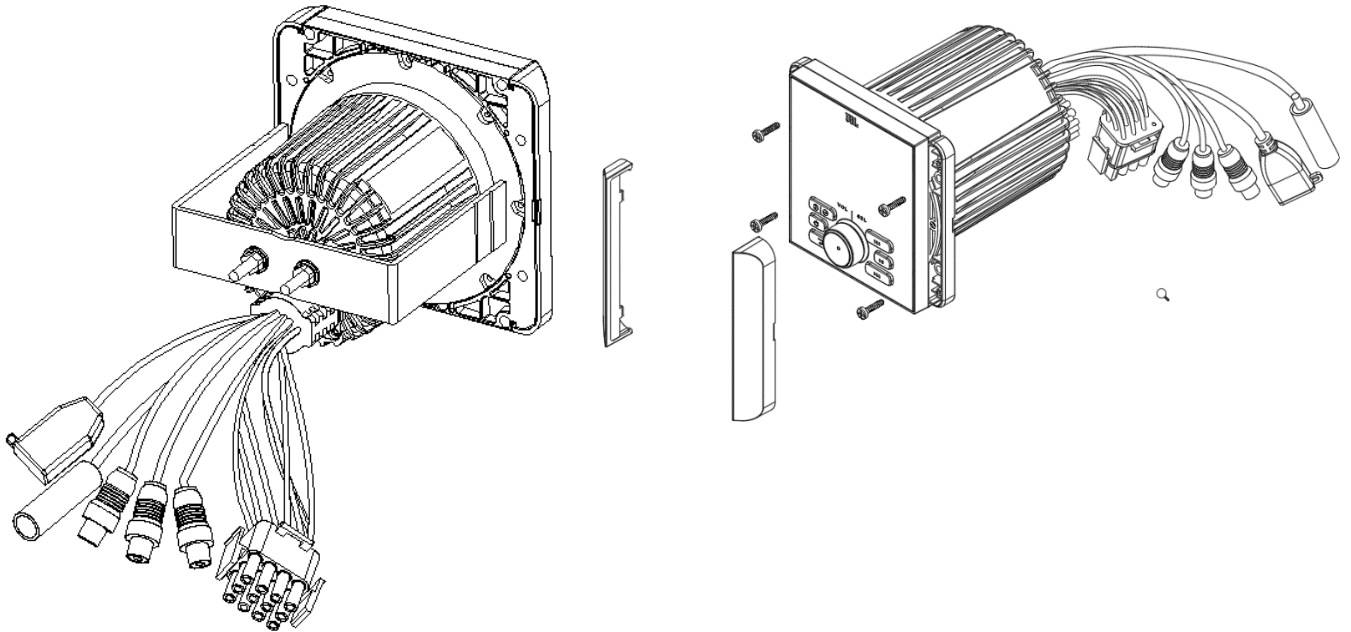

GENERAL BUTTON OPERATION

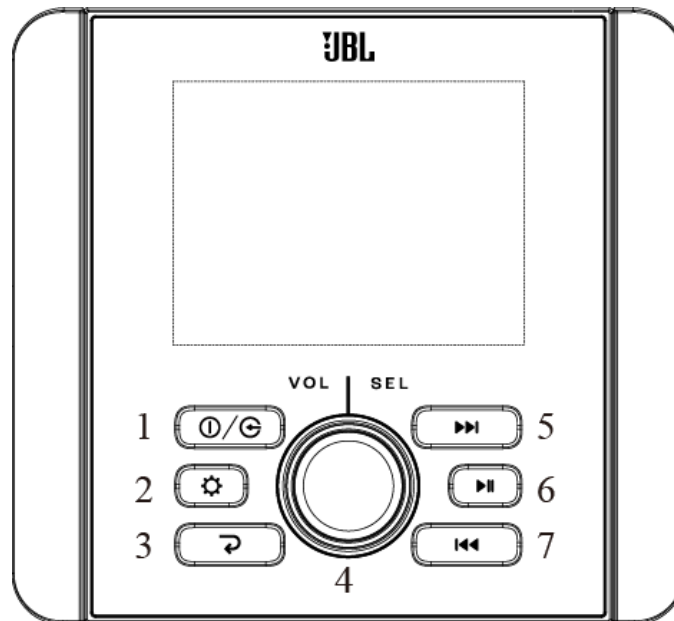

- 1. Power/SRC:** Press for the first time to turn the unit on. Press and hold for more than 3 seconds to turn the unit off. With unit powered on, short repeat press to switch mode in following sequence: FM1 → FM2 → AM → BT → USB → FM1.....
- 2. Setup:** In Radio mode, short press to scan listening to the preset stations. Long press it to auto store 6 stations in each band in sequence by signal strength. After Auto Store is completed, it will auto scan every preset for 6s in sequence.
In USB mode, press it repeatedly to select between Repeat one, Repeat Folder, Random Folder, Random all, Intro Scan. Long press it to enter Track Number search mode. Turn SEL knob and press to set value of track number, then press and hold SEL for 2s to confirm the selection.
- 3. Return:** In selection station, press it to back to source playing screen.
- 4. Volume/enter:** Turn the knob to raise or lower the volume, or to highlight desired control menu options.
Press the SEL knob to enter 1st setting menu, then press it repeatedly to display features in following sequence: VOL → BASS → TREBLE → BALANCE → FADER → EQ → LOUD → SUBW → VOL.....
Press and hold SEL knob for over 2s to enter 2nd setting menu, then press it repeatedly to display features in following sequence: I-VOL → BT VOL → BRIGHTNESS → AREA → BEEP → ABOUT Sys Infor → RESET → I-VOL.....
On each setting, the level can be controlled by turning SEL knob. When the last adjustment is made, the display will automatically return to the original mode after 5 seconds, or you can press Return button to return the original mode quickly.
- 5. NEXT:** In Radio mode, press it to work as Auto Seek. Press and hold it to activate Manual Seek, then press it repeatedly to seek by step. (it will revert to auto seek status if you do not press this button within 5s after Manual Seek is activated.)
In BT Music or USB mode, press it to select the next track.

In USB mode, press and hold it to fast forward.

6. **PLAY/PAUSE:** In Radio mode, press it to MUTE sound output.

In BT Music or USB mode, press it to Pause playback; press it again to resume playback.

In USB mode, long press PLAY/PAUSE button to enter USB files folder list.

7. **PREVIOUS:** In Radio mode, press it to work as Auto Seek. Press and hold it to activate Manual Seek, then press it repeatedly to seek by step. (it will revert to auto seek status if you do not press this button within 5s after Manual Seek is activated.)

In BT Music or USB mode, press it to select the previous track.

In USB mode, press and hold it to fast rewind.

SYSTEM SETUP

Press the SEL knob to enter 1st setting menu, then press it repeatedly to display features in following sequence: VOL → BASS → TREBLE → BALANCE → FADER → EQ → LOUD → SUBW → VOL.....

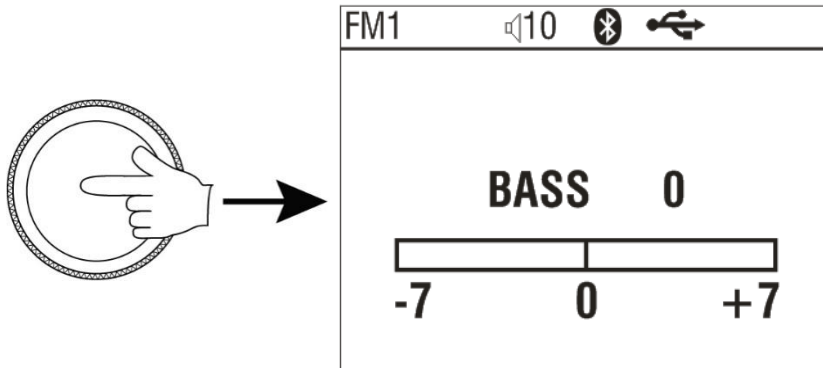

1st setting options:

Bass: -7dB – +7dB

Treble: -7dB – +7dB

Balance: Left 10 – Right 10 (default: 0)

Fader: Front 10 – Rear 10 (default: 0)

Preset EQ: OFF, FLAT, CLASSIC, POP, ROCK

Loud: On/Off

Note: with EQ activated, Bass and Treble will not be displayed

Press and hold SEL knob for over 2s to enter 2nd setting menu, then press it repeatedly to display features in following sequence: I-VOL → BT VOL → BRIGHTNESS → AREA → BEEP → ABOUT Sys Infor → RESET → I-VOL.....

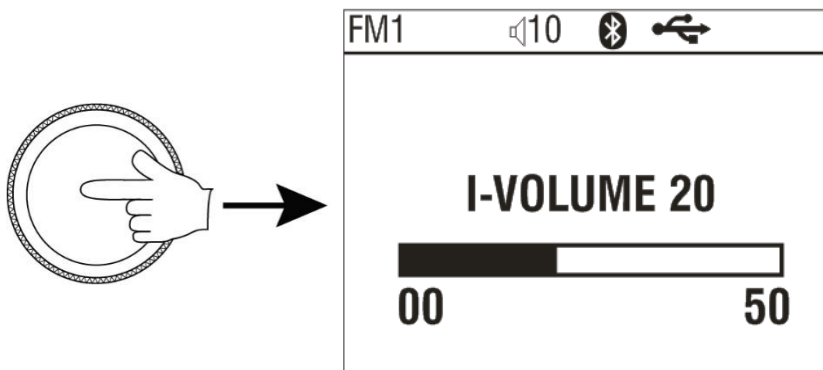

2nd setting options:

I-Volume: 0 – 50 (default at 20)

~~BT Volume:~~ ~~0 – 50 (default at 30)~~

Brightness: 0 – 10 (default at 5)

Area: USA, EUROPE, JAPAN, AUSTRALIA

Beep: 2nd/On/Off

About Sys Infor: SW version display

Reset: No/Yes (With Reset displayed, turn VOL knob to highlight at YES, then press and hold SEL knob for about 5s to reset the system.)

FM/AM TUNER OPERATION

Tuning stations

- Repeat short press >>| or |<< button to tune the frequency step by step.
- Long press >>| or |<< button for over 2s results in auto search of the next or previous station of strong signal.

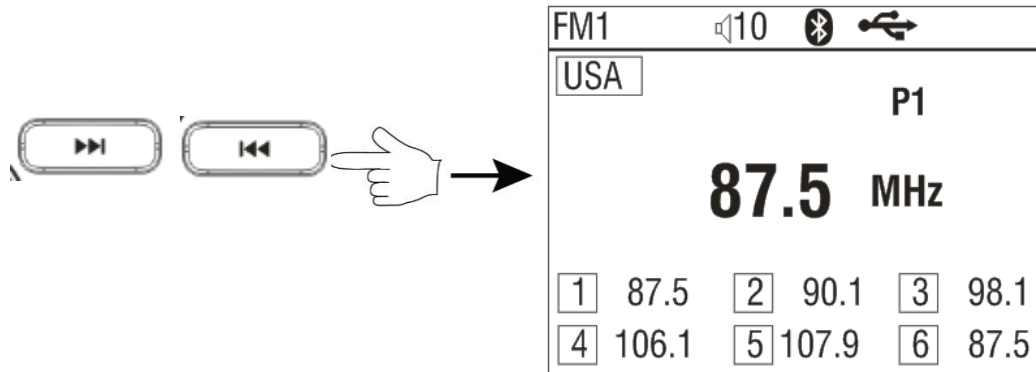

Auto Preset / Presets Scan

- In Radio mode, press Setup button (2) momentarily, it will scan listening to each preset station for 6 seconds. **Short press it again to stop scanning.**
- Long press it to auto store 6 stations in each band in sequence by signal strength. After Auto Store is completed, it will auto scan every preset for 6s in sequence.

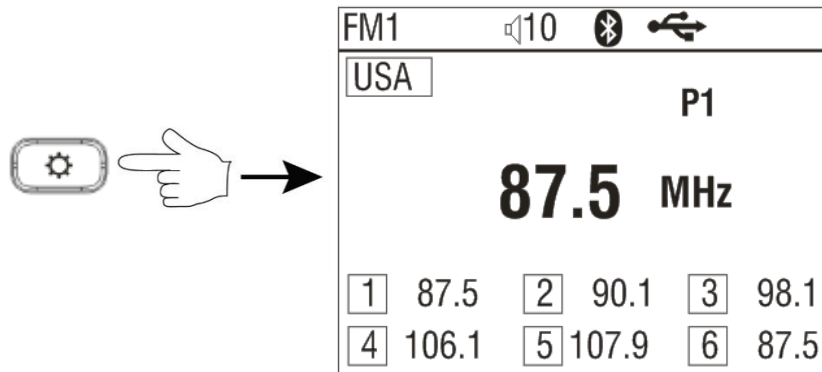

Manual Preset / Presets Recall

- To manually store a preset, first manual tune to a station, press and hold >|| button (6) to activate Manual Preset (Preset #1 is now highlighted, then press >>| or |<< button (5/7) to select a preset number, then preset and hold SEL knob (4) for over 2 seconds to store the frequency in that preset.
- To recall a preset station, press and hold >|| button (6) to activate Manual Preset first, then press >>| or |<< button (5/7) to select a preset number, press SEL knob (4) momentarily to recall the station in that preset.
- Press Return button (3) or long press >|| button (6) to exit Manual Preset status.

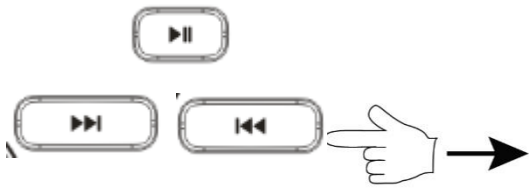

FM1 🔊10 📶 🔌

USA P1

90.1 MHz

1	87.5	2	90.1	3	98.1
4	106.1	5	107.9	6	87.5

BLUETOOTH OPERATION

Pairing a Bluetooth device

1. Bluetooth as the source on the stereo.
2. Find and select "JBLJAM3000" in the list of available sources in your phone's Bluetooth pairing menu.

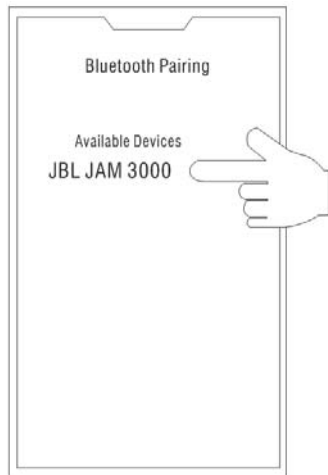

Selecting tracks

Press >>| or |<< button to select the next or previous track.

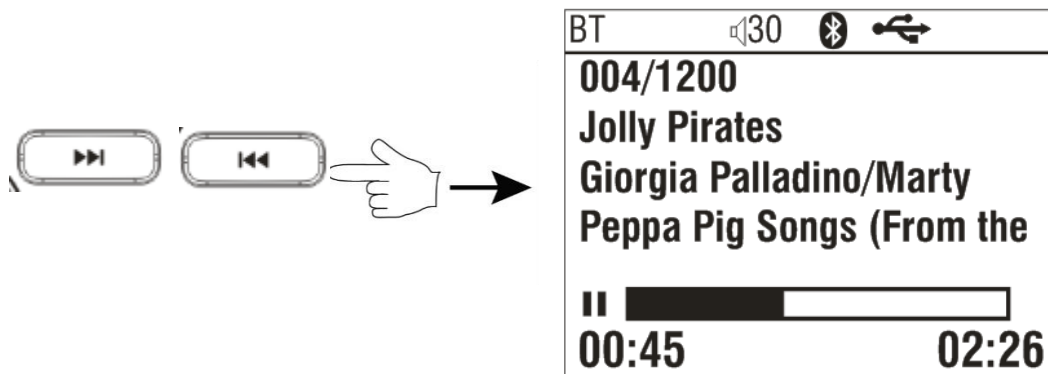

Pausing playback

While playing track, you can pause the track by press >|| button (6), then press again to resume to playback status.

Connecting or disconnecting a device

In BT Music mode, press and hold SEL knob (4) for over 2s, it will display the Device List and highlighted at current connected device. To disconnect the device, press and hold the SEL knob within 5s

To connect or delete the device, press and hold SEL knob to show the Device List first, then turn the knob to move highlight to desired device, then press and hold the knob again to show Connect or Delete, turn the knob and press it to confirm selection.

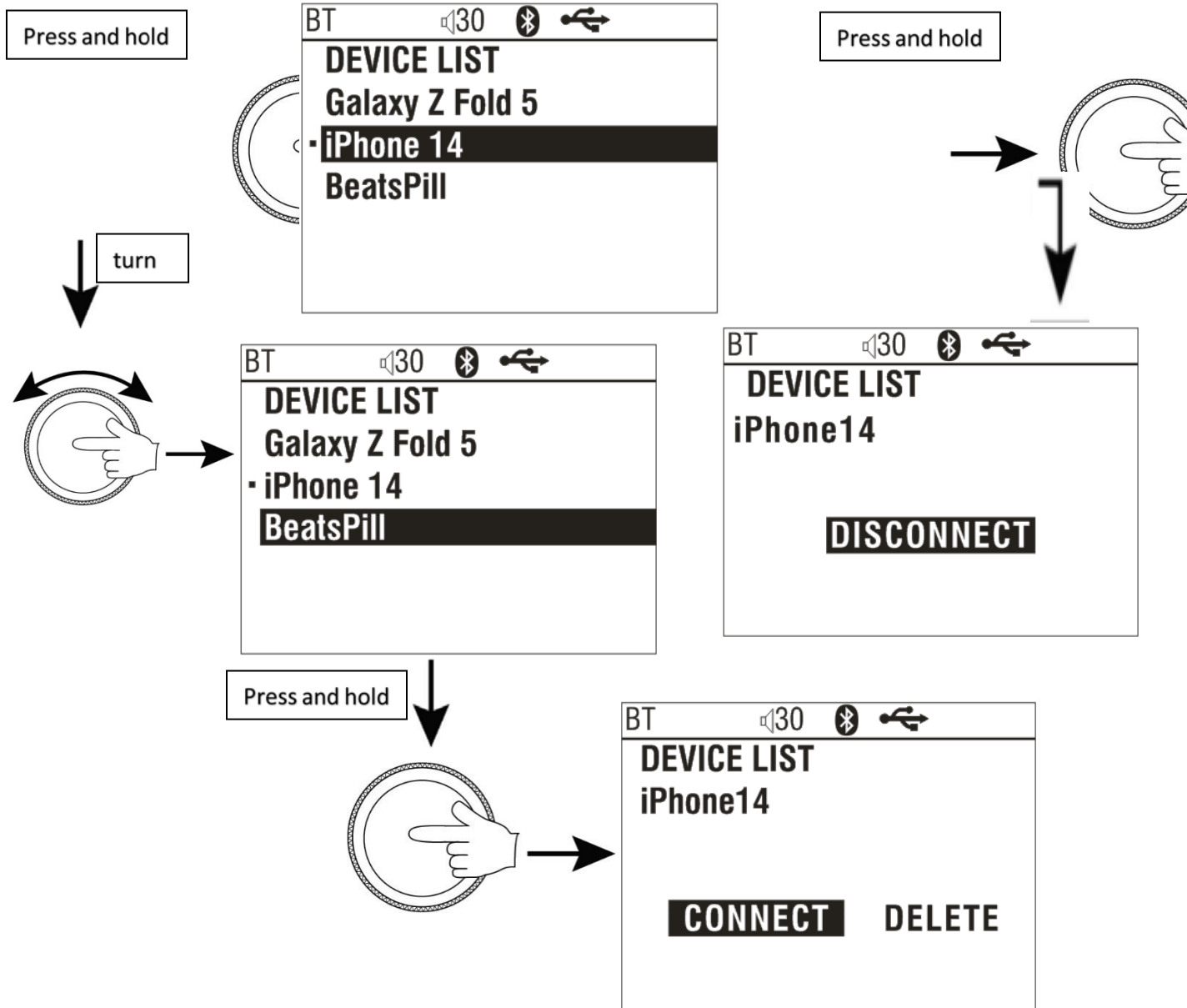

USB OPERATION

Connecting a USB device

Plug a USB drive into the USB slot. It will auto begin to read the tracks in the device.

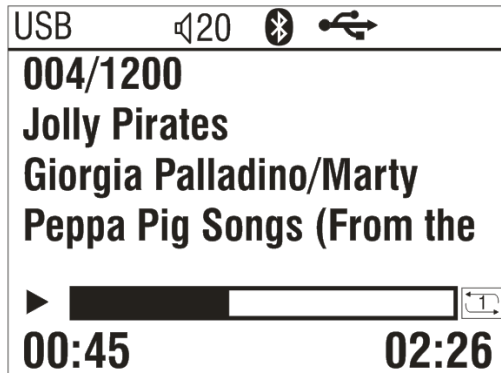

Play Mode Select / File Search

1. While USB playing, press Setup button (2) repeatedly to select between Repeat one, Repeat Folder, Random Folder, Random all, Intro Scan.

Playback mode options:

Repeat:

1. ONE (one track)
2. FOLDER (all tracks in one folder)

Random:

1. ALL (all tracks on the USB device)
2. FOLDER (all tracks in one folder)

INTRO: Plays a brief sample of the beginning of each song on the USB device

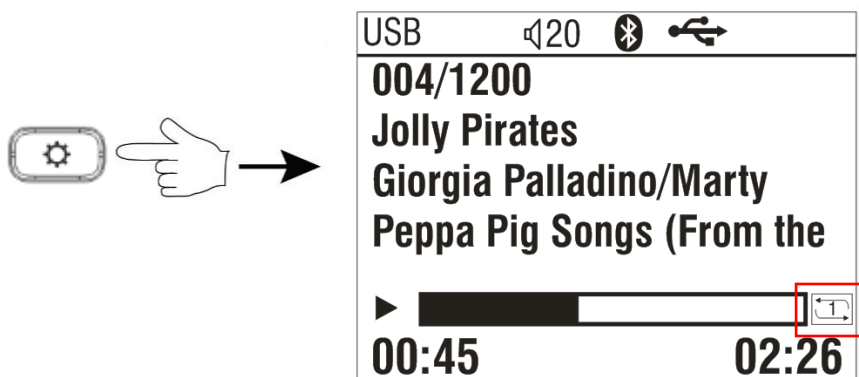

The small icon shows the playback mode.

2. Long press it to enter Track Number search mode. Turn SEL knob and press to set value of track number, then press and hold SEL for 2s to confirm the selection.

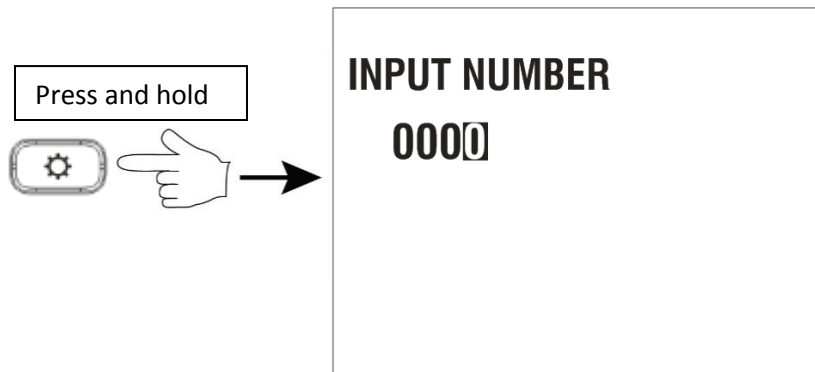

Navigating tracks

1. Press the PREVIOUS and NEXT buttons to restart the current track, select a previous track, or jump to the next track.
2. Press and hold the PREVIOUS and NEXT buttons to rewind or fast-forward a track.

Note: If the current playing track elapsed time is less than 5 seconds, then press Previous button to select previous track.

If the track elapsed time is over 5 seconds, then press Previous the first time will result in back to the beginning of current track, press it again within 5seconds to select previous track.

Pausing playback

1. Press the PLAY/PAUSE button to pause or resume playing a track.
2. Press and hold the PLAY/PAUSE button to enter files folder list. Turn SEL knob to find desired fold/file and press to confirm selection.

SPECIFICATIONS

Tuner bands	AM/FM
AM Band for USA	530 - 1710kHz (10kHz STEP)
AM Band for Europe	522 - 1620kHz (9kHz STEP)
AM Band for Japan	522 - 1629 KHZ (9kHz STEP)
AM Band for Australia	531 – 1629 kHz (9kHz STEP)
FM Band for USA	87.5 – 107.9MHz (0.2MHz STEP)
FM Band for Europe	87.50 - 108.00MHz (0.05MHz STEP)
FM Band for Japan	76.0 - 95.0 MHz (0.1MHz STEP)
FM Band for Australia	87.5 – 108.0 MHz (0.05MHz STEP)
Number of station presets	18
Bluetooth version	5.3
Bluetooth A2DP protocol	Yes
Bluetooth AVRCP	V1.5
BT Max Power	≤ 10 dBm
Bluetooth transmitter frequency range	2402 MHz - 2480 MHz
Serial Port Profile (SPP)	Yes
Simple Secure Pairing (SSP)	Yes
Number of paired phones	5
Bluetooth auto reconnect	Yes (most recently paired phone)
Compatible media file formats	MP3, AAC (on Apple devices), WMA, WAV, M4A
Maximum number of files on USB device	9999
RMS Power Output (Watts x Channel) @ 4-ohm	Low distortion power 15W x 4 / High distortion power 25W x 4
Frequency Response, +/- 3dB	20Hz to 20kHz
Signal-to-Noise Ratio	>75dB
THD+N @ 4-ohm (amplifier)	30%
THD+N @ 2.1Vrms (RCA outputs)	10%
Operating voltage	9V – 16V
Quiescent current	<0.2mA
Max.operation temperature	70°C