

QUICK START GUIDE

TUNE 135BT



WHAT'S IN THE BOX



S/M/L



SCAN ME

APP



JBL HEADPHONES

GET IT ON
Google Play

Download on the
App Store



Get even more control and personalization of your listening experience with this free app.

HOW TO WEAR



1 Try different sizes for a perfect fit and audio performance.



S/M/L

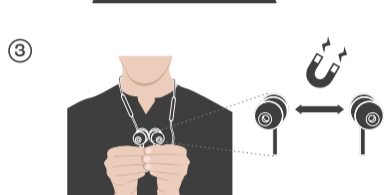

POWER ON & CONNECT

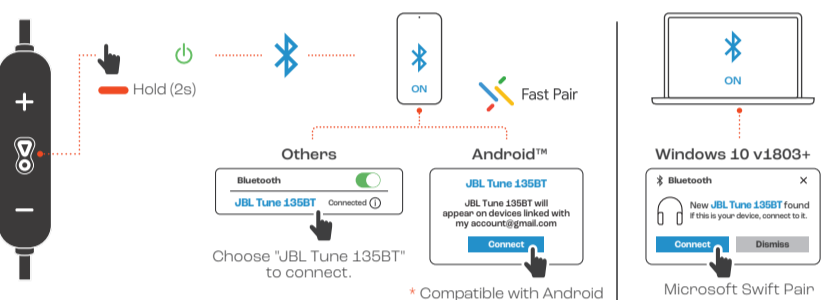

MULTI-POINT CONNECTION

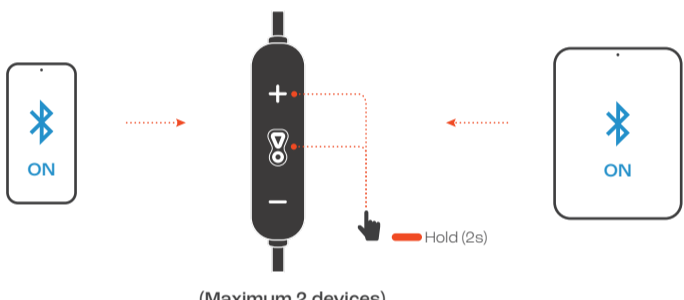

CONTROLS

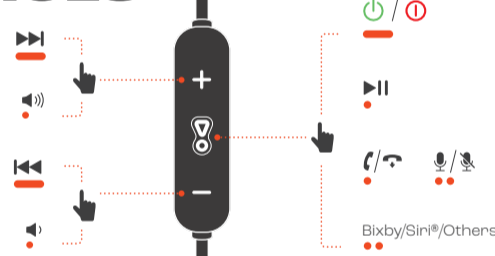

• Press x 1 •• Press x 2 — Hold (2s)
* Enable advance controls by connecting your JBL TUNE 135BT to JBL Headphones app

FACTORY RESET

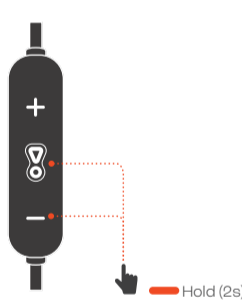

DO MORE WITH THE APP

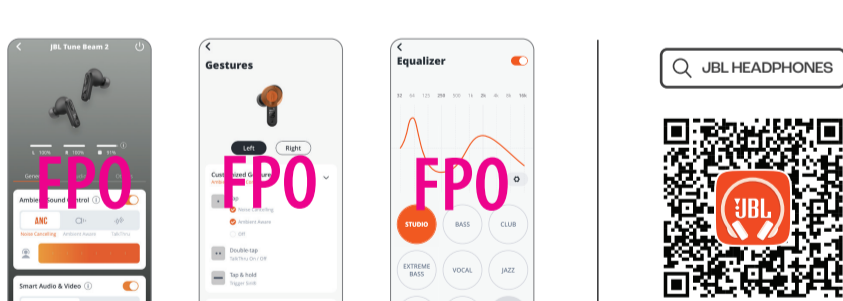

CHARGING

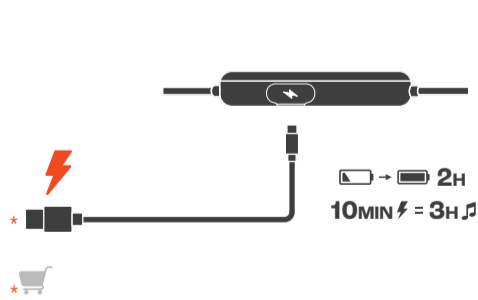

LED BEHAVIORS

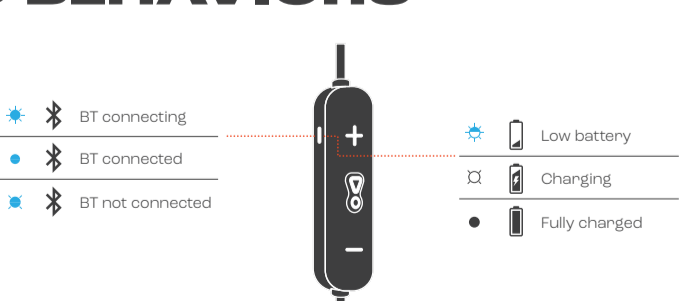

TECH SPEC

Model:	TUNE 135BT	Sensitivity:	110 dB SPL@1 kHz
Driver size:	8.6 mm / 0.34" Dynamic Driver	Maximum SPL:	95 dB
Power supply:	5V == 1 A	Microphone sensitivity:	-42 dBV/Pa@1 kHz
Weight:	18.00 g / 0.0397 lbs	Bluetooth version:	5.4
Battery type:	Li-Ion battery (130 mAh / 3.7V)	Bluetooth profile version:	A2DP V1.4, AVRCP V1.6.2, HFP V1.8
Charging time:	2 hrs from empty	Bluetooth transmitter frequency range:	2.402 GHz - 2.48 GHz
Music playtime with BT on:	Up to 25 hrs	Bluetooth transmitter power:	xx dBm (ERP)
Talk time:	Up to 18 hrs	Bluetooth transmitter modulation:	GFSK, π/4DQPSK, 8DPSK
Frequency response:	20 Hz - 20 kHz	Maximum operation temperature:	45 °C
Impedance:	20 ohm		

