

harman/kardon®
by HARMAN

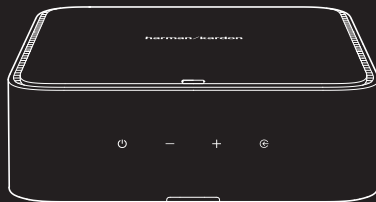

CITATION AMP

1 APP



Google Home

Download the Google Home app and set up your Citation Amp.



AirPlay setup

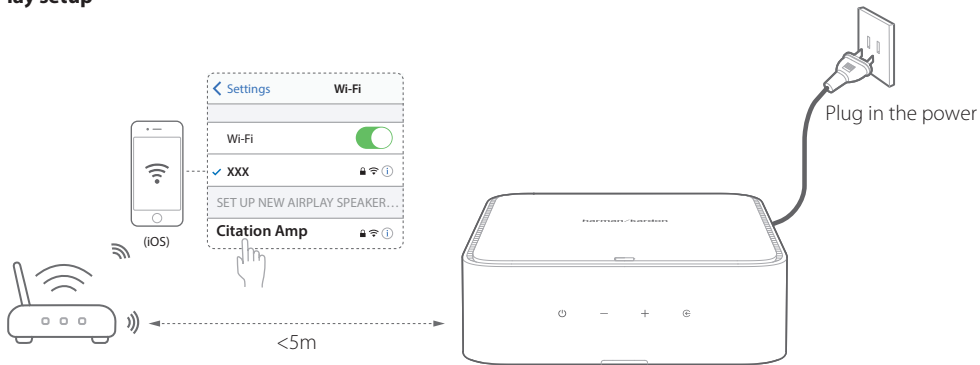

For AirPlay 2 only users, skip the Google Home app; on your iOS device, go to **Settings > Wi-Fi** and select "Citation Amp" under **SET UP NEW AIRPLAY SPEAKER ...** Follow the onscreen instructions to complete setup.

Chromecast and Bluetooth will require additional setup with the Google Home app.

2 PRODUCT TOUR

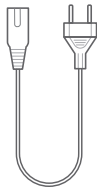
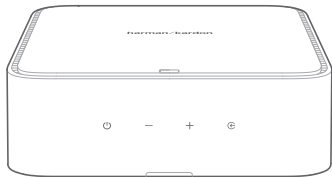

Regional power cord
(varies depending on country)

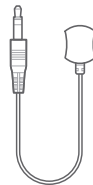

IR extender

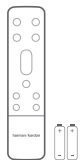

Remote control

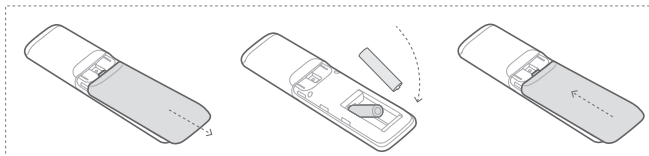

Top & Front

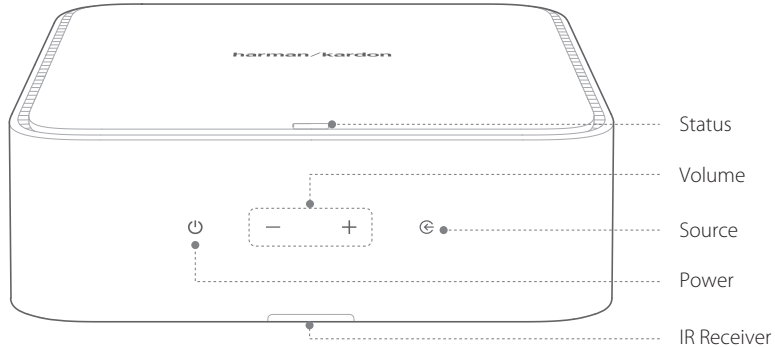

Back

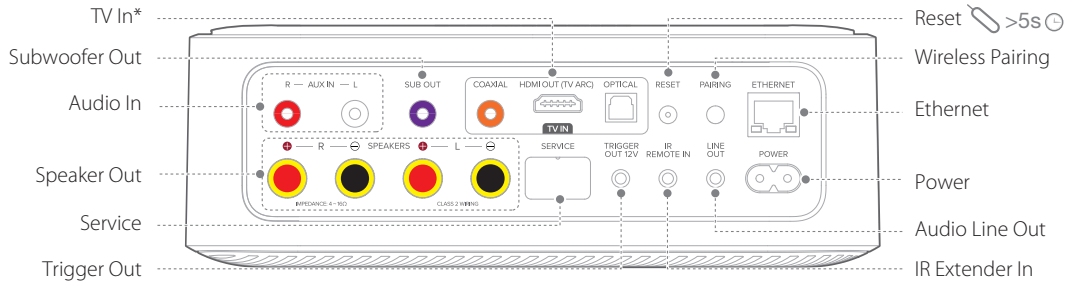

* Only one cable should connect to TV In. Choose your preferred digital audio connection: HDMI ARC, Optical or Coaxial.

3 CONNECT SPEAKERS

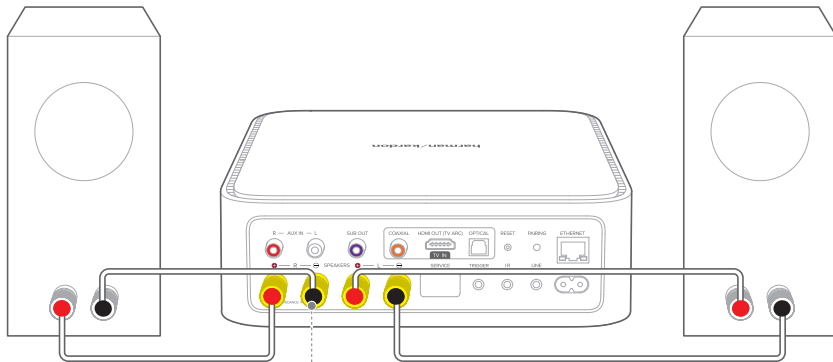

Option 1

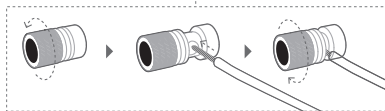

Option 2



4 CONNECT TO YOUR TV

Only one cable should connect to TV in. Choose your preferred digital audio connection: HDMI ARC, Optical or Coaxial.

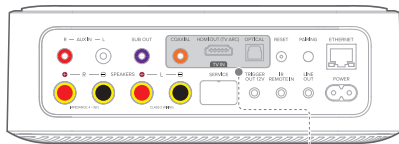

Option 1 (Best): HDMI



Option 2: OPTICAL



Option 3: COAX



5 CONNECT IR EXTENDER (OPTIONAL)

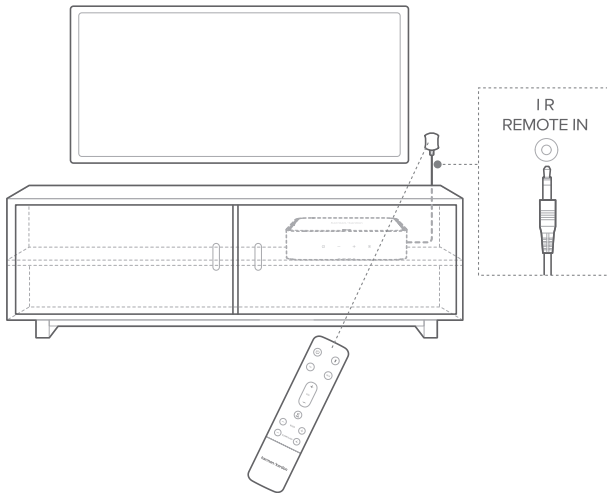

6 GET STARTED

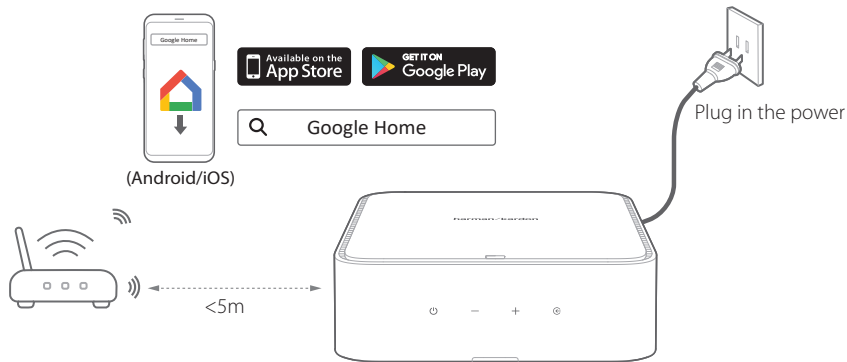

Add Citation Amp to your home Wi-Fi network:

Download and run the Google Home app on a phone or tablet.

Follow the instructions on the touch screen and Google Home app to finish the setup.

* Enable Bluetooth (iPhone / iPad)

7 WIRELESS PAIRING

Add a wireless subwoofer for deep bass.
Add wireless surround speakers for home theater.

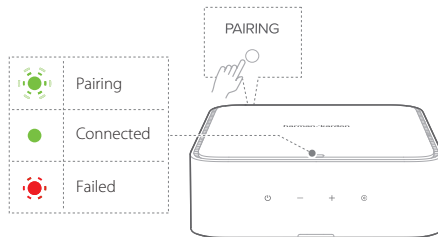
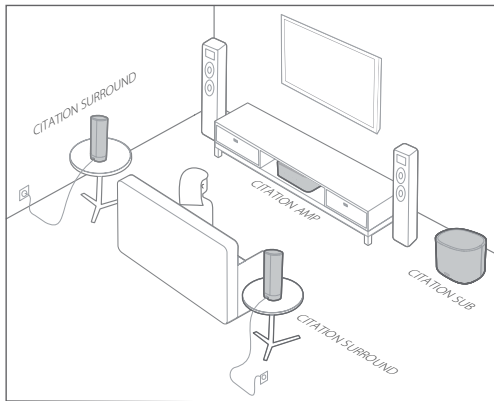

Works with:

- Harman Kardon Citation Sub
- Harman Kardon Citation Sub S
- Harman Kardon Citation Surround

Sold separately. See manual for details.

8 CHROMECAST

Step 1: Open a Chromecast-supported app

Step 2: Play Music

Step 3: Tap the cast icon and select “Citation Amp”

e.g.

Spotify

Pandora

TuneIn

Deezer

Google Play Music

* The device supports multi-room control provided by Chromecast built-in. See Google Home app for more details.



9 AirPlay

Step 1: On an iOS device, enter the Control Center.

Step 2: Tap  to select "Citation Amp" as speaker.

Step 3: Start audio streaming from an app.

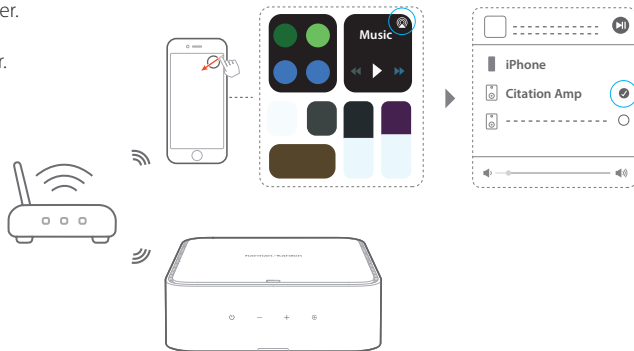

10 BLUETOOTH

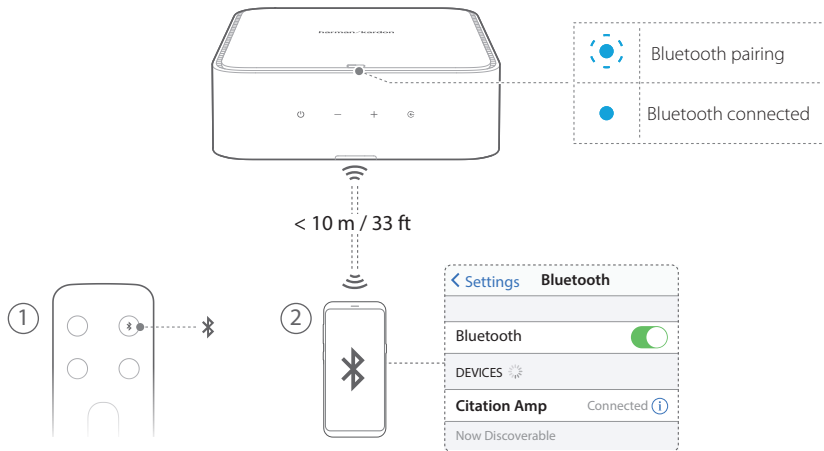

11 ADVANCED SETTINGS/OWNER'S MANUAL

See the Owner's Manual available at harmankardon.com for more details about advanced settings, including: Bass/Treble EQ, Subwoofer Crossover Frequency, Audio Sync, Surround Channel Level, Dual Mono Mode, and Maximum Volume Level.

12 SPECIFICATIONS

- Model Name: Citation Amp
- Output Power: 125 W RMS per channel (8 Ohms, 20 - 20 kHz, 0.05% THD + N)
- Minimum Impedance: 4 Ohms
- Total Harmonic Distortion (THD + N): 0.05%
- Frequency Response: 20 Hz - 20 kHz +/- 1dB
- Audio inputs: Aux, Bluetooth, TV In (HDMI ARC, Optical or Coax. TV in supports one connection at a time)
- Audio Output: 1 Aux (2 V)
- Other Connections: Ethernet, IR Remote Input, 12 V trigger output
- Bluetooth version: 4.2
- Bluetooth Frequency Range: 2402 MHz – 2480 MHz
- Bluetooth Max Transmitting power: 10 dBm (EIRP)
- Bluetooth Transmitter modulation: GFSK, $\pi/4$ DQPSK, 8DPSK
- Wi-Fi network compatibility: 802.11 a/b/g/n/ac
- 2.4G Wi-Fi Frequency Range: 2412 - 2472 MHz (2.4G Hz ISM Band, USA 11 Channels, Europe and others 13 Channels)
- 2.4G Max Transmitting power: 20 dBm (EIRP)
- 2.4G Wi-Fi modulation: DBPSK, DQPSK, CCK, QPSK, BPSK, 16QAM, 64QAM

- 5G Wi-Fi maximum transmitter power: 23 dBm (EIRP)
- 5G Wi-Fi modulation: QPSK, BPSK, 16QAM, 64QAM, 256QAM
- 5G Wi-Fi transmitter frequency range: 5.15 ~ 5.35 GHz, 5.470 ~ 5.725 GHz, 5.725 ~ 5.825 GHz
- 5G WiSA maximum transmitter power: 14 dBm (EIRP)
- 5G WiSA modulation: OFDM, BPSK, QPSK, 16QAM
- 5G WiSA transmitter frequency range: 5.15 ~ 5.35 GHz, 5.470 ~ 5.725 GHz, 5.725 ~ 5.825 GHz
- Power Supply: 100 - 240 V ~ 50/60 Hz
- Power Consumption: 125 W
- Dimensions (W x H x D): 8.5" x 3" x 9" (215 x 75 x 230 mm)
- Weight: 5.18 lb (2.35 kg)

1. Information on power consumption.

This equipment complies with European Commission Regulation (EC) No 1275/2008 and (EU) No 801/2013.

Networked standby: 2.0 W

2. The period of time after which the power management function switches the equipment automatically into; the device shall enter 2.0 W networked Standby automatically in 20 minutes.

How to activate wireless network connections;

- Set up product according to instruction
- Switch into wireless mode (Bluetooth, Wi-Fi)
- Connect with energy using product(s)

How to deactivate wireless network connections;

- The device is intended for use in wireless connections, it is inappropriate to deactivate any wireless connections.

This device complies with Part 15 of the FCC rules and Industry Canada license-exempt RSS standard(s). Operation is subject to the following two conditions: (1) this device may not cause harmful interference, and (2) this device must accept any interference received, including interference that may cause undesired operation. CAN ICES-3 (B) / NMB-3 (B).

IC Caution:

User should also be advised that:

(i) the device for operation in the band 5150 - 5250 MHz is only for indoor use to reduce the potential for harmful interference to co-channel mobile satellite systems;

(ii) the maximum antenna gain permitted for devices in the bands 5250 - 5350 MHz and 5470 - 5725 MHz shall comply with the e.i.r.p. limit: and

(iii) the maximum antenna gain permitted for devices in the band 5725 - 5825 MHz shall comply with the e.i.r.p. limits specified for point-to-point and non point-to-point operation as appropriate.

(iv) Users should also be advised that high-power radars are allocated as primary users (i.e. priority users) of the bands 5250 - 5350 MHz and 5650 - 5850 MHz and that these radars could cause interference and/or damage to LE-LAN devices.

Les utilisateurs devraient aussi être avisés que

(i) les dispositifs fonctionnant dans la bande 5150 - 5250 MHz sont réservés uniquement pour une utilisation à l'intérieur afin de réduire

les risques de brouillage préjudiciable aux systèmes de satellites mobiles utilisant les mêmes canaux;

(ii) le gain maximal d'antenne permis pour les dispositifs utilisant les bandes 5250 - 5350 MHz et 5470 - 5725 MHz doit se conformer à la limite de p.i.r.e.;

(iii) le gain maximal d'antenne permis (pour les dispositifs utilisant la bande 5725 - 5825 MHz) doit se conformer à la limite de p.i.r.e. spécifiée pour l'exploitation point à point et non point à point, selon le cas. De plus, les utilisateurs de radars de haute puissance sont désignés utilisateurs principaux (c.-à-d., qu'ils ont la priorité) pour les bandes 5250 - 5350 MHz et 5650 - 5850 MHz et que ces radars pourraient causer du brouillage et/ou des dommages aux dispositifs LAN-EL.

Warning: Changes or modifications to this unit not expressly approved by the party responsible for compliance could void the user's authority to operate the equipment.

NOTE: This equipment has been tested and found to comply with the limits for a Class B digital device, pursuant to Part 15 of the FCC Rules. These limits are designed to provide reasonable protection against harmful interference in a residential installation. This equipment generates, uses and can radiate radio frequency energy and, if not installed and used in accordance with the instructions, may cause harmful interference to radio communications.

However, there is no guarantee that interference will not occur in a particular installation. If this equipment does cause harmful

interference to radio or television reception, which can be determined by turning the equipment off and on, the user is encouraged to try to correct the interference by one or more of the following measures:

- Reorient or relocate the receiving antenna.
- Increase the separation between the equipment and receiver.
- Connect the equipment into an outlet on a circuit different from that to which the receiver is connected.
- Consult the dealer or an experienced radio/TV technician for help.

High power radars are allocated as primary users of the 5.25 to 5.35 GHz and 5.65 to 5.85 GHz bands. These radar stations can cause interference with and/or damage this device. No configuration controls are provided for this wireless equipment allowing any change in the frequency of operations outside the FCC grant of authorization for US operation according to Part 15.407 of the FCC rules.

FCC/IC Radiation Exposure Statement: This equipment complies with FCC/IC RSS-102 radiation exposure limits set forth for an uncontrolled environment. This equipment should be installed and operated with minimum distance 20cm between the radiator and your body.

Cet équipement est conforme aux limites d'exposition aux radiations FCC/ IC CNR-102 établies pour un environnement non contrôlé. Cet équipement doit être installé et utilisé avec une distance minimale de 20 cm entre le radiateur et votre corps.

해당 무선설비는 운용중 전파혼신 가능성이 있으므로 인명 안전과 관련된 서비스는 할 수 없습니다.

Use Restriction: This device is restricted to indoor use when operating in the 5150 to 5350 MHz frequency range in following countries:

BE	EL	LT	PT
BG	ES	LU	RO
CZ	FR	HU	SI
DK	HR	MT	SK
DE	IT	NL	FI
EE	CY	AT	SE
IE	LV	PL	UK

Belgium (BE), Greece (EL), Lithuania (LT), Portugal (PT), Bulgaria (BG), Spain (ES), Luxembourg (LU), Romania (RO), Czech Republic (CZ), France (FR), Hungary (HU), Slovenia (SI), Denmark (DK), Croatia (HR), Malta (MT), Slovakia (SK), Germany (DE), Italy (IT), Netherlands (NL), Finland (FI), Estonia (EE), Cyprus (CY), Austria (AT), Sweden (SE), Ireland (IE), Latvia (LV), Poland (PL) and United Kingdom (UK).

This product contains open source software. For your convenience, the source code and relevant build instruction for software licensed under the GPL is available at <http://www.harmanardon.com/opensource>. You may also obtain this information by contacting us at OpenSourceSupport@Harman.com

DA

1 APP

Opsætning af Google Assistant

Download Google Home-appen og opsæt din Citation AMP 250.

Opsætning af AirPlay

Kun til AirPlay 2-brugere, Citation AMP 250 kan indstilles i Apple Home-appen.

1. Åben Home-appen, tryk på **+**, tryk derefter på **Add Accessory (Tilføj tilbehør)**.
2. Tryk på **Don't have a Code (Har du ingen kode)** eller **Can't Scan (Kan du ikke scanne?)**, tryk derefter på højtaleren.
3. Vent på, at din højttaler tilføjes. Giv din højttaler et navn, og vælg et rum, hvor den er placeret.
4. Tryk på **Done (Udført)**.

Kun til AirPlay 2-brugere, spring Google Home-appen over, på din iOS-enhed, gå til **Settings (indstillinger) > Wi-Fi** og vælg »Citation AMP 250« under **SET UP NEW AIRPLAY SPEAKER ... (OPSÆTNING AF NY AIRPLAY HØJTALER ...)**

Følg instruktionerne på skærmen for at afslutte opsætningen.

2 PRODUKTPRÆSENTATION

CITATION AMP 250 x1; Regional strømledning x1 (varierer afhængigt af land); Fjernbetjening x1; HDMI-kabel x1; Vægmonteringskit

Top og forside

Berøringsskærm; Lydstyrke; Lyser når den er aktiv

Tilbage

Nulstil; Audio IN; Optisk; HDMI; Strøm

3 KONTROL / INFORMATION OM BERØRINGSSKÆRM

Berøringsskærm: Wi-Fi-status; Bluetooth-status; Mikrofon til/fra; HDMI ARC-kilde; Tryk for at tale med Google Assistant; Opsætning af andre Citation højttalere

4 OPRET FORBINDELSE TIL DIT TV

Mulighed 1 (Bedst):

Mulighed 2: (sælges separat)

5 VÆGMONTERING AF CITATION AMP 250

Brug tape til at fastgøre det vægmonterede papirstyr på væggen, tryk en blyantsspids gennem midten af hvert monteringshul for at markere det vægmonterede beslag og fjern papiret.

Skru vægbeslagene fast på blyantsmærket. Skru monteringspladen med gevind på bagsiden af Citation AMP 250 og hæng derefter Citation AMP 250 på væggen.

6 KOM I GANG

Tilføj Citation AMP 250 til dit hjemme Wi-Fi-netværk:

Download og kørs Google Home-appen på en telefon eller tablet.

Følg instruktionerne på berøringsskærmen og Google Home-appen for at afslutte opsætningen

* Aktiver Bluetooth (iPhone / iPad)

7 OPSÆT MULTIBEAM™ SURROUND-LYD

Automatic MultiBeam Calibration (AMC) vil optimere soundbarrens lydindstillinger for en bedre surroundsound-oplevelse.

8 CHROMECAST

Trin 1: Åbn en app der understøttes af Chromecast

Trin 2: Spil musik

Trin 3: Tryk på Cast-ikonet og vælg «Citation AMP 250» f.eks.

Spotify
Pandora
TuneIn
Deezer

Google Play Music

* Enheden kan understøtte kontrol i flere rum leveret af indbygget Chromecast, for yderligere oplysninger kan du se Google Home-appen.

9. AirPlay

Trin 1: På en iOS-enhed, tilgå kontrolcenter.

Trin 2: Tryk på  for at vælge »Citation AMP 250« som højttaler.

Trin 3: Start lydstreaming fra en app.

10. GOOGLE ASSISTANT

Mikrofon uden lyd: Slå lyden til mikrofonen fra for at stoppe Google Assistant fra at lytte.

Tryk for at tale til Google Assistant

12. SPECIFIKATIONER

- Modelnavn: CITATION AMP 250
- Strømforsyning: 100 - 240 V ~ 50 / 60Hz
- Udgangseffekt: 210 W RMS
- Bluetooth-version: 4.2
- Frekvensområde for Bluetooth-transmitter: 2402 – 2480 MHz
- Bluetooth-sendeeffekt: < 10 dBm (EIRP)
- Bluetooth-sendemodulation: GFSK, $\pi/4$ DQPSK, 8DPSK
- Trådløst netværk: 802.11a/b/g/n/ac (2,4GHz/5GHz)
- Frekvensområde for 2,4G wi-fi-sender: 2,412 - 2,472MHz (2,4 GHz ISM-bånd, USA 11 kanaler, Europa og andre steder 13 kanaler)
- 2,4G wi-fi-sendeeffekt: < 20 dBm (EIRP)
- 2,4G wi-fi-modulation: DBPSK, DQPSK, CCK, QPSK, BPSK, 16QAM, 64QAM
- 5G WiSA-sendeeffekt: < 14 dBm (EIRP)
- 5G WISA modulation: OFDM, BPSK, QPSK, 16QAM

- 5G WISA-sender-frekvensområde: 5,15 - 5,35 GHz, 5,470 - 5,725GHz, 5,725 - 5,825 GHz
- 5G wi-fi-sendeeffekt: < 23 dBm (EIRP)
- 5G wi-fi-modulation: QPSK, BPSK, 16QAM, 64QAM, 256QAM
- Frekvensområde for 5G wi-fi-sender: 5,15 - 5,35GHz, 5,470 - 5,725GHz, 5,725 - 5,825GHz

1. Information on power consumption.

This equipment complies with European Commission Regulation (EC) No 1275/2008 and (EU) No 801/2013.

Networked standby: 2.0 W

2. The period of time after which the power management function switches the equipment automatically into;
the device shall enter 2.0 W networked Standby automatically in 20 minutes.

How to activate wireless network connections;

- Set up product according to instruction
- Switch into wireless mode (Bluetooth, Wi-Fi)
- Connect with energy using product(s)

How to deactivate wireless network connections;

- The device is intended for use in wireless connections, it is inappropriate to deactivate any wireless connections.

DE

① APP

Einrichtung von Google Assistant

Lade die Google Home App herunter und richte den Citation AMP 250 ein.

Einrichtung von AirPlay

Der Citation AMP 250 kann über die Apple Home App eingerichtet werden, aber dies gilt nur für Benutzer von AirPlay 2.

1. Öffne die Home App, tippe auf , dann auf **"Add Accessory (Zubehör hinzufügen)"**.

2. Tippe auf **"Don't have a Code (Kein Code vorhanden)"** oder **"Can't Scan (Scannen nicht möglich)"** und dann auf den Lautsprecher.

3. Warte, bis der Lautsprecher hinzugefügt ist. Gib dem Lautsprecher einen Namen und wähle den Raum, in dem er sich befindet.

4. Tippe auf **"Done (Fertig)"**.

Überspringe als AirPlay 2-Benutzer die Google Home App. Öffne auf deinem iOS-Gerät die **"Settings (Einstellungen)"** > **WLAN** und wähle "Citation AMP 250" unter **"SET UP NEW AIRPLAY SPEAKER (NEUEN AIRPLAY-LAUTSPRECHER EINRICHTEN...)"** Folge den Anweisungen auf dem Bildschirm zum Fertigstellen der Einrichtung.

② PRODUKTTOUR

CITATION AMP 250 x 1; regionales Netzkabel x 1 (variiert je nach Land); Fernbedienung x 1; HDMI-Kabel x 1; Wandhalterung

Ober und Frontseite

Touchscreen; Lautstärke; Leuchtet, wenn aktiv

Rückseite

Reset (Zurücksetzen); Audio IN; Optical; HDMI; Power (Stromanschluss)

③ STEUERUNG / INFORMATIONEN AUF DEM TOUCHSCREEN

Touchscreen: WLAN-Status; Bluetooth-Status; Mikrofon stumm/ Stummschaltung aufgehoben; HDMI ARC-Quelle; Push-to-talk zum Google Assistant; Einrichten anderer Citation-Lautsprecher

④ ANSCHLIESSEN AN DAS FERNSEHGERÄT

Option 1 (beste):

Option 2: (separat erhältlich)

⑤ WANDMONTAGE DES CITATION AMP 250

Klebe die Montageskizze mit Klebeband an die Wand. Drücke mit einer Stiftspitze ein Loch durch die Mitte jedes Montagelochs, um die Position für die Wandhalterung zu markieren, und entferne das Papier.

Schraube die Wandhalterungen an der markierten Position fest. Befestige die Gewindemontagestange auf der Rückseite der Citation AMP 250 und hake die Soundbar an die Wand.

⑥ ERSTE SCHRITTE

Hinzufügen der Citation AMP 250 zu deinem WLAN-Heimnetzwerk:

Kostenlose Google Home-App auf das Smartphone oder Tablet herunterladen und starten.

Befolge die Anweisungen in der Google Home App, um die Einrichtung abzuschließen.

* Bluetooth aktivieren (iPhone / iPad)

⑦ EINRICHTEN DES MULTIBEAM™ SURROUND SOUND

Die automatische MultiBeam-Kalibrierung (AMC) optimiert die Soundeinstellungen der Soundbar für ein besseres Surround-Sound-Erlebnis.

⑧ CHROMECAST

Schritt 1: Öffne die von Chromecast unterstützte App

Schritt 2: Spiele Musik ab

Schritt 3: Tippe auf das Cast-Symbol und wähle "Citation AMP 250"

z. B.
Spotify
Pandora
Tuneln
Deezer
Google Play Music

* Gerät kann die Mehrraum-Steuerung von Chromecast built-in unterstützen.
Weitere Details dazu finde in der Google Home App.

9 AirPlay

Schritt 1: Öffne auf einem iOS-Gerät das Kontrollzentrum.

Schritt 2: Tippe auf , um die "Citation AMP 250" als Lautsprecher auszuwählen.

Schritt 3: Starte das Audio-Streaming aus einer App heraus.

10 GOOGLE ASSISTANT

Mikrofon stummgeschaltet: Schalte das Mikrofon stumm, um das Mithören des Google Assistant zu unterbinden.

Push-to-talk zum Google Assistant

12 TECHNISCHE DATEN

- Modellbezeichnung: CITATION AMP 250
- Energieversorgung: 100 - 240 V - 50/60 Hz
- Ausgangsleistung: 210 W RMS
- Bluetooth-Version: 4.2
- Frequenzbereich für die Bluetooth-Übertragung: 2402–2480 MHz
- Bluetooth-Übertragungsleistung: <10dBm (EIRP)
- Bluetooth-Übertragungsmodulation: GFSK, $\pi/4$ DQPSK, 8DPSK
- WLAN-Netzwerk: IEEE 802.11 a/b/g/n/ac (2,4 GHz/5 GHz)

- 2,4G WLAN-Übertragungsfrequenzbereich: 2412 – 2472 MHz (2,4 GHz ISM-Band, USA 11 Kanäle, Europa und andere Länder 13 Kanäle)
- 2,4G WLAN-Übertragungsleistung: <20dBm (EIRP)
- 2,4G-WLAN-Modulation: DBPSK, DQPSK, CCK, QPSK, BPSK, 16QAM, 64QAM
- 5G WISA-Übertragungsleistung: <14dBm (EIRP)
- 5G WISA-Modulation: OFDM, BPSK, QPSK, 16QAM
- Frequenzbereich für 5G WISA-Übertragung: 5,15–5,35GHz, 5,470–5,725GHz, 5,725–5,825GHz
- 5G WLAN-Übertragungsleistung: < 23 dBm (EIRP)
- 5G WLAN-Modulation: QPSK, BPSK, 16QAM, 64QAM, 256QAM
- 5G WLAN-Übertragungsfrequenzbereich: 5,15 - 5,35GHz, 5,470 - 5,725GHz, 5,725 - 5,825GHz

1. Information on power consumption.

This equipment complies with European Commission Regulation (EC) No 1275/2008 and (EU) No 801/2013.

Networked standby: 2.0 W

2. The period of time after which the power management function switches the equipment automatically into;
the device shall enter 2.0 W networked Standby automatically in 20 minutes.

How to activate wireless network connections;

- Set up product according to instruction
- Switch into wireless mode (Bluetooth, Wi-Fi)
- Connect with energy using product(s)

How to deactivate wireless network connections;

- The device is intended for use in wireless connections, it is inappropriate to deactivate any wireless connections.

ES

① APLICACIÓN

Configuración del Asistente de Google

Descarga la aplicación Google Home y configura tu Citation MultiBeam 700.

Configuración de AirPlay

Los usuarios que utilicen AirPlay 2 solamente pueden configurar Citation MultiBeam 700 utilizando la aplicación Apple Home.

1. Abre la aplicación Home, toca **+** y, a continuación, toca **Add Accessory (Añadir accesorio)**.
2. Toca **Don't have a Code (No tengo código)** o **Can't Scan (No puedo escanear)** y, a continuación, toca en el altavoz.
3. Espera a que se añada el altavoz. Asigna un nombre al altavoz y elige la sala donde se encuentra.
4. Toca **Done (Terminado)**.

En el caso de los usuarios de AirPlay 2 solamente, omite la aplicación Google Home. En el dispositivo iOS, ve a **Settings (Ajustes) > Wi-Fi** y selecciona "Citation MultiBeam 700" en **SET UP NEW AIRPLAY SPEAKER ... (CONFIGURAR NUEVO ALTAVOZ AIRPLAY ...)** Sigue las instrucciones en la pantalla para completar la configuración.

② RECORRIDO POR EL PRODUCTO

1 CITATION MULTIBEAM 700; 1 cable de alimentación adecuado a la región (depende del país); 1 control remoto; 1 cable HDMI; 1 kit de montaje mural **Parte superior y delantera**

Pantalla táctil; Volume (Volumen); se ilumina mientras está activo

Parte posterior

Reset (Restablecer); Audio IN; Optical; HDMI; Power (Alimentación)

③ CONTROL/INFORMACIÓN EN LA PANTALLA TÁCTIL

Pantalla táctil: estado de Wi-Fi, estado de Bluetooth, silenciar/reactivar el micrófono, fuente HDMI ARC, botón para hablar con el Asistente de Google, configurar otros altavoces Citation

④ CONECTAR CON EL TELEVISOR

Opción 1 (la mejor):

Opción 2: (se vende aparte)

⑤ MONTAJE MURAL DE CITATION AMP 250

Utiliza cinta adhesiva para pegar la guía de papel para montaje mural en la pared. Con la punta de un bolígrafo marca el centro de cada orificio de montaje para marcar la pared en la ubicación de montaje y quita el papel.

Atornilla los soportes para montaje mural sobre la marca del bolígrafo. Atornilla el poste de montaje con rosca en la parte posterior de la Citation MultiBeam 700 y, a continuación, cuelga la Citation MultiBeam 700 en la pared.

⑥ PRIMEROS PASOS

Añade Citation MultiBeam 700 a tu red Wi-Fi doméstica:

Descarga y ejecuta la aplicación Google Home en un teléfono o una tableta. Sigue las instrucciones de la pantalla táctil y la aplicación Google Home para finalizar la configuración.

* Activar Bluetooth (iPhone/iPad)

⑦ CONFIGURA EL SONIDO ENVOLVENTE MULTIBEAM™

La calibración automática multihaz (AMC) optimizará los ajustes de la barra de sonido para que disfrutes de un sonido mejor.

⑧ CHROMECAST

Paso 1: abre una aplicación compatible con Chromecast

Paso 2: reproduce música

Paso 3: toca el icono de difusión y selecciona "Citation AMP 250"

por ejemplo

Spotify

Pandora

TuneIn

Deezer

Google Play Music

* El dispositivo es compatible con el control multisala que te ofrece Chromecast integrado; puedes consultar los detalles en la aplicación Google Home.

9 AirPlay

Paso 1: en un dispositivo iOS, accede al Centro de control.

Paso 2: toca  para seleccionar "Citation MultiBeam 700" como altavoz.

Paso 3: inicia la transmisión de sonido desde una aplicación.

10 GOOGLE ASSISTANT

Micrófono silenciado: silencia el micrófono para que el Asistente de Google deje de escuchar.

Toca para hablar con el Asistente de Google

12 ESPECIFICACIONES

- Nombre del modelo: CITATION MULTIBEAM 700
- Alimentación: 100 - 240 V ~ 50/60 Hz
- Potencia de salida: 210 W RMS
- Versión Bluetooth: 4.2
- Intervalo de frecuencias del transmisor Bluetooth: 2.402 – 2.480 MHz
- Potencia del transmisor Bluetooth: <10 dBm (EIRP)
- Modulación del transmisor Bluetooth: GFSK, $\pi/4$ DQPSK, 8DPSK
- Red inalámbrica: 802,11a/b/g/n/ac (2,4 GHz/5 GHz)

- Intervalo de frecuencias del transmisor Wi-Fi 2,4G: 2412 - 2.472 MHz (Banda ISM 2,4 GHz, EE.UU.: 11 canales, Europa y otras regiones: 13 canales)
- Potencia del transmisor Wi-Fi 2,4 G: <20 dBm (EIRP)
- Modulación de Wi-Fi 2,4G: DBPSK, DQPSK, CCK, QPSK, BPSK, 16QAM, 64QAM
- Potencia del transmisor WISA 5G: <14 dBm (EIRP)
- Modulación WISA 5G: OFDM, BPSK, QPSK, 16QAM
- Intervalo de frecuencias del transmisor WISA 5G: 5,15 - 5,35 GHz, 5,470 - 5,725 GHz, 5,725 - 5,825 GHz
- Potencia del transmisor Wi-Fi 5G: < 23 dBm (EIRP)
- Modulación de Wi-Fi 5G: QPSK, BPSK, 16QAM, 64QAM, 256QAM
- Intervalo de frecuencias del transmisor Wi-Fi 5G: 5,15 - 5,35GHz, 5,470 - 5,725GHz, 5,725 - 5,825GHz

1. Information on power consumption.

This equipment complies with European Commission Regulation (EC) No 1275/2008 and (EU) No 801/2013.

Networked standby: 2.0 W

2. The period of time after which the power management function switches the equipment automatically into;
the device shall enter 2.0 W networked Standby automatically in 20 minutes.

How to activate wireless network connections;

- Set up product according to instruction
- Switch into wireless mode (Bluetooth, Wi-Fi)
- Connect with energy using product(s)

How to deactivate wireless network connections;

- The device is intended for use in wireless connections, it is inappropriate to deactivate any wireless connections.

FI

① SOVELLUS

Google-avustajan asennus

Lataa Google Home -sovellus, ja asenna oma Citation AMP 250:si.

AirPlay-asennus

Vain AirPlay 2 käyttäjille, Citation AMP 250 voidaan asentaa käyttämällä Apple Home -sovellusta.

1. Avaa Home-sovellus, napauta **+**, napauta sitten **Add Accessory (Lisää lisävaruste)**.
2. Napauta **Don't have a Code (Ei koodia)** tai **Can't Scan (Ei voi skannata)**, ja napauta sitten kaiutinta.
3. Odota kaiuttimesi lisäämistä. Anna kaiuttimellesi nimi ja valitse huone, jossa se sijaitsee.
4. Napauta **Done (Valmis)**.

Vain AirPlay 2 käyttäjille, ohita Google Home -sovellus; mene iOS-laitteesi kohtaan **Settings (Asetukset) > Wi-Fi** ja valitse "Citation AMP 250" kohdan **SET UP NEW AIRPLAY SPEAKER ... (ASENNA UUSI AIRPLAY-KAIUTIN alta ...)** Noudata näytön ohjeita suorittaaksesi asennuksen loppuun.

② TUOTEKIERROS

CITATION AMP 250 x1; Alueellinen virtajohto x1 (vaihtelee maittain); Kaukosäädin x1; HDMI-kaapeli x1; Seinäkiinnitysarja

Ylhäältä ja edestä

Kosketusnäyttö; Äänenvoimakkuus, Aktiivisuuden ilmaisevat merkkivalot

Takaisin

Nollaus; Äänen tulo; Optinen; HDMI; Virta

③ OHJAUS/ TIEDOT KOSKETUSNÄYTÖLLÄ

Kosketusnäyttö: Wi-Fin tila; Bluetoothin tila; Mikrofonin mykistys/mykistysten

poisto; HDMI ARC -lähde; Paina puhuaksesi Google Assistentille; Toisten Citation-kaiuttimien asennus

④ YHDISTÄ TELEVISIOOSI

Vaihtoehto 1 (Paras):

Vaihtoehto 2: (Myydään erikseen)

⑤ CITATION AMP 250:N SEINÄKIINNITYS

Kiinnitä seinäkiinnityksen paperiohje teipillä seinään. Työnnä kynän kärki jokaisen asennusreiän keskikohdan läpi seinäasennuksen kannattimien paikan merkitsemiseksi, ja poista paperi.

Ruuvaa seinäasennuksen kannattimet kynämerkintöjen kohdalle. Ruuvaa kiinnitysteline Citation AMP 250:n taakse ja kiinnitä Citation AMP 250 sitten seinään.

⑥ ALOITUS

Lisää Citation AMP 250 kotisi Wi-Fi-verkkoon:

Lataa ja käytä Google Home -sovellusta puhelimellasi tai tabletilaitteellasi. Noudata ohjeita kosketusnäytöllä ja Google Home -sovelluksessa asennuksen loppuun viemiseksi

* Ota Bluetooth käyttöön (iPhone / iPad)

⑦ MULTIBEAM™ SURROUND-ÄÄNEN ASENNUS

Automaattinen MultiBeam -kalibrointi (AMC) optimoi soundbar-ääniasetukset paremman surround-äänikokemuksen muodostamiseksi.

⑧ CHROMECAST

Vaihe 1: Avaa Chromecastia tukeva sovellus

Vaihe 2: Toista musiikkia

Vaihe 3: Napauta lähetyksuvaketta ja valitse "Citation AMP 250"

Esim.
Spotify
Pandora
Tuneln
Deezer
Google Play Music

* Laitte voi tukea monen huoneen ohjausta sisäänrakennetun Chromecastin avulla, lisätiedot löydät Google Home -sovelluksesta.

9 AirPlay

Vaihe 1: Siirry iOS-laitteellasi Ohjauskeskukseen.

Vaihe 2: Napauta  valitaksesi "Citation AMP 250:n" kaiuttimeksesi.

Vaihe 3: Aloita äänen suoratoisto sovelluksesta.

10 GOOGLE ASSISTANT

Mikrofoni mykistetty: Mykistä mikrofoni, jotta Google-avustaja lopettaa kuuntelun.

Paina puhuaksesi Google-avustajalle

12 TEKNISET TIEDOT

- Mallinimi: CITATION AMP 250
- Tehonsyöttö: 100 - 240 V ~ 50 / 60 Hz
- Lähtöteho: 210 W RMS
- Bluetooth-versio: 4.2
- Bluetooth-lähettimen taajuusalue: 2402 –2480 MHz
- Bluetooth-lähettimen teho: <10 dBm (EIRP)
- Bluetooth-lähettimen modulaatio: GFSK,π/4 DQPSK, 8DPSK
- Langaton verkko: 802.11a/b/g/n/ac (2,4 GHz/5 GHz)

- 2.4G Wi-Fi-lähettimen taajuusalue: 2412–2472 MHz (2,4 GHz ISM-kaista, USA 11 kanavaa, Eurooppa ja muut maat 13 kanavaa)
- 2,4G Wi-Fi -lähettimen teho: <20 dBm (EIRP)
- 2.4G Wi-Fi-modulaatio: DBPSK, DQPSK, CCK, QPSK,BPSK,16QAM, 64QAM
- 5 G WISA-lähettimen teho: <14 dBm (EIRP)
- 5G WISA-modulaatio: OFDM, BPSK, QPSK, 16QAM
- 5G WISA-lähettimen taajuusalue: 5,15 - 5,35 GHz, 5,470 - 5,725GHz, 5,725 - 5,825 GHz
- 5G Wi-Fi -lähettimen teho: < 23 dBm (EIRP)
- 5G Wi-Fi-modulaatio: QPSK, BPSK, 16QAM, 64QAM, 256QAM
- 5G Wi-Fi-lähettimen taajuusalue: 5,15 - 5,35GHz, 5,470 - 5,725GHz, 5,725 - 5,825GHz

1. Information on power consumption.

This equipment complies with European Commission Regulation (EC) No 1275/2008 and (EU) No 801/2013.

Networked standby: 2.0 W

2. The period of time after which the power management function switches the equipment automatically into;
the device shall enter 2.0 W networked Standby automatically in 20 minutes.

How to activate wireless network connections;

- Set up product according to instruction
- Switch into wireless mode (Bluetooth, Wi-Fi)
- Connect with energy using product(s)

How to deactivate wireless network connections;

- The device is intended for use in wireless connections, it is inappropriate to deactivate any wireless connections.

FR

① APPLICATION

La configuration de l'Assistant Google

Téléchargez l'application Google Home et configurez votre Citation AMP 250.

Configuration d'AirPlay

Pour les utilisateurs uniquement d'AirPlay 2, la Citation MultiBeam 700 peut être configurée via l'application Apple Home.

1. Ouvrez l'application Home, appuyez sur **+**, puis appuyez sur **Add Accessory (Ajouter un accessoire)**.

2. Appuyez sur **Don't have a Code (Je n'ai pas de code)** ou **Can't Scan (Je ne peux pas numériser)**, puis appuyez sur l'enceinte.

3. Attendez que votre enceinte soit ajoutée. Attribuez un nom à votre enceinte et choisissez la pièce où elle se trouve.

4. Appuyez sur **Done (Terminer)**.

Pour les utilisateurs AirPlay 2 uniquement, ignorez l'application Google Home.

Sur votre appareil iOS, accédez à **Settings (Paramètres) > Wi-Fi** et sélectionnez « Citation AMP 250 » sous **SET UP NEW AIRPLAY SPEAKER ... (CONFIGURER UNE NOUVELLE ENCEINTE AIRPLAY ...)** suivez les instructions à l'écran pour terminer la configuration.

② PRÉSENTATION DU PRODUIT

1 CITATION AMP 250 ; 1 cordon secteur selon la région (dépend du pays) ; 1 télécommande ; 1 câble HDMI ; kit de montage mural

Avant et dessus

Écran tactile ; Volume ; S'allume lorsqu'elle est active

Dos

Réinitialisation ; Entrée audio ; Optique ; HDMI ; Alimentation

③ COMMANDES / INFORMATIONS SUR L'ÉCRAN TACTILE

Écran tactile : État du Wi-Fi ; État du Bluetooth ; Désactivation / activation du microphone ; source HDMI ARC ; Appuyer pour parler à l'Assistant Google ; configuration d'autres enceintes Citation

④ CONNEXION À VOTRE TÉLÉVISEUR

Option 1 (meilleure) :

Option 2 : (vendu séparément)

⑤ MONTAGE MURAL DE LA CITATION AMP 250

Utilisez de la bande adhésive pour coller le guide papier de montage mural sur la paroi, enfoncez un crayon au centre de chaque trou de montage afin de marquer l'emplacement du support mural puis retirez le papier.

Vissez les fixations murales sur le repère au crayon ; vissez le goujon de fixation fileté à l'arrière de la Citation AMP 250 puis accrochez la Citation AMP 250 au mur.

⑥ MISE EN ROUTE

Ajout d'une Citation AMP 250 au réseau Wi-Fi de votre domicile :

téléchargez et exécutez l'application Google Home sur votre téléphone ou tablette.

Suivez les instructions sur l'écran tactile et l'application Google Home pour terminer la configuration.

* Activez le Bluetooth (iPhone / iPad)

⑦ CONFIGURATION DU SON SURROUND MULTIBEAM™

L'étalonnage automatique MultiBeam (AMC) optimise les réglages audio de la barre de son pour une meilleure expérience de son d'ambiance surround.

⑧ CHROMECAST

Étape 1 : Ouvrez une application compatible Chromecast.

Étape 2 : Lisez de la musique.

Étape 3 : Appuyez sur l'icône de diffusion et sélectionnez « Citation AMP 250 ».

Par ex.
Spotify
Pandora
Tuneln
Deezer
Google Play Music

* L'appareil peut supporter la commande multi-pièce fournie par Chromecast intégré, vous pouvez vous référer à l'application Google Home pour plus d'informations.

9 AirPlay

Étape 1 : Sur un appareil iOS, entrez dans le Centre de commande.

Étape 2 : Appuyez sur  pour sélectionner « Citation AMP 250 » comme enceinte.

Étape 3 : Démarrez la diffusion audio depuis une application.

10 GOOGLE ASSISTANT

Microphone désactivé : désactivez le microphone pour empêcher l'Assistant Google d'écouter.

Appuyez pour parler à l'Assistant Google

12 CARACTÉRISTIQUES TECHNIQUES

- Nom de modèle : CITATION AMP 250
- Alimentation électrique : 100 - 240 V~ 50/60 Hz
- Puissance de sortie : 210 W RMS
- Version Bluetooth : 4.2
- Bande de fréquences de l'émetteur Bluetooth : 2402 - 2480 MHz
- Puissance de l'émetteur Bluetooth : < 10 dBm (PAR)
- Modulation de l'émetteur Bluetooth : GFSK, $\pi/4$ DQPSK, 8DPSK

- Réseau sans fil : 802.11 a/b/g/n/ac (2,4 GHz / 5 GHz)
- Plage de fréquences de l'émetteur Wi-Fi 2.4G : 2412 - 2472 MHz (bande ISM 2,4 GHz, USA 11 canaux, Europe et autres 13 canaux)
- Puissance de l'émetteur Wi-Fi 2.4G : < 20 dBm (PAR)
- Modulation Wi-Fi 2.4G : DBPSK, DQPSK, CCK, QPSK, BPSK, 16QAM, 64QAM
- Puissance de l'émetteur 5G WISA : < 14 dBm (PAR)
- Modulation 5G WISA : OFDM, BPSK, QPSK, 16QAM
- Plage de fréquences de l'émetteur 5G WISA : 5,15 - 5,35 GHz, 5,470 - 5,725 GHz, 5,725 - 5,825 GHz
- Puissance de l'émetteur Wi-Fi 5G : < 23 dBm (EIRP)
- Modulation Wi-Fi 5G : QPSK, BPSK, 16QAM, 64QAM, 256QAM
- Plage de fréquences de l'émetteur Wi-Fi 5G : 5,15 - 5,35GHz, 5,470 - 5,725GHz, 5,725 - 5,825GHz

1. Information on power consumption.

This equipment complies with European Commission Regulation (EC) No 1275/2008 and (EU) No 801/2013.

Networked standby: 2.0 W

2. The period of time after which the power management function switches the equipment automatically into;
the device shall enter 2.0 W networked Standby automatically in 20 minutes.

How to activate wireless network connections;

- Set up product according to instruction
- Switch into wireless mode (Bluetooth, Wi-Fi)
- Connect with energy using product(s)

How to deactivate wireless network connections;

- The device is intended for use in wireless connections, it is inappropriate to deactivate any wireless connections.

IT

① APP

Configurazione con l'Assistente Google

Scarica l'applicazione Google Home e configura la tua Citation AMP 250.

Configurazione con AirPlay

Solo per gli utenti di AirPlay 2, Citation AMP 250 può essere configurata utilizzando l'applicazione Apple Home.

1. Apri l'applicazione Casa, tocca , quindi tocca **Add Accessory (Aggiungi accessorio)**.
2. Tocca **Don't have a Code (Non hai il codice)** o **Can't Scan (non puoi scansionarlo?)**, quindi tocca lo speaker.
3. Attendi che l'altoparlante venga aggiunto. Dai un nome al tuo speaker e scegli la stanza dove si trova.
4. Tocca **Done (Fatto)**.

Per i soli utenti AirPlay 2, saltare l'app Google Home; sul dispositivo iOS, andare in **Settings (Impostazioni) > Wi-Fi** e selezionare "Citation AMP 250" in **SET UP NEW AIRPLAY SPEAKER ... (IMPOSTA UN NUOVO SPEAKER AIRPLAY...)** segui le istruzioni che compariranno per completare la configurazione.

② TOUR DEL PRODOTTO

CITATION AMP 250 x1; Cavo di alimentazione regionale x1 (varia a seconda del paese); Telecomando x1; Cavo HDMI x1; Kit di montaggio a parete

Parte superiore e frontale

Touch screen; Volume; Si accende quando è attivo

Dietro

Reset; Ingresso audio; Ottico; HDMI; Alimentazione

③ CONTROLLO / INFORMAZIONI SUL TOUCH SCREEN

Touch screen: Stato Wi-Fi; stato Bluetooth; silenziamento/riattivazione microfono;

Sorgente HDMI ARC; premere per parlare con l'Assistente Google; configurazione di altri altoparlanti Citation

④ COLLEGAMENTO AL TV

Opzione 1 (migliore):

Opzione 2: (venduto separatamente)

⑤ MONTAGGIO A PARETE DEL CITATION AMP 250

Utilizzare del nastro adesivo per attaccare la dima di carta sulla parete, spingere la punta di una penna attraverso il centro di ciascun foro per il montaggio per contrassegnare la posizione della staffa a parete e rimuovere la dima.

Avvitare le staffe per il montaggio a parete in corrispondenza del segno della penna; avvitare il perno di montaggio filettato nella parte posteriore di Citation AMP 250; quindi agganciare Citation AMP 250 alla parete.

⑥ GUIDA INTRODUTTIVA

Aggiungi Citation AMP 250 alla tua rete Wi-Fi domestica:

Scarica e apri l'applicazione Google Home sullo smartphone o tablet.

Segui le istruzioni sul touch screen e dell'app Google Home per completare la configurazione

* Attiva il Bluetooth (iPhone / iPad)

⑦ IMPOSTAZIONE DEL SUONO SURROUND MULTIBEAM™

La Calibrazione Automatica MultiBeam™ (AMC) ottimizzerà le impostazioni audio della soundbar per una migliore esperienza di suono surround.

⑧ CHROMECAST

Passo 1: Apri un applicazione supportata da Chromecast

Passo 2: Riproduci un brano musicale

Passo 3: Tocca l'icona cast e seleziona "Citation AMP 250"

es.
Spotify
Pandora
TuneIn
Deezer
Google Play Music

* Il dispositivo può supportare il controllo multi-room fornito da Chromecast integrato, per maggiori dettagli fare riferimento all'app Google Home.

9 AirPlay

Passo 1: Su un dispositivo iOS, entra in Centro di Controllo

Passo 2: Tocca  per selezionare "Citation AMP 250" come speaker.

Passo 3: Inizia lo streaming audio da un'app.

10 GOOGLE ASSISTANT

Microfono silenziato: Disattiva il microfono per impedire all'Assistente Google di ascoltare.

Premi per parlare con l'Assistente Google

12 SPECIFICHE

- Modello: CITATION AMP 250
- Alimentazione: 100 - 240 V ~ 50 / 60Hz
- Potenza in uscita: 210 W RMS
- Versione Bluetooth: 4.2
- Intervallo di frequenza del trasmettitore Bluetooth: 2402 – 2480 MHz
- Potenza del trasmettitore Bluetooth: <10 dBm (EIRP)
- Modulazione del trasmettitore Bluetooth: GFSK, $\pi/4$ DQPSK, 8DPSK
- Rete wireless: 802.11a/b/g/n/ac (2.4GHz/5GHz)

- Intervallo di frequenza del trasmettitore Wi-Fi 2.4G: 2412 – 2472 MHz (2,4GHz banda ISM, USA 11 canali, Europa e altri 13 canali)
- Potenza del trasmettitore Wi-Fi 2.4G: <20 dBm (EIRP)
- Modulazione Wi-Fi 2.4G: DBPSK, DQPSK, CCK, QPSK, BPSK, 16QAM, 64QAM
- Potenza del trasmettitore 5G WISA: < 14 dBm (EIRP)
- Modulazione 5G WISA: OFDM, BPSK, QPSK, 16QAM
- Gamma di frequenza del trasmettitore 5G WISA: 5.15 - 5.35 GHz, 5.470 - 5.725GHz, 5.725 - 5.825 GHz
- Potenza del trasmettitore Wi-Fi 5G: < 23 dBm (EIRP)
- 5G Wi-Fi modulation: QPSK, BPSK, 16QAM, 64QAM, 256QAM
- Intervallo di frequenza del trasmettitore Wi-Fi 5G: 5.15 - 5.35GHz, 5.470 - 5.725GHz, 5.725 - 5.825GHz

1. Information on power consumption.

This equipment complies with European Commission Regulation (EC) No 1275/2008 and (EU) No 801/2013.

Networked standby: 2.0 W

2. The period of time after which the power management function switches the equipment automatically into;
the device shall enter 2.0 W networked Standby automatically in 20 minutes.

How to activate wireless network connections;

- Set up product according to instruction
- Switch into wireless mode (Bluetooth, Wi-Fi)
- Connect with energy using product(s)

How to deactivate wireless network connections;

- The device is intended for use in wireless connections, it is inappropriate to deactivate any wireless connections.

NL

1 APP

De Google Assistant installeren

Download de Google Home-app en installeer de Citation AMP 250.

AirPlay ionstalleren

Alleen voor AirPlay 2-gebruikers: Citation AMP 250 kan worden geïnstalleerd via de Apple Home-app.

1. Open de Home app, tik op , en dan op **Add Accessory (Accessoire toevoegen)**.

2. Tik op **Don't have a Code (Heb geen code)** of **Can't Scan (Kan niet scannen)**, en tik vervolgens op de luidspreker.

3. Wacht even tot de luidspreker is toegevoegd. Geef de luidspreker een naam en geef het de naam van de locatie waar de luidspreker zich bevindt.

4. Tip op **Done (Voltooid)**.

Alleen voor AirPlay 2 gebruikers: ga naar de Google Home app; op een iOS apparaat, ga naar **Settings (Instellingen) > Wi-Fi** en selecteer "Citation AMP 250" onder **SET UP NEW AIRPLAY SPEAKER ... (INSTALLEER NIEUWE LUIDSPREKER ...)** volg de instructies op het scherm om de installatie te voltooien.

2 PRODUCTBESCHRIJVING

CITATION AMP 250 x1; Netsnoer x1 (varieert afhankelijk van het land); Afstandsbediening x1; HDMI-kabel x1; Wandmontagekit

Boven- & Voorkant

Aanraakscherm; Volume; Licht op tijdens gebruik

Achterkant

Reset; Audio IN; Optical; HDMI; Voeding

3 BEDIENING / INFORMATIE OP AANRAAKSCHERM

Aanraakscherm: Wi-Fi-status; Bluetooth-status; Mic dempen/dempen opheffen; HDMI ARC-bron; Push-to-talk met Google Assistant; Installeer andere Citation-luidsprekers

4 VERBINDING MET DE TV

Optien 1 (Beste):

Optie 2: (apart verkocht)

5 WANDMONTAGE VAN DE CITATION AMP 250

Gebruik tape om de papiergeleider aan de muur te plakken, duw een penpunt door het midden van elk montagegat om de locatie van de aan de wand gemonteerde beugel te markeren en verwijder het papier.

Schroef de wandbeugels op de penmarkering; draai de schroefdraadmontagepaal in de achterkant van de Citation AMP 250 en hang de Citation AMP 250 aan de muur.

6 INGEBRUIKNAME

Voeg Citation AMP 250 toe aan het wifi-thuisnetwerk:

Download en installeer de Google Home-app op een mobiele telefoon of tablet. Volg de instructies op het aanraakscherm en de Google Home-app om de installatie te voltooien

* Bluetooth inschakelen (iPhone / iPad)

7 INSTALLEER MULTIBEAM™ SURROUND SOUND

Automatic MultiBeam Calibration (AMC) optimaliseert de soundbar-geluidsinstellingen voor een optimale surround sound-ervaring.

8 CHROMECAST

Stap 1: Open een Chromecast-ondersteunde app

Stap 2: Speel muziek

Stap 3: Tik op het cast-pictogram en selecteer "Citation AMP 250"
b.v.

Spotify

Pandora

TuneIn

Deezer

Google Play Music

* Het apparaat ondersteunt multi-room-bediening van Chromecast ingebouwd;
Zie voor meer details de Google Home-app.

AirPlay

Stap 1: Ga op een iOS-apparaat naar het Control Center.

Stap 2: Tik op  en selecteer "Citation AMP 250" als luidspreker.

Stap 3: Start audiostreaming via een app.

GOOGLE ASSISTANT

Microfoon gedempt: Demp de microfoon om te voorkomen dat Google Assistant luistert.

Push-to-talk met Google Assistant

SPECIFICATIES

- Modelnaam: CITATION AMP 250
- Voeding: 100 - 240 V ~ 50 / 60Hz
- Uitgangsvermogen: 210 W RMS
- Bluetooth-versie: 4.2
- Frequentiebereik van Bluetooth-zender: 2402 – 2480 MHz
- Bluetooth zendervermogen: <10 dBm (EIRP)
- Bluetooth-zendermodulatie: GFSK,π/4 DQPSK, 8DPSK
- Draadloos netwerk: 802.11a/b/g/n/ac (2.4GHz/5GHz)

- 2.4G frequentiebereik wifi-zender: 2412 - 2472 MHz (2,4 GHz ISM-band, VS 11 kanalen, Europa en 13 kanalen)
- 2.4G Wi-Fi zendervermogen: <20 dBm (EIRP)
- 2.4G Wi-Fi modulatie: DBPSK, DQPSK, CCK, QPSK,BPSK,16QAM, 64QAM
- 5G WISA zendervermogen: < 14 dBm (EIRP)
- 5G WISA modulatie: OFDM, BPSK, QPSK, 16QAM
- 5G WISA zender frequentiebereik: 5.15 - 5.35 GHz, 5.470 - 5.725GHz, 5.725 - 5.825 GHz
- 5G Wi-Fi zendervermogen: < 23 dBm (EIRP)
- 5G Wi-Fi modulatie: QPSK, BPSK, 16QAM, 64QAM, 256QAM
- 5G Wi-Fi zender frequentiebereik: 5.15 - 5.35GHz, 5.470 - 5.725GHz, 5.725 - 5.825GHz

1. Information on power consumption.

This equipment complies with European Commission Regulation (EC) No 1275/2008 and (EU) No 801/2013.

Networked standby: 2.0 W

2. The period of time after which the power management function switches the equipment automatically into;
the device shall enter 2.0 W networked Standby automatically in 20 minutes.

How to activate wireless network connections;

- Set up product according to instruction
- Switch into wireless mode (Bluetooth, Wi-Fi)
- Connect with energy using product(s)

How to deactivate wireless network connections;

- The device is intended for use in wireless connections, it is inappropriate to deactivate any wireless connections.

NO

1 APP

Oppsett med Google-assistenten

Last ned appen Google Hjem og sett opp Citation AMP 250.

Oppsett med AirPlay

Kun for brukere av AirPlay 2, Citation MultioBeam 700 kan settes opp med appen Apple Hjem.

1. Åpne appen Hjem, tapp på  og deretter på **Add Accessory (Legg til tilbehør)**.
2. Tapp på **Don't have a Code (Har ikke kode)** eller **Can't Scan (Kan ikke skanne)**, og deretter på høyttaleren.
3. Vent til høyttaleren din er lagt til. Gi høyttaleren din et navn og velg rommet den står i.
4. Tapp på **Done (Ferdig)**.

Kun for brukere av AirPlay 2, hopp over appen Google Hjem; gå til Innstillinger på iOS-**Settings (Enheten og)** deretter til **Wi-Fi** og velg "Citation AMP 250" under **SET UP NEW AIRPLAY SPEAKER ... (KONFIGURER NY AIRPLAY-HØYTALER...)** følg instruksjonene på skjermen for å fullføre oppsettet.

2 PRODUKTOVERSIKT

CITATION AMP 250 x 1; regional strømledning x 1 (varierer avhengig av land); fjernkontroll x 1; HDMI-kabel x 1; veggmonteringssett

Topp og front

Berøringsskjerm; volum; lys når aktiv

Bak

Tilbakestilling; audio INN; optisk; HDMI; strøm

3 KONTROLL / INFORMASJON PÅ BERØRINGSSKJERM

Berøringsskjerm: Wi-Fi-status; Bluetooth-status; Mikrofon demping / demping

av; HDMI ARC-kilde; Trykk for å snakke til Google-assistenten; Konfigurer andre Citation-høyttalere

4 KOBLE TIL TV

Alternativ 1 (best)

Alternativ 2: (selges separat)

5 VEGGMONTERING AV CITATION AMP 250

Bruke tape for å feste papirmalen for veggmontering til veggen, skyv en pennespiss gjennom senter av hvert monteringshull for å markere plasseringen for veggmonteringsbraketten og fjern så papiret. Skru veggmonteringsbrakettene på pennemerket; skru den gjengede monteringsstøtten inn på baksiden av Citation AMP 250, og fest Citation AMP 250 til veggen.

6 KOMME I GANG

Legg Citation AMP 250 til hjemmenettverket:

Last ned og kjøp appen Google Hjem på en telefon eller et nettbrett.

Følg instruksjonene på berøringsskjermen og appen Google Hjem for å fullføre oppsettet.

* Aktiver Bluetooth (iPhone / iPad)

7 KONFIGURER MULTIBEAM™ SURROUNDLYD

Automatisk MultiBeam-kalibrering (Automatic MultiBeam Calibration = AMC) optimerer lydinnstillingene på lydplanken for en bedre opplevelse av surroundlyden.

8 CHROMECAST

Trinn 1: Åpne Chromecast-støttet app

Trinn 2: Spill musikk

Trinn 3: Tapp på cast-ikonet og velg "Citation AMP 250"

f.eks.
Spotify
Pandora
Tuneln
Deezer
Google Play musikk

* Enheten kan støtte multiroom kontroll levert av innebygget Chromecast, se appen Google Hjem for flere detaljer.

9 AirPlay

Trinn 1: Gå inn på Kontrollsenter på en iOS-enhet.

Trinn 2: Tapp på  for å velge "Citation AMP 250" som høyttaler.

Trinn 3: Begynn lydstrømming fra en app.

10 GOOGLE ASSISTANT

Mikrofon dempet: Demp mikrofonen for å hindre at Google-assistenten lytter.

Trykk for å snakke til Google-assistenten

12 SPESIFIKASJONER

- Modellnavn: CITATION AMP 250
- Strømforsyning: 100 – 240 V~, 50 / 60 Hz
- Utgangseffekt: 210 W RMS
- Bluetooth-versjon: 4.2
- Frekvensområde for Bluetooth-sender: 2402 – 2,480MHz
- Bluetooth-sendereffekt: < 10 dBm (EIRP)
- Modulasjon for Bluetooth-sender: GFSK,π / 4 DQPSK, 8 DPSK
- Trådløst nettverk: 802.11 a/b/g/n/ac (2,4 GHz / 5 GHz)
- 2,4 G frekvensområde for Wi-Fi-sender: 2412 - 2472 MHz (2.4GHz ISM Band, USA 11 kanaler, Europa og andre 13 kanaler)

- 2,4 G Wi-Fi sendereffekt: < 20 dBm (EIRP)
- 2,4 G Wi-Fi modulasjon: DBPSK, DQPSK, CCK, QPSK,BPSK,16 QAM, 64 QAM
- Strøm for 5 G WISA-sender: < 14 dBm (EIRP)
- 5 G WISA-modulasjon: OFDM, BPSK, QPSK, 16 QAM
- Frekvensområde for 5 G WISA-sender: 5,15 – 5,35 GHz, 5,470 – 5,725 GHz, 5,725 – 5,825 GHz
- 5 G Wi-Fi sendereffekt: < 23 dBm (EIRP)
- 5 G Wi-Fi modulasjon: QPSK, BPSK, 16QAM, 64QAM, 256QAM
- Frekvensområde for 5 G Wi-Fi-sender: 5,15 - 5,35GHz, 5,470 - 5,725GHz, 5,725 - 5,825GHz

1. Information on power consumption.

This equipment complies with European Commission Regulation (EC) No 1275/2008 and (EU) No 801/2013.

Networked standby: 2.0 W

2. The period of time after which the power management function switches the equipment automatically into;
- the device shall enter 2.0 W networked Standby automatically in 20 minutes.

How to activate wireless network connections;

- Set up product according to instruction
- Switch into wireless mode (Bluetooth, Wi-Fi)
- Connect with energy using product(s)

How to deactivate wireless network connections;

- The device is intended for use in wireless connections, it is inappropriate to deactivate any wireless connections.

PL

1 APP

Konfiguracja Google Assistant

Pobierz aplikację Google Home i skonfiguruj urządzenie Citation AMP 250.

Konfiguracja AirPlay

W przypadku AirPlay 2 urządzenie Citation AMP 250 można skonfigurować za pomocą aplikacji Apple Home.

1. Otwórz aplikację Home, stuknij **+**, a następnie stuknij **Add Accessory (Dodaj akcesorium)**.
2. Stuknij **Don't have a Code (Nie mam kodu)** lub **Can't Scan (Nie mogę skanować)**, a następnie stuknij głośnik.
3. Poczekaj na dodanie głośnika. Wpisz nazwę dla głośnika i wybierz dla niego pomieszczenie.
4. Stuknij **Done (Gotowe)**.

W przypadku AirPlay 2 pomiń aplikację Google Home; na urządzeniu z systemem iOS przejdź do **Settings (Konfiguracja)** > Sieć **Wi-Fi** i wybierz „Citation AMP 250” w sekcji **SET UP NEW AIRPLAY SPEAKER ... (KONFIGURUJ NOWY GŁOŚNIK AIRPLAY ...)** Aby przeprowadzić konfigurację, postępuj zgodnie z instrukcjami wyświetlanymi na ekranie.

2 OMÓWIENIE PRODUKTU

Soundbar CITATION AMP 250 x1; przewód zasilania (dostosowany do regionu) x1 (zależy od kraju); pilot zdalnego sterowania x1; kabel HDMI x1; zestaw montażowy na ścianę

Góra i przód

Ekran dotykowy; Głośność; Światła, gdy aktywne

Wstecz

Resetuj; WEJ Audio; Optyczne; HDMI; Zasilanie

3 STEROWANIE / INFORMACJE O EKRANIE DOTYKOWYM

Ekran dotykowy: Status sieci Wi-Fi, status Bluetooth; wycisz/usuń wyciszenie mikrofonu; źródło HDMI ARC; funkcja push-to-talk dla aplikacji Google Assistant; skonfiguruj inne głośniki Citation

4 PODŁĄCZANIE DO TELEWIZORA

Opcja 1 (najlepsza):

Opcja 2: (sprzedawane oddzielnie)

5 MONTAŻ ŚCIENNY SOUNDBARA CITATION AMP 250

Użyj taśmy do przyklejenia szablonu do montażu ściennego na ścianie, pchnij końcówkę długopisu przez środek każdego otworu montażowego, aby wyznaczyć lokalizację wspornika ściennego, i zdejmij szablon. Przykręć wsporniki ścienne w miejscu oznaczenia; dokręć gwintowany kołek montażowy z tyłu soundbara Citation AMP 250, a następnie zawieś go na ścianie.

6 WPROWADZENIE

Jak połączyć soundbar Citation AMP 250 z siecią domową Wi-Fi:

Pobierz i uruchom aplikację Google Home na smartfonie lub tablecie.

Postępuj zgodnie z instrukcjami wyświetlanymi na ekranie dotykowym i w aplikacji Google Home, aby zakończyć konfigurację

* Włącz Bluetooth (iPhone / iPad)

7 KONFIGUROWANIE DŹWIĘKU PRZESTRZENNEGO SOUNDBARA MULTIBEAM™

Za pomocą automatycznej kalibracji MultiBeam (AMC) można zoptymalizować ustawienia dźwięku soundbara, uzyskując lepsze wrażenia z odsłuchu.

8 CHROMECAST

Krok 1: Otwórz aplikację wspierającą Chromecast

Krok 2: Odtwarzaj muzykę

Krok 3: Stuknij ikonę transmisji i wybierz „Citation AMP 250” np.

Spotify

Pandora

TuneIn

Deezer

Google Play Music

**Urządzenie może obsługiwać wiele pomieszczeń dzięki wbudowanej usłudze Chromecast; więcej szczegółów w aplikacji Google Home.

9 AirPlay

Krok 1: Na urządzeniu z systemem iOS otwórz Centrum sterowania.

Krok 2: Stuknij , aby wybrać „Citation AMP 250” jako soundbar.

Krok 3: Rozpocznij strumieniowanie audio z aplikacji.

10 GOOGLE ASSISTANT

Mikrofon wyciszony: Wycisz mikrofon, aby zatrzymać nasłuchiwanie aplikacji Google Assistant.

Użyj funkcji push-to-talk, aby aktywować Google Assistant

12 DANE TECHNICZNE

- Nazwa modelu: CITATION AMP 250
- Zasilanie: 100 - 240 V~, 50/60 Hz
- Moc wyjściowa: 210 W RMS
- Wersja Bluetooth: 4.2
- Zakres częstotliwości nadajnika Bluetooth: 2402 – 2480 MHz
- Moc nadajnika Bluetooth: <10 dBm (EIRP)
- Modulacja nadajnika Bluetooth: GFSK,π/4 DQPSK, 8DPSK
- Sieć bezprzewodowa: 802.11a/b/g/n/ac (2,4 GHz / 5 GHz)

- Zakres częstotliwości nadajnika 2,4 GHz Wi-Fi: 2412 - 2472 MHz (2,4 GHz w paśmie ISM, 11 kanałów w USA, 13 kanałów w Europie i innych)
- Moc nadajnika Wi-Fi dla 2,4 GHz: <20 dBm (EIRP)
- Modulacja w transmisji Wi-Fi dla 2,4 GHz: DBPSK, DQPSK, CCK, QPSK, BPSK, 16QAM, 64QAM
- Moc nadajnika 5G WISA: < 14 dBm (EIRP)
- Modulacja dla standardu 5G WISA: OFDM, BPSK, QPSK, 16QAM
- Zakres częstotliwości nadajnika 5G WISA: 5,15 - 5,35 GHz, 5,470 - 5,725 GHz, 5,725 - 5,825 GHz
- Moc nadajnika Wi-Fi dla 5 GHz: < 23 dBm (EIRP)
- Modulacja w transmisji Wi-Fi dla 5 GHz: QPSK, BPSK, 16QAM, 64QAM, 256QAM
- Zakres częstotliwości Wi-Fi dla 5 GHz: 5,15 - 5,35GHz, 5,470 - 5,725GHz, 5,725 - 5,825GHz

1. Information on power consumption.

This equipment complies with European Commission Regulation (EC) No 1275/2008 and (EU) No 801/2013.

Networked standby: 2.0 W

2. The period of time after which the power management function switches the equipment automatically into;
the device shall enter 2.0 W networked Standby automatically in 20 minutes.

How to activate wireless network connections;

- Set up product according to instruction
- Switch into wireless mode (Bluetooth, Wi-Fi)
- Connect with energy using product(s)

How to deactivate wireless network connections;

- The device is intended for use in wireless connections, it is inappropriate to deactivate any wireless connections.

PT-BR

1 APLICATIVO

Configuração do Google Assistente

Baixe o aplicativo Google Home e configure a Citation AMP 250.

Configuração do AirPlay

A Citation AMP 250 pode ser configurada para uso com o AirPlay 2 por meio do aplicativo Apple Casa.

1. Abra o aplicativo casa, toque em **+** e depois em **Add Accessory (Adicionar Acessório)**.
2. Toque em **Don't have a Code (Não Tem um Código)** ou **Can't Scan (Não Pode Escanear?)** e depois na caixa de som.
3. Aguarde enquanto a caixa de som é adicionada. Escolha um nome para a caixa de som e indique o cômodo onde ela será instalada.
4. Toque em **Done (Pronto)**.

A instalação com AirPlay 2 não requer o aplicativo Google Home. No dispositivo iOS, abra **Settings (Configurações)** > **Wi-Fi** e selecione "Citation AMP 250" no menu **SET UP NEW AIRPLAY SPEAKER ... (Configurar Nova Caixa de Som Airplay ...)** Siga as instruções na tela para completar a configuração.

2 APRESENTAÇÃO DO PRODUTO

1x Citation AMP 250; 1x Cabo de energia apropriado para o país e a região; 1x Controle remoto; 1x Cabo HDMI; Kit de montagem em parede

Topo e frente

Tela de toque; Volume; Indicador de atividade

Traseira

Reiniciar; Entrada de áudio; Óptica; HDMI; Liga/desliga

3 CONTROLE E INFORMAÇÕES NA TELA DE TOQUE

Tela de toque: Conexão Wi-Fi; Conexão Bluetooth; Liga/desliga microfone; Fonte

HDMI ARC; Toque para falar com o Google Assistente; Configurar outras caixas de som Citation

4 CONEXÃO A TV

Opção 1 (preferida):

Opção 2 (vendida separadamente):

5 MONTAGEM EM PAREDE DA CITATION AMP 250

Cole o gabarito de papel em uma parede com fita adesiva e perfure os centros dos orifícios de montagem para assinalar o local de instalação dos suportes.

Quando terminar, retire o papel.

Parafuse os suportes de montagem em parede nos pontos marcados a caneta, introduza a barra rosqueada na parte traseira da Citation AMP 250 e fixe-a na parede.

6 PRIMEIROS PASSOS

Conecte a Citation AMP 250 à rede Wi-Fi de sua casa:

Baixe e execute o aplicativo Google Home em um smartphone ou tablet.

Configure a soundbar de acordo com as instruções na tela de toque e no aplicativo Google Home.

* Ligar Bluetooth (iPhone e iPad)

7 LIGAR O MULTIBEAM™ SURROUND SOUND

A calibragem Automatic MultiBeam Calibration (AMC) ajusta as configurações da soundbar para proporcionar a melhor experiência acústica.

8 CHROMECAST

Etapa 1: Abra o aplicativo suportado pelo Chromecast

Etapa 2: Toque uma música

Etapa 3: Toque no ícone do Chromecast e selecione "Citation AMP 250"

p.ex.
Spotify
Pandora
Tuneln
Deezer
Google Play Music

* A soundbar suporta o controle multiambiente do Chromecast. Para mais informações, acesse o aplicativo Google Home.

9 AirPlay

Etapa 1: Entre no Centro de Controle de um dispositivo iOS.

Etapa 2: Toque em  e selecione a caixa de som "Citation AMP 250".

Etapa 3: Inicie o streaming a partir de um aplicativo.

10 GOOGLE ASSISTENTE

Microfone mudo: Desligue o microfone para bloquear o Google Assistente.

Pressione para falar com o Google Assistente

12 ESPECIFICAÇÕES

- Modelo: Citation AMP 250
- Entrada de energia: 100 a 240 V ~ 50 / 60 Hz
- Potência de saída: 210 Wrms
- Versão Bluetooth: 4.2
- Intervalo de frequência de transmissão Bluetooth: 2402 a 2480 MHz
- Potência de transmissão Bluetooth: <10 dBm (EIRP)
- Modulação da transmissão Bluetooth: GFSK,π/4 DQPSK e 8DPSK
- Especificações de conexão sem fio: IEEE 802.11a/b/g/n/ac (2,4 GHz/5 GHz)
- Intervalo de frequência do transmissão Wi-Fi 2.4G: 2412 a 2.472 MHz (banda ISM a 2,4 GHz com 11 canais para EUA ou 13 para Europa e outros locais)

- Potência de transmissão Wi-Fi 2.4G: <20 dBm (EIRP)
- Modulação Wi-Fi 2.4G: DBPSK, DQPSK, CCK, QPSK, BPSK, 16QAM e 64QAM
- Potência máxima de transmissão 5G WISA: <14 dBm (EIRP)
- Modulação 5G WISA: OFDM, BPSK, QPSK e 16QAM
- Intervalos de frequência de transmissão 5G WISA: 5,15 a 5,35 GHz, 5,470 a 5,725 GHz e 5,725 a 5,825 GHz
- Potência máxima de transmissão Wi-Fi 5G: <23 dBm (EIRP)
- Modulação 5G Wi-Fi: QPSK, BPSK, 16QAM, 64QAM e 256QAM
- Intervalos de frequência de transmissão Wi-Fi 5G: 5,15 - 5,35GHz, 5,470 - 5,725GHz, 5,725 - 5,825GHz

1. Information on power consumption.

This equipment complies with European Commission Regulation (EC) No 1275/2008 and (EU) No 801/2013.

Networked standby: 2.0 W

2. The period of time after which the power management function switches the equipment automatically into;
- the device shall enter 2.0 W networked Standby automatically in 20 minutes.

How to activate wireless network connections;

- Set up product according to instruction
- Switch into wireless mode (Bluetooth, Wi-Fi)
- Connect with energy using product(s)

How to deactivate wireless network connections;

- The device is intended for use in wireless connections, it is inappropriate to deactivate any wireless connections.

SV

1 APP

Installation med Google Assistant

Ladda ner Google Hem-appen och installera din Citation AMP 250.

Installation med AirPlay

För användare som endast har AirPlay 2 kan Citation AMP 250 ställas in med Apple Hem-appen.

1. Öppna Hem-appen, tryck **+** och tryck sedan på **Add Accessory (Lägg till tillbehör)**.
2. Klicka på **Don't have a Code (Har ingen kod)** eller **Can't Scan (Kan inte skanna)**, och klicka sedan på högtalaren.
3. Vänta tills din högtalare läggs till. Ge din högtalare ett namn och välj ett rum där den finns.
4. Klicka på **Done (Klar)**.

För användare som endast har AirPlay 2: hoppa över Google Hem-appen. På din iOS-enhet går du till **Settings (Inställningar) > Wi-Fi** och välj "Citation AMP 250" under **SET UP NEW AIRPLAY SPEAKER ... (STÄLL IN NY AIRPLAY-HÖGTALARE ...)** följ instruktionerna på skärmen för att slutföra installationen.

2 PRODUKTÖVERSIKT

CITATION AMP 250 x1; Regional nätkabel x1 (varierar beroende på land);

Fjärrkontroll x1; HDMI-kabel x1; Väggh monteringsssats

Ovansida & framsida

Pejskärm; Volym; Tänds när den är aktiv

Tillbaka

Återställning; Ljud IN; Optisk; HDMI; Ström

3 KONTROLL/INFORMATION OM PEJSKÄRM

Pejskärm: Wi-Fi-status; Bluetooth-status; Mikrofon stäng av/sätt på; HDMI ARC-

källa; Tryck för att prata med Google Assistant; Ställ in andra Citation-högtalare

4 ANSLUT TILL DIN TV

Alternativ 1 (bäst):

Alternativ 2: (säljs separat)

5 VÄGGMONTERA CITATION AMP 250

Använd tejp för att fästa pappersguiden för väggmontering på väggen, tryck spetsen på en penna genom mitten på varje monteringshål för att markera var väggmonteringsfästet ska sitta och ta bort pappret.

Skruva fast väggfästet på pennmärket. skruva fast det gängade monteringsstödet på baksidan av Citation AMP 250 och haka sedan fast Citation AMP 250 på väggen.

6 KOMMA IGÅNG

Lägg till Citation AMP 250 i ditt hem-Wi-Fi-nätverk.

Ladda ner och kör Google Hem-appen på en telefon eller surfplatta.

Följ instruktionerna på pejskärmen och i Google Hem-appen för att slutföra installationen

* Aktivera Bluetooth (iPhone/iPad)

7 STÄLL IN MULTIBEAM™ SURROUND LJUD

Automatisk MultiBeam-kalibrering (AMC) optimerar soundbarens ljudinställningar för en bättre surroundljudupplevelse.

8 CHROMECAST

Steg 1: Öppna appen som stödjer Chromecast

Steg 2: Spela musik

Steg 3: Klicka på cast-ikonen och välj "Citation AMP 250"

t.ex.

Spotify

Pandora
Tuneln
Deezer
Google Play Music

* Enheten kan stödja multirumskontroll som tillhandahålls av Chromecast built-in, för mer information se Google Hem-appen.

9 AirPlay

Steg 1: Gå till Kontrollcentret på en iOS-enhet.

Steg 2: Tryck på  för att välja "Citation AMP 250" som högtalare.

Steg 3: Starta ljudstreaming från en app.

10 GOOGLE ASSISTANT

Mikrofon avstängd: Stäng av mikrofonen för att stoppa Google Assistant från att lyssna.

Tryck för att prata med Google Assistant

12 SPECIFIKATIONER

- Modellnamn: CITATION AMP 250
- Strömförsörjning: 100-240 V ~ 50/60Hz
- Uteffekt: 210 W RMS
- Bluetooth-version: 4.2
- Bluetooth-sändarens frekvensomfång: 2402–2480 MHz
- Bluetooth-sändarens effekt: <10 dBm (EIRP)
- Bluetooth-sändarens modulering: GFSK, $\pi/4$ DQPSK, 8DPSK
- Trådlöst nätverk: 802.11a/b/g/n/ac (2,4 GHz/5 GHz)
- 2,4 G Wi-Fi-sändarens frekvensomfång: 2412 – 2472 MHz (2,4 GHz ISM-band, USA 11 kanaler, Europa och övriga 13 kanaler)
- 2,4 G Wi-Fi-sändarens effekt: <20 dBm (EIRP)

- 2,4 G Wi-Fi-modulering: DBPSK, DQPSK, CCK, QPSK, BPSK, 16QAM, 64QAM
- 5G WISA-sändarens effekt: < 14 dBm (EIRP)
- 5G WISA-modulering: OFDM, BPSK, QPSK, 16QAM
- 5G WISA-sändarens frekvensomfång: 5,15-5,35 GHz, 5,470-5,725 GHz, 5,725-5,825 GHz
- 5G Wi-Fi-sändarens effekt: < 23 dBm (EIRP)
- 5G Wi-Fi-modulering: QPSK, BPSK, 16QAM, 64QAM, 256QAM
- 5G Wi-Fi-sändarens frekvensområde: 5,15 - 5,35GHz, 5,470 - 5,725GHz, 5,725 - 5,825GHz

1. Information on power consumption.

This equipment complies with European Commission Regulation (EC) No 1275/2008 and (EU) No 801/2013.

Networked standby: 2.0 W

2. The period of time after which the power management function switches the equipment automatically into;
the device shall enter 2.0 W networked Standby automatically in 20 minutes.

How to activate wireless network connections;

- Set up product according to instruction
- Switch into wireless mode (Bluetooth, Wi-Fi)
- Connect with energy using product(s)

How to deactivate wireless network connections;

- The device is intended for use in wireless connections, it is inappropriate to deactivate any wireless connections.



The Bluetooth® word mark and logos are registered trademarks owned by Bluetooth SIG, Inc. and any use of such marks by HARMAN International Industries, Incorporated is under license. Other trademarks and trade names are those of their respective owners.



The Wi-Fi CERTIFIED™ Logo is a certification mark of the Wi-Fi Alliance®.



Manufactured under license from Dolby Laboratories. Dolby, Dolby Audio, and the double-D symbol are trademarks of Dolby Laboratories.



The terms HDMI, HDMI High-Definition Multimedia Interface, and the HDMI Logo are trademarks or registered trademarks of HDMI Licensing Administrator, Inc.



Chromecast built-in, Google Play and the Google Play logo are trademarks of Google LLC.



Apple®, AirPlay®, iPad®, iPad Air®, iPad Pro®, and iPhone® are trademarks of Apple Inc., registered in the U.S. and other countries.

Use of the Works with Apple badge means that an accessory has been designed to work specifically with the technology identified in the badge and has been certified by the developer to meet Apple performance standards. To control this AirPlay 2-enabled speaker, iOS 11.4 or later is required.

CH_HK_CITATION AMP 250_QSG_EMEA_PV_V8