

LIMITED WARRANTY STATEMENT

The manufacturer warranties safe operation and reliability only under the following conditions:

- The product is installed and operated according to the assembly and operating instructions.
- Only original replacement parts are used.

General Terms

This Limited Warranty applies to the enclosed product (the “Product”) distributed by Great American Duck Races, Inc., an Arizona corporation (doing business as Great American Marketing and Events) (“GAME”). • GAME warrants that the Product will be free from defects in materials and workmanship under normal use for a period of ninety (90) days from the date of purchase. (Your dated sales or delivery receipt, showing the date of your Product purchase, is your proof of the purchase date.) During the warranty period, GAME will repair or replace any defective parts at no charge. • All defective parts that are replaced by GAME will be replaced, at GAME’s discretion, with either new parts or used parts that meet or exceed performance specifications for new parts. All parts removed from the Product under this warranty will become the property of GAME. Repair or replacement of any parts will not serve to extend the ninety (90) days warranty period. • This Limited Warranty does not apply to expendable parts. This Limited Warranty does not extend to any product (a) from which the serial number has been removed or (b) that has been damaged or rendered defective (i) as a result of accident, misuse, abuse or other external causes; (ii) by operation outside the usage parameters stated in the manual that shipped with the Product; (iii) by the use of parts not manufactured or sold by GAME; or (iv) by modification or service by anyone other than GAME or an authorized GAME distributor. • If a defect is identified within the warranty period, please contact GAME.

EXCEPT FOR THE LIMITED WARRANTY SET FORTH ABOVE, GAME EXPRESSLY DISCLAIMS ALL OTHER WARRANTIES, WHETHER EXPRESS OR IMPLIED, ORAL OR STATUTORY (INCLUDING, WITHOUT LIMITATION, WARRANTIES OF MERCHANTABILITY AND FITNESS FOR A PARTICULAR PURPOSE). ANY IMPLIED WARRANTIES THAT MAY BE IMPOSED BY LAW ARE LIMITED TO THE TERMS OF THE ABOVE LIMITED WARRANTY.

Limitation of Liability

EXCEPT FOR THE LIMITED WARRANTY DESCRIBED ABOVE, IN NO EVENT WILL GAME HAVE ANY LIABILITY OF ANY KIND WHATSOEVER (WHETHER UNDER CONTRACT, TORT, OR ANY OTHER THEORY OF LEGAL LIABILITY) TO ANY PERSON WITH RESPECT TO THE PRODUCT (INCLUDING, WITHOUT LIMITATION, (A) ANY USE OR MISUSE OF THE PRODUCT, (B) ANY FAILURE OR MALFUNCTION OF THE PRODUCT, (C) ANY BODILY INJURY, DEATH, LOSS OF OR DAMAGE TO ANY PROPERTY, OR ANY OTHER DAMAGES RELATED TO OR RESULTING FROM THE PRODUCT OR ITS USE (INCLUDING, WITHOUT LIMITATION, ANY SPECIAL, INCIDENTAL, CONSEQUENTIAL OR PUNITIVE DAMAGES, LOST PROFITS, LOSS OF USE), EVEN IF GAME OR GAME’S AUTHORIZED REPRESENTATIVES HAVE BEEN ADVISED OF THE POSSIBILITY OF ANY SUCH DAMAGES.

Severability

Any provision of this Limited Warranty which is prohibited or unenforceable in any jurisdiction will, as to such jurisdiction, be ineffective to the extent of such prohibition or unenforceability without invalidating the remaining portions hereof or affecting the validity or enforceability of such provision in any other jurisdiction.

Venue and Choice of Law

This Limited Warranty is applicable in all countries. This Limited Warranty will be governed by the laws of the State of Arizona (regardless of any conflict of laws rules), and any disputes arising from this Limited Warranty will be resolved in Phoenix, Arizona.

Entire Agreement

This Limited Warranty is understood to be the complete and exclusive agreement between GAME and the purchaser of the Product, superseding all prior agreements, oral or written, and all other communications between such parties relating to the Product. No employee or representative of GAME or any other party is authorized to make any warranty in addition to the limited warranty set forth above.

To obtain warranty service, please call, write, or email us directly at the address shown below.

This warranty gives you specific legal rights, and you may also have other rights which vary from state to state.

DIGITAL WIRELESS THERMOMETER
OWNER’S MANUAL

MODEL 4302



Look for other GAME products at your favorite store or visit
our website, www.game-group.com.



Great American Merchandise & Events™
16444 N. 91st Street
Scottsdale, AZ 85260-1567 USA

tel: 888.382.5988, 602.957.3825
fax: 602.957.7665
email: products@game-group.com
www.game-group.com



RECEIVER

Front View

- 1. Probe battery strength
- 2. Temperature
- 3. Temperature Scale
- 4. Receiver battery strength
- 5. Signal indicator

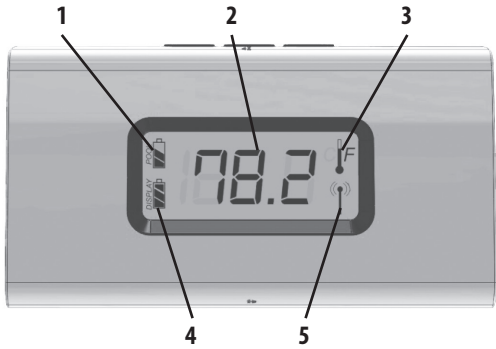

Top Buttons Functions

- 1. Transmitter button
- 2. Screen light
- 3. C°/F° button

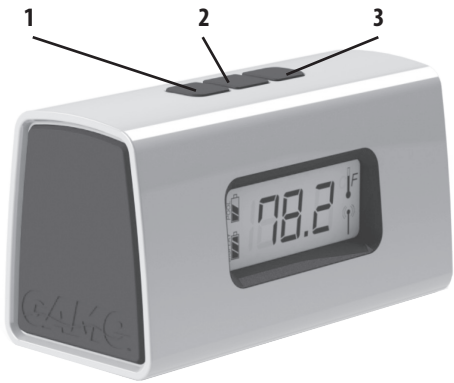

RECEIVER Back View

- 1. Battery compartment
- 2. Wall mount

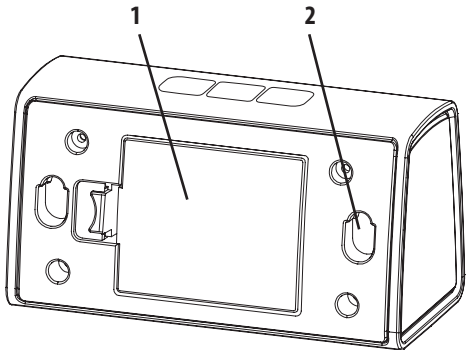

REMOTE SENSOR

Probe Front View

- 1. C°/F° button
- 2. Battery strength indicator
- 3. Temperature
- 4. LCD temperature display
- 5. Transmitter icon
- 6. Transmitter button
- 7. Battery cover
- 8. Transmitter LED indicator

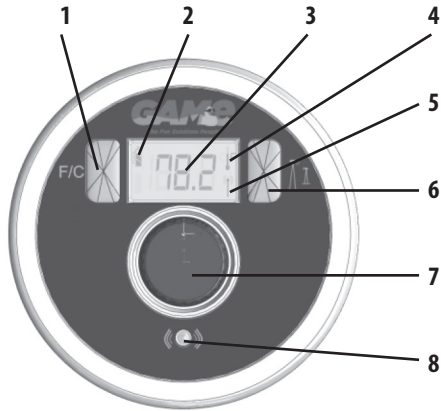

Exploded View

- 1. Battery Cover
- 2. Probe Body
- 3. Sensor Cover

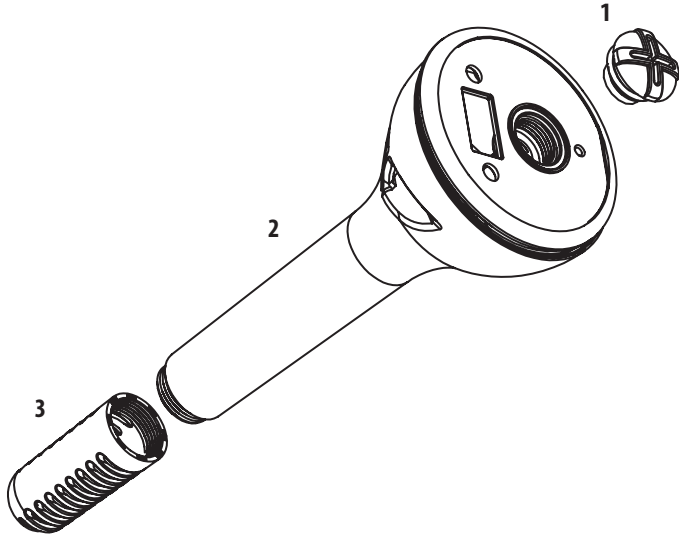

SPECIFICATIONS

Range of temperature measurement:

Receiver	-0 °C to 50 °C (32°F to 122°F)
Remote sensor	-50 °C to 70 °C (-58°F to 158°F)
Transmission	100M (300 ft.) open area, RF 433 MHz
Resolution	0.1 degree
Battery life	3 months (alkaline batteries recommended)

Note

- Always read the owner’s manual carefully before operating the unit.
- Avoid placing the receiver near interference sources/metal frames such as computer or TV sets.
- The receiver loses its time information when the battery is removed.
- The unit will automatically exit all menus after 8 seconds without adjustment.
- The remote sensor transmits every 2.5 minutes if the temp change is less than 0.5 °C / 1.1 °F. If the temperature change is more than 0.5 °C / 1.1 °F it will transmit every 30 seconds. The remote sensor will measure temperature every 10 seconds.

RECEIVER BATTERY INSTALLATION

For first time installation, always insert batteries in the receiver unit and then the remote sensor. The receiver will seek a sensor within range.

- 1- Open the battery cover of the back unit.
- 2- Install 3 AAA batteries according to polarity indicated.
- 3- Replace the batteries compartment cover

SETTING UP THE SENSOR

- Screw and install the sensor cover.
- Place the sensor as close to the receiver as possible.
- Remove the battery cap.
- Install three AAA batteries according to polarity indicated.
- Screw and tighten the battery cap.
- The red LED on the remote sensor will flash when it transmits a signal. Temperature of the remote sensor will be updated and displayed on the sensor’s LCD.
- Press the “°C/°F” button on the back of the remote sensor to change from Fahrenheit to Celsius.

LOW BATTERY INDICATOR

There are two Low battery indication on the receiver and one on the prob. A Low Battery warning icon will appear on the Probe screen and on the receiver screen. When the low battery indicator appears, replace the batteries and follow the setup procedure as mentioned in this instruction manual.

FCC STATEMENT

FCC Information and Copyright

This equipment has been tested and found to comply with the limits for a Class B digital device, pursuant to part 15 of the FCC Rules.

These limits are designed to provide reasonable protection against harmful interference in a residential installation. This equipment generates,

uses and can radiate radio frequency energy and, if not installed and used in accordance with the instructions, may cause harmful interference

to radio communications. However, there is no guarantee that interference will not occur in a particular installation. If this equipment does

cause harmful interference to radio or television reception, which can be determined by turning the equipment off and on, the user is

encouraged to try to correct the interference by one or more of the following measures:

- Reorient or relocate the receiving antenna.
- Increase the separation between the equipment and receiver.
- Connect the equipment into an outlet on a circuit different from that to which the receiver is connected.
- Consult the dealer or an experienced radio/TV technician for help.

This device complies with part 15 of the FCC Rules. Operation is subject to the following two conditions:

- (1) This device may not cause harmful interference, and
- (2) this device must accept any interference received, including interference that may cause undesired operation.

changes or modifications not expressly approved by the party responsible for compliance could void the user's authority to operate the equipment.