

⚠ WARNING

- **INGESTION HAZARD:** This product contains a button cell or coin battery.
 - **DEATH** or serious injury can occur if ingested.
 - A swallowed button cell or coin battery can cause Internal Chemical Burns in as little as **2 hours**.
- KEEP** new and used batteries **OUT OF REACH Of CHILDREN**
- **Seek immediate medical attention** if a battery is suspected to be swallowed or inserted inside any part of the body.



WARNING

- a) Remove and immediately recycle or dispose of used batteries according to local regulations and keep away from children. Do NOT dispose of batteries in household trash or incinerate.
- b) Even used batteries may cause severe injury or death.
- c) Call a local poison control center for treatment information
- d) the compatible battery type is CR2450.
- e) the nominal battery voltage is DC3V.
- f) Non-rechargeable batteries are not to be recharged.
- g) Do not force discharge, recharge, disassemble, heat above (manufacturer's specified temperature rating) or incinerate. Doing so may result in injury due to venting, leakage or explosion resulting in chemical burns."
- h) Ensure the batteries are installed correctly according to polarity (+ and -).
- i) Do not mix old and new batteries, different brands or types of batteries, such as alkaline, carbon-zinc, or rechargeable batteries.
- j) Remove and immediately recycle or dispose of batteries from equipment not used for an extended period of time according to local regulations.
- k) Always completely secure the battery compartment. If the battery compartment does not close securely, stop using the product, remove the batteries, and keep them away from children.



FCC Warning

This device complies with part 15 of the FCC Rules. Operation is subject to the following two conditions: (1) This device may not cause harmful interference, and (2) this device must accept any interference received, including interference that may cause undesired operation. Any Changes or modifications not expressly approved by the party responsible for compliance could void the user's authority to operate the equipment. Note: This equipment has been tested and found to comply with the limits for a Class B digital device, pursuant to part 15 of the FCC Rules. These limits are designed to provide reasonable protection against harmful interference in a residential installation. This equipment generates, uses and can radiate radio frequency energy and, if not installed and used in accordance with the instructions, may cause harmful interference to radio communications. However, there is no guarantee that interference will not occur in a particular installation. If this equipment does cause harmful interference to radio or television reception, which can be determined by turning the equipment off and on, the user is encouraged to try to correct the interference by one or more of the following measures:

- Reorient or relocate the receiving antenna.
- Increase the separation between the equipment and receiver.
- Connect the equipment into an outlet on a circuit different from that to which the receiver is connected.
- Consult the dealer or an experienced radio/TV technician for help.

Note: The Grantee is not responsible for any changes or modifications not expressly approved by the party responsible for compliance. such modifications could void the user's authority to operate the equipment.

The device has been evaluated to meet general RF exposure requirement.

To maintain compliance with FCC's RF exposure guidelines, the distance must be at least 20 cm between the radiator and your body, and fully supported by the operating and installation

INSTALLATION MANUAL

MODEL NO.: 2BRY7-96686WS

Product & Accessory

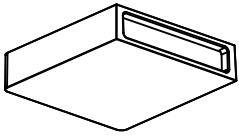

1*LED wireless sensor
(RF wireless emitter
of door switch)

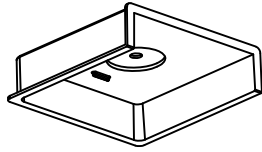

1*installation bracket



1*screw



1* magnet piece

Installation Tools



screw driver

Surface mounting instruction

A1

suggested distance for
installation 24mm

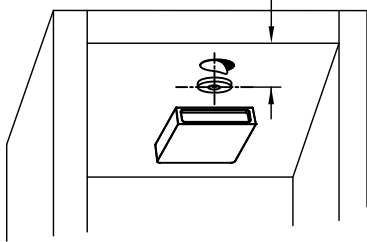

- 1.Clean the surface and fix the magnet piece onto the cabinet board with double-sided adhesive tape.

A2

surface installation for single door use

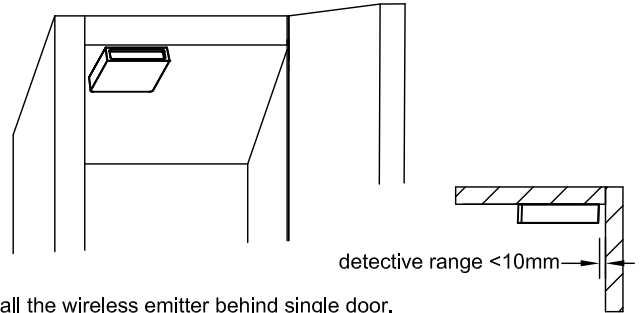

- 1.Install the wireless emitter behind single door.

B1

suggested distance for
installation 24mm

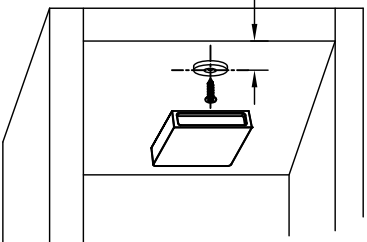

- 1.Clean the surface and fix the magnet piece onto the cabinet board with double-sided adhesive tape.

B2

surface installation for double doors use

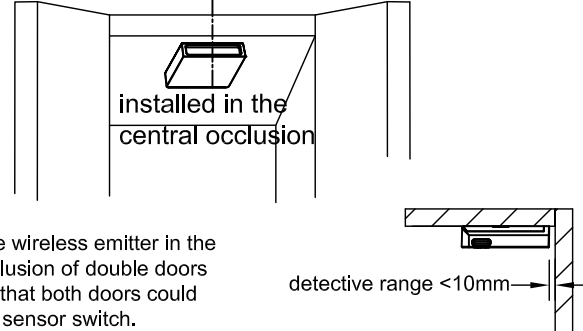

- 1.Install the wireless emitter in the central occlusion of double doors cabinet so that both doors could control the sensor switch.

Recessed mounting instruction

C1

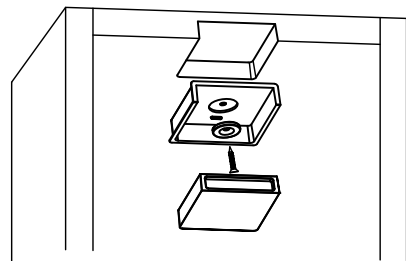

- 1.Make slot for inserting the wireless emitter, clean the surface, and stick magnet piece onto installation bracket with double-sided adhesive tape in the back.
- 2.Put the wireless emitter into the installation bracket and magnet will hold it in place.

C2

recessed installation for single door use

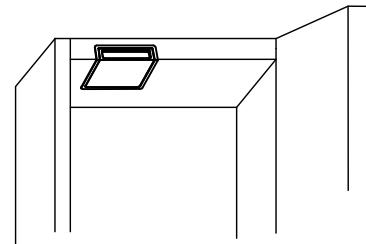

- 1.Install the wireless emitter behind single door.

D3

recessed installation for double doors use

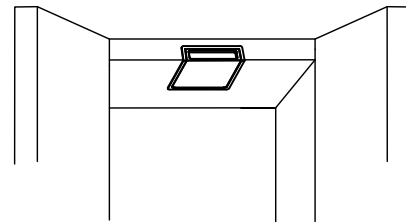

- 1.Install the wireless emitter in the central occlusion of double doors cabinet so that both doors could control the sensor switch.

Slotting size

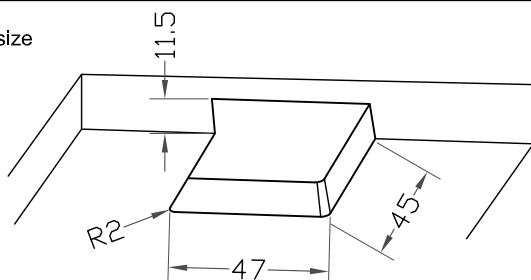

INSTALLATION MANUAL

MODEL NO.: 2BRY7-96686WS

Function Description

This product is intended for use with low-voltage lighting systems, please install and use it in accordance with the requirements of National Electrical Code Article 411.

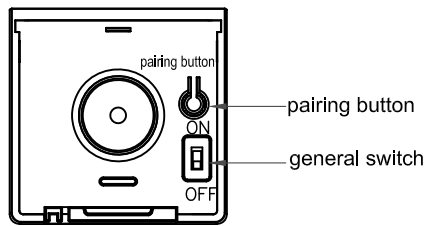

sensor detector
indicating light
of working
sensor detector

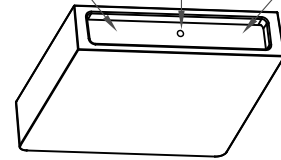

Pairing/Unpairing

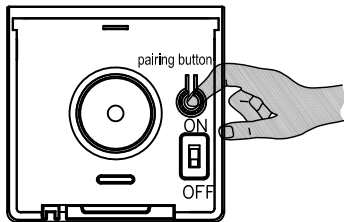

1. Pairing: Press the pairing button on the emitter within 3seconds after receiver connected to the power supply, it's successfully paired when the output light flash .
2. Unpairing: Long press (over 3S) the pairing button on the emitter within 3seconds after receiver connected to the power supply, it's successfully unpaired when the output light flash .
3. One receiver can be paired with multiple emitters, one emitter can be paired with max. eight receivers. (one receiver and one emitter already paired in production, pls do the multiple pairing and unpairing by yourself.)

Battery change

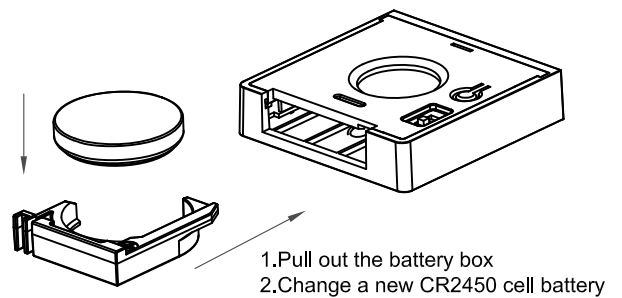

Normal LED power supply+ RF wireless sensor

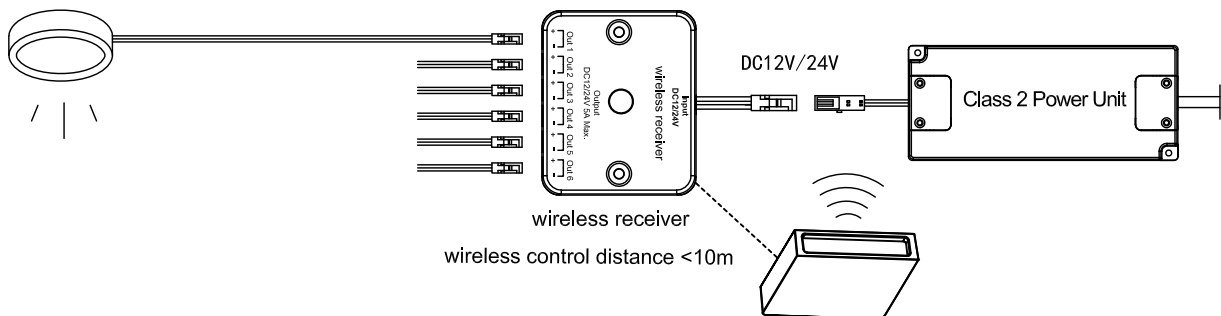

Smart LED driver+ RF wireless sensor

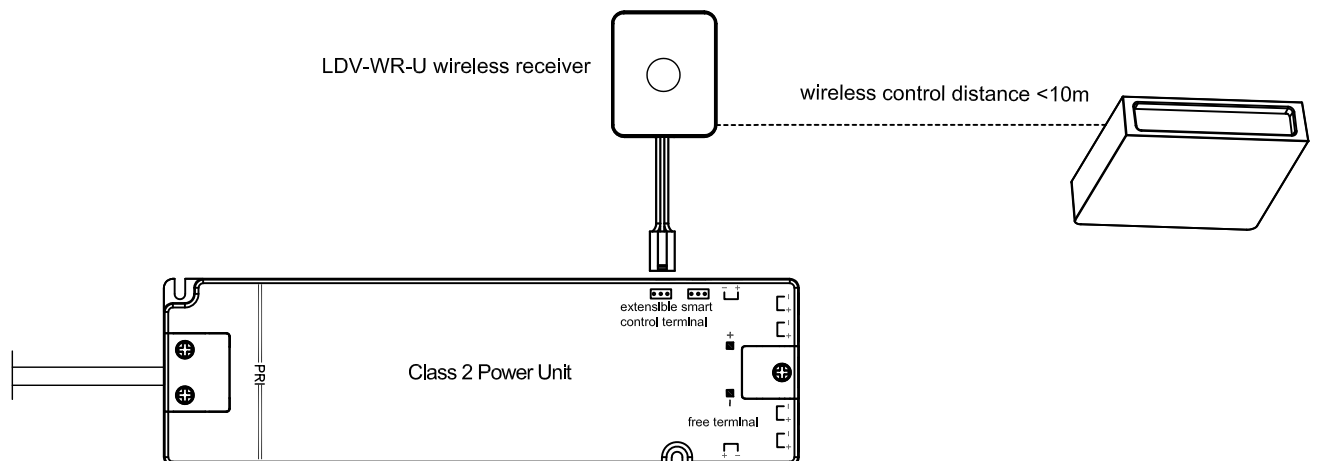

Working principle: it is an exclusive design for Class III 2.4G radio frequency application.

Function:

Door sensor switch (single and double detectors): light switch on when door opens, and light switch off when door closes; for double door application, light switch on when any door opens, and light switch off when both door close.