

Handbag instruction manual

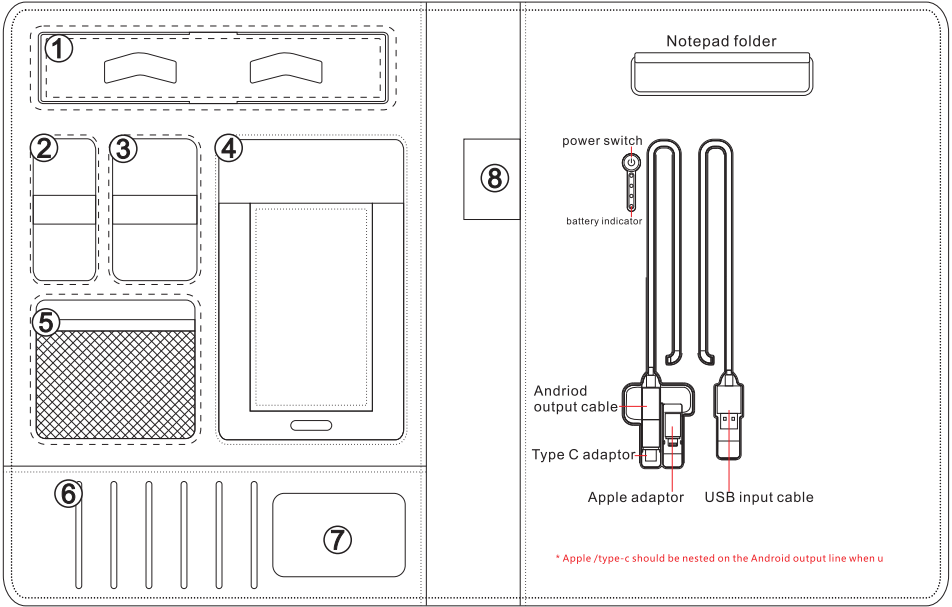

- ①: Mobile phone holder ②: Data cable storage bag ③: Key storage bag
④: Mobile phone storage bag ⑤: Mesh storage bag ⑥: Card insertion*6
⑦: Transparent Window ⑧: Pen hanging



- LED display for residual power
- When residual power is lower than 25%
 - Residual power is between 25% -50%
 - Residual power is between 50%-75%
 - Residual power is between 75% -100%
- Switch of power supply
- Connect it with mobile phone and press this button. It will charge to the mobile phone.

1. Extract the USB drive
2. Insert the Udisk into the reading device for use
- * pay attention to the pros and cons when connecting the usb flash drive to the computer

- warning specifications
1. It is prohibited to disassemble, collide, squeeze or throw into fire.
 2. If severe swelling occurs, do not continue to use.
 3. Do not place in a high temperature environment.
 4. Do not use after soaking in water.
 5. Small batteries that may be ingested by children must be placed in the hands of children Out of reach.
 6. Do not swallow the battery as swallowing may cause burns.
 7. If swallowed accidentally, seek medical attention promptly.
 8. Users should use products that comply with applicable standards and CCC certification The power adapter charges the device.

FCC Warning

This device complies with part 15 of the FCC Rules. Operation is subject to the following two conditions:

- (1) This device may not cause harmful interference, and
- (2) this device must accept any interference received, including interference that may cause undesired operation.

Any Changes or modifications not expressly approved by the party responsible for compliance could void the user's authority to operate the equipment.

Note: This equipment has been tested and found to comply with the limits for a Class B digital device, pursuant to part 15 of the FCC Rules. These limits are designed to provide reasonable protection against harmful interference in a typical installation. This equipment generates uses and can radiate radiofrequency energy and, if not installed and used in accordance with the instructions, may cause harmful interference to radio communications. However, there is no guarantee that interference will not occur in a particular installation. If this equipment does cause harmful interference to radio or television reception, which can be determined by turning the equipment off and on, the user is encouraged to try to correct the interference by one or more of the following measures:

- Reorient or relocate the receiving antenna.
- Increase the separation between the equipment and receiver.
- Connect the equipment into an outlet on a circuit different from that to which the receiver is connected.
- Consult the dealer or an experienced radio/TV technician for help.

The FCC certification of this device refers to RF exposure testing performed in typical operating conditions, where a person is closer than 0 cm from the device surface at all times, except for non-repetitive patterns with transient time intervals in the order of a second. Only in the stated conditions, the device is shown to fully comply with the FCC RF Exposure requirements of KDB 447498.