

15WCoil specifications

、 boundary dimension

(unit: mm)

A	42.5 MAX
B	39.0±1
C	17.0±0.5
D	5.3
E	8.0 ref
F	3-1
G	1.8 Max
H	140.0±2
I	0.80 MAX(Disk thickness)

(1)wire diameter : 0.08\*105P\*12TSilk-covered wire  
 (2)Number of turns in the coil: 11TS  
 (3)Do the end lines intersect: yes  
 (4)8MM high-temperature adhesive tape for coils  
 (5)The coil and the magnetic sheet need to be adhered in the center.  
 (8)Magnetic disk arm surface with 39 circular white backing adhesive

第 1 页

+, electrical characteristics:

parameter	specification	test condition	test instrument
L0	6.8±5% pH	100KHz/1V	□TH1816
Q	>40 min	100KHz/1V	□TH1816
DCR	<50 mΩ	@25°C	■CH-502BC

Watch coil specifications

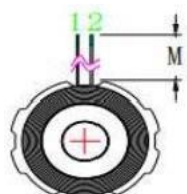
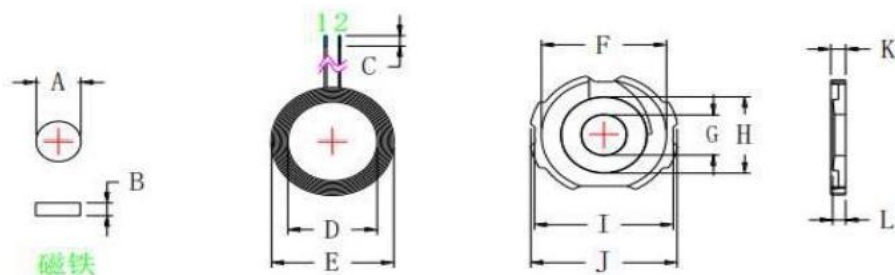

A	7.65±0.1
B	2.5±0.1
C	2.0±1
D	15.0±0.2
E	20.5±0.5
F	21.5±0.2
G	7.7±0.1
H	14.5±0.1
I	23.5±0.2
J	25.0±0.2
K	2.5±0.15
L	2.4 ± 0.1
M	10±1

hear

5W coil specification

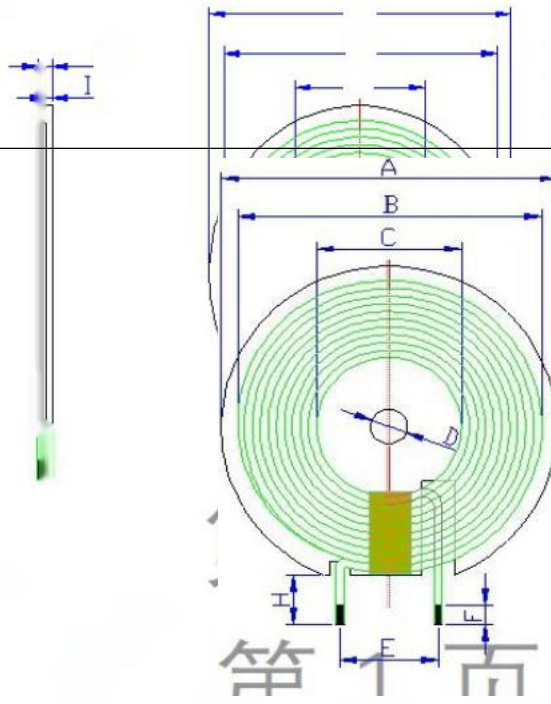

+、boundary dimension

(unit: mm)

A	42.5 MAX
B	39.0±1
C	17.0 ±0.5
D	5.3
E	8.0 ref
F	3-1
G	<b>1.8 Max</b>
H	30.0±2
I	<b>0.70 MAX(Disk thickness)</b>

(1) Wire diameter: 0.08 \* 24P \* 2 bare copper wire

(2) Number of turns in the coil: 11TS

(3) Does the tail line cross over: Yes

(4) 8MM diameter high-temperature adhesive tape

(5) The coil and the magnetic sheet need to be adhered in the center.

(B) 39 solid white adhesive on the back of the magnetic sheet

+、electrical specification:

parameter	specification	test condition	test instrument
L0	6.8±5% pH	100KHz/1V	<input type="checkbox"/> TH1816B
Q	>40 min	100KHz/1V	<input type="checkbox"/> TH1816B
DCR	<50 mΩ	@25°C	<input type="checkbox"/> CH-502BC