

A110

user's manual

hello

Thank you for buying our company dashcam. Please read the manual carefully before use and keep it for reference. If you need any assistance, please contact our customer support team.

matters need attention

- ✧ Please use our Recorder Special Adapter, our special adapter works only for our recorder, please do not give your phone or other device charged by our Recorder Special Adapter which will cause damage to your phone or other devices. If you need to purchase a car adapter, make sure to use the following specifications: input: 12~24V, output: 12V.
- ✧ Do not be exposed to heat over 50°C or direct sunlight, especially in the car.
- ✧ Do not operate the recorder while driving to avoid traffic accidents caused by distraction.
- ✧ For safety reasons, be sure to open the screen saver function during driving.
- ✧ Do not remove the TF card during the recording process.
- ✧ Prevent it from falling.
- ✧ Keep the recorder away from the water and the liquid. This may cause the recorder to fail.
- ✧ If the equipment overoverheated, produces unnecessary smoke or unpleasant smell, immediately remove from the power outlet to prevent fire hazard.
- ✧ For the first time, make sure that the equipment is firmly fixed, and then start and drive the car to prevent the equipment from falling, injuring passengers or damaging the car glass, or the equipment is damaged by the fall.
- ✧ Do not try to open the case of the recorder or repair it in any way, if the recorder has been separated, the warranty will be invalid.

structural description



Product size: DVR-3.2 inches

Model number: A110

Description: Hd dashcam

1-Camera

- "Shoot" window

2-Recorder holder

- Install and secure the recorder.

3-The LCD display screen

- A 3.2-inch HD display screen.

4-Speaker

- Sound remind.

5-Power interface-Type-C

- Connect the external power supply, including charging the battery and providing the working power supply.

6-Micro SD card slot

- Install and uninstall the Micro SD card.

7-Power key / screen backlight switch

- Function 1: switch machine function

In standby mode, press [Power button] when the screen is on to enter the screen protection function, and automatically exit the screen protection function

- Function 2: Screen backlight switch

In the shutdown state, long press [power key] and hold for 3 seconds to turn on the local power supply, the machine will automatically start to work. Press [power button] under the startup state and keep it for 3 seconds to automatically save the video file and user Settings and shut down

8-M menu key / playback key

- Function 1: Menu function

In standby state, press M key to enter the main menu function setting table, press [up key] or [down key], select the options to be set, and press [OK key] to confirm. After setting, press [M] to exit the menu

- Function 2: playback key

In standby video mode, long press M to enter playback mode to view the normal video recorded by the recorder, emergency video, and pictures

9-Turn up / turn on the Wi-Fi / recording switch

- Function 1: Upper page turning function

Press [Up] in menu settings and playback mode.

- Function 2: Turn on the Wi-Fi system

In preview mode, long press [Up] to open the Wi-Fi function

- Function 3: the recording switch

In video mode, press [flip button] to turn off the recording function, and press [flip button] again to open the recording.

10-Down button / quick photo / front and rear lens switch

- Function 1: Upper page turning function

Short press [Down] in menu Settings and playback mode

- Function 2: take photos quickly

In standby video mode, long press [down key] for the quick camera function

- Function 3: front and rear lens switching

In standby video mode, short press [turn single front record display, before and after split screen display, single after recording display

Key] can switch the front and rear shots, single front record display, front and rear screen display, single back record display

11-OK bond

- Function 1:, setting confirmation

After entering the system setting, press OK to confirm the adjustment items;

- Function 2: Start up and close the video recording

In video mode, press [OK] to start the recording and press [OK] again to stop the recording

12-AV interface

- Rear-sight rear-pull interface,

memory card

The recorder is compatible with 16GB, 32G, and 64GB. A 128GB micro SD memory card. You must use at least a level 10 micro SD card. We strongly recommend the use of branded memory cards purchased from regular channels for maximum reliability and stability in recorded and high vibration activities.

- **Insert the Micro SD card**

Slide the memory card into the SD card slot facing the card screen label, and the card will lock in place when fully inserted. Please insert the memory card in the correct manner as described in the instructions.

If not, the card slot may be damaged by the wrong card insertion.

- **Remove the Micro SD card**

Stick the nail on the edge of the memory card, press gently, and remove the memory card.

matters need attention:

- To avoid damaging the SD card and data, do not remove or insert the SD card when the device is powered on.
- Before use, please format the micro SD memory card on the recorder.
- Please carefully remove the Micro SD card as the card may jump out and be lost.
- To keep your micro SD card in good shape, please reformat it regularly.
- Reformatting removes all content, so make sure to download these files first.

begin

- **"Automatic recording"**

Verify that the recorder is connected to a cigarette lighter socket in the car. When the car engine is started, the recorder will automatically turn on and start recording, and when the car engine is off,

The recorder will close and stop recording.

Note: The recorder does not have an internal battery and must be connected to an external power supply to operate.

Set the feature profile

1. Wi-Fi

- The Wi-Fi function is turned off by default, and using the Wi-Fi function requires manually turning on the Wi-Fi function

2. Resolution

- The recorder default 2K resolution, the menu can choose 1080P, can be selected according to the requirements

3. Cycling video recording

- The recorder by default will loop for 1 minute to save a video, optional / 1 minute / 3 minutes / 5 minutes, when the TF card storage is full, the recorder will cover the earlier recorded image;

4. Recording

- The recorder recording function is turned on by default and can be closed according to demand

5. Pull the mirror image in the back side

- Users can adjust the mirror function on or off according to the preview interface display

6. Screen protection

- The screen saver is turned off by default, and you can choose 1 minute, 2 minutes and 3 minutes. After the screen saver is opened, the screen will be turned off if there is no touch during use

[point out]

The recording continues after the screen is turned off

7. Preview mode

- The recorder can display the front recording by default, and can select the rear display or split screen display according to the requirements

8. Volume

- The default sound of the recorder is high, which can set the off, low, medium and high according to the demand

9. Gravity sensing / collision detection

- The recorder has a built-in collision sensor (G-sensor). In case of a serious vehicle collision, the recorder will lock the video of the accident as a special image, and the red video icon above the display screen changes to the yellow icon. Locked images are not covered by cycles.

[point out]

The Collision sensor (G-sensor) supports sensitivity adjustment, and changes the settings in the Settings menu according to the actual needs

10. Shed-down time for video duration

- Time reduction video: it is a shooting technology to compress the time, which takes a group of photos or videos, later through the photo series or video frame, the process of several minutes, several hours or even several years in a short period of time in the way of video playback
- The reduced video can be selected as close, 12H, 24H, 72H, and the default state is closed. When the reduced video is selected, if the car is stalled, ACC is disconnected, the main interface of the recorder will prompt "enter the reduced video" prompt box, and then enter the streaming media interface, the video mode is reduced video mode, and close the screen after 5s. If a touch operation occurs in 5s or a touch operation occurs after the screen closing, the screen will be closed again after 10s. When the car is started again and the ACC is powered on, exit the reduced video and display the prompt box "exit the reduced video";.

Note: Special pressure lowering line should be used, not other recorder pressure lowering line

11. Shed-down version of the video

- This menu is reduced video frame rate selection can choose 1 second 1 frame, 1 second 2 frames, 1 second 5 frames, 1 frame, 1 second: one minute can record 30 minutes of video; 5 frames and 5 seconds: one minute can record 6 minutes of video;

Note: This feature needs to be ACC turned on, otherwise this feature does not appear.

12. Language settings

- Recorder built-in multiple languages, default English display, language display can be selected according to the requirements

13. Date setting

- On the system Settings menu, press [Up] / [Down] to move the cursor to the set date option. Short press [confirm key] to enter, short press [mode key] to switch between years, month, day, hours, minutes, seconds, short press [flip key] / [flip key] to add or subtract the corresponding time, after setting, short press [confirm key] to exit.

[Note] In order to effectively record the evidence collection date and time of driving safety accidents, please set the correct date and time before using the local machine.

14. Time zone

- The default time zone UTC + 8:00, the corresponding time zone can be selected according to different countries

15. GPS Information

- Enter the setting menu to query the current GPS signal situation of the recorder, and confirm whether the location and

GPS star value

16. Format the storage card

- The new card inserted into the recorder will automatically pop up the formatting interface, and the formatting function can also be operated in the setting interface

[Note] In order to effectively record the normal operation of driving, it is recommended to format the memory card on a monthly basis

17. Restore the factory settings

- Doing this restore factory settings feature restores the previously changed settings options to the factory default settings

18. Software version

- Select the Software Version menu to view the software information for this recorder

Instrument board recorder installation



1. Before installation, remove the dirt from the windshield
2. Peel off the 3M adhesive protective film from the recorder holder.
3. Press the recorder holder firmly against the windshield.
4. Plug the USB car charger into the car's cigarette lighter socket.
5. Connect the USB wires along the clearance on the roof.
6. Turn the end of the USB wire around the rearview mirror several times to prevent the recorder from falling.
7. Plug the Micro USB head of the car charger into the power interface of the camera
8. Adjust the camera to the right angle to ensure that the front of the car is visible from the recorder screen.

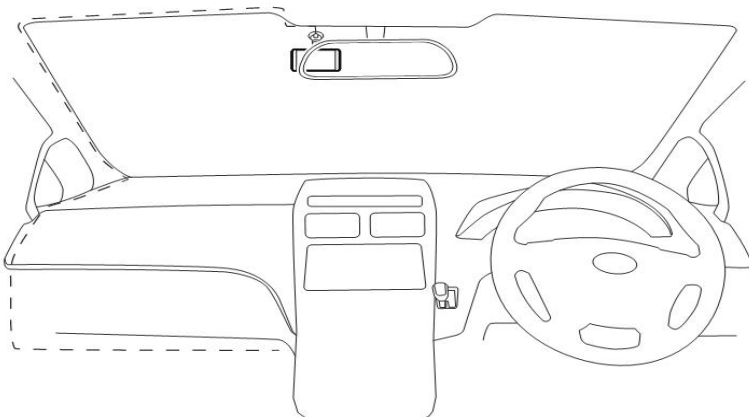

Mobile phone application

Download and install the Windrecorder app

Option 1: Download the wind recorder app from Google Play or the Apple App Store to your phone.



Option 2:

Scan the QR code below to download the app to your phone.



The recorder is connected to the APP

Verify that your recorder is open.

1. Start the wind recorder app on your phone;
2. Click "Agree" to start using the app;
3. Click "Next" to get the permissions;
4. Click "allowed only in use" to allow the application to access the location of the recorder camera;
5. Click "allow" to allow the application to access the files of the recorder camera;

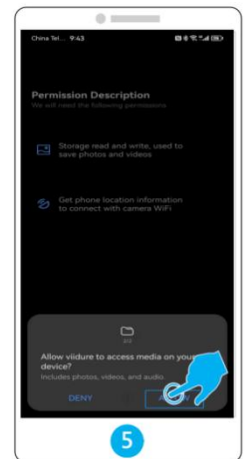
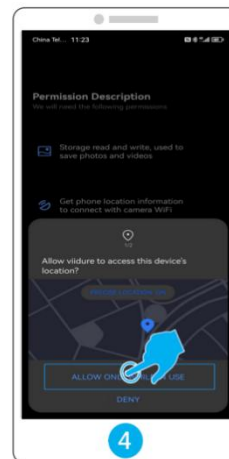
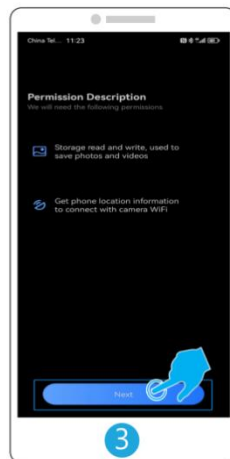
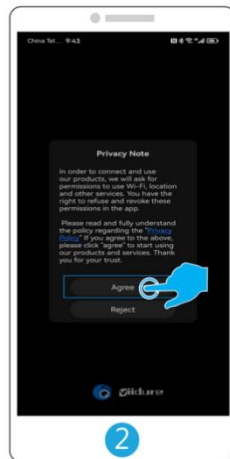

6. Click "Add recorder" to let the app connect to your recorder camera;
7. Click "Next" to enter the mobile phone Wi-Fi system
8. Click on the SSID of the recorder and enter the PWD "12345678"
9. Click the "Return" icon to exit the phone Wi-Fi system
10. Click "Access recorder" to enter.



Overview of the application

Verify that the recorder is connected to your phone and enter the air recorder APP:

Application Home Page

1.Camera mode

The default is in the photo-taking mode

2.Local album

Recorder for local video and photo albums

3.My recorder

Select the connected camera

4.Add a new recorder

Add a new camera to connect to

5.Enter the recorder

Enter the recorder for operation

6.Application information

Application Setup / version update / support

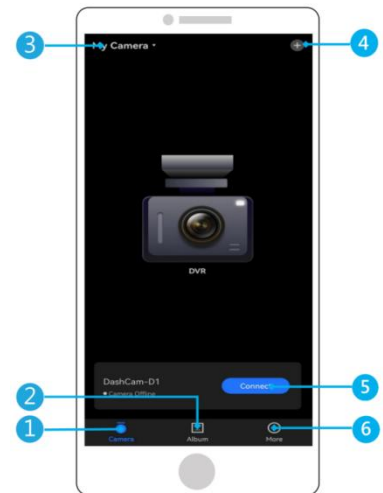

Application operation

1.return

Back to the home page

2.Video buttons

Start / stop recording the video

3.Photo shutter

take a picture

4.Recorder file

Playback / download / delete logged files

5.Recorder setting

Set up the recorder

6.microphone

Microphone is switched on / off

7.Display mode

Switch display mode

8.Preview window

Display real-time images

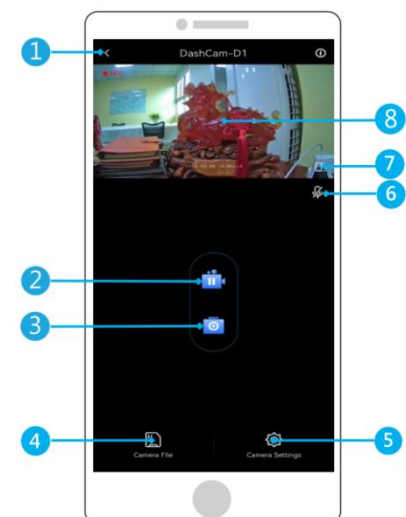

debugging

Q: Why does the recorder always say "no card inserted"?

A: 1. Please ensure that the memory card is level 10 and above.

2. First, by formatting the memory card on the computer. When you format it on your computer, select FAT 32 (Default) on the file system. Then format it in the recorder.

Q: The recorder can no longer work.

A: Please check whether the memory is full. If so, please save the file and format the SD card.

Q: The image is very blurred.

A: The windshield will reflect the light, please adjust the recorder.

Q: The recorder often loses its power supply.

A: Because the vehicle design is different, please rotate the car charger for adjustment to maintain stability.

Q: The recorder cannot be opened.

A: Make sure the power supply indicator is on or off. If off, plug in the car charger and reset the recorder.

Q: None of the buttons respond.

A: Please reset the recorder to restart.

Q: When opened, the recorder will not record automatically.

A: 1. Check that the memory card is full.

2. Reformat the card. If this problem exists, replace a new card.

Q: There is no sound in this video.

A: Please confirm that the microphone is turned off.

Q: The recorder always automatically on and off.

A: Please power the recorder through the USB vehicle charger. Do not power the recorder through the USB data cable with other adapters.

Q: The recorder cam is very hot. Is this normal?

A: It is normal to use the heat in the normal temperature range. If the equipment produces unnecessary smoke or odor, it should be stopped immediately.

Q: Even if the car engine is off, the machine won't turn off.

A: If the video mode is running, the machine will not turn off even if the car engine is off and the key switch is off.

Q: The video cannot be recorded on the memory card.

Q: "Memory error" appears on the recorder screen

A: 1-Be sure to use a branded memory card. Using low cost memory cards sold in this city does not guarantee operation.

2-A possible problem with the memory card. Please format the memory card.

Q: The screen freeze / button cannot operate

A: Press the reset button on the host side to restart the system.

Specifications may need to be modified without further notice, please treat the actual product as the standard form. If you need the latest updated software, please contact our after-sales service team!

contact us

For any questions, questions or comments about our products, please email the address below or call us. We will respond as soon as possible.

Warning:

Changes or modifications to this unit not expressly approved by the party responsible for compliance could void the user ' s authority to operate the equipment.

NOTE:

This device complies with part 15 of the FCC Rules. Operation is subject to the following two conditions: (1) This device may not cause harmful interference, and (2) this device must accept any interference received, including interference that may cause undesired operation.

FCC Statement:

This equipment has been tested and found to comply with the limits for a Class B digital device, pursuant to part 15 of the FCC Rules. These limits are designed to provide reasonable protection against harmful interference in a residential installation. This equipment generates, uses and can radiate radio frequency energy and, if not installed and used in accordance with the instructions , may cause harmful interference to radio communications. However, there is no guarantee that interference will not occur in a particular installation. If this equipment does cause harmful interference to radio or television reception, which can be determined by turning the equipment off and on, the user is encouraged to try to correct the interference by one or more of the following measures:

- Reorient or relocate the receiving antenna.
- Increase the separation between the equipment and receiver.
- Connect the equipment into an outlet on a circuit different from that to which the receiver is connected.
- Consult the dealer or an experienced radio/TV technician for help.

The equipment complies with FCC Radiation exposure limit set forth for uncontrolled environment. This equipment should be installed and operated with minimum distance 20cm between the radiator and your body.