

# AI SMART MOUSE



Instructions for use and after-sales service guarantee

## 1 Product structure and key description



## 2 Use the mouse

### 2.4G High Performance Wireless Mode (Receiver mode)

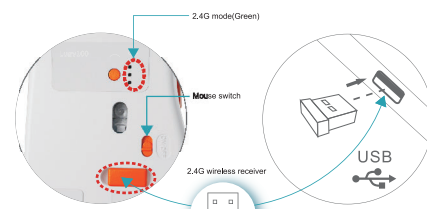

Figure 1

Note: The mouse factory default connection mode is 2.4G wireless mode.

01

- (1) Figure. As shown, remove the mouse 2.4G wireless receiver.
- (2) As shown in Figure ②, plug the 2.4G wireless receiver into any USB port of the computer.
- (3) Wait a little, after the computer recognizes the mouse device, turn on the mouse power switch, and the mouse function can be used normally. If the mouse does not respond to the above operation, please try to replace the 2.4G wireless receiver with another USB port on the computer for connection. (If it still cannot be used normally, please pair it in the following way)
- (4) Wireless 2.4G pairing mode: Switch the mouse mode to 2.4G mode, and the green light will blink slowly, then insert the mouse receiver into the USB port of the computer, hold down the mode key at the bottom of the mouse for 3-5 seconds, wait for the green light to blink quickly, the mouse enters the pairing mode, put the mouse close to the receiver, the green light will be steady for 5 seconds after the connection is successful, and the mouse can be used normally (if it fails, repeat the above operations).
- (5) The voice function of the mouse requires the installation of special intelligent voice mouse software. For details on how to download and install the software, (As in Figure 4).

Use 2.4G high performance wireless mode which needs to be used with the wireless receiver at the bottom of the mouse. To use Bluetooth mode, the computer needs to have Bluetooth hardware and support Bluetooth BLE (the operating system supports Windows 7, 8, 10, 11 or later or MacOS 10.10 or later).

### Bluetooth BLE mode

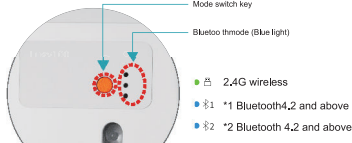

- (1) Wireless 2.4G (Green) Bluetooth 1 (Blue) Bluetooth 2 mode switch. In connect 2.4G mode, press the mode switch button at the bottom of the mouse to switch to Bluetooth 1 (Blue), the status light is blue, press again to switch to Bluetooth 2 (Blue), the status light is blue, press again to switch to 2.4G wireless mode, the status light is green, and cycle in turn.

02

## (2) Enter Bluetooth pairing mode

Switch the mouse mode to Bluetooth mode, the blue light of the mode indicator blinks slowly, hold down the mode button at the bottom of the mouse for 3-5 seconds, wait for the blue light to blink quickly, and the mouse enters Bluetooth pairing mode, in the Bluetooth pairing mode, the blue light of the mouse status indicator will continue to blink for 60 seconds, and the pairing operation must be completed within 60 seconds.

## (3) Pairing with a computer

Open the device options in the computer Settings screen, as shown in the figure. Click "Add Bluetooth or other device", and select "Bluetooth" in the pop-up dialog box as shown in the figure. Find "AltronLink Mouse" and click to connect. After successfully pairing with the computer, the blue light will keep on for 5 seconds and then go out.

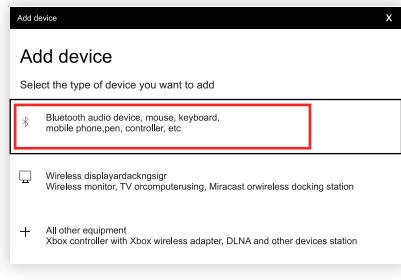
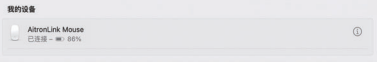

Figure 1

03

## Show connected:



## 3 Software

### Windows OS

#### 1. How to obtain the software installation package

When the mouse is in normal use, a Windows user can hold down the mouse wheel scroll button for 5 seconds to automatically display the driver download page (or enter "https://gpt.aiutronx.com/" in the browser to open the driver download page), and click the Windows driver download button to download the software.

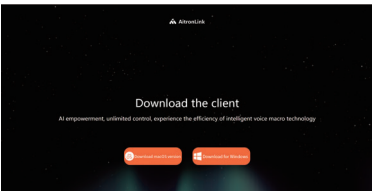

Download interface:



04

- (1) Double-click the downloaded installation package and click "Next" to install it.
- (2) After the installation is complete, the software will run automatically, and the task bar at the lower right corner of the computer will display the software icon (AI).

Note: By default, the driver is automatically started upon startup. If the anti-virus software displays a warning to prevent the driver from starting upon startup, select Allow this operation.



(The software is running properly, and the software will appear in the taskbar)

### Mac OS operating system

#### 1. How to obtain the software installation package

For Mac IOS users, search for AltronLink in the APP Store to download and install it. After the installation is completed, the status bar at the top of the computer will display the software icon (AI).

## 4 Charging instructions

It is recommended to use the computer USB port or 5V power supply to charge the mouse. When charging, the red light is steady on at the wheel, scroll and the red light is turned off after it is full. The mouse is charged for about 2 hours. (Do not use the fast charge adapter and cable to charge the mouse)

05

## 5 Function introduction

### 1. How to obtain the software installation package

1. Voice typing
- (1) Short voice mode: Hold down the mouse voice button (As in Figure 5), start speaking, then release to achieve voice typing.
- (2) Long voice mode: Click the mouse voice key (As in Figure 5) start speaking, then click the button again to achieve voice typing.



Figure 1

### 2. Voice translation

- (1) Short speech mode: Hold down the mouse translation button (As in Figure 6), start speaking and release to translate.
- (2) Long voice mode: click the mouse translation key (As in Figure 6) to start speaking, and then click the key again to achieve voice translation.



Figure 1

### 3. Voice search

- (1) Hold down the mouse "Q" key (as shown). Start talking, then release to enable intelligent search.
- (2) The language of voice search is subjected to the language of voice typing.

- (3) Left click the AltronLink (AI) icon, click "Smart Settings" in the pop-up software interface, and set the search engine in "Voice Search Settings".



Figure 1

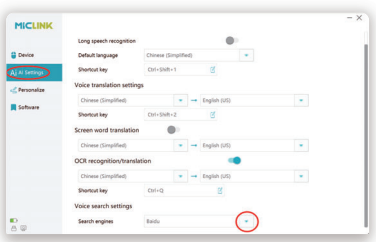

Figure 1

## 4. Word translation

- (1) Left click the AltronLink (AI) icon, click "Smart Setting" in the pop-up software interface, and find the button for word translation (As in Figure 9). Click the button, slide the mouse to select the text that needs to be translated, and click the translation button.
- (2) The recognition and translation language of word segmentation translation can be set in the software (As in Figure 9)

07

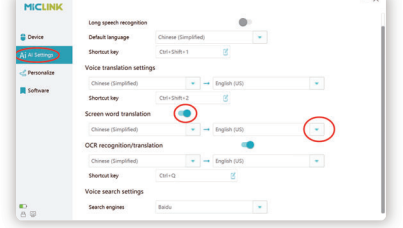

Figure 1

## 5. Screenshot recognition/translation

- (1) Left click the AltronLink (AI) icon, click "Device Settings" in the pop-up software interface, and select the function of "Screenshot translation" (As in Figure 10).

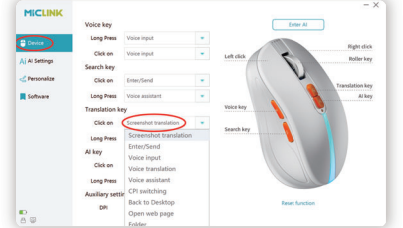

Figure 1

## 5. Screenshot recognition/translation

- (2) Click the mouse translation button, slide the mouse to select the identification or translation content and click the software identification or translation button.
- (3) The recognition and translation language of screenshot translation can be set in the software and the shortcut key of screenshot translation can also be modified (As in Figure 11).

08

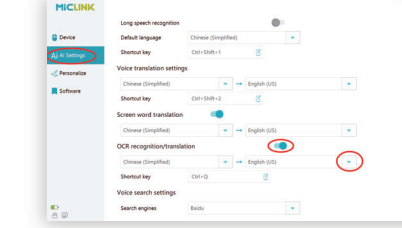

Figure 1

## 6. Cloud command Settings

- (1) Left click the AltronLink (AI) icon and click "Cloud Finger" in the pop-up software interface. Left set \*, click Add command (As in Figure 12). Enter the instruction word and select the pair of the instruction word should control function (open folder/website/fix text) (As in Figure 13).

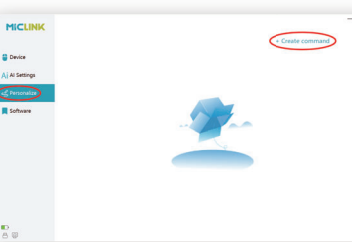

Figure 1

09

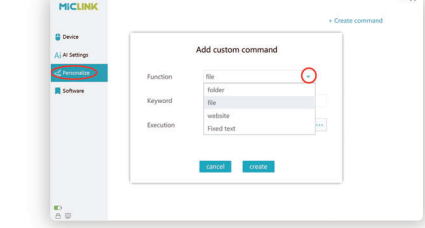

Figure 1

## 7. Press Enter/Send

- (1) Left click the AltronLink (AI) icon, click "Device Settings" in the pop-up software interface, and select the "Enter/Send" function (As in Figure 14).

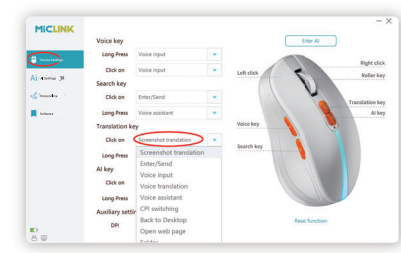

Figure 1

10



Figure 1

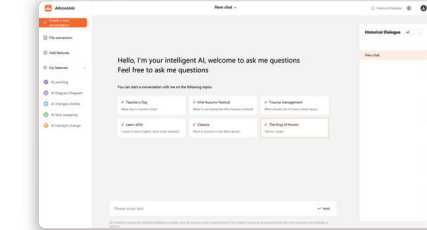

Figure 1

## 6 Use precautions

1. Due to the ultra-low standby power consumption, it is not necessary to deliberately shut down the mouse when used in a fixed place, and it is recommended to shut down the mouse when taking it out.
2. 2.4G wireless receiver inserted into the computer USB, do not deliberately take out the storage.
3. The battery is a 3.7V-500mAh rechargeable battery, which does not need to be removed unless it needs to be replaced. 1.5VAAA alkaline batteries can be used.

## 7 Special Reminder

1. The intelligent voice mouse with a rechargeable battery should be prevented from exposure to sunlight or stored in a hot car, and remember not to remove the mouse shell or disassemble parts at will.

11



Introduction to the use of the mouse program

12

We strive to ensure rigorous product design and perfect product quality, committed to high performance and personalized user experience, and provide complete after-sales service.

From the date of sale, the smart voice mouse can enjoy 12 months of free guarantee service in case of hardware failure under normal use.

The following factors are not included in the free warranty service, we will provide paid after-sales service, fault repair, parts or machine replacement

1. Disassembled, repaired and assembled by unauthorized personnel;
2. due to the use of physical damage, damage;
3. Abnormal caused by normal loss and other reasons unrelated to product quality.

**FCC Statement**  
This equipment has been tested and found to comply with the limits for a Class B digital device, pursuant to part 15 of the FCC Rules. These limits are designed to provide reasonable protection against harmful interference in a residential installation. This equipment generates, uses and can radiate radio frequency energy and, if not installed and used in accordance with the instructions, may cause harmful interference to radio communications. However, there is no guarantee that interference will not occur in a particular installation. If this equipment does cause harmful interference to radio or television reception, which can be determined by turning the equipment off and on, the user is encouraged to try to correct the interference by one or more of the following measures:  
\* Reorient or relocate the receiving antenna.  
\* Increase the separation between the equipment and receiver.  
\* Connect the equipment into an outlet on a circuit different from that to which the receiver is connected.  
\* Consult the dealer or an experienced radio/TV technician for help.  
Caution: Any changes or modifications to this device not explicitly approved by manufacturer could void your authority to operate this equipment.  
This device complies with part 15 of the FCC Rules. Operation is subject to the following two conditions: (1) This device may not cause harmful interference, and (2) this device must accept any interference received, including interference that may cause undesired operation.

**RF Exposure Information**  
The device has been evaluated to meet general RF exposure requirement. The device can be used in 0mm exposure condition, compliance with exposure requirements.  
Only in the stated conditions, the device is shown to fully comply with the FCC RF Exposure requirements of 47 CFR 47.498.

Made in China