

# Baby Monitor

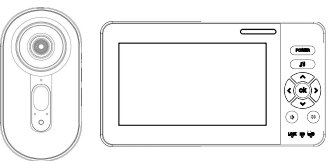

## User Manual

### Product Components List

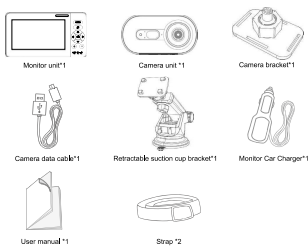

### Display Features

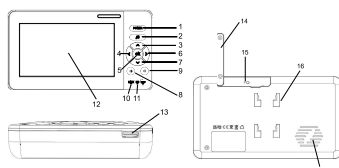

- 1.Power button**  
-Press the Power button briefly to turn the device on or off.
- 2.Music button/Back button**  
-After the camera and monitor are connected, in live view mode, press the **⏮** button briefly to play or pause music.  
-In the menu settings or playback interface, press the **⏮** button briefly to return to the previous screen.

- 3.Up button**  
-Press the **⏮** button briefly to enter video playback mode.  
-In the video playback/photo viewing interface, press **⏮** briefly to switch between different videos/photos.
- 4.Left button**  
-In live monitoring mode, press the **⏮** button briefly to start recording.  
-In the playback interface, press the **⏮** button briefly to open the delete options.
- 5.OK button**  
-Press the **⏮** button briefly to open the menu settings list.  
-Press the **⏮** button briefly to confirm the menu settings, confirm deletion, or pause/play video.
- 6.Right button**  
-Press the **⏮** button briefly to enter photo mode. In the live view mode, press **⏮** briefly to capture a real-time photo.  
-In the playback interface, press **⏮** briefly to toggle between video and photo lists.  
-In the menu settings interface, press **⏮** briefly to select to the right.
- 7.Down button**  
-While music is playing, press the **⏮** button briefly to skip to the next song.  
-In the menu settings list or playback interface, press **⏮** briefly to select a function/photo/video downwards.  
-In the video playback/photo viewing interface, press **⏮** briefly to switch between different videos/photos.
- 8.Volume + button**  
-In live monitoring mode, press the **⏮** button briefly to decrease the camera volume.

- 9.Volume - button**  
-In live monitoring mode, press the **⏮** button briefly to increase the camera volume.  
-Long press the volume **⏮** button to cycle through the zoom and restore angles. This function can only be used during real-time monitoring.
- 10.Connection indicator light**  
-Camera and monitor connection signal indicator.
- 11.Charging indicator light**  
-The monitor's charging status indicator light.  
-The monitor's power status indicator light will turn red when connected to the car charger and powered on successfully.
- 12.Display**  
-Monitor display screen.
- 13.Charging port**  
-Connect the car charger to the TYPE-C charging port.
- 14. Antenna**  
-Signal reception.
- 15.Reset hole**  
-If the device freezes or becomes unresponsive, use a SIM card ejector to press and hold the reset hole to power off and restart the monitor.
- 16. Bracket card slot**  
-The slot position for connecting the retractable bracket.
- 17. Speaker**  
-Audio speaker

### Camera Features

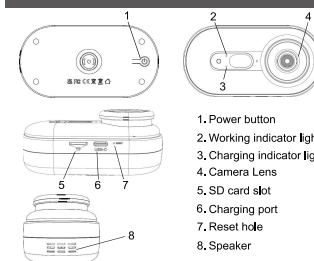

- 1. Power button
- 2. Working indicator light
- 3. Charging indicator light
- 4. Camera Lens
- 5. SD card slot
- 6. Charging port
- 7. Reset hole
- 8. Speaker

### Installation precautions

- WARNING:** Keep the device out of reach of children.
- Choking hazard:** This product contains small parts, please be careful when unpack and assemble the product.
- Strangulation Hazard:** Children have STRANGLED in cords. Keep the cords out of reach of children (more than 3 feet / 0.9 meters away). Never use an extension cord with the AC adapter.
- Power Safety:** This device should only be used with the included AC power adapter (rated 5V 1-2A). Using other 24GHz devices (such as Wi-Fi routers, Bluetooth systems, or microwave ovens) may interfere with this product. Keep the baby monitor at least 5 feet (1.5 meters) away from such devices, and turn them off if interference occurs.

### Camera Installation

- Step 1:** Pull the headrest up, pass the hook side of the strap horizontally through the bracket hole, wrap it around the headrest, pass it through the buckle, and glue the fur side back to secure.
- Step 2:** Pass the hook side of the other strap vertically through the bracket hole, wrap it around the headrest, pass it through the buckle, and glue the fur side back to secure.

- Step 3:** Press the headrest back into place, insert the ball joint into the connection, then place the screw ring into the connection and tighten it clockwise (as shown in the image below).

### Install monitor

- Step 1:** Clean the glass surface where the suction cup will attach. Peel off the protective film from the suction cup, press it firmly against the glass, and push the pressure switch back until it is fully closed.

- Step 2:** Align the four corners of the suction cup bracket with the monitor's back slots and secure it. Rotate the nut on the back of the bracket to adjust the monitor's angle (front, back, left, right).

- Rotate the adjustment knob from back to front to flip the bracket arm 180°; rotate the knob from front to back to fix the bracket arm's angle.
- Rotate the triangular screw counterclockwise to extend the bracket arm length, and clockwise to tighten and fix the length.

- Step 3:** Finally, connect the TYPE C port of the car charger to the monitor's input port to power it on.

### Charging Status

- 1.Charging indicator light**  
When using the included TYPE-C data cable to charge the camera, the charging indicator will flash red, indicating that charging is in progress. Once fully charged, the red light will remain on (as shown in the image below).
- 2.Power supply for monitor**
  - ① **Car Power Supply:** Connect the monitor to the car charger via the cigarette lighter socket.
  - ② **Status indication:** When the monitor is successfully connected to the car charger, the indicator light stays on in red, and the battery icon in the top-right corner of the screen displays the symbol (as shown in the image below).

### Inserting the memory card

- Before use, insert an SD card into the camera to record and store videos and photos. Please follow the steps below to insert an SD card:
- ① Insert the memory card. Make sure to insert the metal contacts first. Push the memory card down until you hear a click. (The memory card can only be inserted one way. If the card does not insert smoothly, do not force it.)
- ② To remove the memory card, just push it in and the card will pop out.
- (The memory card is already installed in the machine.)

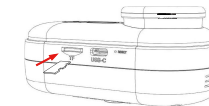

## Device Connection and Pairing

### 1. Automatic Connection

Press and hold the **Power** button on the camera and the **Power** button on the monitor to power them on. When the camera's blue light is flashing quickly, it will begin the automatic connection process. Once the camera's blue light stays on, the connection is successful, and the screen will display the **Video** icon.

### 2. Manual Connection

- After powering on the monitor, press the **Pairing** button → select Pairing Camera.
- Search for and pair the connection. When the connection is successful, the camera's blue light will stay on, and the **Video** icon will appear on the screen.

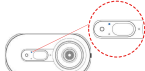

(Connection success indicator light picture)

#### Note:

\*Whether using automatic or manual connection, ensure that both the camera and the monitor are powered on. The camera's blue light must flash quickly to pair. If the camera's blue light is flashing slowly (sleep mode), the camera and monitor may not be paired.  
\*The metal material of the car body will block the transmission signal. Please try to use the camera and monitor inside the car to avoid signal interruption.

## Function Operations

### 1. Live Monitoring and Recording

After the camera and monitor are powered on and successfully connected, the live view will automatically display. Press the **Play** button briefly to start recording (the "REC" icon will flash). Press the **Stop** button again to stop recording. Press the **Back** button to enter the video playback interface.

### 2. Live Monitoring and Photo Capture

After the camera and monitor are powered on and successfully connected, the live view will automatically display. Press the **Photo** button briefly to capture a real-time image from the live monitoring screen.

### 3. Music

\*In live monitoring mode, press the **Music** button briefly to play music. The music icon will appear in the top right corner of the screen.  
\*Press the **Next** button briefly to switch to the next song, press the **Previous** button to decrease the volume, and press the **Volume Up** button to increase the volume.

### 4. View Video

\*Press the **Play** button briefly to enter video playback. Press **Left/Right** buttons briefly to browse forward/backward through the video. Press **Enter** button briefly to confirm and play the selected video. Press **Play/Pause** button again to pause playback. Press **Back** button briefly to exit the playback interface and return to the video list.  
\*When the video is paused, press **Delete** button briefly to choose to delete the current video. In the video browsing interface, pressing **Delete** button briefly will also allow you to delete the current video.

### 5. View Photos

\*Press **Play** button briefly once to enter video playback, then press **Photo** button to switch to the photo browsing interface.  
\*Press **Left/Right** buttons briefly to browse forward/backward through the photos. Press **Enter** button briefly to confirm and view the selected photo. Press **Back** button briefly to exit the viewing interface.  
\*Press **Delete** button briefly to delete the current photo. In the photo browsing interface, press **Delete** button briefly to delete the current photo.

## Menu Settings List

Press **Settings** button briefly to enter the menu settings list. Press **Left/Right** buttons to navigate up or down through different settings options. Press **Enter** button briefly to confirm and enter the selected settings menu.

#### Display Brightness:

Press **Left/Right** buttons briefly to adjust different brightness levels. Press **Enter** button briefly to exit the current setting.

#### Language:

Press **Left/Right** buttons briefly to select and switch between multiple languages. Press **Enter** button briefly to confirm the selected language. Press **Back** button briefly to exit the current setting.

#### Camera Volume:

Press **Left/Right** buttons briefly to adjust the camera's volume.

#### Video Resolution:

Press **Left/Right** buttons briefly to select and switch between different resolutions. Press **Enter** button briefly to confirm the selected video resolution.

#### Day/Night Mode:

Press **Left/Right** buttons briefly to select and switch between Night, Day, or Auto modes for live monitoring. Press **Enter** button briefly to confirm the selected mode. Press **Back** button briefly to exit the current setting. (When Night/Day mode is selected, the **Day/Night** icon will appear at the top of the screen.)

#### Alarm:

Press **Left/Right** buttons briefly to select different alarm groups. Press **Enter** button briefly to activate the current alarm, and press **OK** button briefly to enter the alarm time setting interface. Press **Left/Right** buttons to select the time value, press **Enter** button to confirm the set time value. Once the time value is set, press **OK** button briefly to confirm. Press **Back** button briefly to turn off any alarm. (When the alarm is successfully activated, the **Alarm** icon will appear in the top right corner of the monitor screen.)

#### Date and Time:

Press **Enter** button briefly to select year, month, day, hour, or minute. Press **Left/Right** buttons to adjust the values for year, month, day, hour, and minute. Once the values are set, press **OK** button briefly to confirm.

#### Default Setting:

Restore to factory settings.

#### Format:

Format and clean the files stored on the SD card. It is recommended to back up important files before formatting.

#### Date Stamp:

Press **Enter** button briefly to toggle the timestamp on or off.

#### Pairing Camera:

Press **Pairing** button briefly to search for and connect to the camera (ensure both the camera and monitor are powered on).

#### Version:

The device version number.

## Connecting Camera to PC

\*When there is an SD card in the camera, use the Type-C cable included in the package to connect the camera (powered on) to the computer USB port. (After connecting to the computer, the connection between the camera and the monitor will be automatically disconnected. After unplugging the data cable, the camera's blue light will flash slowly, and the camera needs to be shut down and restarted before reconnecting.)

\*The computer screen will display the **Video** icon, indicating that the PC has detected the SD card and is automatically installing the camera driver.

\*After opening the disk, you can see that there are 2 folders inside.

#### VIDEO

\*The computer screen will display the **Video** icon, indicating that the PC has detected the SD card and is automatically installing the camera driver.

\*You can copy the disk files to the computer for backup. (The built-in memory card will overwrite recorded content in a loop by default. It is recommended to export data and format it once a month to ensure read and write performance.)

#### PHOTO

\*The photos you monitor and record will be stored in this folder.

\*The photos you monitor and take will be stored in this folder.

\*You can copy the disk files to the computer for backup. (The built-in memory card will overwrite recorded content in a loop by default. It is recommended to export data and format it once a month to ensure read and write performance.)

No Display on Screen	<ol style="list-style-type: none"> <li>Press the power button briefly to wake up the screen.</li> <li>Check if the camera and monitor are disconnected.</li> <li>Force restart the monitor by pressing and holding the reset button for 5 seconds.</li> </ol>
Monitor Displays "Signal weak or disconnected"	<ol style="list-style-type: none"> <li>Verify the camera is powered on (the blue LED should flash quickly). If off, restart the camera.</li> <li>Adjust the direction of the monitor's antenna.</li> </ol>
The blue light of the camera flashes when it is working, and it cannot connect to the monitor	You need to shut down the camera and restart it.
Screen Image Lagging/Freezing	<ol style="list-style-type: none"> <li>Shorten the distance between devices to avoid obstacles.</li> <li>Repower the battery unit/plug out the adapter, then plug it into the socket again.</li> <li>Press the RESET hole at the back of Monitor unit</li> </ol>
Device Noise	<ol style="list-style-type: none"> <li>The camera and monitor may be placed too close.</li> <li>The volume on the monitor may be set too high.</li> </ol>

Device Freezing /No Response	Immediately press and hold the reset hole to restart. If that doesn't work, contact customer support.
The video files/photos cannot be saved	<ol style="list-style-type: none"> <li>Ensure the SD card is properly inserted.</li> <li>Format the SD card via Menu → Format. (It is recommended to back up the files in the SD card before formatting.)</li> </ol>
Device has no sound	<ol style="list-style-type: none"> <li>Press the Volume + button to increase the volume.</li> <li>Check if the device is in Mute Mode: Enter Menu → Audio Settings or shortpress Volume +/- buttons to toggle mute.</li> <li>Force restart the device by pressing the reset hole.</li> </ol>
Loose/Detached Mount	<ol style="list-style-type: none"> <li>Clean the suction cup contact surface and windshield thoroughly.</li> <li>Resecure the straps tightly around the seatback.</li> <li>Check if the telescopic bracket buckle is fully engaged.</li> </ol>

## TECHNICAL DATA

Item	Parameters
Display	4.3" IPS
Power Adaptor	INPUT: 12-24V DC OUTPUT: 5V-2.0A
Working temperature range	-10°C-60°C (Extreme temperatures may cause screen display abnormalities)
Picture transmission distance	Open Area: 18.6 meters (61 feet) Obstructed Area: 15.4 meters (50.5 feet)
Battery (Monitor unit)	2000mAh 3.7V
WiFi	2.4G

Battery (Camera unit)	1000mAh 3.7V
-----------------------	--------------

## FCC Warning

This device complies with part 15 of the FCC Rules. Operation is subject to the following two conditions:

- This device may not cause harmful interference, and
- This device must accept any interference received, including interference that may cause undesired operation.

Any Changes or modifications not expressly approved by the party responsible for compliance could void the user's authority to operate the equipment.

**Note:** This equipment has been tested and found to comply with the limits for a Class B digital device, pursuant to part 15 of the FCC Rules. These limits are designed to provide reasonable protection against harmful interference in a residential installation. This equipment generates uses and can radiate radio frequency energy and, if not installed and used in accordance with the instructions, may cause harmful interference to radio communications. However, there is no guarantee that interference will not occur in a particular installation. If this equipment does cause harmful interference to radio or television reception, which can be determined by turning the equipment off and on, the user is encouraged to try to correct the interference by one or more of the following measures:

- Reorient or relocate the receiving antenna.
- Increase the separation between the equipment and receiver.
- Connect the equipment into an outlet on a circuit different from that to which the receiver is connected.
- Consult the dealer or an experienced radio/TV technician for help.

## MAINTENANCE

- Clean your baby monitor with a slightly damp or anti-static cloth.
- Never use cleaning agents or solvents.
- Do not attempt to repair or adjust any of the electrical or mechanical functions of the unit.
- It is recommended to disassemble the host in a high-temperature exposure environment to prevent aging of components. If you forget to disassemble the device, you need to cool it down for 10 minutes before turning it on to avoid damaging the circuit board due to sudden temperature differences.
- Do not disassemble, crush, or expose the battery to high temperatures.
- It is recommended to use a 5V 1A adapter to charge the camera.
- Charge the device (display) using the provided 5V/2A adapter. Charging with other power sources may affect performance.

## Compliance Information

**Product Name:** Baby monitor  
**Model:** ABS-60  
**Manufacturer:** Shenzhen Aobasen Electronic Technology Co., Ltd  
**Address:** 6 Floor, Yuanshuo Science Park, No.8 South Lane, Xinhaiqiao Street, Guihua Community, Shenzhen, China  
**Contact Person:** Melleng Feng  
**Phone:** +86 15217034875  
**Email:** mjyaya@163.com

## Troubleshooting

Problem	Solution
Can't power on	<ol style="list-style-type: none"> <li>Check if the charging indicator is flashing red during charging; the red light should stay on once fully charged.</li> <li>Try powering on the device after charging it for 1 hour.</li> <li>If the device still won't power on after charging, press and hold the reset hole for 5 seconds to force a restart.</li> </ol>
Unable to Automatically Connect to Camera	<ol style="list-style-type: none"> <li>Confirm that the camera blue light flashes quickly if not, press and hold the power button to restart.</li> <li>Ensure the devices are within 5 meters (16 feet) and have a clear line of sight.</li> <li>Turn off potential interference sources in the car (e.g., Wi-Fi, Bluetooth).</li> <li>If the camera and display cannot match, please check if the camera's blue light is in sleep mode (i.e. slow flash mode).</li> <li>Press and hold the reset hole (use a pin) for 5 seconds to reset both devices, then reconnect.</li> </ol>

Copyright © 2024 AATA Technology Inc. All rights reserved.

Copyright © 2024 AATA Technology Inc. All rights reserved.

Copyright © 2024 AATA Technology Inc. All rights reserved.

Copyright © 2024 AATA Technology Inc. All rights reserved.

Copyright © 2024 AATA Technology Inc. All rights reserved.

Copyright © 2024 AATA Technology Inc. All rights reserved.

**WARNING:**  
 STRANGULATION HAZARD: Cords can strangle children.  
 Keep cords out of the reach of children (more than 3ft (0.9m) away).