

#### Technical Support

If you need any technical help, please visit our official support site and contact our support team before returning the products:

<https://support.reolink.com>.

#### Technische Unterstützung

Wenn Sie technische Hilfe benötigen, besuchen Sie bitte unsere offizielle Support-Website und kontaktieren Sie unser Support-Team, bevor Sie die Produkte zurückschicken, <https://support.reolink.com>.

#### Support technique

Si vous avez besoin d'aide, veuillez contacter Reolink avant de retourner votre produit. La plupart des questions peuvent être répondues via notre centre de support en ligne à l'adresse

<https://support.reolink.com>.

#### Assistenza Tecnica

Se avete bisogno di assistenza tecnica, visitate il nostro sito ufficiale di Centro Assistenza e contattate il team di supporto prima di restituire i prodotti, <https://support.reolink.com>.

#### Soporte técnico

Si necesita cualquier ayuda técnica, por favor, consulte nuestro sitio oficial de soporte y póngase en contacto con nuestro equipo de soporte antes de devolver el producto: <https://support.reolink.com>.

#### REOLINK INNOVATION LIMITED

FLAT/RM 705 7/F FA YUEN COMMERCIAL BUILDING 75-77 FA YUEN STREET MONG KOK KL HONG KONG

# Reolink

EN/DE/FR/IT/ES  
Item No. : Hub P1

## Operational Instructions

Apply to: Reolink Home Hub Pro

December 2024  
58.03.008.0150



@ReolinkTech

<https://reolink.com>

# Contents

What's in the Box .....	2
Device Overview .....	3
Install the Hard Drive .....	4
Connecting Home Hub Pro .....	5
Access via Reolink App/Client .....	6
Adding Devices to Home Hub Pro .....	8
Specifications .....	9
Important Safety Instructions .....	9
Legal Disclaimer .....	10
Notification of Compliance .....	11

## What's in the Box

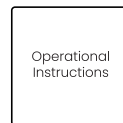

Operational  
Instructions



Home Hub Pro

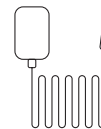

Power Adapter

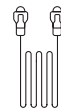

Ethernet Cable

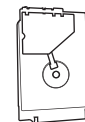

Hard Drive

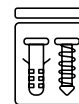

Pack of Screws



Reset Needle

## Device Overview

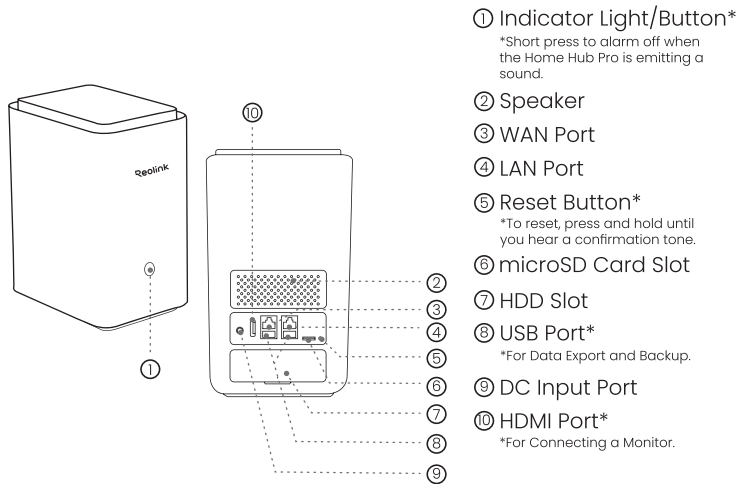

### Different States of the Indicators Light:

- Red Light Solid: Powered On
- Red Light Blinking: Network Connection Successful, No HDD Detected
- Blue Light Solid: Network Connection Successful, HDD Detected

## Install the Hard Drive

**NOTE:** Please make sure your device is powered off during the installation.

### Step 1: Remove the HDD slot cover.

Press the release tab on the left and hold the hollow part on the right simultaneously as you pull out the hard drive bracket.

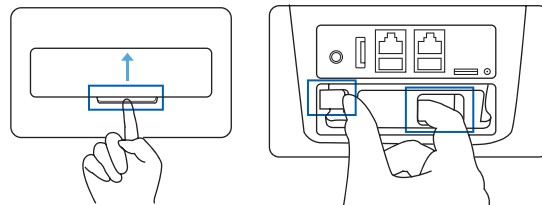

### Step 2:

Fix your HDD to the bracket with provided screws.

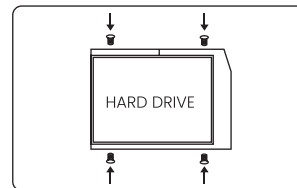

**Step 3: Push the bracket back into the slot.**

Make sure the release tab clicks into place and then cover the slot.

**NOTE:** When both the HDD and microSD card are inserted, recordings will only be saved to the HDD.

## Connecting Home Hub Pro

**Step 1:**

Power on the Reolink Home Hub Pro and connect it to your home router using the Ethernet cable provided.

**Step 2:**

Connect your phone to the same router that the Home Hub Pro is connected to.

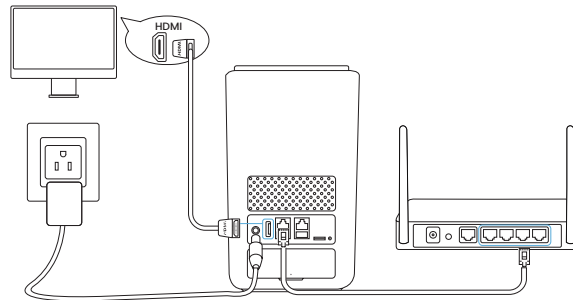

## Access via Reolink App/Client

**Step 1: Download the Reolink App.**

Scan the QR code to download the Reolink App.



## Step 2: Add the Hub to Set Up

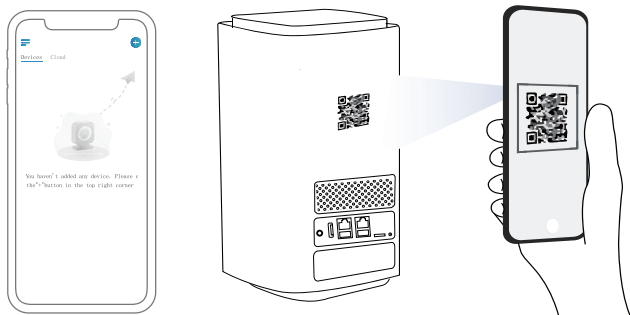

## Step 3: Setup Completion

Once setup is complete, the hub's indicator light will turn blue, meaning it's ready to use with the Reolink App.

## Step 4 (Optional): Access via Reolink Client

After the setup, you can access the hub using the Reolink Client:

1. Download the Reolink Client from: <https://reolink.com> > Support > App & Client
2. Open the Reolink Client on your PC, click "Add Device," and enter the hub's UID found below the QR code.

**NOTE:** If the Hub is not connected to the router after the setup, the indicator light will be red.

## Adding Devices to Home Hub Pro

There are two ways to add Reolink devices to your Home Hub Pro:

1. If your device is already set up, click the "+" button at the top right and choose to "add from device list" or "add from LAN."
2. If your device is not yet set up, click the "+" button in the top right corner and scan the QR code. (If you are adding a plug-in camera, make sure to power it up first.)



**NOTE:** Supports up to 24 Reolink cameras (excluding 4G). Compatible with most Reolink cameras. For more details, please contact Reolink support.

## Specifications

Operating Temperature: -10°C~+45 °C(14°F to 113°F)

Operating Humidity: 10%~90%

Dimensions: 185\*133\*222 mm

Weight: 1.096 kg

For more specifications, please visit <https://reolink.com/>.

## Important Safety Instructions

**Please read the instructions carefully before using the device.**

1. Replace only with the same or equivalent type of accessories recommended by Reolink.
2. Do not use the device in an environment that exceeds the recommended temperature range.
3. Do not use the device in an environment that exceeds the recommended humidity range.
4. Do not attempt to disassemble, repair, or alter the device by yourself.
5. Always follow the local safety laws and regulations when using the device.
6. The device contains (or comes with) small components, small plastic elements, and other small parts that may cause choking hazards. Keep the device and its accessories out of reach of children. Consult a physician immediately if small parts are swallowed.
7. The device contains (or comes with) cables or cords that may cause strangulation hazards. Keep the device and its accessories out of reach of children.

## Legal Disclaimer

To the maximum extent permitted by applicable law, this document and the product described, with its hardware, software, firmware, and services, are delivered on an "as-is" and "as-available" basis, with all faults and without warranty of any kind. Reolink disclaims all warranties, express or implied, including but not limited to, warranties of merchantability, satisfactory quality, fitness for a particular purpose, accuracy, and non-infringement of third-party rights. In no event will Reolink, its directors, officers, employees, or agents be liable to you for any special, consequential, incidental or indirect damages, including but not limited to damages for loss of business profits, business interruption, or loss of data or documentation, in connection with the use of this product, even if Reolink has been advised of the possibility of such damages.

To the extent permitted by applicable law, your use of the Reolink products and services is at your sole risk and you assume all risks associated with internet access. Reolink does not take any responsibilities for abnormal operation, privacy leakage or other damages resulting from cyber attacks, hacker attacks, virus inspections, or other internet security risks. However, Reolink will provide timely technical support if required.

The laws and regulations related to this product vary by jurisdiction. Please check all relevant laws and regulations in your jurisdiction before using this product to ensure that your use conforms to the applicable law and regulation. During the use of the product, you must comply with relevant local laws and regulations. Reolink is not responsible for any illegal or improper use and its consequences. Reolink is not liable in the event that this product is used with illegitimate purposes, such as third-party rights infringement, medical treatment, safety equipment, or other situations where the product failure could lead to death or personal injury, or for weapons of mass destruction, chemical and biological weapons, nuclear explosion, and any unsafe nuclear energy uses or anti-humanity purposes. In the event of any conflicts between this manual and the applicable law, the latter prevails.

# Notification of Compliance

## FCC Statement

This device complies with Part 15 of the FCC Rules. Operation is subject to the following two conditions:

(1) This device may not cause harmful interference, and (2) This device must accept any interference received, including interference that may cause undesired operation. Changes or modifications not expressly approved by the party responsible for compliance could void the user's authority to operate the equipment.

This equipment has been tested and found to comply with the limits for a Class B digital device, pursuant to Part 15 of the FCC Rules. These limits are designed to provide reasonable protection against harmful interference in a residential installation.

This equipment generates uses and can radiate radio frequency energy and, if not installed and used in accordance with the instructions, may cause harmful interference to radio communications. However, there is no guarantee that interference will not occur in a particular installation. If this equipment does cause harmful interference to radio or television reception, which can be determined by turning the equipment off and on, the user is encouraged to try to correct the interference by one or more of the following measures:

- Reorient or relocate the receiving antenna.
- Increase the separation between the equipment and receiver.
- Connect the equipment into an outlet on a circuit different from that to which the receiver is connected.
- Consult the dealer or an experienced radio/TV technician for help.

## FCC Radiation Exposure statement

This equipment complies with FCC radiation exposure limits set forth for an uncontrolled environment. This equipment should be installed and operated with minimum distance 20cm between the radiator and your body.

## ISED Statement

This device complies with Industry Canada licence-exempt RSS standard(s). Operation is subject to the following two conditions:

(1) this device may not cause interference, and (2) this device must accept any interference, including interference that may cause undesired operation of the device." This equipment should be installed and operated with a minimum distance of 20 cm between the radiator and your body.

Le présent appareil est conforme aux CNR d'Industrie Canada applicables aux appareils radio exempts de licence. L'exploitation est autorisée aux deux conditions suivantes :

(1) l'appareil n' doit pas produire de brouillage, et  
(2) l'utilisateur de l'appareil doit accepter tout brouillage radioélectrique subi, même si le brouillage est susceptible d'en compromettre le fonctionnement."

Cet équipement doit être installé et utilisé avec une distance minimale de 20 cm entre le radiateur et votre corps.

**MODIFICATION:** Any changes or modifications not expressly approved by the grantee of this device could void the user's authority to operate the device.

Toute modification non approuvée explicitement par le fournisseur de licence de l'appareil peut entraîner l'annulation du droit de l'utilisateur à utiliser l'appareil.

This Class B digital apparatus complies with Canadian ICES-003.

Cet appareil numérique de la classe B est conforme à la norme NMB-003 du Canada.

Operation of 5150-5350 MHz is restricted to indoor use only.

Le fonctionnement de 5150-5350 MHz est limité à une utilisation en intérieur uniquement.



## SIMPLIFIED EU AND UK DECLARATION OF CONFORMITY

Hereby, REOLINK INNOVATION LIMITED declares that the radio equipment type [refer to the cover of the Operational Instructions] is in compliance with Directive 2014/53/EU. The full text of the EU and UK declaration of conformity is available at the following internet address:

<https://support.reolink.com/hc/en-us/articles/36788378727065/>

RF exposure information: The Maximum Permissible Exposure (MPE) level has been calculated based on a distance of 20cm between the device and the human body. To maintain compliance with RF exposure requirement, use product that maintain a 20cm distance between the device and human body.

### Operating Frequency

OPERATING FREQUENCY :

2412~2472MHz RF Power:≤20dBm(EIRP)

5150~5250MHz RF Power:≤23dBm(EIRP)

5250~5350MHz RF Power:≤23dBm(EIRP)

5470~5725MHz RF Power:≤23dBm(EIRP)

5725~5875MHz RF Power:≤14dBm(EIRP)

868MHz RF Power:≤13.9dBm(EIRP)



The functions of Wireless Access Systems including Radio Local Area Networks (WAS/RLANs) within the band 5150~5350 MHz for this device are restricted to indoor use only within all European Union countries (BE/BG/CZ/DK/DE/EE/IE/EL/ES/FR/HR/IT/CY/LV/LT/LU/HU/MT/NL/AT/PL/PT/RO/SI/SK/FI/SE/TR/NO/CH/IS/LI/UK/NL)



### Correct Disposal of This Product

This marking indicates that this product should not be disposed with other household wastes throughout the EU. To prevent possible harm to the environment or human health from uncontrolled waste disposal, recycle it responsibly to promote the sustainable reuse of material resources. To return your used device, please use the return and collection systems or contact the retailer where the product was purchased. They can take this product for environmentally safe recycling.

### Limited Warranty

This product comes with a 2-year limited warranty that is valid only if purchased from Reolink Official Store or a Reolink authorized reseller. Learn more: <https://reolink.com/warranty-and-return/>.

### Terms and Privacy

Use of the product is subject to your agreement to the Terms of Service and Privacy Policy at [reolink.com](https://reolink.com)

### Terms of Service

By using the Product Software that is embedded on the Reolink product, you agree to the terms&conditions between you and Reolink. Learn more: <https://reolink.com/terms-conditions/>

### Technical Support

If you need any technical help, please visit our official support site and contact our support team before returning the products, <https://support.reolink.com>.

### Trademarks Acknowledgement

“Reolink” and other Reolink’s trademarks and logos are the properties of Reolink. Other trademarks and logos mentioned are the properties of their respective owners.